

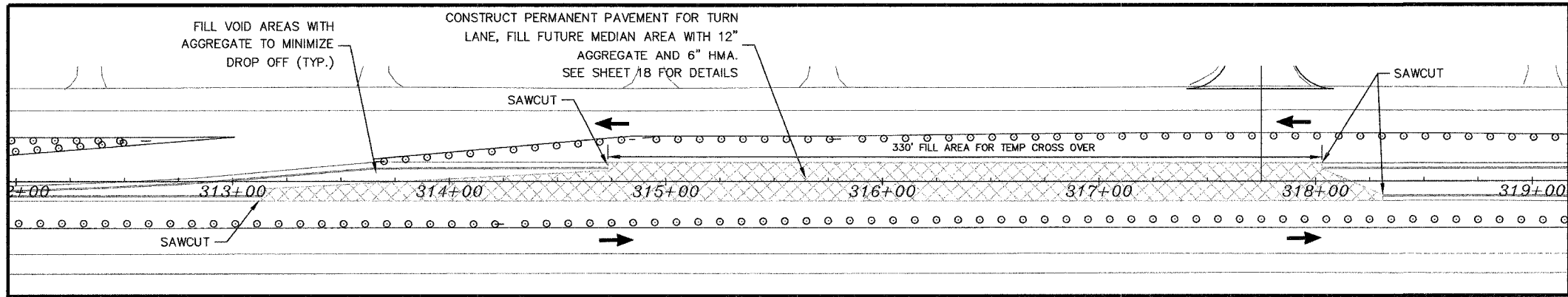

LEGEND

- PROP RECONSTRUCTION AREAS
- EXISTING CURB LINE
- PROPOSED CURB LINE
- TRAFFIC BARRICADES
- MEDIAN REMOVAL AREAS
- TEMPORARY PAVEMENT MARKING



"VIEW A"  
SCALE 1"=30'

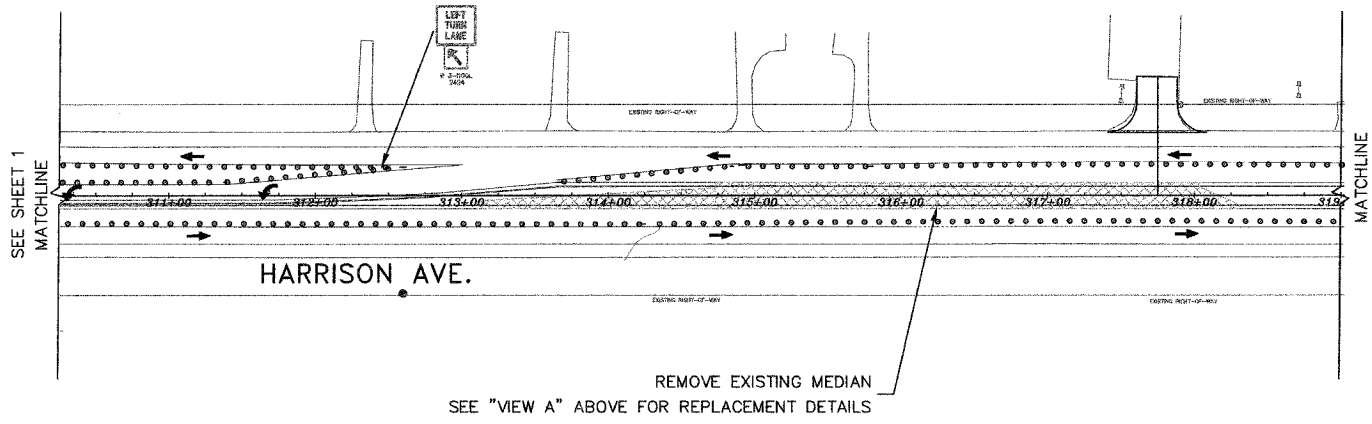

PHASING

1. RELOCATE OR COVER EXISTING REGULATORY SIGNS AS APPLICABLE
2. PLACE SIGNING, FLAGGERS AND TRAFFIC CONTROL DEVICES PER STD. 701601, 701701, 701901, 701606 AND IDOT DIST II DETAIL # 94.2 (ALL TEMPORARY TRAFFIC CONTROL PLACEMENT BASED ON 45 MPH DESIGN)
3. REMOVE MEDIAN IN AREAS SHOWN, CLOSE SIDE ROADS AS DIRECTED BY ENGINEER
4. CONSTRUCT AREAS TO BE USED BY TRAFFIC DURING CONSTRUCTION
5. RECONSTRUCT PERRYVILLE MEDIAN NOSE, NORTH LEG
6. POST AN ADVISORY SPEED LIMIT OF 35 MPH THROUGH CONSTRUCTION AREA

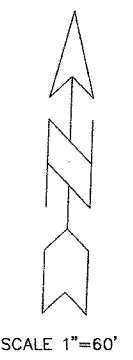
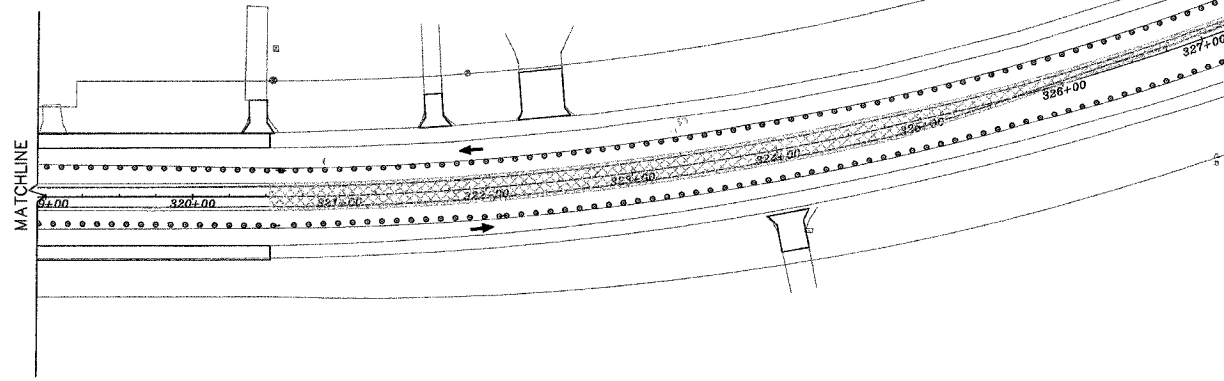
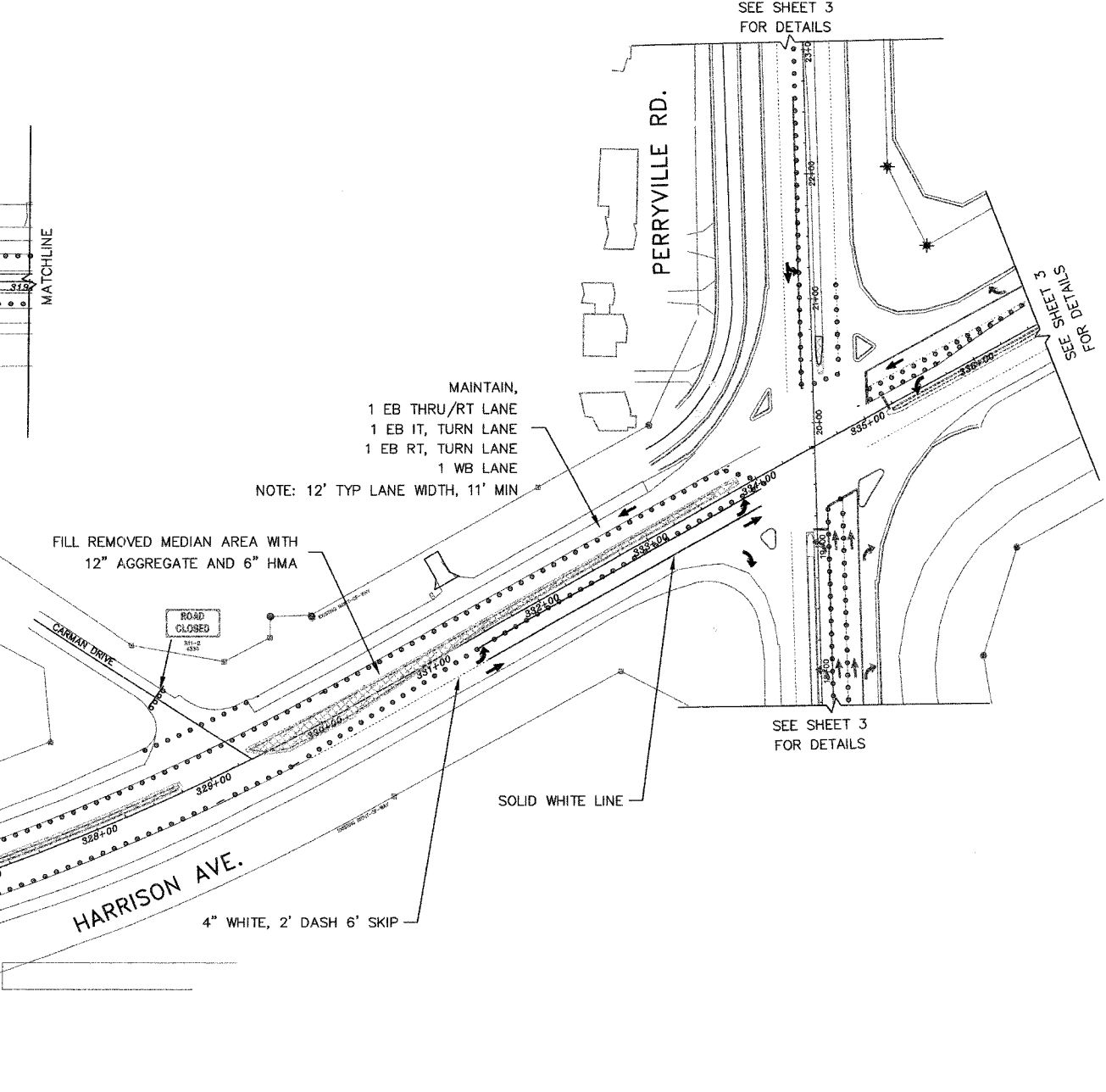

I:\Map\021\County Shared\Bidders\Highway Dept\Projects\04-00355-00-RS\Harrison & Perryville Staging Plan.dwg, 4/15/2008 12:52:19 PM, Doc: TC54600.pcl, WCS, 000