

ROUTE NO.	SECTION	COUNTY	TOTAL SHEETS	SHEET NO.
F.A.S. 321	05-00057-02-RS	IROQUOIS	100	1
FED. ROAD DIST. NO.		ILLINOIS CONTRACT NO.		
		CONTRACT NO. 87322		

- INDEX OF SHEETS**
- COVER SHEET
  - GENERAL NOTES AND MIXTURE REQUIREMENTS
  - SUMMARY OF QUANTITIES
  - 5. SCHEDULE OF QUANTITIES
  - TYPICAL SECTIONS
  - 17. PLAN AND PROFILE
  - ENTRANCE DETAILS
  - EROSION CONTROL SHEET
  - 100. STATION CROSS SECTIONS

**STATE OF ILLINOIS**  
**DEPARTMENT OF TRANSPORTATION**  
**DIVISION OF HIGHWAYS**  
**PLANS FOR PROPOSED**  
**SURFACE TRANSPORTATION PROGRAM – RURAL**

**HIGHWAY STANDARDS**

- 000001-05 STANDARD SYMBOLS, ABBREVIATIONS, AND PATTERNS
- 280001-04 TEMPORARY EROSION CONTROL SYSTEMS
- 630301-04 SHOULDER WIDENING FOR TYPE 1, (SPECIAL) GUARDRAIL TERMINALS
- 635006-02 REFLECTOR AND TERMINAL MARKER PLACEMENT
- 635011-01 REFLECTOR MARKER AND MOUNTING DETAILS
- 667101 PERMANENT SURVEY MARKERS
- 701006-02 OFF ROAD OPERATIONS, 2L, 2W, 4.5 m (15') TO 600mm (24") FROM PAVEMENT EDGE
- 701011-01 OFF-RD MOVING OPERATIONS, 2L, 2W, DAY ONLY
- 701301-02 LANE CLOSURE, 2L, 2W, SHORT TIME OPERATIONS
- 701306-01 LANE CLOSURE, 2L, 2W, SLOW MOVING OPERATIONS - DAY ONLY FOR SPEEDS ≥ 45 MPH
- 701311-02 LANE CLOSURE, 2L, 2W, MOVING OPERATIONS-DAY ONLY
- 701901 TRAFFIC CONTROL DEVICES
- 780001-01 TYPICAL PAVEMENT MARKINGS
- BLR 24-1 MAILBOX-TURNOUT FOR LOCAL ROADS
- BLR 26 STEEL PLATE BEAM GUARDRAIL 700 MM (27½") HIGH
- BLR 27 TRAFFIC BARRIER TERMINAL TYPE 5A

**UTILITIES**

- NICOR GAS  
1844 FERRY ROAD  
NAPERVILLE, IL 60563-9600  
ATTN: CONSTANCE LANE (630)388-3830
- MARATHON PIPE LINE  
1900 W. AVENUE H  
GRIFFITH IND. 46319-3034  
ATTEN: SUSAN DAILY (219)924-8577 X-228
- VERIZON NORTH  
KALIN HINSHAW  
110E MONROE  
BLOOMINGTO, IL 61701-2675  
(MAIL CODE) ILLLBON
- EASTERN ILLINI ELECTRIC  
330 W OTTAWA ST  
P.O. BOX 96  
PAXTON, IL 60957  
ATTN ALAN SCHWEIGHART 217-379-2131-17
- AMEREN CIPS  
P.O. BOX 566  
711 S 9TH STREET  
MATTON, IL 61938  
ATTN MIKE TIPTON 217-234-0559
- MCLEOD USA  
102 E SHAFER  
FORSYTH, IL 62535  
ATTN MARK MILLS 217-876-7194

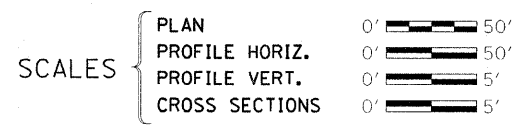

**F.A.S. 321 E 2900 NORTH ROAD (C.H. 4)**  
**SECTION 05-00057-02-RS**  
**IROQUIOS COUNTY**  
**PROJECT – SR-321(114)**  
**C-93-057-06**

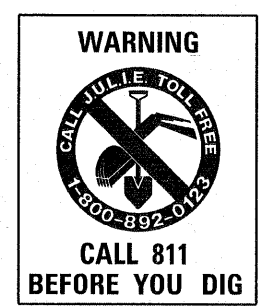
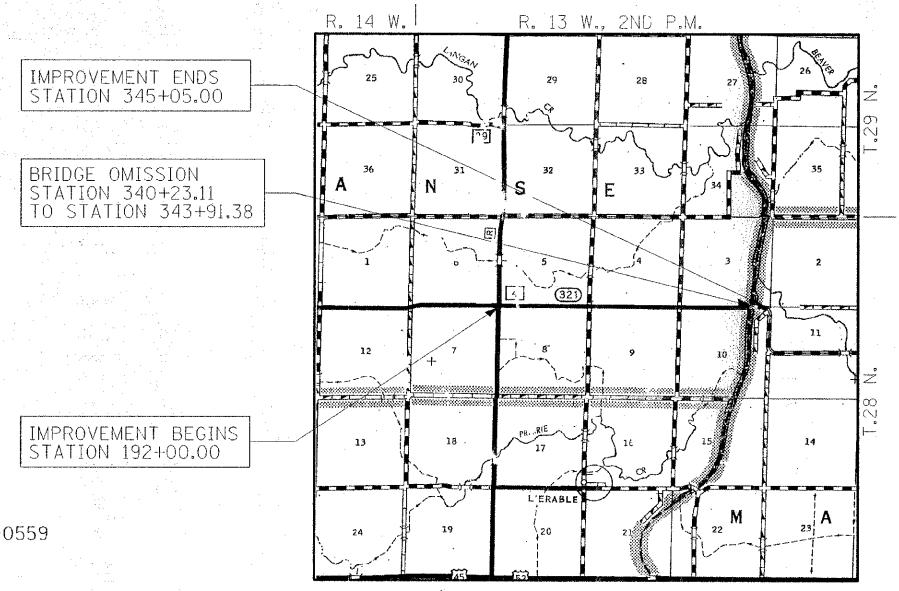
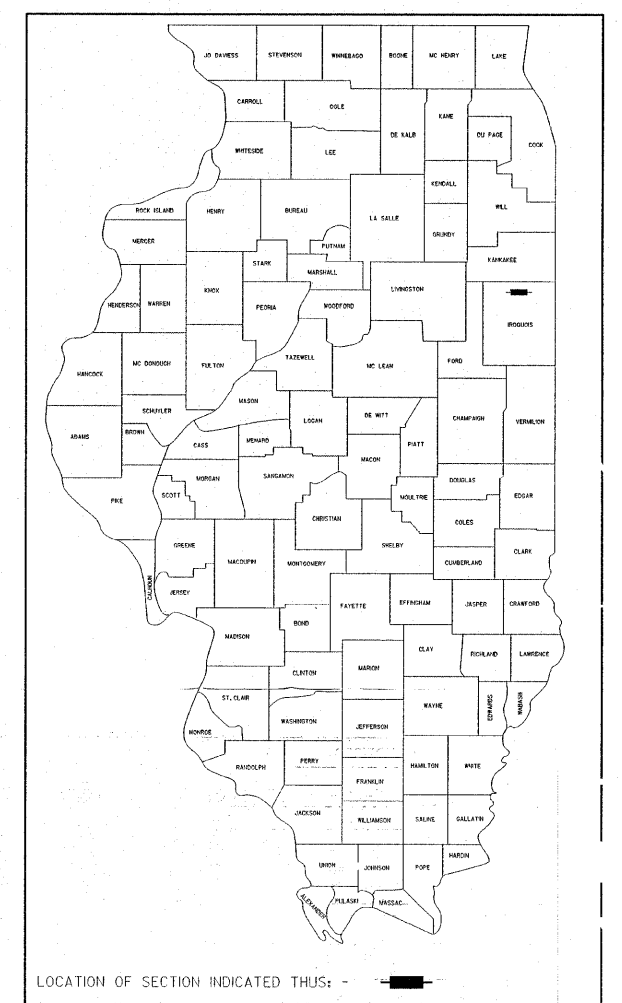

APPROVED March 20, 2008  
COUNTY ENGINEER

PASSED 03-26 2008  
DISTRICT THREE ENGINEER OF LOCAL ROADS & STREETS

Releasing For Bid Based on Limited Review 03-26 2008  
DEPUTY DIRECTOR OF HIGHWAYS REGION TWO ENGINEER  
STATE OF ILLINOIS DEPARTMENT OF TRANSPORTATION

DESIGN FUNCTIONAL CLASSIFICATION: MAJOR COLLECTOR (NON-URBAN)  
DESIGN TRAFFIC: 1322 (2028) ADT  
DESIGN SPEED: 50 M.P.H.

CONTRACT NO. 87322

**LAYOUT**

APPROXIMATE SCALE: 0 1 MILE

GROSS NET LENGTH OF SECTION = 15305 FEET = 2.897 MILES  
BRIDGE OMISSION = 368.27 FEET = 0.070 MILES  
NET LENGTH OF SECTION = 14936.73 FEET = 2.827 MILES

DATE: 3/17/2008

**HAMPTON, LENZINI & REHWICK, INC.**  
CIVIL & STRUCTURAL ENGINEERS  
LAND SURVEYORS

3085 STEVENSON DRIVE, SUITE 201  
SPRINGFIELD, ILLINOIS 62703  
(217) 546-3400

ELGIN • SPRINGFIELD

PROJECT NUMBER: 03-16-0001-i DATE: 03/04/08

EXPIRES: 11/30/2009