

DATE	
BY	
ORIGINAL SURVEY	SURVEYED
NOTE BOOK	PLOTTED
NO.	AREA
	CHECKED

DATE	
BY	
ORIGINAL SURVEY	SURVEYED
NOTE BOOK	PLOTTED
NO.	AREA
	CHECKED

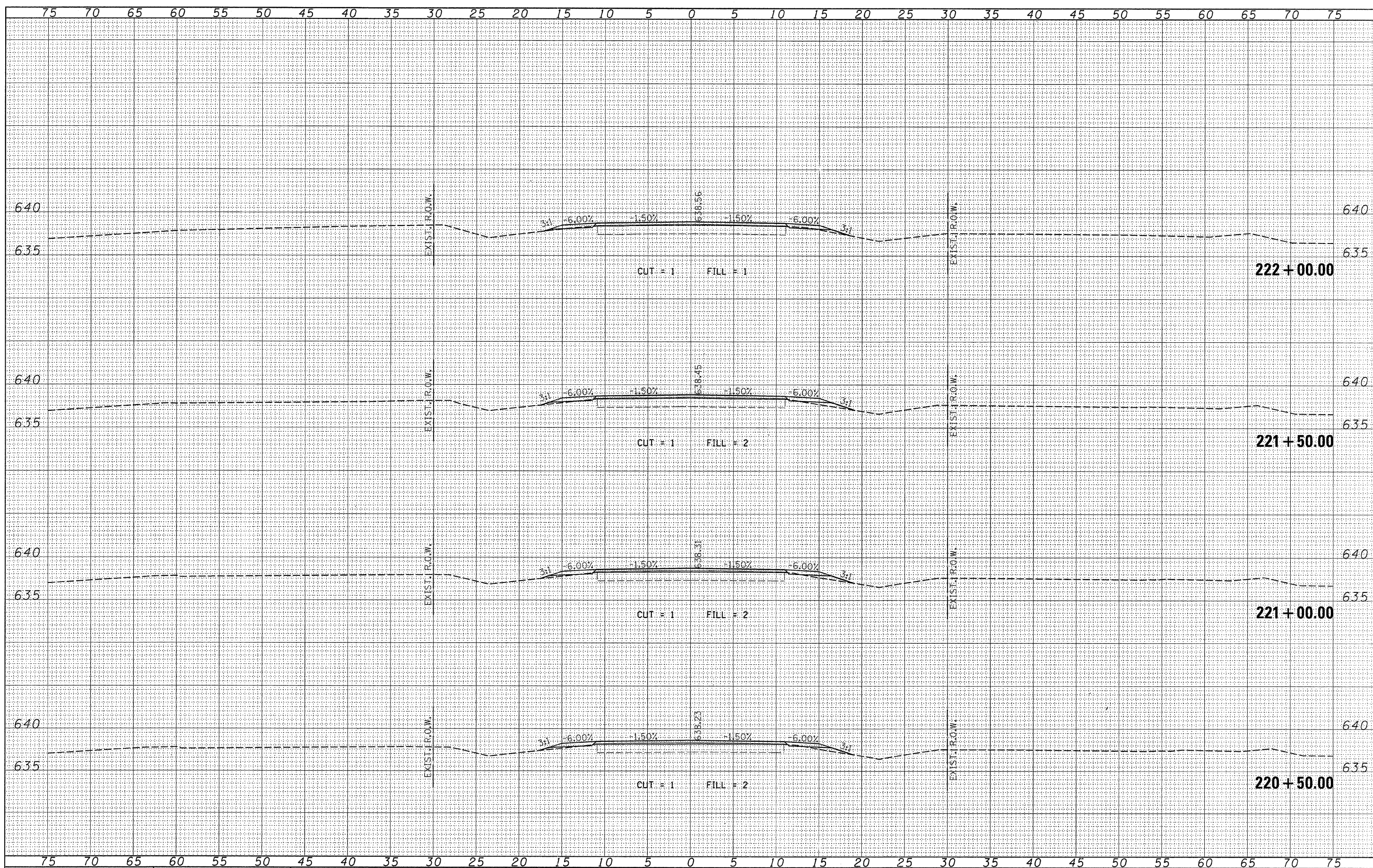

FILE NAME = 46001-sht-rs.dgn
 USER NAME =
 PLOT SCALE =
 PLOT DATE = 3/4/2008

DESIGNED - LFS	REVISED -
DRAWN - WJS	REVISED -
CHECKED -	REVISED -
DATE -	REVISED -

**STATE OF ILLINOIS
 COUNTY HIGHWAY DEPARTMENT**

HLR HAMPTON, LENZINI & RENWICK, INC.
 CIVIL & STRUCTURAL ENGINEERS
 LAND SURVEYORS
 SCALE: 5:10 SHEET NO. OF SHEETS

**CROSS SECTIONS
 F.A.S. 321 / C.H. 4**

F.A.S.	SECTION	COUNTY	TOTAL SHEETS	SHEET NO.
321	05-00057-02-RS	IROQUOIS	100	35
CONTRACT NO. 87322				
FED. ROAD DIST. NO. ILLINOIS FED. AID PROJECT				