

DATE	BY

DATE	BY

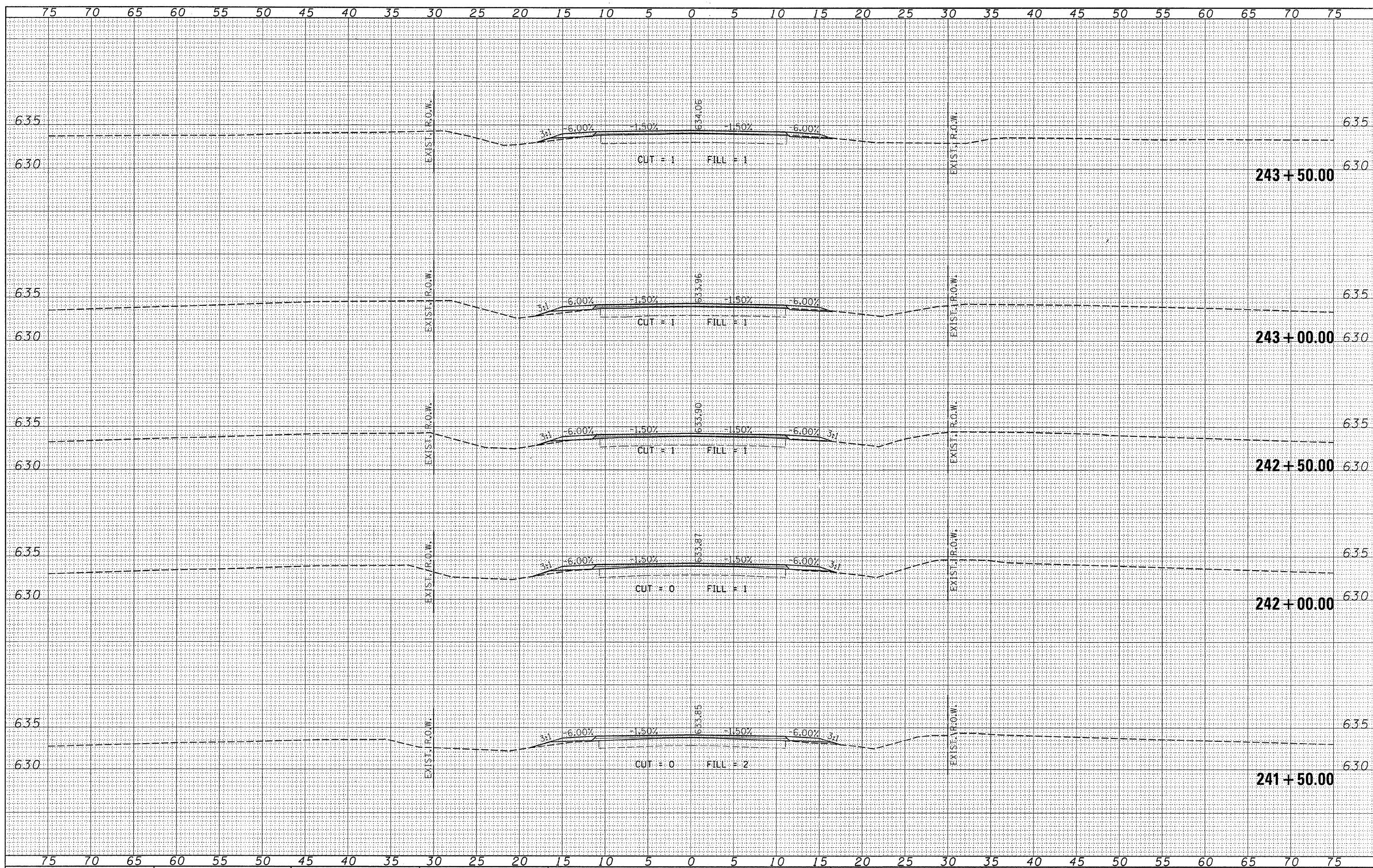

FILE NAME = 46001-sh1-rs.dgn  
 USER NAME =  
 PLOT SCALE =  
 PLOT DATE = 3/4/2008

DESIGNED - LFS	REVISED -
DRAWN - WJS	REVISED -
CHECKED -	REVISED -
DATE -	REVISED -

STATE OF ILLINOIS  
 COUNTY HIGHWAY DEPARTMENT

**HLR** HAMPTON, LENZINI & RENWICK, INC.  
 CIVIL & STRUCTURAL ENGINEERS  
 LAND SURVEYORS  
 SCALE: 5:10 SHEET NO. OF SHEETS

CROSS SECTIONS  
 F.A.S. 321 / C.H. 4  
 STA. 241+50.00 TO STA. 243+50.00

F.A.S. 321	SECTION 05-00057-02-RS	COUNTY IROUOIS	TOTAL SHEETS 100	SHEET NO. 46
CONTRACT NO. 87322			FED. ROAD DIST. NO. [ILLINOIS] FED. AID PROJECT	