

ROUTE NO.	SECTION	COUNTY	TOTAL SHEETS	SHEET NO.
C.H. 11	08-00022-00-BR	PUTNAM	23	7
		ILLINOIS	CONTRACT NO. 89434	

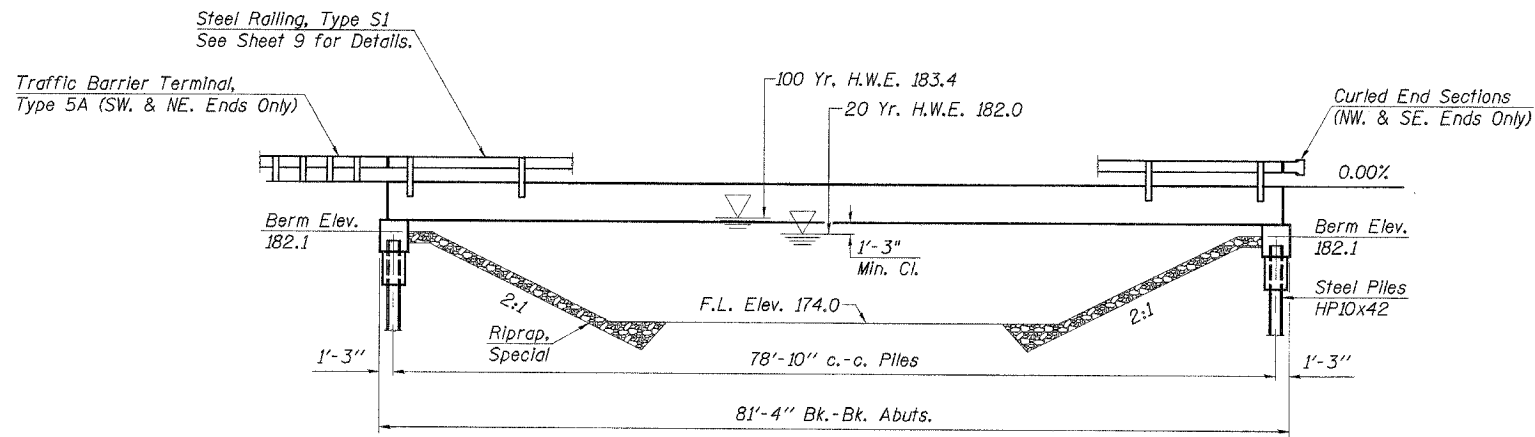

ELEVATION

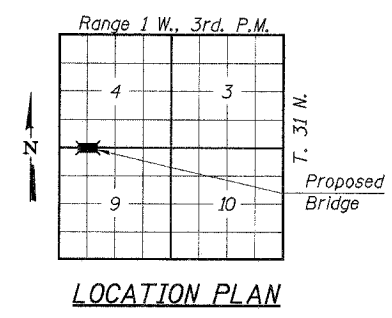

LOCATION PLAN

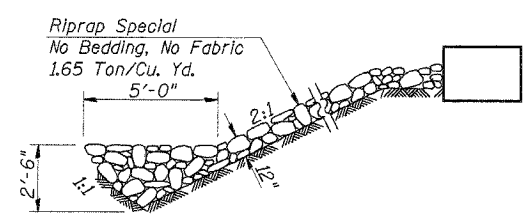

STONE RIPRAP ANCHOR DETAIL

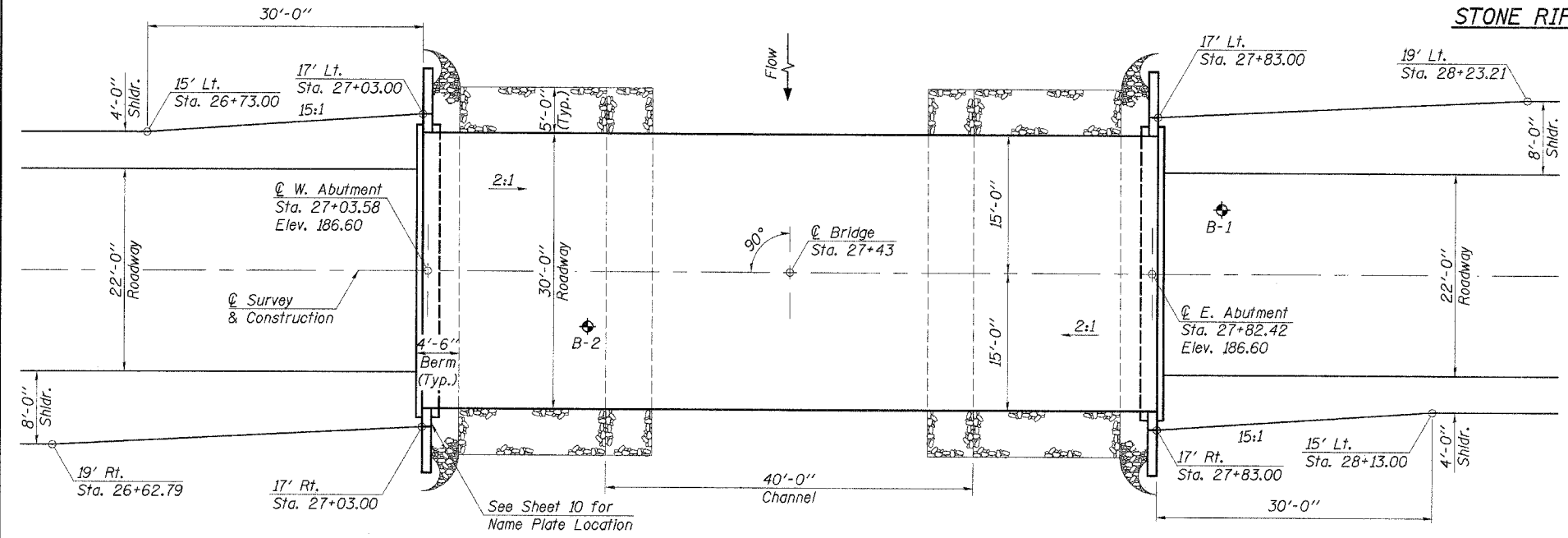

PLAN

DESIGN STRESSES

$f_c = 5,000$ p.s.i. (Prestressed Beams)
 $f_{ct} = 4,000$ p.s.i. (Prestressed Beams)
 $f_c = 1,400$ p.s.i. (Concrete)
 $f_s = 270,000$ p.s.i. (Prestressed Strands)
 $f_{sl} = 201,960$ p.s.i. (Prestressed Strands)
 $f_s = 24,000$ p.s.i. (Reinf. Bars -- Field Units)
 $f_y = 60,000$ p.s.i. (Reinf. Bars -- Field Units)
 $n = 9$ (Concrete)
 LOADING HS20-44
 Design Specifications: 2002 AASHTO
 25#/Sq. Ft. included in dead load for future wearing surface.

WATERWAY INFORMATION

Drainage Area 8.51 Sq. Mi.
 Existing Opening (20 Yr.) 336 Sq. Ft.
 Required Opening (20 Yr.) 464 Sq. Ft.
 Proposed Opening (20 Yr.) 464 Sq. Ft.
 Design Discharge (20 Yr.) 1,723 C.F.S.
 Created Head (20 Yr.) 0.0 Ft.
 100 Year Discharge 2,694 C.F.S.
 100 Yr. Created Head 0.3 Ft.

DESIGNED	F.J.S.
CHECKED	S.F.M.
DRAWN	S.A.P.
CHECKED	F.J.S.

GENERAL NOTES

See Proposal Booklet for Boring data.
 Reinforcement bars shall conform to the requirements of ASTM A706 Grade 60 (IL Modified). See Special Provisions.
 The Contractor shall drive one steel test pile in a permanent location at each abutment as directed by the Engineer, before ordering the remainder of piles.
 Layout of slope protection system may be varied in the field to suit ground conditions as directed by the Engineer.

CLEAR CREEK
 BUILT 200_ BY
 PUTNAM COUNTY
 SEC. 08-00022-00-BR
 COUNTY HIGHWAY 11
 F.A. PROJ. BRS-254()
 STR. NO. 078-3116 LOADING HS20

LETTERING FOR NAME PLATE
 See Std. 515001

TOTAL BILL OF MATERIAL

ITEM	UNIT	SUPER	SUB	TOTAL
Precast Prestressed Concrete Deck Beams (33" Depth)	Sq. Ft.	2,400		2,400
Concrete Structures	Cu. Yd.		22.7	22.7
Reinforcement Bars	Pound		2,750	2,750
Steel Railing, Type S1	Foot	164		164
Name Plates	Each		1	1
Steel Piles HP10x42	Foot		320	320
Test Pile Steel HP10x42	Each		2	2
Riprap, Special	Ton		138	138
Concrete Encasement	Cu. Yd.		3.5	3.5
Hot-Mix Asphalt Surf. Course, Mix "C" N50	Ton	30.0		30.0
P.C. Mortar Fairing Course	Foot	720		720
Waterproofing Membrane System	Sq. Yd.	267		267

"I certify that to the best of my knowledge, information and belief, this bridge design is structurally adequate for the design loading shown on the plans. The design is an economical one for the style of structure and complies with requirements of the current 'AASHTO Standard Specifications for Highway Bridges'."

Fred J. Stone, Jr. (10-10-07)
 ILLINOIS STRUCTURAL NO. 2934 (Expires 11/30/08)



GENERAL PLAN & ELEVATION

COUNTY HIGHWAY 11
 SECTION 08-00022-00-BR
 PUTNAM COUNTY
 STATION 27+43

4440 ASH GROVE SPRINGFIELD, IL. 62711 (217) 793-8800 www.fehr-graham.com	FEHR-GRAHAM & ASSOCIATES, LLC ENGINEERING AND SCIENCE CONSULTANTS <small>REPORTS • RECORDS • BIDDINGS • BIDDING BY APPROVAL</small>	JOB NO.: 46856 FILE: 46856GPE.DGN DATE: 04/12/07
---	--	--