

ROUTE NO.	SECTION	COUNTY	TOTAL SHEETS	SHEET NO.
C.H. 11 F.A.S. 254	08-00022 -00-BR	PUTNAM	23	23
ILLINOIS				

CONTRACT NO. 89434

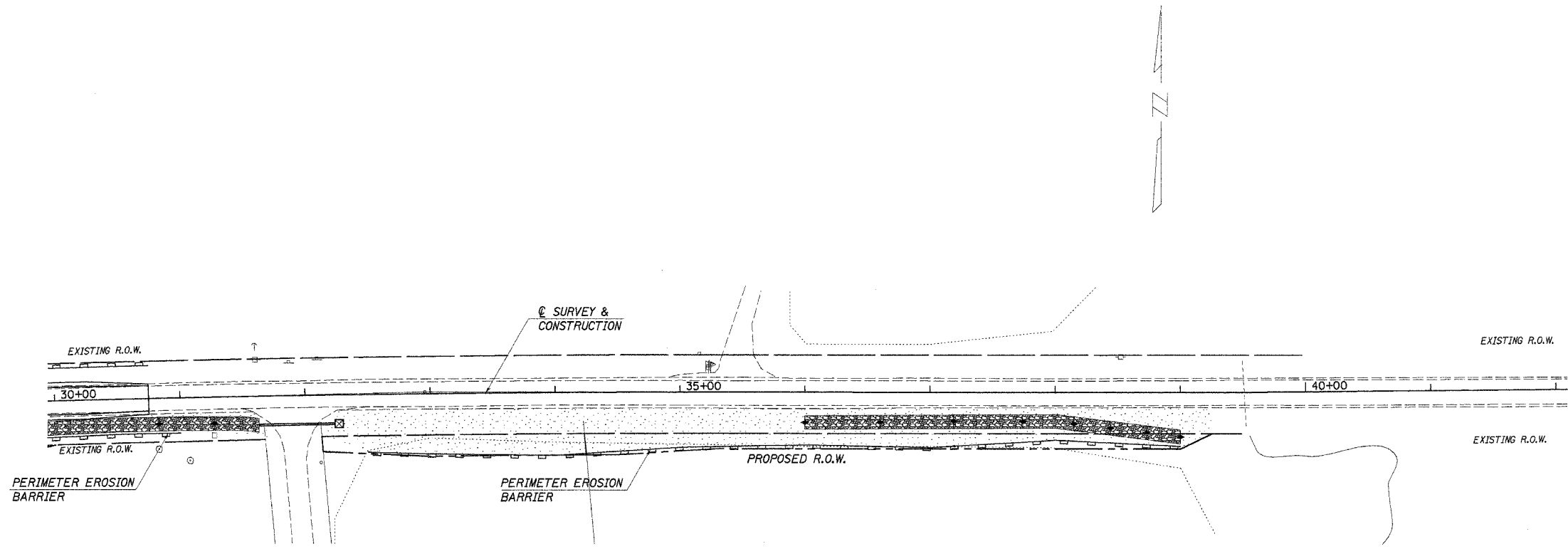

**TEMPORARY EROSION CONTROL:**

- PERIMETER EROSION BARRIER
- TEMPORARY DITCH CHECK
- INLET AND PIPE PROTECTION

**PERMANENT EROSION CONTROL:**

- SEEDING CLASS 2, FERTILIZERS, & MULCH, METHOD 2
- STONE RIPRAP DITCH

**EROSION CONTROL PLAN**  
SECTION 08-00022-00-BR  
PUTNAM COUNTY  
COUNTY HIGHWAY 11  
STATION 27+43

4440 ASH GROVE SPRINGFIELD, IL 62711 (217) 793-8600 www.fehr-graham.com	<b>FEHR-GRAHAM &amp; ASSOCIATES, LLC</b> ENGINEERING AND SCIENCE CONSULTANTS MEMPHIS, IL. ROCKFORD, IL. ROCKFELLE, IL. MONROE, WI. SPRINGFIELD, IL.	DRAWN: S.A.P. DATE: 02/07/07	CHECKED: G.J.C. DATE: 03/2/07	JOB NO.: 46856 FILE: EROSION2.DGN DATE: 04/17/07
--	---	---------------------------------	----------------------------------	--