

F.A.S. RTE.	SECTION	COUNTY	TOTAL SHEETS	SHEET NO.
2360	04-00058-09-FP	WOODFORD	9	7
STA. 70+00		TO STA. 120+00		
FED. ROAD DIST. NO. 4		ILLINOIS	FED. AID PROJECT	

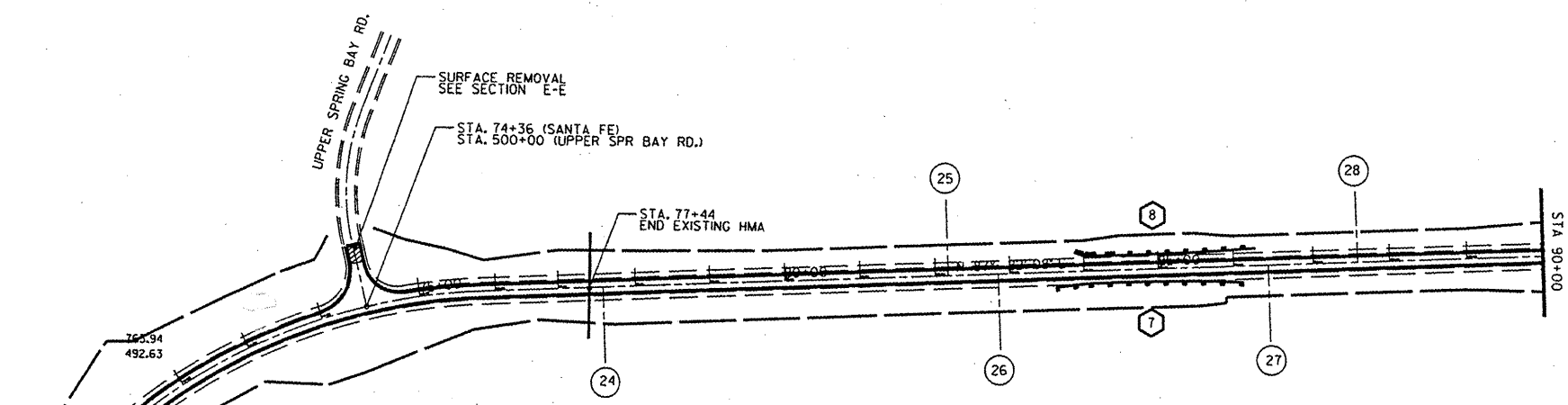

EXIST. CURVE C04  
 P.I.S.T.A. = 72+01.59  
 I = 65° 37' 57" (RT)  
 D = 7° 30' 00"  
 R = 763.94'  
 T = 492.63'  
 L = 875.10'  
 E = 145.07'  
 e = -----  
 T.R. = -----  
 S.E. RUN = -----  
 P.C. STA. = 67+08.96  
 P.T. STA. = 75+84.05

**LEGEND**

- ENTRANCE LOCATION (SEE TABLE)
- ⊗ GUARDRAIL LOC. (SEE TABLE)
- ▷ MAIL BOX TURNOUT (TYP.)

**GUARDRAIL TABLE**

RUN #	STATION -	STATION	LENGTH (FT)
7	83+61 -	86+12	RT 200
8	83+88 -	86+31	LT 187.5
9	93+23 -	101+71	RT 800
10	99+85 -	102+66	LT 287.5
11	114+05 -	119+05	LT 462.5
12	116+91 -	118+98	RT 187.5

EXIST. CURVE C06  
 P.I.S.T.A. = 97+29.89  
 I = 18° 34' 49" (LT)  
 D = 6° 11' 36"  
 R = 925.10'  
 T = 151.33'  
 L = 300.00'  
 E = 12.30'  
 e = -----  
 T.R. = -----  
 S.E. RUN = -----  
 P.C. STA. = 95+78.56  
 P.T. STA. = 98+78.56

EXIST. CURVE C07  
 P.I.S.T.A. = 103+43.67  
 I = 5° 30' 00" (RT)  
 D = 1° 13' 20"  
 R = 4,687.84'  
 T = 225.17'  
 L = 450.00'  
 E = 5.40'  
 e = -----  
 T.R. = -----  
 S.E. RUN = -----  
 P.C. STA. = 101+18.49  
 P.T. STA. = 105+68.49

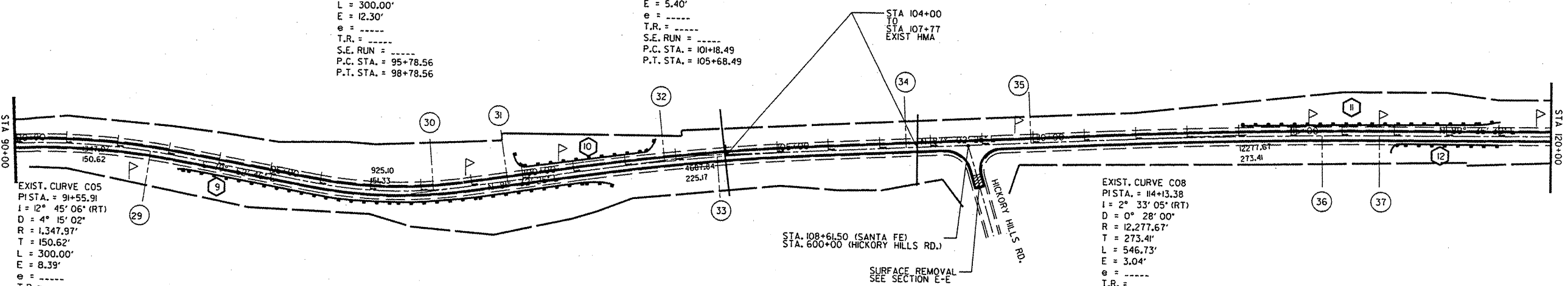

EXIST. CURVE C05  
 P.I.S.T.A. = 91+55.91  
 I = 12° 45' 06" (RT)  
 D = 4° 15' 02"  
 R = 1,347.97'  
 T = 150.62'  
 L = 300.00'  
 E = 8.39'  
 e = -----  
 T.R. = -----  
 S.E. RUN = -----  
 P.C. STA. = 90+05.29  
 P.T. STA. = 93+05.29

EXIST. CURVE C08  
 P.I.S.T.A. = 114+13.38  
 I = 2° 33' 05" (RT)  
 D = 0° 28' 00"  
 R = 12,277.67'  
 T = 273.41'  
 L = 546.73'  
 E = 3.04'  
 e = -----  
 T.R. = -----  
 S.E. RUN = -----  
 P.C. STA. = 111+39.97  
 P.T. STA. = 116+86.70

ENTRANCE #	TYPE	STATION	WIDTH (FT)	SURFACE
24	FIELD ENTRANCE	77+61 RT	18	AGG
25	FIELD ENTRANCE	82+17 LT	16	AGG
26	PRIVATE ENTRANCE	82+84 RT	17	AGG
27	FIELD ENTRANCE	86+47 RT	17	AGG
28	FIELD ENTRANCE	87+59 LT	17	AGG
29	PRIVATE ENTRANCE	92+66 RT	20	ASPH
30	PRIVATE ENTRANCE	98+23 LT	22	ASPH
31	PRIVATE ENTRANCE	99+70 LT	31	ASPH
32	PRIVATE ENTRANCE	102+77 LT	20	AGG
33	FIELD ENTRANCE	103+81 RT	24	AGG
34	FIELD ENTRANCE	107+52 LT	12	AGG

ENTRANCE #	TYPE	STATION	WIDTH (FT)	SURFACE
35	PRIVATE ENTRANCE	109+95 LT	12	AGG
36	PRIVATE ENTRANCE	115+61 RT	18	AGG
37	PRIVATE ENTRANCE	116+7 RT	18	AGG

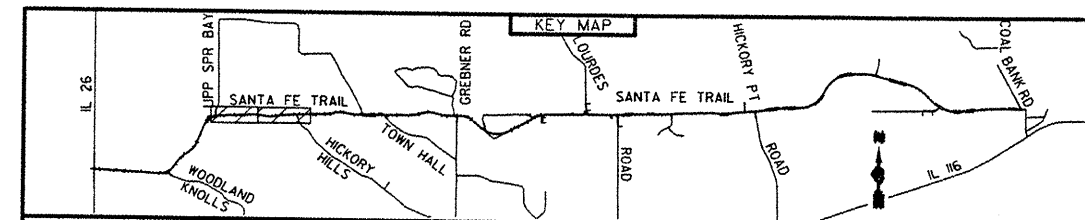

**WOODFORD COUNTY HIGHWAY DEPARTMENT**  
 DENNIS BACHMAN, P.E., COUNTY ENGINEER  
 301 S. Main St.  
 Roodock, IL 61561-0467  
 TEL: 309-923-2891  
 FAX: 309-923-7928

F.A.S. RTE. 2360  
 SECTION 04-00058-08-FP  
 SANTA FE TRAIL (C.H.#25)  
**PLAN SHEET**  
 SCALE: 1"=100'  
 DATE: 3/1/06  
 DRAWN BY: BJB  
 CHECKED BY: DDB