

F.A.S. RTE.	SECTION	COUNTY	TOTAL SHEETS	SHEET NO.
2360	04-00058-09-FP	WOODFORD	9	8
STA. 120+00		TO STA. 180+00		
FED. ROAD DIST. NO. 4	ILLINOIS	FED. AID PROJECT		

EXIST. CURVE C09
 P.I.S.T.A. = 121+87.86
 I = 11° 12' 45" (L.T.)
 D = 3° 44' 15"
 R = 1,533.00'
 T = 150.48'
 L = 300.00'
 E = 7.37'
 e = -----
 T.R. = -----
 S.E. RUN = -----
 P.C. STA. = 120+37.38
 P.T. STA. = 123+37.38

EXIST. CURVE C11
 P.I.S.T.A. = 132+65.91
 I = 12° 45' 00" (L.T.)
 D = 4° 15' 00"
 R = 1,348.14'
 T = 150.62'
 L = 300.00'
 E = 8.39'
 e = -----
 T.R. = -----
 S.E. RUN = -----
 P.C. STA. = 131+15.29
 P.T. STA. = 134+15.29

EXIST. CURVE C10
 P.I.S.T.A. = 127+07.06
 I = 22° 50' 11" (RT)
 D = 7° 30' 00"
 R = 763.94'
 T = 154.29'
 L = 304.48'
 E = 15.42'
 e = -----
 T.R. = -----
 S.E. RUN = -----
 P.C. STA. = 125+52.77
 P.T. STA. = 128+57.25

EXIST. CURVE C13
 P.I.S.T.A. = 164+87.61
 I = 26° 57' 48" (RT)
 D = 7° 30' 00"
 R = 763.94'
 T = 183.15'
 L = 359.51'
 E = 21.65'
 e = -----
 T.R. = -----
 S.E. RUN = -----
 P.C. STA. = 163+04.46
 P.T. STA. = 166+63.97

EXIST. CURVE C14
 P.I.S.T.A. = 171+79.78
 I = 13° 37' 55" (L.T.)
 D = 4° 30' 00"
 R = 1,273.24'
 T = 152.18'
 L = 302.93'
 E = 9.06'
 e = -----
 T.R. = -----
 S.E. RUN = -----
 P.C. STA. = 170+27.59
 P.T. STA. = 173+30.53

EXIST. CURVE C12
 P.I.S.T.A. = 157+97.43
 I = 12° 32' 23" (L.T.)
 D = 4° 00' 00"
 R = 1,432.40'
 T = 157.38'
 L = 313.49'
 E = 8.62'
 e = -----
 T.R. = -----
 S.E. RUN = -----
 P.C. STA. = 156+40.05
 P.T. STA. = 159+53.55

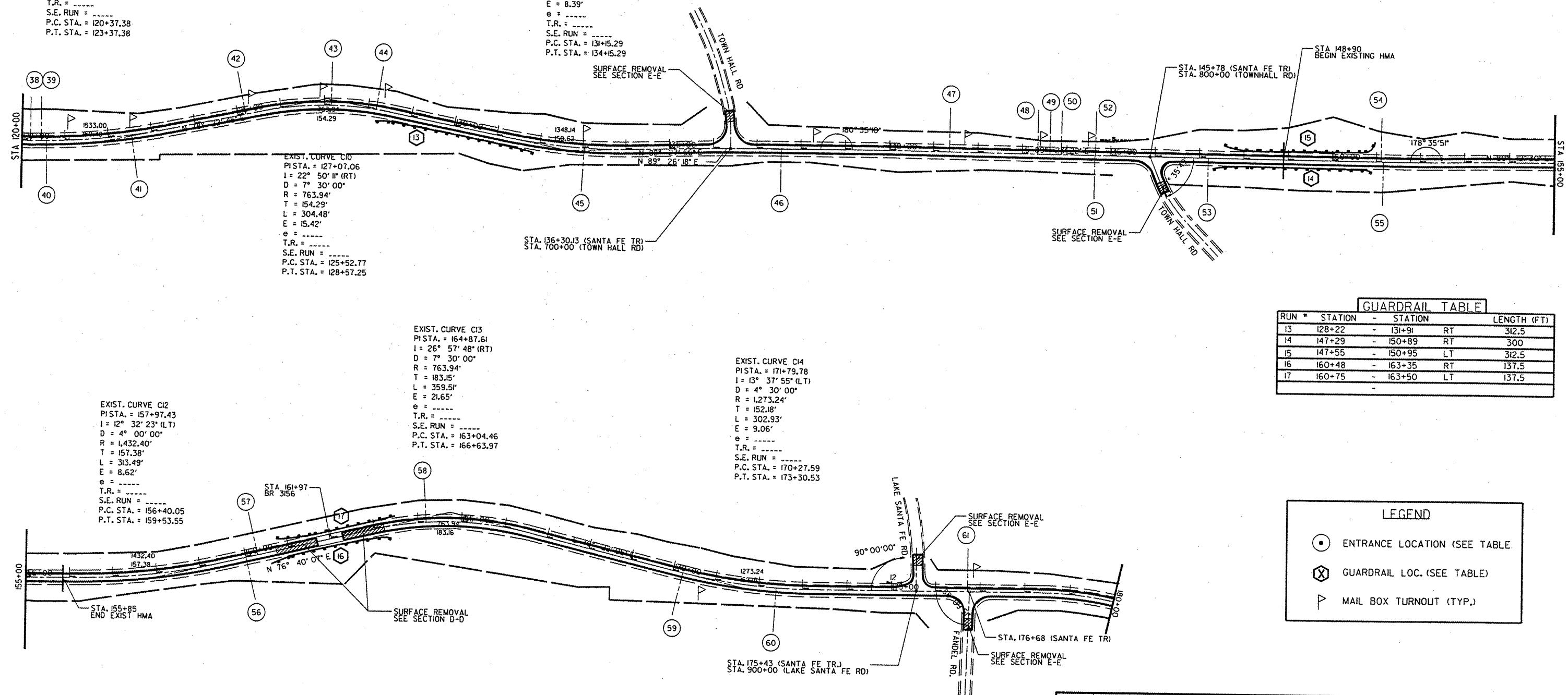

GUARDRAIL TABLE

RUN #	STATION	STATION	LENGTH (FT)
13	128+22	131+91	312.5
14	147+29	150+89	300
15	147+55	150+95	312.5
16	160+48	163+35	137.5
17	160+75	163+50	137.5

LEGEND

- ENTRANCE LOCATION (SEE TABLE)
- ⊗ GUARDRAIL LOC. (SEE TABLE)
- ⤴ MAIL BOX TURNOUT (TYP.)

ENTRANCE #	TYPE	STATION	WIDTH (FT)	SURFACE
38	PRIVATE ENTRANCE	120+21 LT	21	AGG
39	PRIVATE ENTRANCE	120+45 LT	21	AGG
40	PRIVATE ENTRANCE	120+58 RT	16	AGG
41	PRIVATE ENTRANCE	122+53 RT	40	ASPH
42	PRIVATE ENTRANCE	125+18 LT	12	ASPH
43	PRIVATE ENTRANCE	127+15 LT	14	ASPH
44	PRIVATE ENTRANCE	128+18 LT	13	ASPH
45	PRIVATE ENTRANCE	133+04 RT	26	AGG
46	PRIVATE ENTRANCE	137+55 RT	30	AGG
47	PRIVATE ENTRANCE	141+36 LT	14	ASPH
48	PRIVATE ENTRANCE	143+35 LT	12	AGG

ENTRANCE #	TYPE	STATION	WIDTH (FT)	SURFACE
49	PRIVATE ENTRANCE	143+63 LT	11	AGG
50	PRIVATE ENTRANCE	143+88 LT	13	ASPH
51	PRIVATE ENTRANCE	144+64 RT	13	CONC.
52	PRIVATE ENTRANCE	144+66 LT	23	AGG
53	FIELD ENTRANCE	147+20 RT	17	AGG
54	FIELD ENTRANCE	151+10 LT	18	AGG
55	FIELD ENTRANCE	151+16 RT	22	AGG
56	FIELD ENTRANCE	160+00 RT	16	AGG
57	FIELD ENTRANCE	160+28 LT	12	AGG
58	PRIVATE ENTRANCE	164+18 LT	15	AGG
59	PRIVATE ENTRANCE	170+23 RT	30	ASPH

ENTRANCE #	TYPE	STATION	WIDTH (FT)	SURFACE
60	FIELD ENTRANCE	172+40 RT	12	AGG
61	PRIVATE ENTRANCE	176+72 LT	15	ASPH

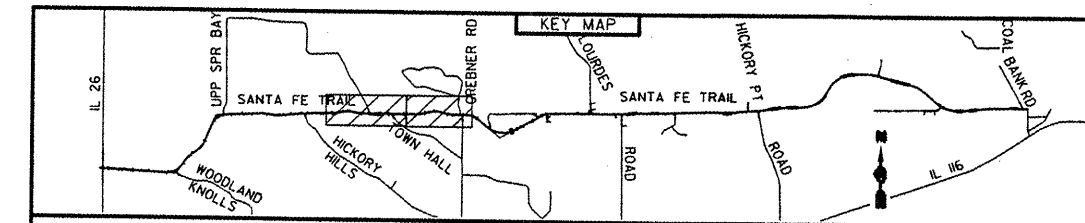

WOODFORD COUNTY HIGHWAY DEPARTMENT
 DENNIS BACHMAN, P.E., COUNTY ENGINEER
 301 S. Main St.
 Roanoke, IL 61561-0467
 TEL: 309-923-2891
 FAX: 309-923-7928

F.A.S. RTE. 2360
 SECTION 04-00058-08-FP
 SANTA FE TRAIL (C.H.#25)

PLAN SHEET
 SCALE: 1"=100'
 DATE 3/1/06
 DRAWN BY: BJH
 CHECKED BY: DNR