

F.A.S. RTE.	SECTION	COUNTY	TOTAL SHEETS	SHEET NO.
2360	04-00058-09-FP	WOODFORD	9	1

**INDEX OF SHEETS**

SHEET NO.	DESCRIPTION
1	COVER SHEET
2	SCHEDULE OF QUANTITIES
3	PROPOSED TYPICAL SECTIONS
4	DETAIL SHEET
5	MISC DETAIL
6-9	PLAN SHEETS

**IDOT HIGHWAY STANDARDS**

- 000001-05 STANDARD SYMBOLS, ABBREVIATIONS AND PATTERNS
- 630001-07 STEEL PLATE BEAM GUARDRAIL
- 631011-04 TRAFFIC BARRIER TERMINAL, TY. 2
- 635006-02 REFLECTOR AND TERMINAL MARKER PLACEMENT
- 635011-01 REFLECTOR MARKER AND MOUNTING DETAILS
- 701006-02 OFF ROAD OPERATIONS, 2L, 2W, 15' TO 24' FROM EDGE OF PAVEMENT
- 701201-02 LANE CLOSURE, 2L, 2W, DAY ONLY, FOR SPEEDS >=45MPH
- 701301-02 LANE CLOSURE, 2L, 2W, SHORT TIME OPERATION
- 701306-01 LANE CLOSURE, 2L, 2W, SLOW MOVING OPERATION, DAY ONLY, >=45 MPH
- 701901 TRAFFIC CONTROL DEVICES
- 781001-02 TYPICAL APPLICATION, RAISED REFLECTIVE PAVEMENT MARKINGS
- BLR22-5 TYPICAL APPLICATION OF TRAFFIC CONTROL DEVICES FOR CONSTRUCTION ON RURAL LOCAL HIGHWAYS
- BLR 23-2 TRAFFIC BARR. TERMINAL, TY 1
- BLR 24-1 MAIL BOX TURNOUT FOR LOCAL ROADS
- BLR 26 STEEL PLATE BEAM GURAD RAIL
- BLR 27 TRAFFIC BARRIER TERMINAL, TY 5A

STATE OF ILLINOIS  
DEPARTMENT OF TRANSPORTATION  
DIVISION OF HIGHWAYS  
**PLANS FOR PROPOSED  
LOCAL AGENCY IMPROVEMENT  
FEDERAL-AID SECONDARY PROJECT**

STU PROGRAM  
F.A.S. ROUTE 2360 (SANTA FE TRAIL)  
COUNTY HIGHWAY #25  
PROJECT NO. M-5093(134)  
JOB NO. C-94-043-08  
SECTION 04-00058-09-FP  
WOODFORD COUNTY

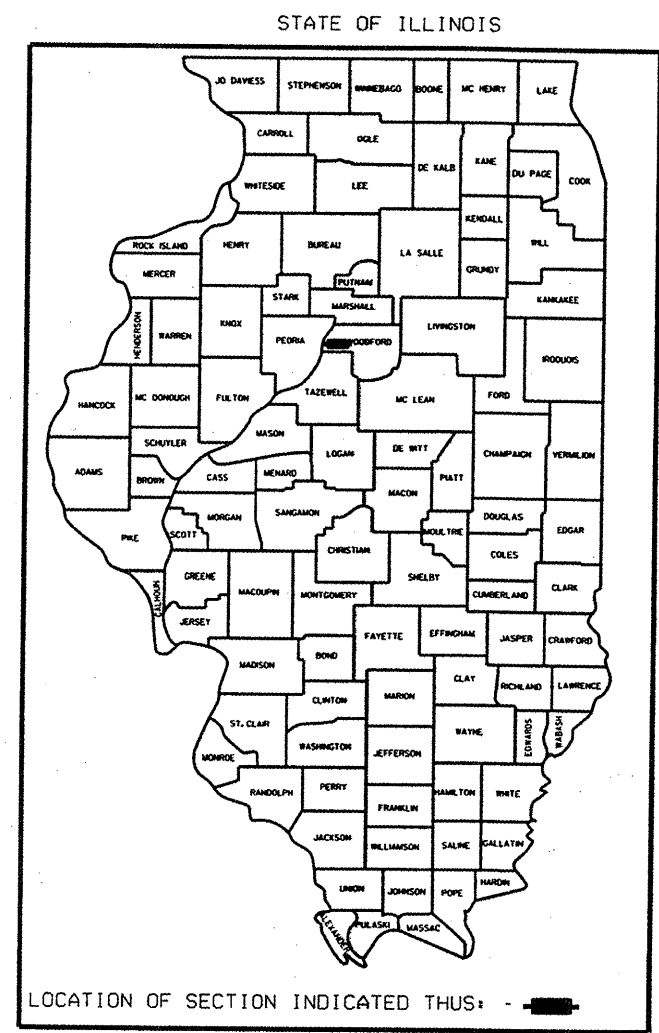

**SUMMARY OF QUANTITIES**

ITEM #	DESCRIPTION	UNIT	QUANTITY
40200800	AGGREGATE SURFACE COURSE, TY. B	TON	976
40600100	BITUMINOUS MATERIALS (PRIME COAT)	GALLON	3,122
40600300	AGGREGATE (PRIME COAT)	TON	71
40600895	CONSTRUCTING TEST STRIP	EACH	3
40600892	HOT-MIX ASPHALT SURFACE REMOVAL- BUTT JOINT	SO YD	1,999
40600990	TEMPORARY RAMP	SO YD	192
40603080	HOT-MIX ASPHALT BINDER COURSE, IL 19.0, N50	TON	6,767
40603310	HOT-MIX ASPHALT SURFACE COUSE, MIX "C", N50	TON	4,287
40603510	POLYMERIZED HOT-MIX ASPHALT SURFACE COURSE, MIX "C", N50	TON	4,034
# 4080050	INCIDENTAL HOT-MIX ASPHALT SURFACING	TON	335
48101200	AGGREGATE SHOULDERS, TY. B	TON	6,228
# 63301210	REMOVE AND RE-ERECT STEEL PLATE BEAM GUARDRAIL, TY. A	FOOT	5,587.5
# 63301990	REMOVE AND RE-ERECT TRAFFIC BARRIER TERMINAL, TY 1	EACH	29
# 63302000	REMOVE AND RE-ERECT TRAFFIC BARRIER TERMINAL, TY 2	EACH	6
# 63302500	REMOVE AND RE-ERECT TRAFFIC BARRIER TERMINAL, TY. 5 A	EACH	4
67100100	MOBILIZATION	L SUM	1
# 70100460	TRAFFIC CONTROL AND PROTECTION, STANDARD 701306	L SUM	1
70300100	SHORT-TERM PAVEMENT MARKINGS	FOOT	6,747
70301000	WORK ZONE PAVEMENT MARKING REMOVAL	SO FT	2,249
* 78100100	RAISED REFLECTIVE PAVEMENT MARKER	EACH	280
* 78200455	BIDIRECTIONAL GUARD RAIL REFLECTORS	EACH	76

# SEE SPECIAL PROVISIONS  
\* SPECIALTY ITEM

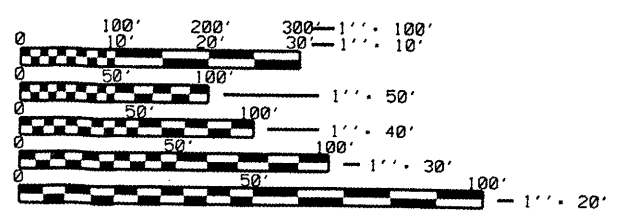

FULL SIZE PLANS HAVE BEEN PREPARED USING STANDARD ENGINEERING SCALES. REDUCED SIZED PLANS WILL NOT CONFORM TO STANDARD SCALES. IN MAKING MEASUREMENTS ON REDUCED PLANS, THE ABOVE SCALES MAY BE USED.

J.U.L.I.E.  
JOINT UTILITY LOCATION INFORMATION FOR EXCAVATION  
1-800-892-0123

CONTRACT NO. 89489

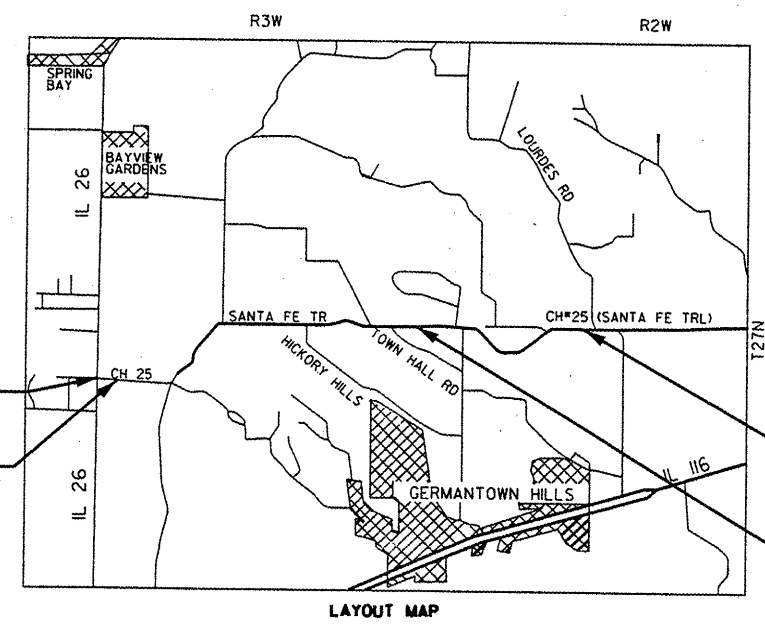
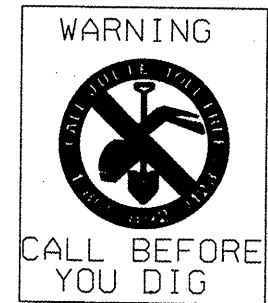

BEGIN IMPROVEMENT  
STA. 10+12

BRIDGE OMISSION  
STA. 19+91

**OMMISSIONS**

BRIDGE OMISSION (STRUCTURE # 102-3061)  
STA. 19+91 TO STA. 20+64, 73 FEET

BRIDGE OMISSION (STRUCTURE # 102-3156)  
STA. 161+66 TO STA. 162+28, 62 FEET

END IMPROVEMENT  
STA. 235+00

BRIDGE OMISSION  
STA. 161+97

**DESIGN INFORMATION:**

LOCAL ROADS FUNCTIONAL CLASS:  
MAJOR COLLECTOR  
2018 ADT = 1820 (7% TRUCKS)  
DESIGN SPEED: 40 MPH  
DESIGN GUIDELINES: URBAN  
VARIANCES GRANTED: NONE  
COMMITMENTS: NONE



IMPROVEMENT CONSISTS OF THE CONSTRUCTION OF BITUMINOUS CONCRETE BINDER AND SURFACE COURSE OVER AN EXISTING OIL & CHIP ROADWAY, INCLUDING PROPOSED AGGREGATE SHOULDERS AND REMOVAL AND RE-ERECTION OF GUARDRAIL AND TERMINALS.

GROSS LENGTH OF SECTION 22,488 FT.  
NET LENGTH OF SECTION = 22,353 FT. (4.23 MI)

UTILITIES  
(TO BE DETERMINED)

APPROVED March 19 20 08  
Dennis Bachman  
COUNTY ENGINEER

PASSED March 24 20 08  
Dennis Bachman  
DISTRICT FOUR ENGINEER OF  
LOCAL ROADS & STREETS

Releasing For  
Bid Based on  
Limited Review

March 24 20 08  
Joseph E. Crowe  
DEPUTY DIRECTOR OF HIGHWAYS,  
REGION THREE ENGINEER

STATE OF ILLINOIS  
DEPARTMENT OF TRANSPORTATION

PLANS DEVELOPED IN ACCORDANCE WITH  
THE IDOT LOCAL ROADS MANUAL (APRIL 2005)

THESE PLANS HAVE BEEN PREPARED BY OR UNDER THE DIRECTION OF:

DATE: March 19, 2008

SIGNED: Dennis Bachman

LICENSE EXPIRES: NOVEMBER 30, 2009

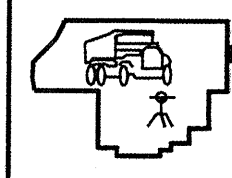
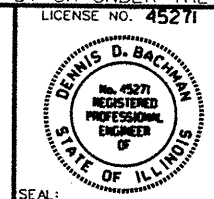

**WOODFORD COUNTY  
HIGHWAY DEPARTMENT**

DENNIS BACHMAN, P.E., COUNTY ENGINEER  
301 S. Main St.  
Raanoke, IL 61561  
TEL: 309-923-2891  
FAX: 309-923-7928

PRINTED BY THE AUTHORITY OF THE STATE OF ILLINOIS

Table with 6 columns: ENTRANCE #, TYPE, STATION, WIDTH (FT), SURFACE, 40200800 AGG SURFACE COURSE, TY B TOTAL (TONS), 40800040 INCIDENTAL BIT SURFACING TOTAL (TONS). Rows 1-39 detailing entrance types and materials.

Table with 6 columns: Station, Description, Length (ft), Material, Tons, Notes. Rows 40-84 detailing materials and quantities for various entrance types.

Summary table for HMA materials. Columns: STATION TO STATION, LENGTH (FT), TONS. Rows for 4060350 POLYMERIZED HMA, 4060330 HMA SURFACE, and 40603080 HMA BINDER. Includes sub-totals for intersections and total usage.

Summary table for Aggregate and Bituminous materials. Columns: STATION TO STATION, LENGTH (FT), GALLONS, TONS. Rows for 4060000 BITUMINOUS MATERIALS and 40600300 AGGREGATE (PRIME COAT).

Table for traffic control measures. Columns: RUN #, STATION, TYPE A, TYPE B, TYPE C, TYPE D, REFLECTORS. Rows 1-20 detailing stationing and material requirements for various traffic control types.

Table for Bituminous Surface Removal. Columns: STATION TO STATION, AREA (SY). Rows detailing removal areas for butt joints and temporary ramps.

Table for Aggregate Shoulders. Columns: STATION TO STATION, LENGTH (FT), TOTAL TONS. Rows detailing shoulder material requirements for various stationing.

Table for Pavement Markings. Columns: STATION TO STATION, SPACING, Applications. Rows detailing marking requirements for short-term and work zone applications.

WOODFORD COUNTY HIGHWAY DEPARTMENT  
DENNIS BACHMAN, P.E., COUNTY ENGINEER  
301 S. Main St.,  
Rockton, IL 61561-0467  
TEL: 309-923-2891  
FAX: 309-923-7928

F. A. S. RTE. 2360  
SECTION 04-00058-09-FP  
SANTA FE TRAIL (C. H. #25)  
SCALE: DATE: 1/25/08  
DRAWN BY: BJH  
CHECKED BY: DDB

FILE NAME: TABLES  
DATE: 1/25/08  
DDB

F.A.S. RTE.	SECTION	COUNTY	TOTAL SHEETS	SHEET NO.
2360	04-00058-09-FP	WOODFORD	9	3
STA. 10+12 TO STA. 235+00		FED. ROAD DIST. NO. 4 ILLINOIS FED. AID PROJECT		

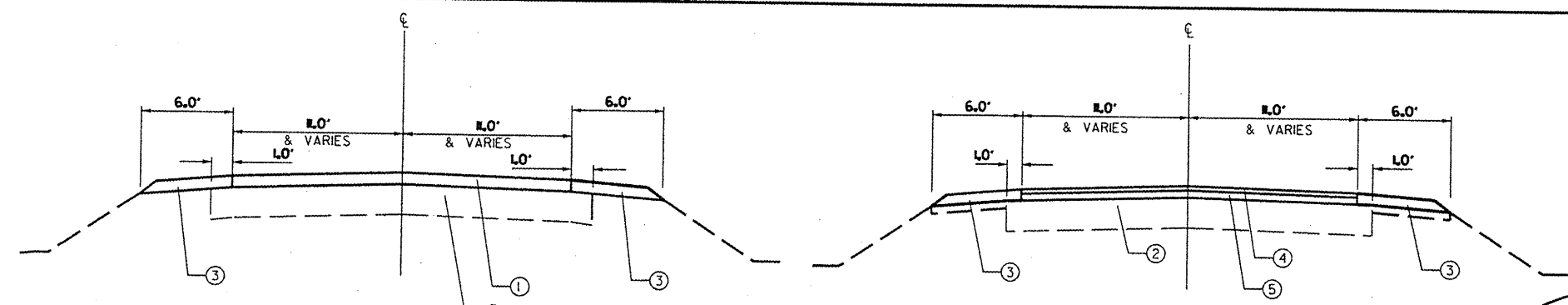

EXISTING TYPICAL SECTION  
SANTA FE TRAIL (C.H. #25)  
(Oil and Chip)

EXISTING TYPICAL SECTION  
SANTA FE TRAIL (C.H. #25)  
(HMA)

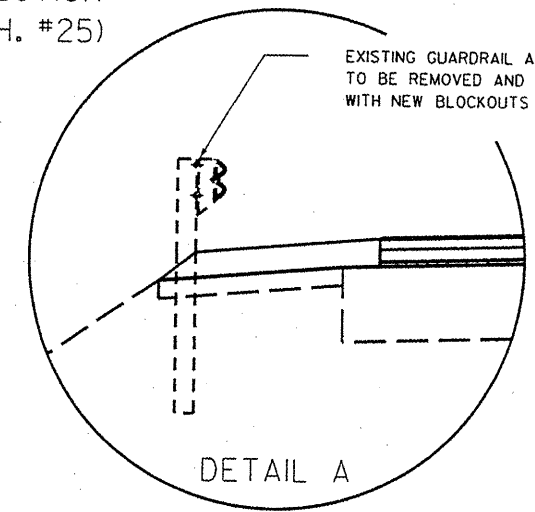

DETAIL A

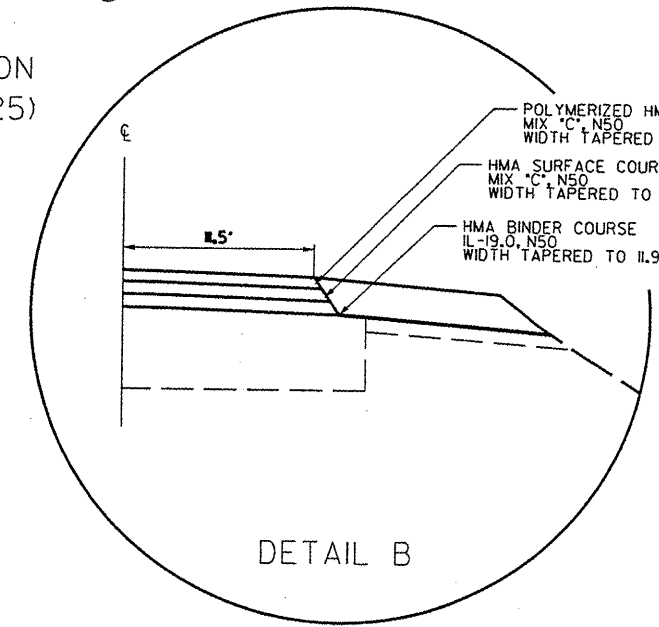

DETAIL B

- ① EXISTING BITUMUNIOUS A-3 SURFACE
- ② EXISTING AGGREGATE BASE COURSE- 12' & VARIES
- ③ EXISTING AGGREGATE SHOULDERS
- ④ EXISTING BITUMUNIOUS SURFACE COURSE- 2' & VARIES
- ⑤ EXISTING BITUMUNIOUS BINDER COURSE- 2' & VARIES
- ⑥ POLYMERIZED HOT-MIX ASPHALT SURFACE COURSE, MIX 'C', N50, 1 1/4"
- ⑦ HOT-MIX ASPHALT SURFACE COURSE, MIX 'C', N50, 1 1/4"
- ⑧ HOT-MIX ASPHALT BINDER COURSE, IL-19.0, N50, 2 1/4"
- ⑨ AGGREGATE SHOULDERS, TY B - 2 1/2'
- ⑩ AGGREGATE SHOULDERS, TY B - 4 3/4'

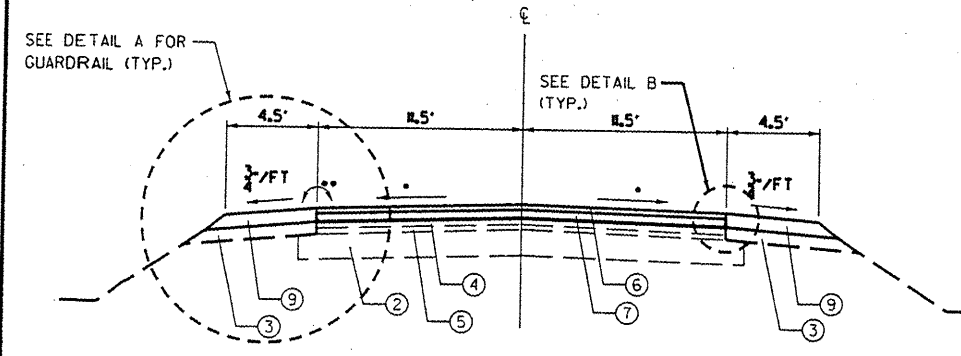

PROPOSED TYPICAL SECTION  
SANTA FE TRAIL (C.H. #25)  
(over existing HMA)

STA 10+12 TO STA 19+91  
STA 20+64 TO STA 36+00

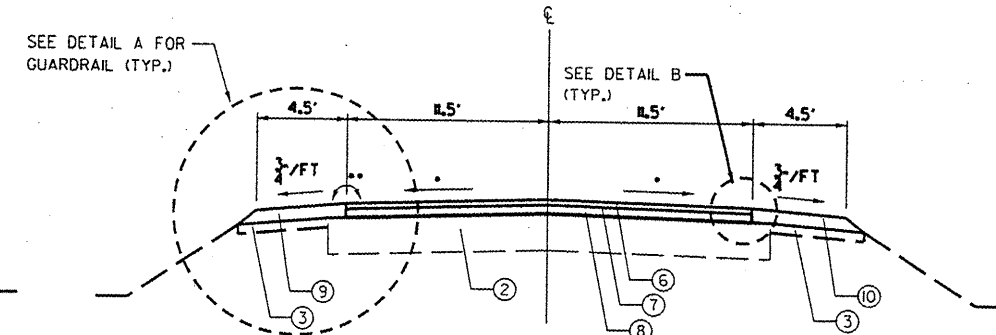

PROPOSED TYPICAL SECTION  
SANTA FE TRAIL (C.H. #25)

STA 53+00 TO STA 68+69  
STA 77+74 TO STA 104+00  
STA 107+77 TO STA 148+90  
STA 155+85 TO STA 235+00

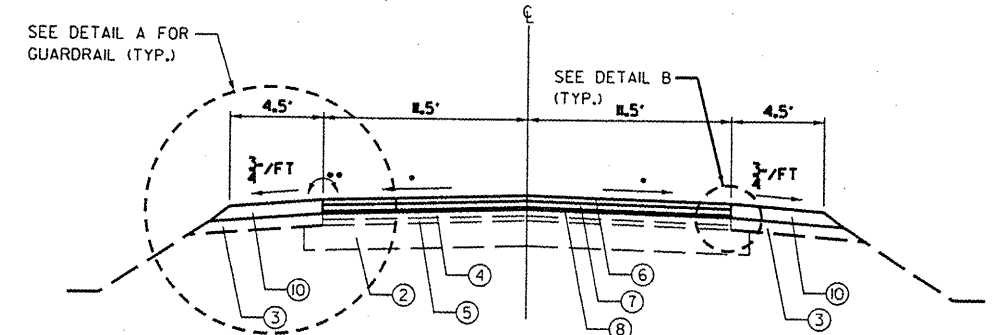

PROPOSED TYPICAL SECTION  
SANTA FE TRAIL (C.H. #25)  
(over existing HMA)

STA 36+00 TO STA 53+00  
STA 68+69 TO STA 77+74  
STA 104+00 TO STA 107+77  
STA 148+90 TO STA 155+85

STRUCTURAL DESIGN TRAFFIC: YEAR 2018  
PV = 1693 SU = 109 MU = 18 AADT=1820

ROAD/STREET CLASSIFICATION: CLASS III

PERCENT OF STRUCTURAL DESIGN TRAFFIC IN DESIGN LANE:  
P = 93% S = 6% M = 1%

TRAFFIC FACTOR: ACTUAL TF = 0.19  
MIN TF = N/A

PG GRADE: BINDER = PG 58-22  
SURFACE = PG 64-28  
SURFACE = SBS\_PG 64-28

SUBGRADE SUPPORT RATING: SSR = N/A

MIX DESIGN	BINDER	SURFACE	POLY. SURFACE	INCIDENTAL
PG:	PG 58-22	PG 64-28	SBS 64-28	PG 64-28
RAP (%max)	25%	10%	10%	10%
DESIGN AIR VOIDS	4%	4%	4%	4%
GRADATION MIXTURE	IL-19.0	IL-9.5	IL-9.5	IL-9.5
FRICTION AGGREGATE	-	-	-	-
N DESIGN	N50	N50	N50	N50

WOODFORD COUNTY  
HIGHWAY DEPARTMENT

DENNIS BACHMAN, P.E., COUNTY ENGINEER  
301 S. Main St., P.O. Box 467  
Roanoke, IL 61561-0467  
TEL: 309-923-2891  
FAX: 309-923-7928

F. A. S. RTE. 2360  
SECTION 04-00058-09-FP  
SANTA FE TRAIL (C.H. #25)

PROPOSED  
TYPICAL SECTION

SCALE: 1"=5'  
DATE: 1/25/08

DRAWN BY: BJH  
CHECKED BY: DDB

PLOT SCALE: 1"=5'

F.A.S. RTE.	SECTION	COUNTY	TOTAL SHEETS	SHEET NO.
2360	D4-00058-09-FP	WOODFORD	9	4
STA.		TO STA.		
FED. ROAD DIST. NO. 4		ILLINOIS FED. AID PROJECT		

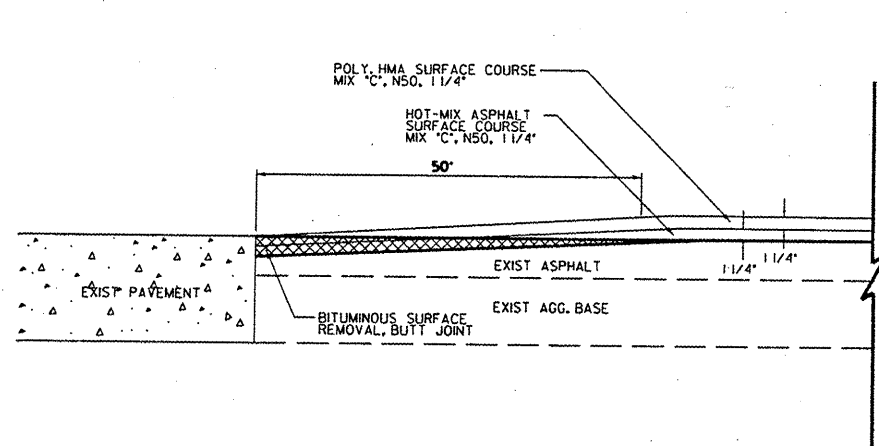

**SECTION A-A**  
TYPICAL BUTT-JOINT DETAIL  
STATION 10+12

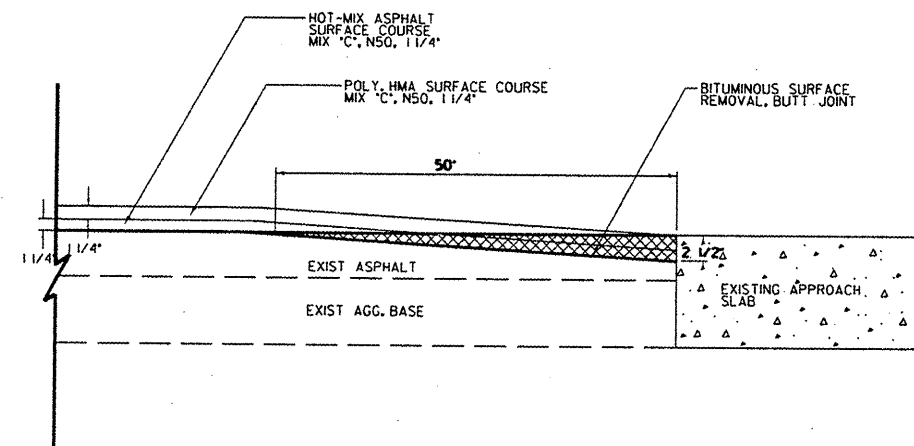

**SECTION B-B**  
TYPICAL BUTT-JOINT DETAIL  
BRIDGE APPROACH  
STA. 19+91  
STA. 20+64

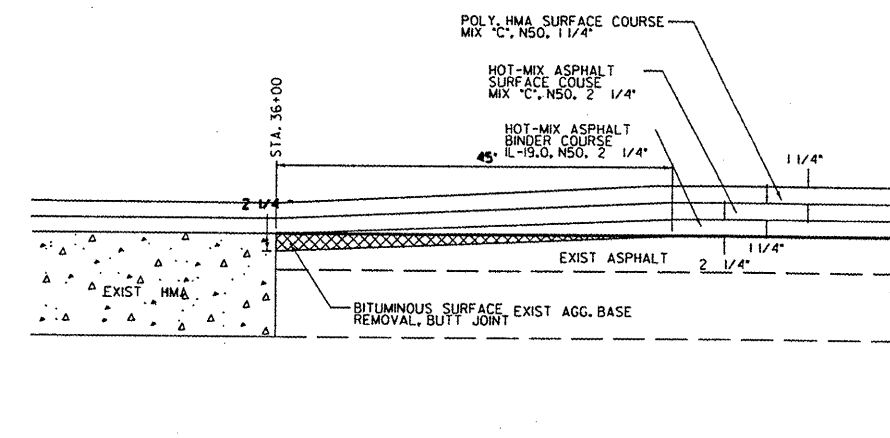

**SECTION C-C**  
START OF HMA BINDER COURSE  
STA. 36+00

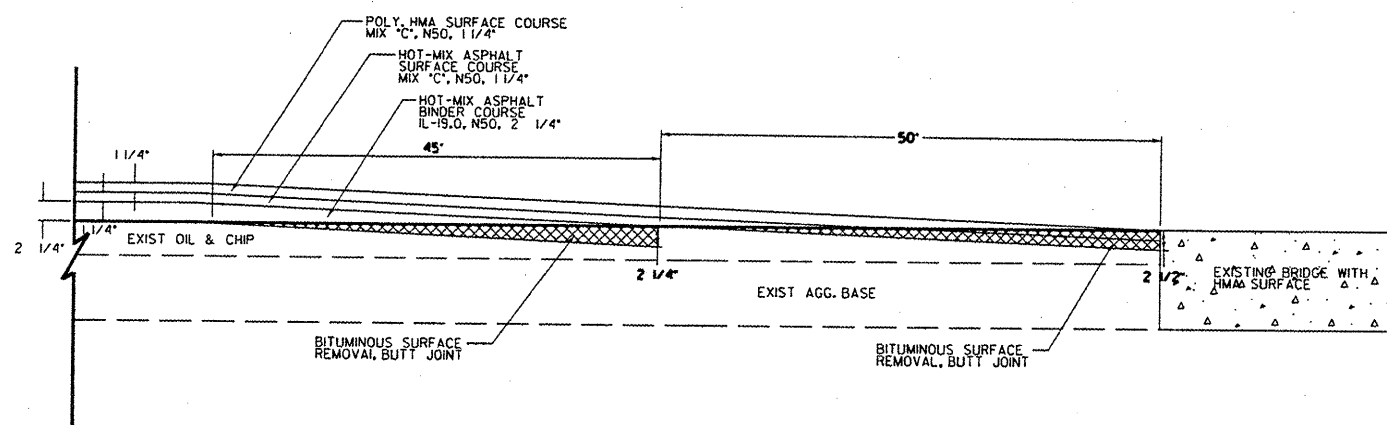

**SECTION D-D**  
TYPICAL BUTT JOINT DETAIL  
BRIDGE APPROACH  
STA. 161+66  
STA. 162+28

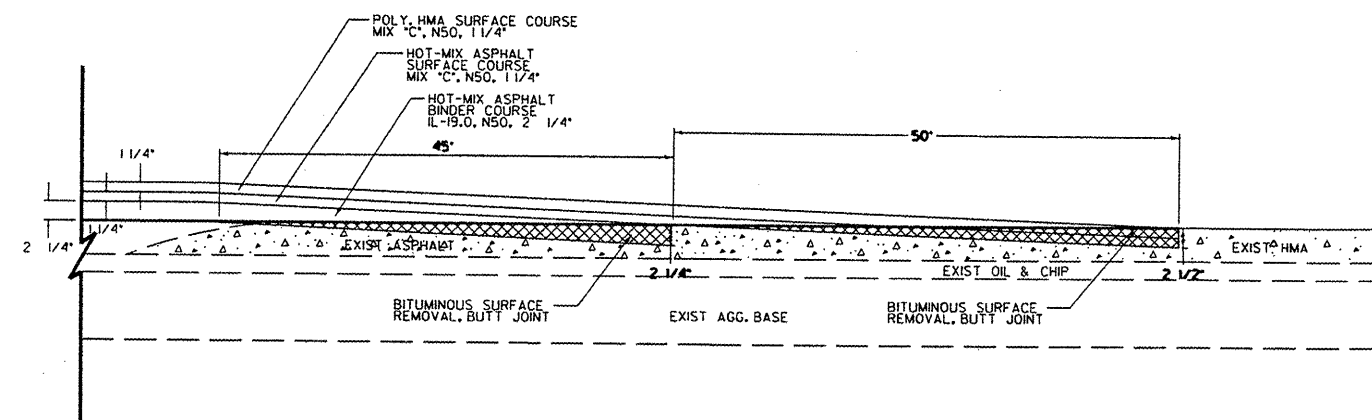

**SECTION F-F**  
TYPICAL BUTT JOINT DETAIL  
STA. 235+00  
END OF IMPROVEMENT

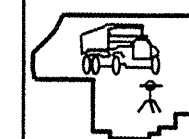

WOODFORD COUNTY  
HIGHWAY DEPARTMENT  
DENNIS BACHMAN, P.E., COUNTY ENGINEER  
301 S. Main St., P.O. Box 467  
Roopeke, IL 61561-0467  
TEL: 309-923-2891  
FAX: 309-923-7928

F. A. S. RTE. 2360  
SECTION 04-00058-09-FP  
SANTA FE TRAIL (C. H. #25)  
BUTT JOINT  
DETAIL  
SCALE: 1"=5'  
DATE: 1/25/08  
DRAWN BY: BJB  
CHECKED BY: DDB

FILE NAME: 081115  
PLOT SCALE: 1"=5'  
USER NAME: BJB

F.A.S. RTE.	SECTION	COUNTY	TOTAL SHEETS	SHEET NO.
2360	04-00058-09-FP	WOODFORD	9	5
STA.		TO STA.		
FED. ROAD DIST. NO. 4	ILLINOIS	FED. AID PROJECT		

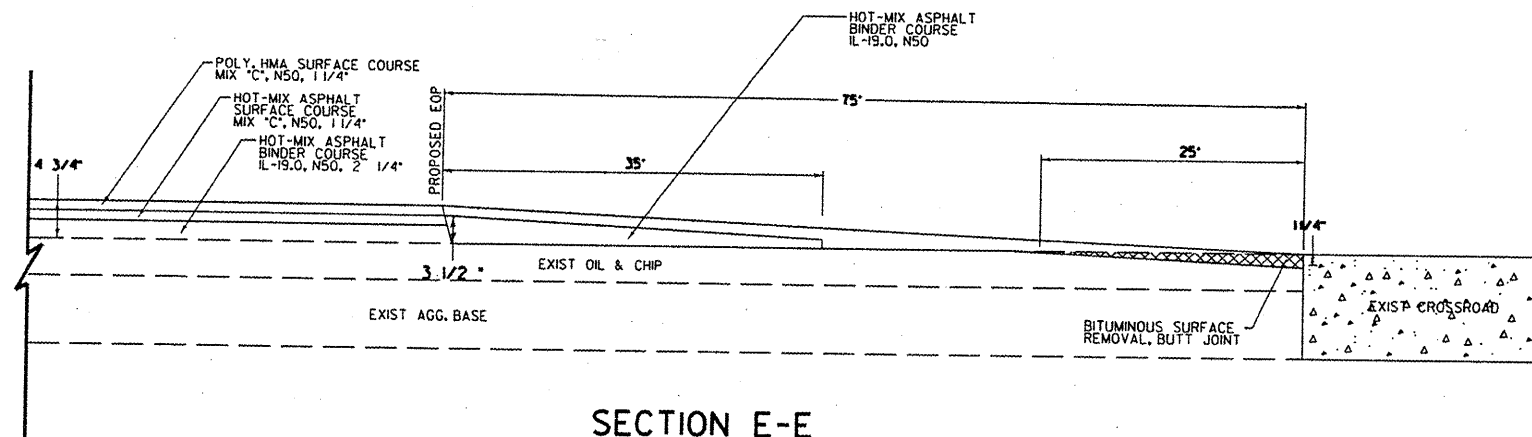

**SECTION E-E**  
TYPICAL BUTT JOINT DETAIL  
INTERSECTIONS  
9 TO BE CONSTRUCTED

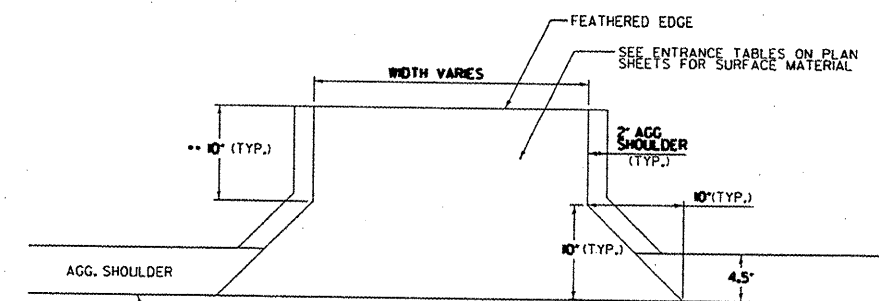

**ENTRANCE DETAIL**

\*\* THICKNESS OF SURFACE MATERIAL TO BE FEATHERED FOR LAST 10' TO MATCH EXISTING SURFACE

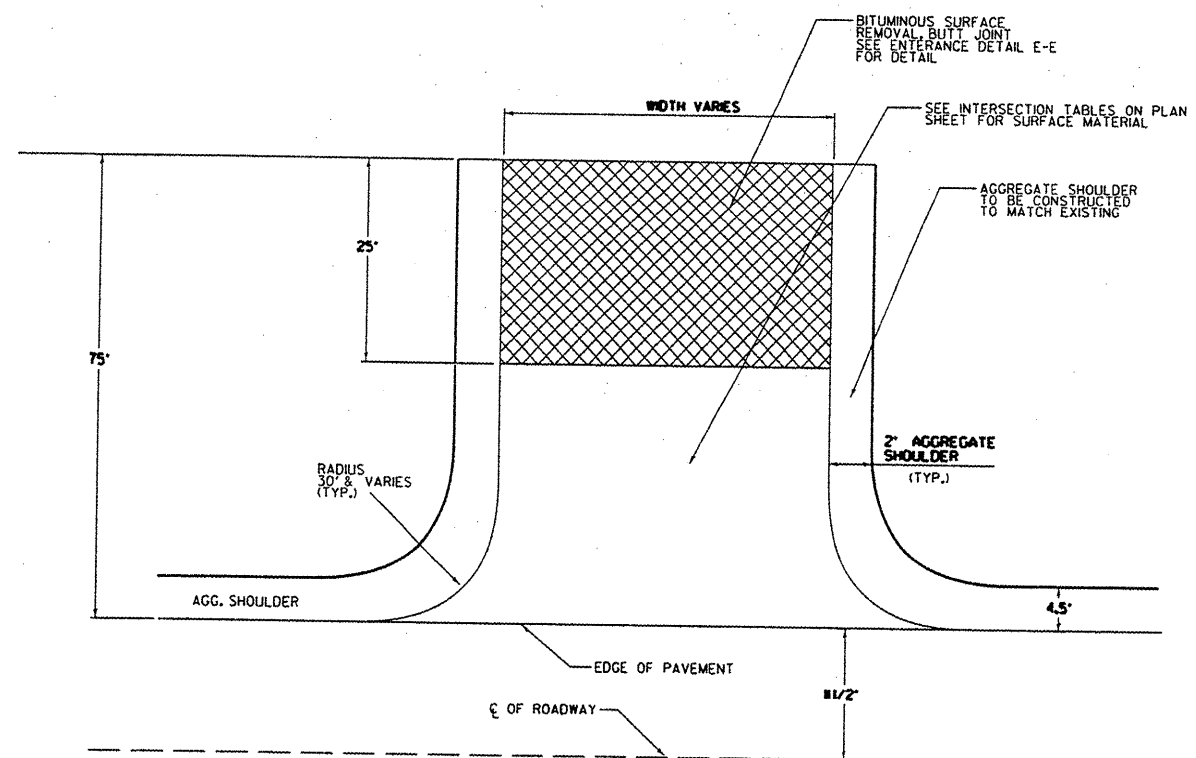

**INTERSECTION DETAIL**

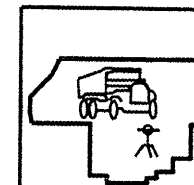

WOODFORD COUNTY  
HIGHWAY DEPARTMENT  
DENNIS BACHMAN, P.E., COUNTY ENGINEER  
301 S. Main St., P.O. Box 467  
RoaNoke, IL 61561-0467  
TEL: 309-923-2891  
FAX: 309-923-7928

F. A. S. RTE. 2360  
SECTION 04-00058-09-FP  
SANTA FE TRAIL (C.H. #25)

**MISC. DETAIL**

SCALE: 1"=5'  
DATE: 1/25/08

DRAWN BY: Bjh  
CHECKED BY: ODB

CONTRACT NO. 89489				
F.A.S. RTE.	SECTION	COUNTY	TOTAL SHEETS	SHEET NO.
2360	04-00058-09-FP	WOODFORD	9	6
STA. 10+12		TO STA. 70+00		
FED. ROAD DIST. NO. 4		ILLINOIS	FED. AID PROJECT	

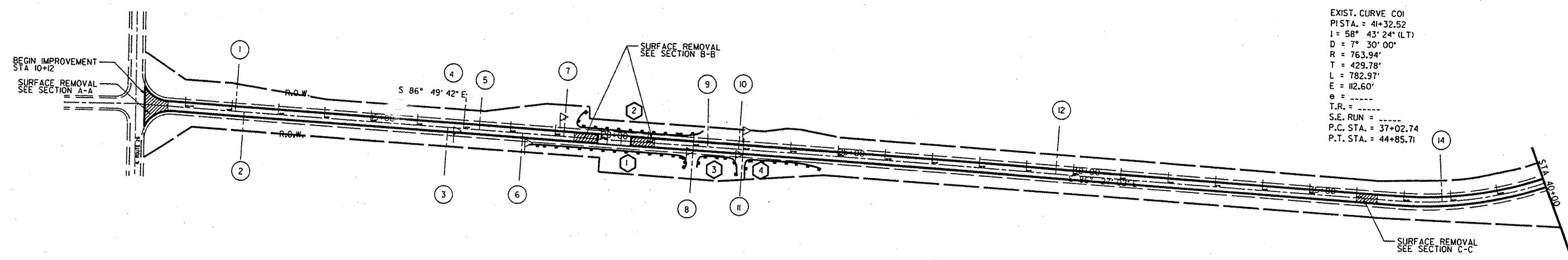

EXIST. CURVE C01  
 P.I.S.T.A. = 41+32.52  
 I = 58° 43' 24" (LT)  
 D = 7° 30' 00"  
 R = 763.94'  
 T = 429.78'  
 L = 782.97'  
 E = 112.60'  
 e = -----  
 T.R. = -----  
 S.E. RUN = -----  
 P.C. STA. = 37+02.74  
 P.T. STA. = 44+85.71

**LEGEND**

- ENTRANCE LOCATION (SEE TABLE)
- ⊗ GUARDRAIL LOC. (SEE TABLE)
- ⏏ MAIL BOX TURNOUT (TYP.)

**GUARDRAIL TABLE**

RUN #	STATION -	STATION	LENGTH (FT)
1	18+40	21+82 RT	237.5
2	19+47	22+21 LT	150
3	22+09	22+94 RT	137.5
4	23+06	24+66 RT	150
5	65+06	68+88 RT	325
6	66+07	69+48 LT	300

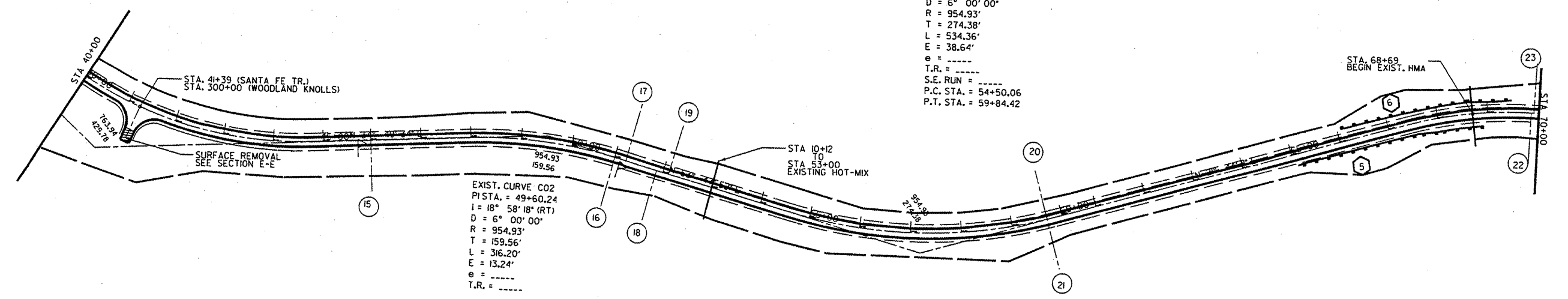

EXIST. CURVE C03  
 P.I.S.T.A. = 57+24.44  
 I = 32° 03' 4" (LT)  
 D = 6° 00' 00"  
 R = 954.93'  
 T = 274.38'  
 L = 534.36'  
 E = 38.64'  
 e = -----  
 T.R. = -----  
 S.E. RUN = -----  
 P.C. STA. = 54+50.06  
 P.T. STA. = 59+84.42

EXIST. CURVE C02  
 P.I.S.T.A. = 49+60.24  
 I = 18° 58' 18" (RT)  
 D = 6° 00' 00"  
 R = 954.93'  
 T = 159.56'  
 L = 316.20'  
 E = 13.24'  
 e = -----  
 T.R. = -----

ENTRANCE#	TYPE	STATION	WIDTH (FT)	SURFACE
1	FIELD ENTRANCE	12+08 LT	19	AGG
2	COMMERCIAL ENTRANCE	12+26 RT	30	ASPH
3	PRIVATE ENTRANCE	16+66 RT	28	AGG
4	FIELD ENTRANCE	17+00 LT	21	AGG
5	PRIVATE ENTRANCE	17+32 LT	10	AGG
6	PRIVATE ENTRANCE	18+25 RT	16	AGG
7	PRIVATE ENTRANCE	19+19 LT	13	AGG
8	PRIVATE ENTRANCE	22+00 RT	14	AGG
9	FIELD ENTRANCE	22+30 LT	17	AGG
10	PRIVATE ENTRANCE	22+97 LT	15	AGG

ENTRANCE#	TYPE	STATION	WIDTH (FT)	SURFACE
11	PRIVATE ENTRANCE	23+00 RT	9	AGG
12	FIELD ENTRANCE	29+63 LT	25	AGG
13	FIELD ENTRANCE	37+20 RT	16	AGG
14	FIELD ENTRANCE	37+80 LT	20	AGG
15	PRIVATE ENTRANCE	46+00 RT	14	ASPH
16	PRIVATE ENTRANCE	51+00 RT	40	ASPH
17	FIELD ENTRANCE	51+23 LT	23	AGG
18	FIELD ENTRANCE	51+86 RT	33	AGG
19	COMMERCIAL ENTRANCE	52+11 LT	30	AGG
20	FIELD ENTRANCE	59+70 LT	21	AGG

ENTRANCE#	TYPE	STATION	WIDTH (FT)	SURFACE
21	FIELD ENTRANCE	59+70 RT	22	AGG
22	FIELD ENTRANCE	69+85 RT	13	AGG
23	FIELD ENTRANCE	69+90 LT	21	AGG

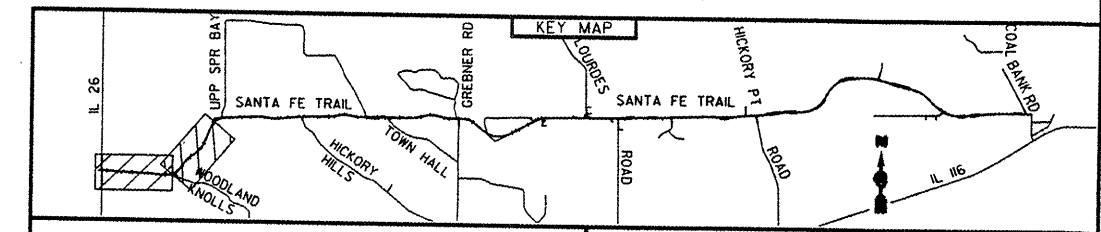

**WOODFORD COUNTY HIGHWAY DEPARTMENT**  
 DENNIS BACHMAN, P.E., COUNTY ENGINEER  
 301 S. Main St.  
 Roanoke, IL 61561-0467  
 TEL: 309-923-2891  
 FAX: 309-923-7928

F.A.S. RTE. 2360  
 SECTION 04-00058-08-FP  
 SANTA FE TRAIL (C.H.#25)  
**PLAN SHEET**  
 SCALE: 1"=100'  
 DATE: 1/31/08  
 DRAWN BY: BJH  
 CHECKED BY: DDB

F.A.S. RTE.	SECTION	COUNTY	TOTAL SHEETS	SHEET NO.
2360	04-00058-09-FP	WOODFORD	9	7
STA. 70+00		TO STA. 120+00		
FED. ROAD DIST. NO. 4		ILLINOIS	FED. AID PROJECT	

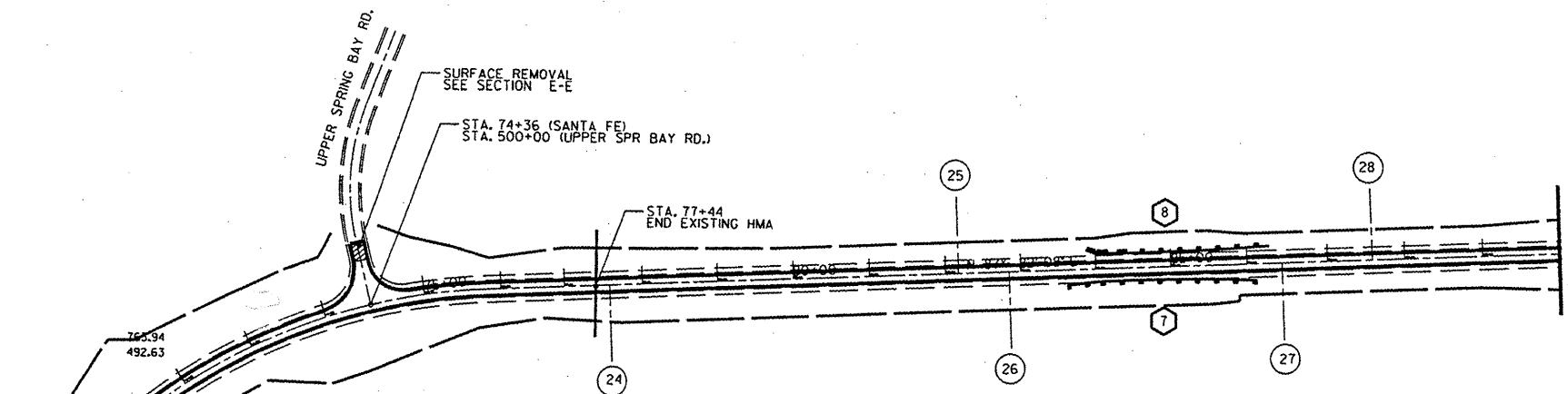

EXIST. CURVE C04  
 P.I. STA. = 72+01.59  
 I = 65° 37' 57" (RT)  
 D = 7° 30' 00"  
 R = 763.94'  
 T = 492.63'  
 L = 875.10'  
 E = 145.07'  
 e = -----  
 T.R. = -----  
 S.E. RUN = -----  
 P.C. STA. = 67+08.96  
 P.T. STA. = 75+84.05

**LEGEND**

- ENTRANCE LOCATION (SEE TABLE)
- ⊗ GUARDRAIL LOC. (SEE TABLE)
- ▷ MAIL BOX TURNOUT (TYP.)

**GUARDRAIL TABLE**

RUN #	STATION -	STATION	LENGTH (FT)
7	83+61 -	86+12 RT	200
8	83+88 -	86+31 LT	187.5
9	93+23 -	101+71 RT	800
10	99+85 -	102+66 LT	287.5
11	114+05 -	119+05 LT	462.5
12	116+91 -	118+98 RT	187.5

EXIST. CURVE C06  
 P.I. STA. = 97+29.89  
 I = 18° 34' 49" (LT)  
 D = 6° 11' 36"  
 R = 925.10'  
 T = 151.33'  
 L = 300.00'  
 E = 12.30'  
 e = -----  
 T.R. = -----  
 S.E. RUN = -----  
 P.C. STA. = 95+78.56  
 P.T. STA. = 98+78.56

EXIST. CURVE C07  
 P.I. STA. = 103+43.67  
 I = 5° 30' 00" (RT)  
 D = 1° 13' 20"  
 R = 4,687.84'  
 T = 225.17'  
 L = 450.00'  
 E = 5.40'  
 e = -----  
 T.R. = -----  
 S.E. RUN = -----  
 P.C. STA. = 101+18.49  
 P.T. STA. = 105+68.49

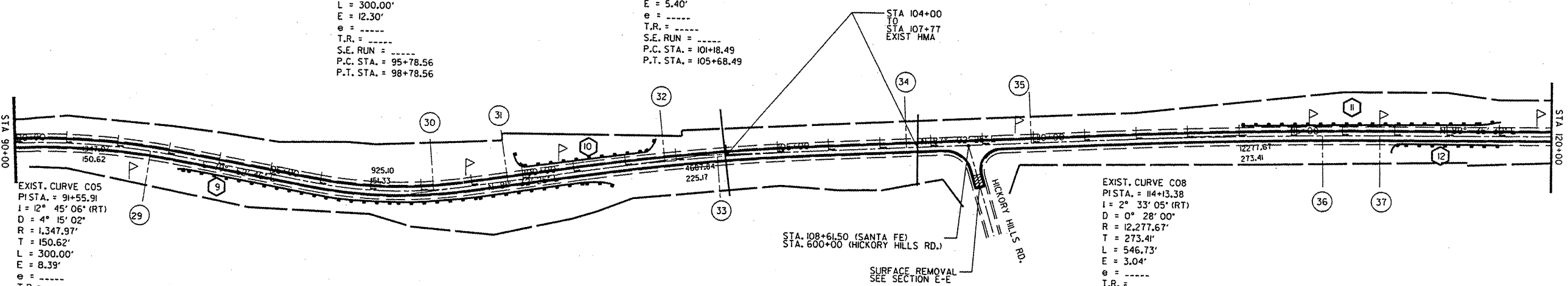

EXIST. CURVE C05  
 P.I. STA. = 91+55.91  
 I = 12° 45' 06" (RT)  
 D = 4° 15' 02"  
 R = 1,347.97'  
 T = 150.62'  
 L = 300.00'  
 E = 8.39'  
 e = -----  
 T.R. = -----  
 S.E. RUN = -----  
 P.C. STA. = 90+05.29  
 P.T. STA. = 93+05.29

EXIST. CURVE C08  
 P.I. STA. = 114+13.38  
 I = 2° 33' 05" (RT)  
 D = 0° 28' 00"  
 R = 12,277.67'  
 T = 273.41'  
 L = 546.73'  
 E = 3.04'  
 e = -----  
 T.R. = -----  
 S.E. RUN = -----  
 P.C. STA. = 111+39.97  
 P.T. STA. = 116+86.70

ENTRANCE #	TYPE	STATION	WIDTH (FT)	SURFACE
24	FIELD ENTRANCE	77+61 RT	18	AGG
25	FIELD ENTRANCE	82+17 LT	16	AGG
26	PRIVATE ENTRANCE	82+84 RT	17	AGG
27	FIELD ENTRANCE	86+47 RT	17	AGG
28	FIELD ENTRANCE	87+59 LT	17	AGG
29	PRIVATE ENTRANCE	92+66 RT	20	ASPH
30	PRIVATE ENTRANCE	98+23 LT	22	ASPH
31	PRIVATE ENTRANCE	99+70 LT	31	ASPH
32	PRIVATE ENTRANCE	102+77 LT	20	AGG
33	FIELD ENTRANCE	103+81 RT	24	AGG
34	FIELD ENTRANCE	107+52 LT	12	AGG

ENTRANCE #	TYPE	STATION	WIDTH (FT)	SURFACE
35	PRIVATE ENTRANCE	109+95 LT	12	AGG
36	PRIVATE ENTRANCE	115+61 RT	18	AGG
37	PRIVATE ENTRANCE	116+7 RT	18	AGG

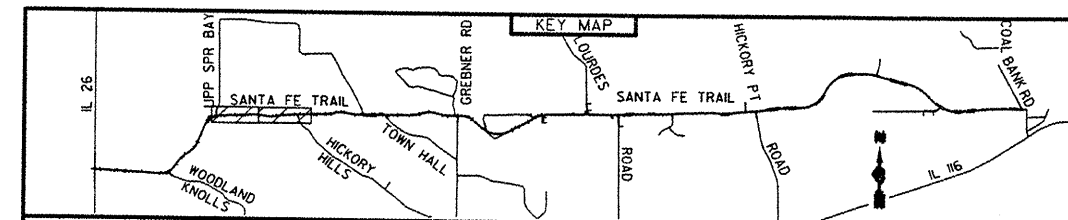

**WOODFORD COUNTY HIGHWAY DEPARTMENT**  
 DENNIS BACHMAN, P.E., COUNTY ENGINEER  
 301 S. Main St.  
 Roonoke, IL 61561-0467  
 TEL: 309-923-2891  
 FAX: 309-923-7928

F.A.S. RTE. 2360  
 SECTION 04-00058-08-FP  
 SANTA FE TRAIL (C.H.#25)

**PLAN SHEET**

SCALE: 1"=100'  
 DATE 3/1/06  
 DRAWN BY: BJB  
 CHECKED BY: DDB

F.A.S. RTE.	SECTION	COUNTY	TOTAL SHEETS	SHEET NO.
2360	04-00058-09-FP	WOODFORD	9	8
STA. 120+00		TO STA. 180+00		
FED. ROAD DIST. NO. 4	ILLINOIS	FED. AID PROJECT		

EXIST. CURVE C09  
 P.I.S.T.A. = 121+87.86  
 I = 11° 12' 45" (L.T.)  
 D = 3° 44' 15"  
 R = 1,533.00'  
 T = 150.48'  
 L = 300.00'  
 E = 7.37'  
 e = -----  
 T.R. = -----  
 S.E. RUN = -----  
 P.C. STA. = 120+37.38  
 P.T. STA. = 123+37.38

EXIST. CURVE C11  
 P.I.S.T.A. = 132+65.91  
 I = 12° 45' 00" (L.T.)  
 D = 4° 15' 00"  
 R = 1,348.14'  
 T = 150.62'  
 L = 300.00'  
 E = 8.39'  
 e = -----  
 T.R. = -----  
 S.E. RUN = -----  
 P.C. STA. = 131+15.29  
 P.T. STA. = 134+15.29

EXIST. CURVE C10  
 P.I.S.T.A. = 127+07.06  
 I = 22° 50' 11" (RT)  
 D = 7° 30' 00"  
 R = 763.94'  
 T = 154.29'  
 L = 304.48'  
 E = 15.42'  
 e = -----  
 T.R. = -----  
 S.E. RUN = -----  
 P.C. STA. = 125+52.77  
 P.T. STA. = 128+57.25

EXIST. CURVE C13  
 P.I.S.T.A. = 164+87.61  
 I = 26° 57' 48" (RT)  
 D = 7° 30' 00"  
 R = 763.94'  
 T = 183.15'  
 L = 359.51'  
 E = 21.65'  
 e = -----  
 T.R. = -----  
 S.E. RUN = -----  
 P.C. STA. = 163+04.46  
 P.T. STA. = 166+63.97

EXIST. CURVE C14  
 P.I.S.T.A. = 171+79.78  
 I = 13° 37' 55" (L.T.)  
 D = 4° 30' 00"  
 R = 1,273.24'  
 T = 152.18'  
 L = 302.93'  
 E = 9.06'  
 e = -----  
 T.R. = -----  
 S.E. RUN = -----  
 P.C. STA. = 170+27.59  
 P.T. STA. = 173+30.53

EXIST. CURVE C12  
 P.I.S.T.A. = 157+97.43  
 I = 12° 32' 23" (L.T.)  
 D = 4° 00' 00"  
 R = 1,432.40'  
 T = 157.38'  
 L = 313.49'  
 E = 8.62'  
 e = -----  
 T.R. = -----  
 S.E. RUN = -----  
 P.C. STA. = 156+40.05  
 P.T. STA. = 159+53.55

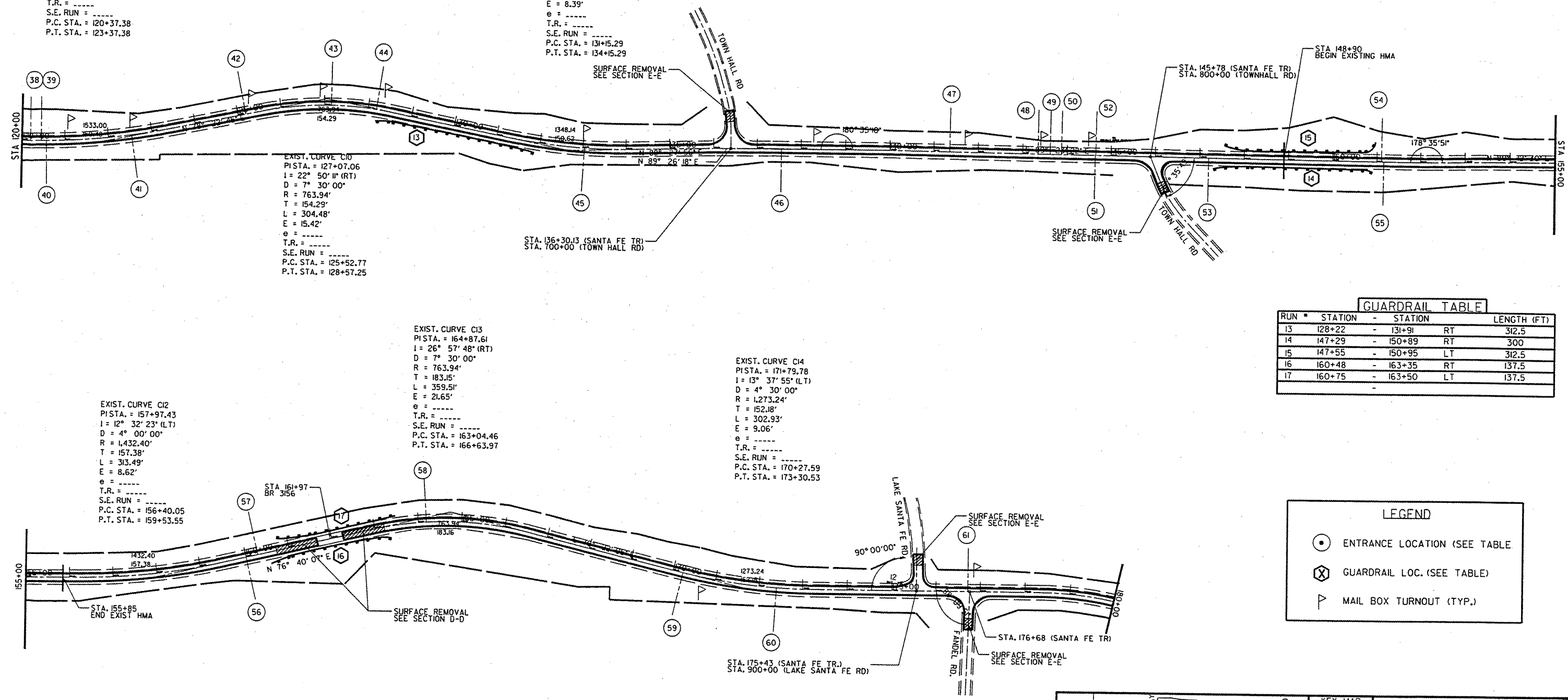

**GUARDRAIL TABLE**

RUN #	STATION -	STATION		LENGTH (FT)
13	128+22	-	131+91 RT	312.5
14	147+29	-	150+89 RT	300
15	147+55	-	150+95 LT	312.5
16	160+48	-	163+35 RT	137.5
17	160+75	-	163+50 LT	137.5

**LEGEND**

- ENTRANCE LOCATION (SEE TABLE)
- ⊗ GUARDRAIL LOC. (SEE TABLE)
- ⤴ MAIL BOX TURNOUT (TYP.)

ENTRANCE #	TYPE	STATION	WIDTH (FT)	SURFACE
38	PRIVATE ENTRANCE	120+21 LT	21	AGG
39	PRIVATE ENTRANCE	120+45 LT	21	AGG
40	PRIVATE ENTRANCE	120+58 RT	16	AGG
41	PRIVATE ENTRANCE	122+53 RT	40	ASPH
42	PRIVATE ENTRANCE	125+18 LT	12	ASPH
43	PRIVATE ENTRANCE	127+15 LT	14	ASPH
44	PRIVATE ENTRANCE	128+18 LT	13	ASPH
45	PRIVATE ENTRANCE	133+04 RT	26	AGG
46	PRIVATE ENTRANCE	137+55 RT	30	AGG
47	PRIVATE ENTRANCE	141+36 LT	14	ASPH
48	PRIVATE ENTRANCE	143+35 LT	12	AGG

ENTRANCE #	TYPE	STATION	WIDTH (FT)	SURFACE
49	PRIVATE ENTRANCE	143+63 LT	11	AGG
50	PRIVATE ENTRANCE	143+88 LT	13	ASPH
51	PRIVATE ENTRANCE	144+64 RT	13	CONC.
52	PRIVATE ENTRANCE	144+66 LT	23	AGG
53	FIELD ENTRANCE	147+20 RT	17	AGG
54	FIELD ENTRANCE	151+10 LT	18	AGG
55	FIELD ENTRANCE	151+16 RT	22	AGG
56	FIELD ENTRANCE	160+00 RT	16	AGG
57	FIELD ENTRANCE	160+28 LT	12	AGG
58	PRIVATE ENTRANCE	164+18 LT	15	AGG
59	PRIVATE ENTRANCE	170+23 RT	30	ASPH

ENTRANCE #	TYPE	STATION	WIDTH (FT)	SURFACE
60	FIELD ENTRANCE	172+40 RT	12	AGG
61	PRIVATE ENTRANCE	176+72 LT	15	ASPH

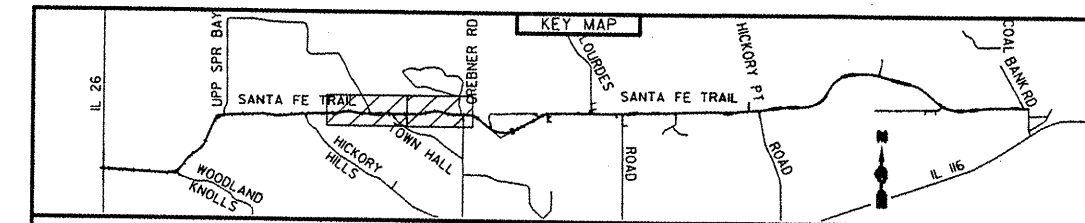

**WOODFORD COUNTY HIGHWAY DEPARTMENT**  
 DENNIS BACHMAN, P.E., COUNTY ENGINEER  
 301 S. Main St.  
 Roanoke, IL 61561-0467  
 TEL: 309-923-2891  
 FAX: 309-923-7928

F.A.S. RTE. 2360  
 SECTION 04-00058-08-FP  
 SANTA FE TRAIL (C.H.#25)  
**PLAN SHEET**  
 SCALE: 1"=100'  
 DATE 3/1/06  
 DRAWN BY: BJH  
 CHECKED BY: DNR



F.A.S. RTE.	SECTION	COUNTY	TOTAL SHEETS	SHEET NO.
2360	04-00058-09-FP	WOODFORD	9	9
STA. 180+00		TO STA. 237+00		
FED. ROAD DIST. NO. 4		ILLINOIS FED. AID PROJECT		

EXIST. CURVE C15  
 P.I.S.T.A. = 181+28.60  
 I = 41° 01' 16" (RT)  
 D = 7° 30' 00"  
 R = 763.94'  
 T = 285.79'  
 L = 546.95'  
 E = 51.71'  
 e = -----  
 T.R. = -----  
 S.E. RUN = -----  
 P.C. STA. = 178+42.81  
 P.T. STA. = 183+89.76

**LEGEND**

- ENTRANCE LOCATION (SEE TABLE)
- ⊗ GUARDRAIL LOC. (SEE TABLE)
- ▷ MAIL BOX TURNOUT (TYP.)

EXIST. CURVE C16  
 P.I.S.T.A. = 195+95.68  
 I = 69° 38' 19" (LT)  
 D = 5° 31' 51"  
 R = 1,035.95'  
 T = 720.52'  
 L = 1,259.12'  
 E = 225.93'  
 e = -----  
 T.R. = -----  
 S.E. RUN = -----  
 P.C. STA. = 188+75.16  
 P.T. STA. = 201+34.28

STA. 190+40 (SANTA FE TR.)  
 STA. 1000+00 (LOURDES CHURCH RD.)

**GUARDRAIL TABLE**

RUN #	STATION	STATION	RT	LENGTH (FT)
18	189+00	192+76	RT	462.5
19	194+19	196+36	RT	150
20	197+00	200+27	RT	350

EXIST. CURVE C17  
 P.I.S.T.A. = 216+47.27  
 I = 27° 51' 03" (RT)  
 D = 7° 30' 00"  
 R = 763.94'  
 T = 189.42'  
 L = 371.34'  
 E = 23.13'  
 e = -----  
 T.R. = -----  
 S.E. RUN = -----  
 P.C. STA. = 214+57.86  
 P.T. STA. = 218+29.20

ENTRANCE#	TYPE	STATION	WIDTH (FT)	SURFACE
62	FIELD ENTRANCE	183+00 RT	14	AGG
63	FIELD ENTRANCE	183+07 LT	14	AGG
64	FIELD ENTRANCE	202+18 RT	17	AGG
65	FIELD ENTRANCE	202+49 LT	15	AGG
66	FIELD ENTRANCE	204+28 LT	16	AGG
67	FIELD ENTRANCE	205+32 RT	15	AGG
68	FIELD ENTRANCE	209+83 RT	16	AGG
69	PRIVATE ENTRANCE	210+15 LT	15	AGG
70	PRIVATE ENTRANCE	213+84 LT	14	AGG
71	PRIVATE ENTRANCE	214+87 LT	20	ASPH
72	FIELD ENTRANCE	216+41 LT	18	ASPH

ENTRANCE#	TYPE	STATION	WIDTH (FT)	SURFACE
73	FIELD ENTRANCE	218+75 RT	19	AGG
74	FIELD ENTRANCE	221+35 RT	17	AGG
75	FIELD ENTRANCE	222+98 LT	13	AGG
76	PRIVATE ENTRANCE	223+27 RT	26	ASPH
77	PRIVATE ENTRANCE	224+80 LT	48	AGG
78	PRIVATE ENTRANCE	225+51 RT	50	ASPH
79	PRIVATE ENTRANCE	227+26 LT	23	AGG
80	PRIVATE ENTRANCE	227+55 LT	23	AGG
81	FIELD ENTRANCE	228+70 RT	16	AGG
82	FIELD ENTRANCE	231+17 LT	37	AGG
83	PRIVATE ENTRANCE	232+37 RT	25	ASPH

ENTRANCE#	TYPE	STATION	WIDTH (FT)	SURFACE
84	FIELD ENTRANCE	232+74 LT	22	AGG

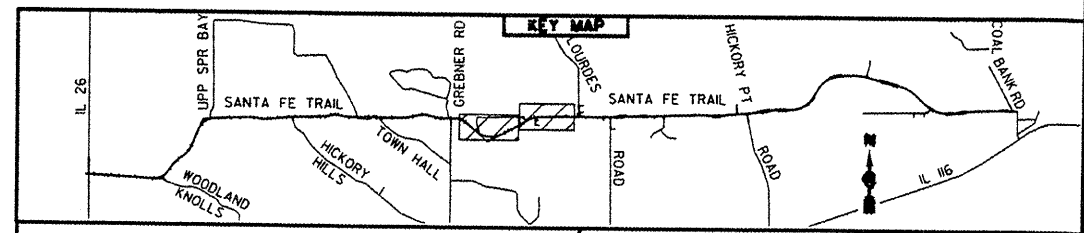

**WOODFORD COUNTY HIGHWAY DEPARTMENT**  
 DENNIS BACHMAN, P.E., COUNTY ENGINEER  
 301 S. Main St.  
 Roanoke, IL 61561-0467  
 TEL: 309-923-2891  
 FAX: 309-923-7928

F.A.S. RTE. 2360  
 SECTION 04-00058-08-FP  
 SANTA FE TRAIL (C.H.#25)  
**PLAN SHEET**

SCALE: 1"=100'  
 DATE 3/1/06  
 DRAWN BY: BJH  
 CHECKED BY: DDB

USER MAKE & CHECKERS