

ROUTE NO.	SECTION	COUNTY	TOTAL SHEETS	SHEET NO.
		DOUGLAS	279	66

FEDERAL DIST. NO. ILLINOIS PROJECT #99-00080-00-RP

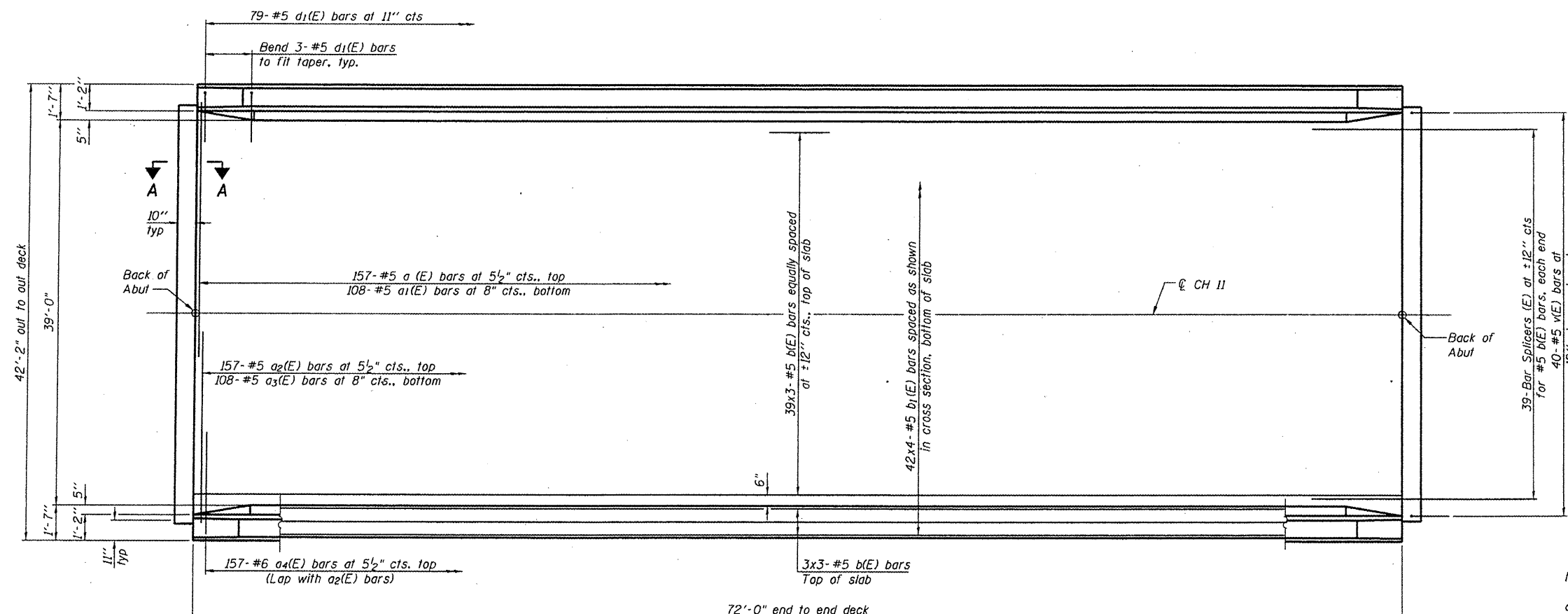

PLAN

Notes:
See Sheet 8 of 13 for superstructure details and Bill of Material.
Bars indicated thus 20 x 3-#5 etc. indicates 20 lines of bars with 3 lengths per line.
See Sheet 8 of 13 for parapet reinforcement.

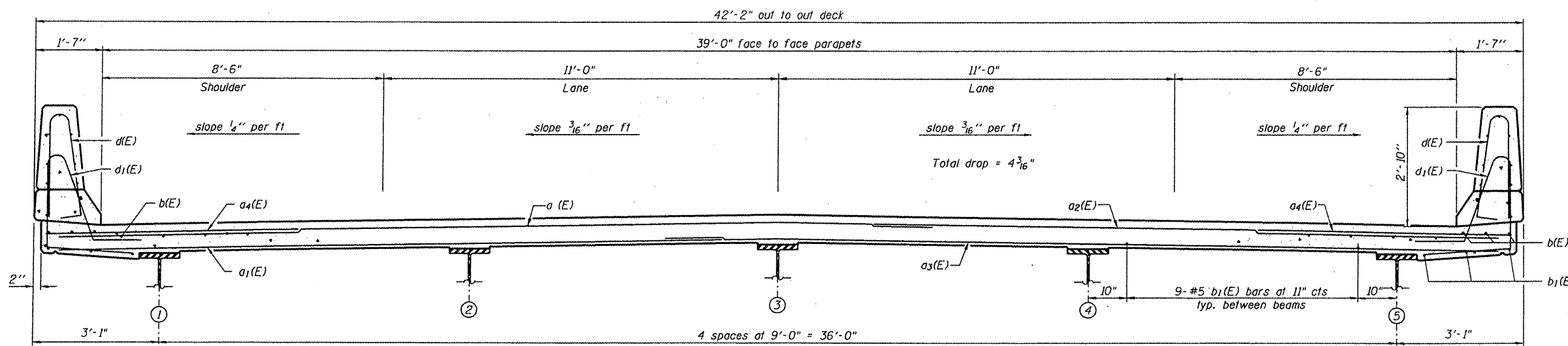

CROSS SECTION
(Looking Up Station)

CH 11 (FA 666) OVER BIG SLOUGH

DECK PLAN AND CROSS SECTION

REVISIONS		SECTION 99-00080-00-RP	CH 11 (FAS 666)	DRAWN BY DATE R KING 01/08
1		DOUGLAS	SN 021-4548	CHECKED BY DATE JMD 01/08
2				BOOK NUMBER
3				PROJECT NO. 5149
4				SHEET NO.
5				
6				
7				
8				
9				
10				

HOMER L. CHASTAIN & ASSOCIATES, LLP
CONSULTING ENGINEERS
184-08197

DECATUR CHICAGO
617-422-8644 0783 714-0060
ROCKFORD
815-489-0860