



DENNIS L. & ROSE E. PLANK  
(1306400005- C)

TROY & LISA MAST  
(1305300006)

ROUTE NO.	SECTION	COUNTY	TOTAL SHEETS	SHEET NO.
FAS 666	99-00080-00-RP	DOUGLAS	279	86
FEDERAL DIST. NO.		ILLINOIS	PROJECT	C-95-323-07

POT STA 57+37.37 (FAS 666-CH 11)  
 POT STA 204+95.59 (TR 8- 100E)  
 POT STA 57+35.48 (FAS 666-CH 11)  
 POT STA 204+95.59 (TR 8- 100E)

24" STOP BAR (YELLOW)

DOUBLE 4" SOLID (YELLOW)

4" SOLID (WHITE)

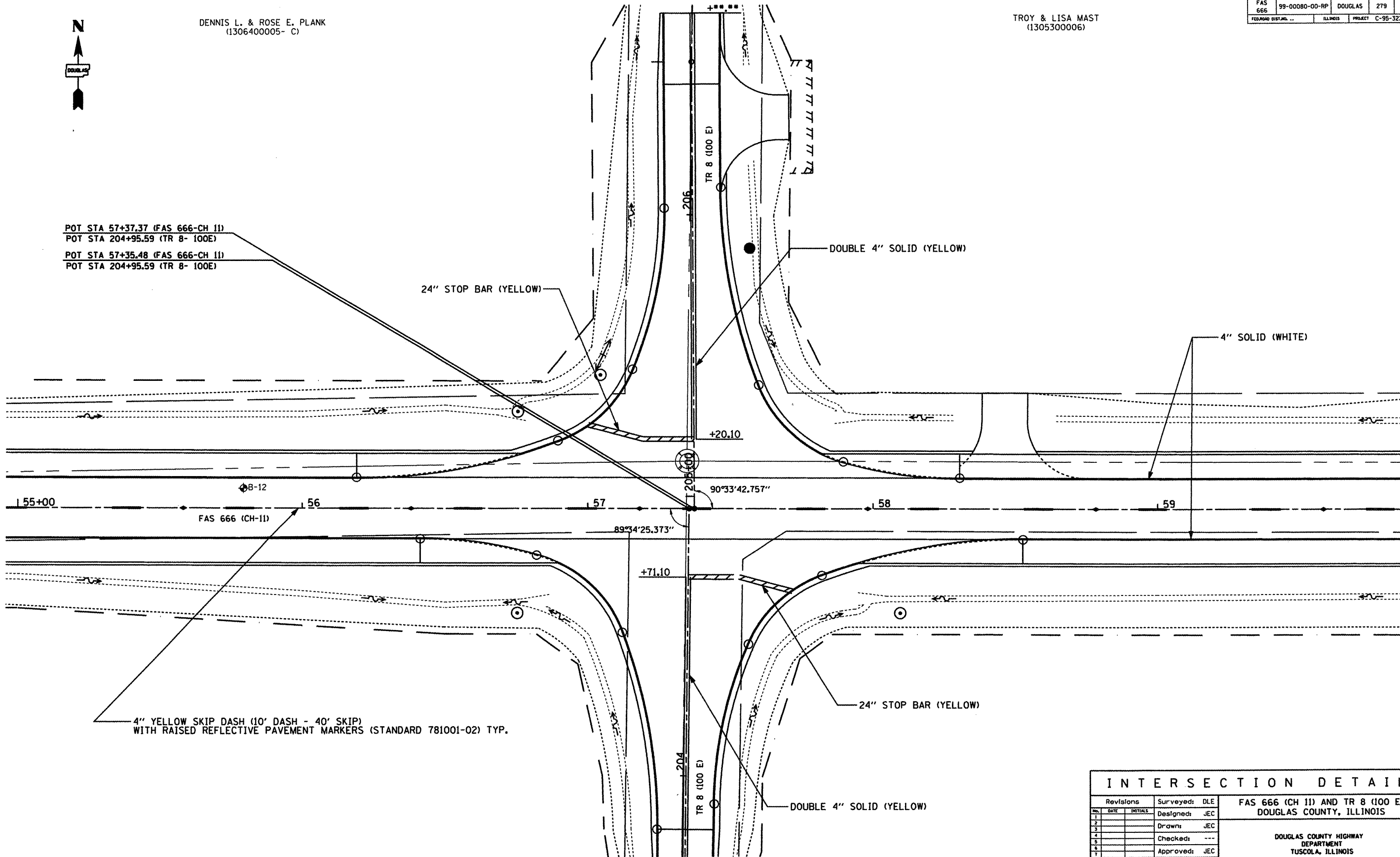

4" YELLOW SKIP DASH (10' DASH - 40' SKIP)  
 WITH RAISED REFLECTIVE PAVEMENT MARKERS (STANDARD 781001-02) TYP.

### INTERSECTION DETAIL

Revisions	Surveyed: DLE	FAS 666 (CH 11) AND TR 8 (100 E) DOUGLAS COUNTY, ILLINOIS
1	Designed: JEC	
2	Drawn: JEC	
3	Checked: ---	
4	Approved: JEC	
5		
6		
Job No.: NA	Date: 1/08	DOUGLAS COUNTY HIGHWAY DEPARTMENT TUSCOLA, ILLINOIS