

CO. HWY.	SECTION	COUNTY	TOTAL SHEETS	SHEET NO.
13	05-00130-14-RS	MCLEAN	5	1
FED. ROAD DIST. NO. 5 ILLINOIS			FED. AID PROJECT	

INDEX OF SHEETS

- Cover Sheet
- Typical Cross Sections
- Details
- Intersection Detail (CH 13 & RT 24)
- CH 13 Alignment Diagram

STATE STANDARD DETAILS

606001-03	CONCRETE CURB TYPE B AND COMBINATION CONCRETE CURB AND GUTTER
701001-01	OFF-RD OPERATIONS, 2L, 2W, MORE THAN 15' AWAY
701006-02	OFF-RD OPERATIONS, 2L, 2W, 15' TO 24" FROM PAVEMENT EDGE
701011-01	OFF-RD MOVING OPERATIONS, 2L, 2W, DAY ONLY
701201-02	LANE CLOSURE, 2L, 2W, DAY ONLY, FOR SPEEDS > 45 MPH
701301-02	LANE CLOSURE, 2L, 2W, SHORT TIME OPERATIONS
701306-01	LANE CLOSURE, 2L, 2W, SLOW MOVING OPERATIONS DAY ONLY, FOR SPEEDS > 45 MPH
701901	TRAFFIC CONTROL DEVICES
BLR 21-7	TYPICAL APPLICATION OF TRAFFIC CONTROL DEVICES FOR CONSTRUCTION OF RURAL HIGHWAYS
BLR 22-5	TYPICAL APPLICATION OF TRAFFIC CONTROL DEVICES FOR CONSTRUCTION ON RURAL LOCAL HIGHWAYS (TWO LANE TWO WAY RURAL TRAFFIC) (ROAD CLOSED TO THRU TRAFFIC)

SUMMARY OF QUANTITIES

ITEM NUMBER	ITEM	UNIT	QUANTITY
* 20200100	EARTH EXCAVATION	CU YD	290
* 21001000	GEOTECHNICAL FABRIC FOR GROUND STABILIZATION	SQ YD	645
35102000	AGGREGATE BASE COURSE, TYPE B 8"	SQ YD	645
35501308	HOT-MIX ASPHALT BASE COURSE, 6"	SQ YD	580
* 40600100	BITUMINOUS MATERIALS (PRIME COAT)	GALLON	21,000
* 40600300	AGGREGATE (PRIME COAT)	TON	550
* 40600625	LEVELING BINDER (MACHINE METHOD), N50	TON	4,550
40600982	HOT-MIX ASPHALT SURFACE REMOVAL-BUTT JOINT	SQ YD	667
40600990	TEMPORARY RAMP	SQ YD	69
40603080	HOT-MIX ASPHALT BINDER COURSE, IL-19.0, N50	TON	12,000
40603310	HOT-MIX ASPHALT SURFACE COURSE, MIX "C", N50	TON	7,600
* 40800010	BITUMINOUS MATERIALS (PRIME COAT)	GALLON	200
* 40800030	AGGREGATE (PRIME COAT)	TON	10
* 40800050	INCIDENTAL HOT-MIX ASPHALT SURFACING	TON	350
44000500	COMBINATION CURB AND GUTTER REMOVAL	FOOT	128
* 44300300	AREA REFLECTIVE CRACK CONTROL TREATMENT, SYSTEM A	SQ YD	102,881
* 48101200	AGGREGATE SHOULDERS, TYPE B	TON	8,000
* 60609800	COMBINATION CONCRETE CURB AND GUTTER, TYPE M-6.18	FOOT	130
67100100	MOBILIZATION	L SUM	1
Δ 78100100	RAISED REFLECTIVE PAVEMENT MARKER	EACH	484

* SEE SPECIAL PROVISIONS

Δ SPECIALTY ITEMS

THESE PLANS ARE NOT TO SCALE

J.U.L.I.E.
JOINT UTILITY LOCATION INFORMATION FOR EXCAVATION
1-800-892-0123

CONTRACT NO. 91387

STATE OF ILLINOIS
DEPARTMENT OF TRANSPORTATION
DIVISION OF HIGHWAYS
PLANS FOR PROPOSED
MCLEAN COUNTY
FEDERAL AID SECONDARY (STP-SR)
COLFAX-WESTON RD (CH 13)
F.A.S. ROUTE 349 SECTION 05-00130-14-RS
PROJECT #RS-349(113)
JOB #C-95-308-08

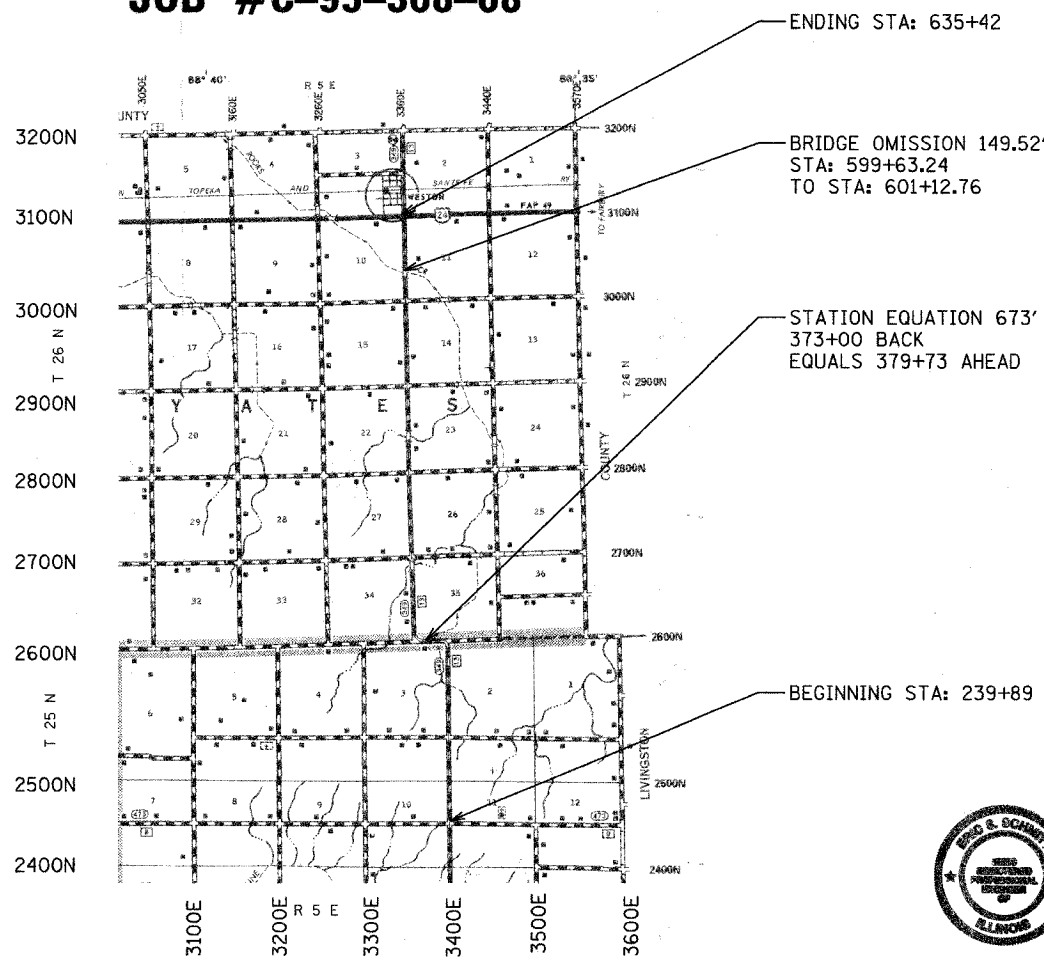
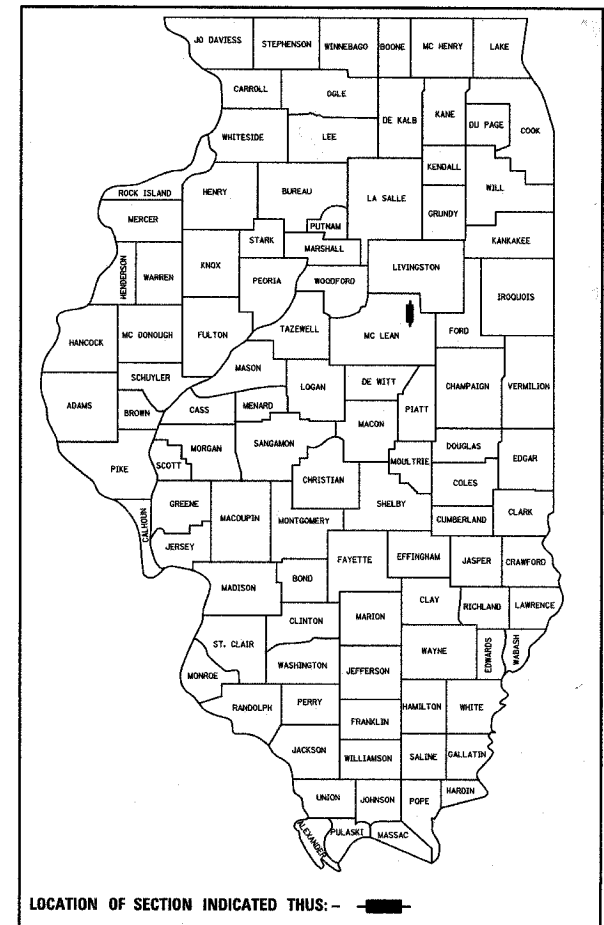

- NOTE: THE TOTAL LENGTH OF THE PROPOSED PROJECT IS 38,880 FEET WITH A NET LENGTH OF 38,730.48 FEET (7.335 MILES)
- NOTE: THESE PLANS MEET THE MINIMUM REQUIREMENTS FOR A 3R IMPROVEMENT.
- NOTE: CURRENT ADT: 725
FUNCTIONAL CLASSIFICATION: MAJOR COLLECTOR
- NOTE: THE PLANS FOR SECTION 05-00130-14-RS ARE THOSE AS APPROVED IN SECTIONS T-MFT (1931) AND TX (1938)



E. J. Schmitt 3/21/2008
ILLINOIS PROFESSIONAL ENGINEER #55820
EXPIRES 11-30-09

MCLEAN COUNTY HIGHWAY DEPARTMENT	
APPROVED	3-21-08 <i>Joe Miller</i> COUNTY ENGINEER
PASSED	3/24-08 <i>D. A. Schmitt</i> DISTRICT FIVE ENGINEER OF LOCAL ROADS & STREETS
Releasing For Bid Based on Limited Review	3/25-08 <i>Joseph E. Long</i> DEPUTY DIRECTOR OF HIGHWAYS, REGION THREE ENGINEER
STATE OF ILLINOIS DEPARTMENT OF TRANSPORTATION	

CONTRACT NO. 91387				
CO. HWY.	SECTION	COUNTY	TOTAL SHEETS	SHEET NO.
13	05-00130-14-RS	McLEAN	5	2
FED. ROAD DIST. NO. 5 ILLINOIS FED. AID PROJECT				

EXISTING TYPICAL CROSS SECTION
 SEC. 05-00130-14-RS
 COLFAX-WESTON RD (CH 13)

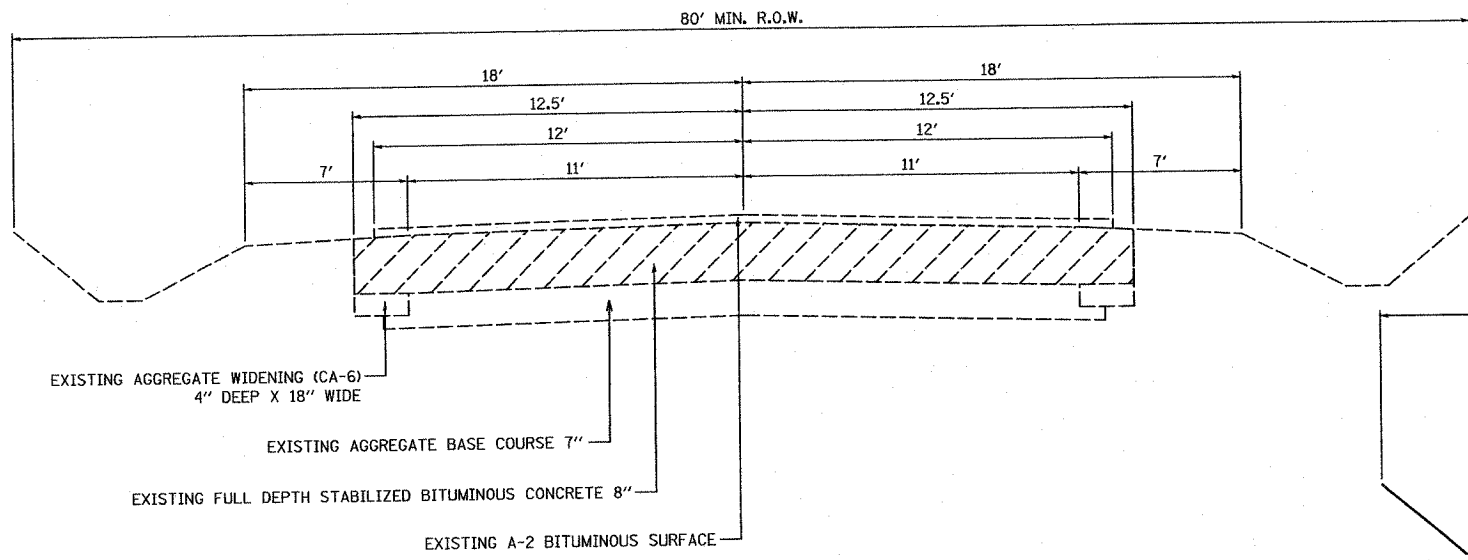

STRUCTURAL DESIGN DATA 80,000#

CLASS III ROAD	DESIGN PERIOD 20 YEARS
STRUCTURAL DESIGN TRAFFIC: 885	YEAR: 2015
PERCENT OF DESIGN TRAFFIC IN DESIGN LANE:	
P.C. 78%	S.U. 12% M.U. 10%
P.C. 690	S.U. 106 M.U. 88
MINIMUM SOIL SUPPORT: IBR= 3.0	
TRAFFIC FACTOR (T.F.)= 0.457	
STRUCTURAL NUMBER (Dt): 3.7	
PAVEMENT STRUCTURE MATERIALS:	
SURFACE: PROPOSED HOT-MIX ASPHALT	4" @ 0.40 a1= 1.60
BASE: EXISTING STABILIZED BITUMINOUS CONCRETE	8" @ 0.22 a2= 1.76
SUBBASE: EXISTING AGGREGATE BASE COURSE	6" @ 0.10 a3= 0.60
PROPOSED (Dt) TOTAL= 3.96	

PROPOSED TYPICAL CROSS SECTION #1

SEC. 05-00130-14-RS
 COLFAX-WESTON RD (CH 13)
 STA: 239+89 TO STA: 373+00 BK - STA: 379+73 AH
 STA: 379+73 AH TO STA: 598+88.24
 STA: 601+87.76 TO STA: 635+42

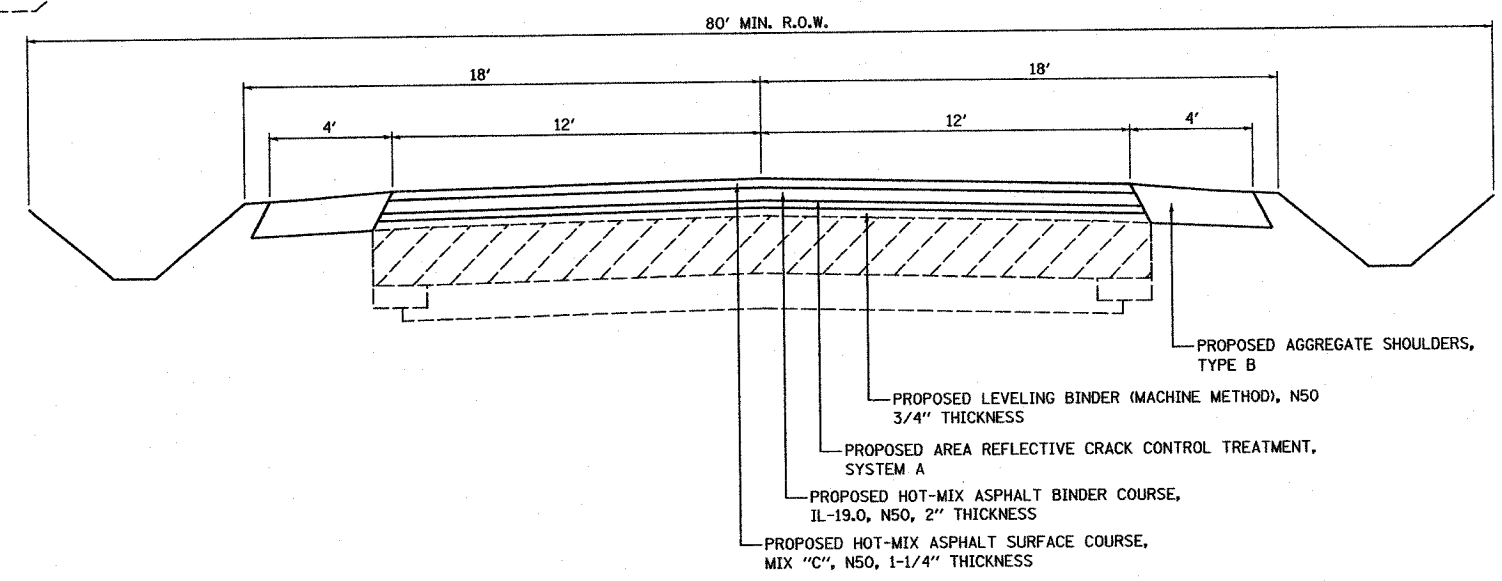

PROPOSED TYPICAL CROSS SECTION #2

SEC. 05-00130-14-RS
 COLFAX-WESTON RD (CH 13)
 STA: 598+88.24 TO STA: 599+63.24
 BRIDGE OMISSION 599+63.24 TO STA: 601+12.76
 STA: 601+12.76 TO STA: 601+87.76

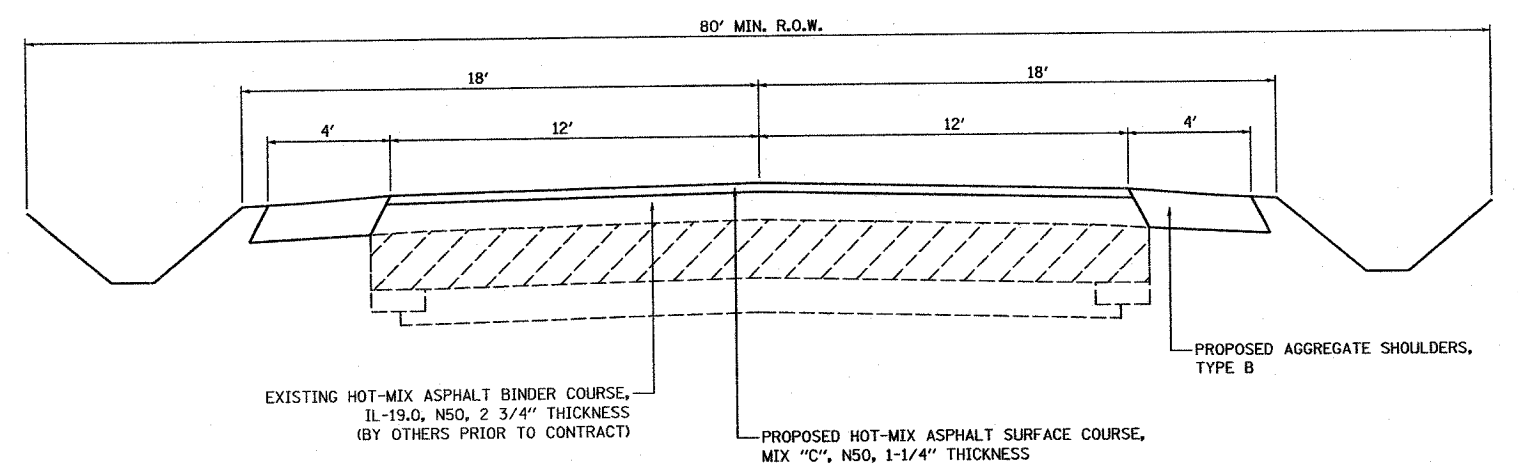

CONTRACT NO. 91387				
CO. HWY.	SECTION	COUNTY	TOTAL SHEETS	SHEET NO.
13	05-00130-14-RS	McLEAN	5	3
FED. ROAD DIST. NO. 5 ILLINOIS FED. AID PROJECT				

TYPICAL RURAL PRIVATE ENTRANCE

5 @ 65.8 SQ YDS EACH

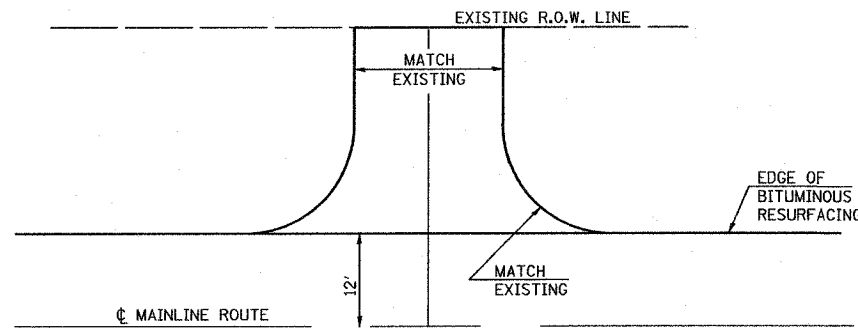

PLAN F

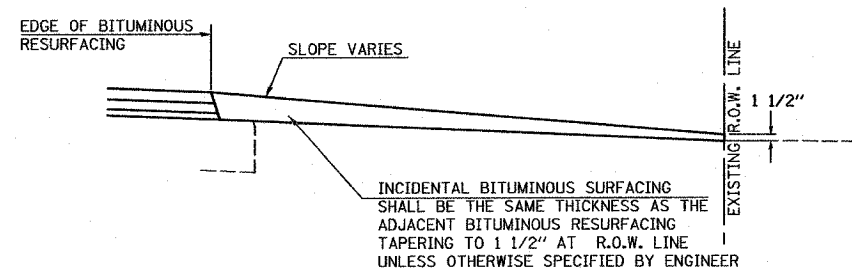

PROFILE F

BITUMINOUS SURFACE REMOVAL-BUTT JOINT

- 1 @ 133.3 SQ YDS STA: 239+89 (BEGINNING STATION) 1 1/4"
- 1 @ 133.3 SQ YDS STA: 599+63.24 (BRIDGE APPROACH PAVEMENT) 1 1/4"
- 1 @ 133.3 SQ YDS STA: 601+12.76 (BRIDGE APPROACH PAVEMENT) 1 1/4"

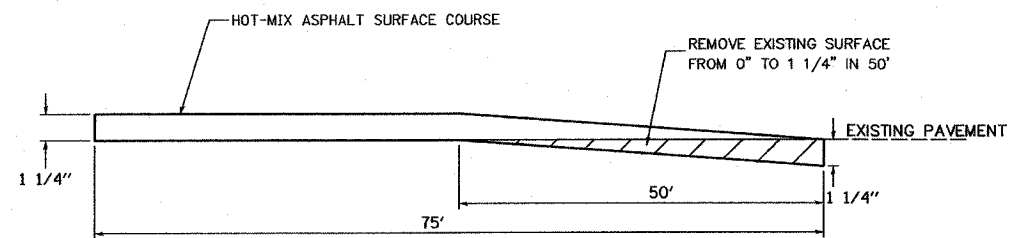

BITUMINOUS SURFACE REMOVAL-BUTT JOINT

- 1 @ 133.3 SQ YDS STA: 598+88.24 (BRIDGE PAVEMENT) 2"
- 1 @ 133.3 SQ YDS STA: 601+87.76 (BRIDGE PAVEMENT) 2"

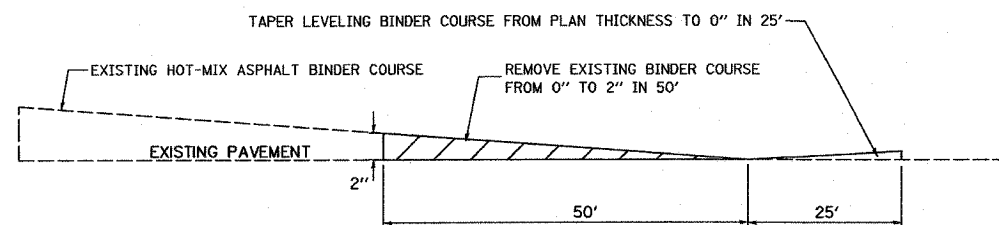

TYPICAL FIELD ENTRANCE

44 @ 13.8 SQ YDS EACH

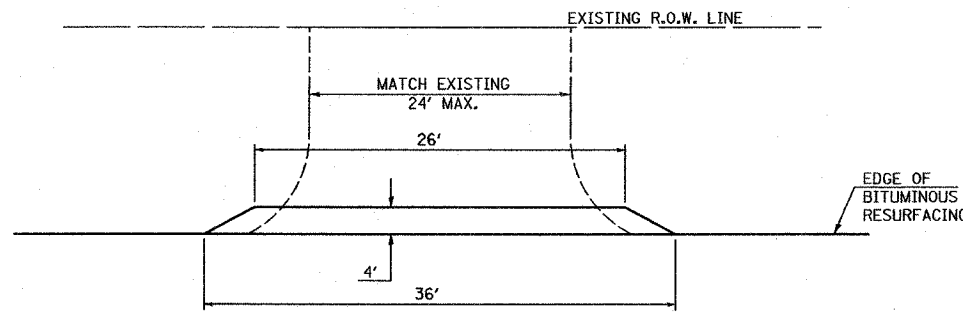

PLAN G

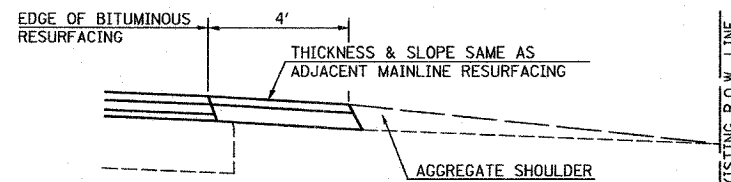

PROFILE G

TYPICAL RURAL SIDE ROAD RETURN

12 @ 122.8 SQ YDS EACH

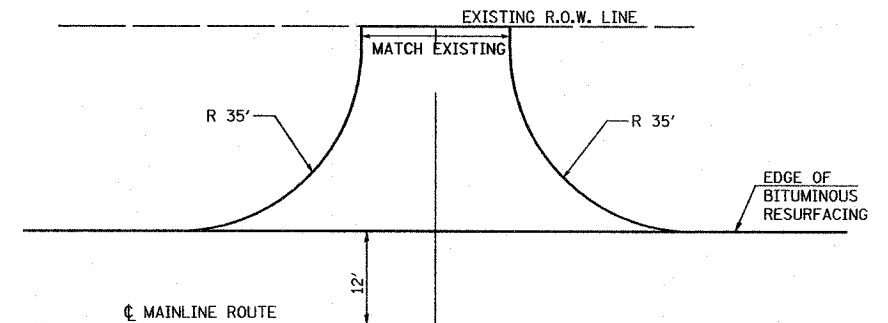

PLAN H

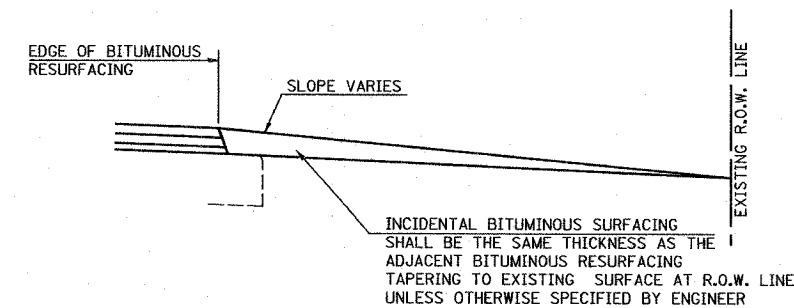

PROFILE H

TYPICAL RURAL MAILBOX TURNOUT

3 @ 41 SQ YD EACH

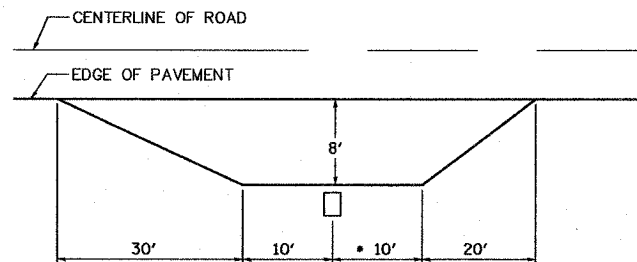

NOTE: * MULTIPLE MAILBOX CLUSTERS TO BE EXTENDED 2' FOR EACH ADDITIONAL MAILBOX

PLAN I

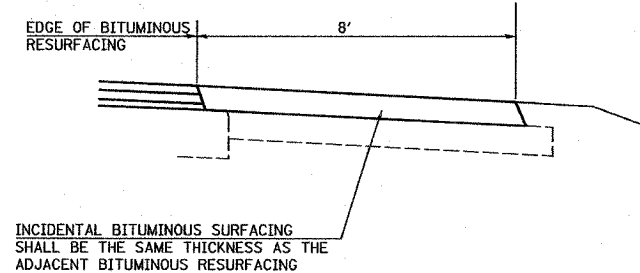

PROFILE I

NOTES:

1. ALL TEMPORARY & PERMANENT PAVEMENT STRIPING WILL BE DONE BY OTHERS.
2. ALL FIELD ENTRANCES SHALL BE CONSTRUCTED WITH THE EXTENDABLE SCREED WIDENER AND PAID FROM HOT-MIX ASPHALT BINDER AND SURFACE COURSES.
3. ALL SIDE ROAD RETURNS, PRIVATE ENTRANCES AND RURAL MAILBOX TURNOUTS ARE TO BE CONSTRUCTED AND PAID FROM INCIDENTAL HOT-MIX ASPHALT SURFACING.
4. AGGREGATE SHOULDERS SHALL BE PLACED ALONG ALL SIDEROAD RETURN RADII AND PRIVATE ENTRANCE RADII AND SHALL BE PLACED ALONG AND BEHIND ALL FIELD ENTRANCES, GUADRIL AND GUADRIL RUNOUTS, PRIVATE ENTRANCES AND MAILBOX TURNOUTS UNLESS SPECIFIED BY THE RESIDENT ENGINEER.
5. ALL EXISTING GUADRIL WILL BE ADJUSTED FOR HEIGHT AND TURNOUT BY THE McLEAN COUNTY HIGHWAY DEPARTMENT FOLLOWING THE PLACEMENT OF THE AGGREGATE SHOULDERS.

CO. HWY.	SECTION	COUNTY	TOTAL SHEETS	SHEET NO.
13	05-00130-14-RS	McLEAN	5	4
FED. ROAD DIST. NO. 5		ILLINOIS	FED. AID PROJECT	

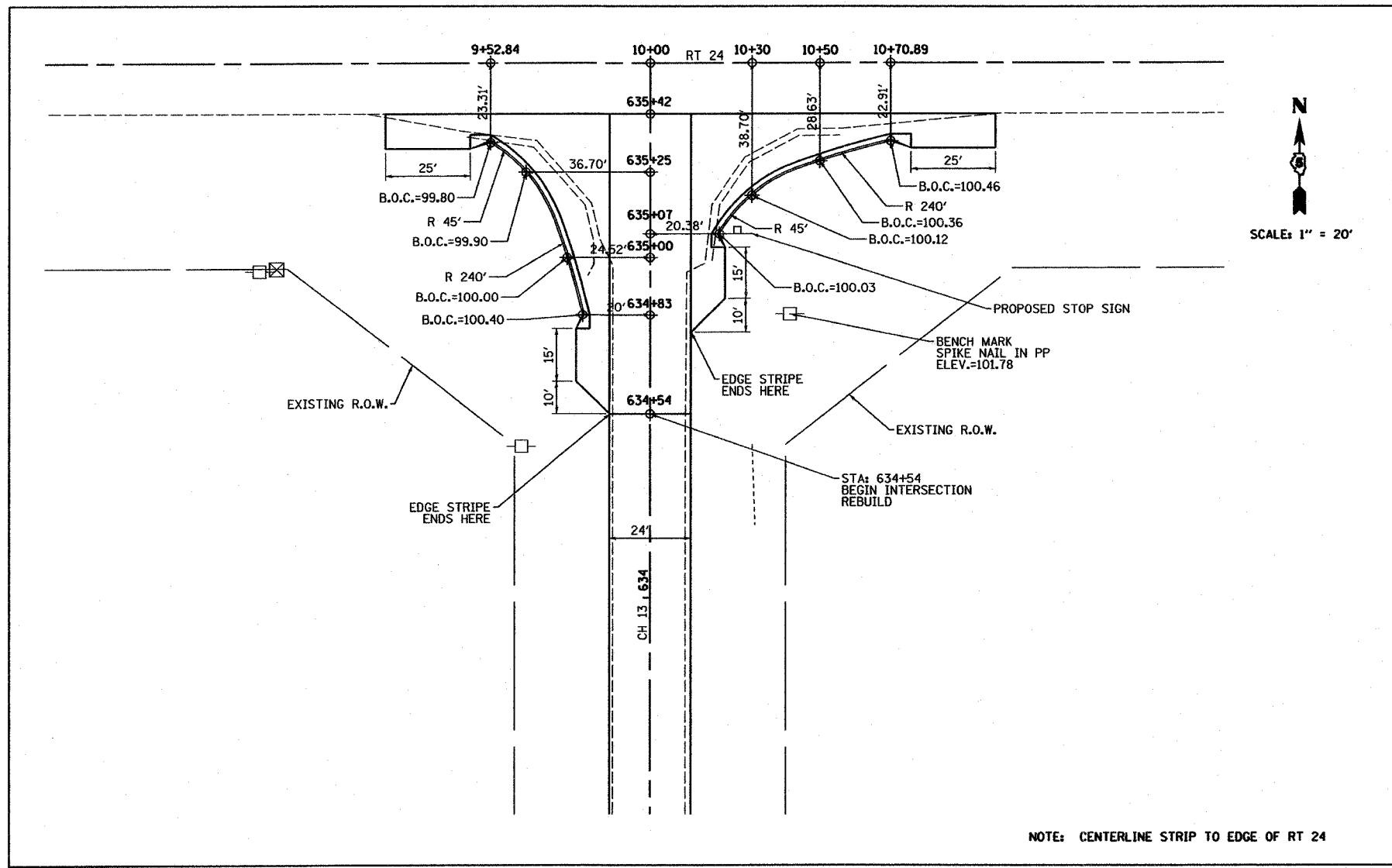

NOTES:

- EARTH EXCAVATION QUANTITY EQUALS 290 CU YD.
- COMBINATION CONCRETE CURB & GUTTER REMOVAL EQUALS 128 FOOT.
- GEOTECHNICAL FABRIC QUANTITY EQUALS 645 SQ YDS.
- AGGREGATE BASE COURSE, TYPE B 8" QUANTITY EQUALS 645 SQ YD.
- HOT-MIX ASPHALT BASE COURSE 6" QUANTITY EQUALS 580 SQ YD.
- LEVELING BINDER, BINDER AND SURFACE COURSES ARE FIGURED IN MAINLINE QUANTITIES.
- COMBINATION CONCRETE CURB AND GUTTER, TYPE M-6.18 QUANTITY EQUALS 130 FOOT.
- BACK FILL BEHIND PROPOSED CURB & GUTTER SHALL BE DONE TO THE SATISFACTION OF THE ENGINEER AND SHALL BE CONSIDERED INCIDENTAL TO THE COST OF COMBINATION CONCRETE CURB AND GUTTER, TYPE M-6.18.
- STATIONING ALONG RT 24 IS ASSUMED AND FOR CONSTRUCTION PURPOSES ONLY.

CH 13 PROPOSED CENTERLINE ELEVATIONS

STATION	ELEV.
635+42	100.12
635+25	100.03
635+00	99.90
634+54	100.42

**INTERSECTION RECONSTRUCTION DETAIL
STA: 634+54 TO STA: 635+42**

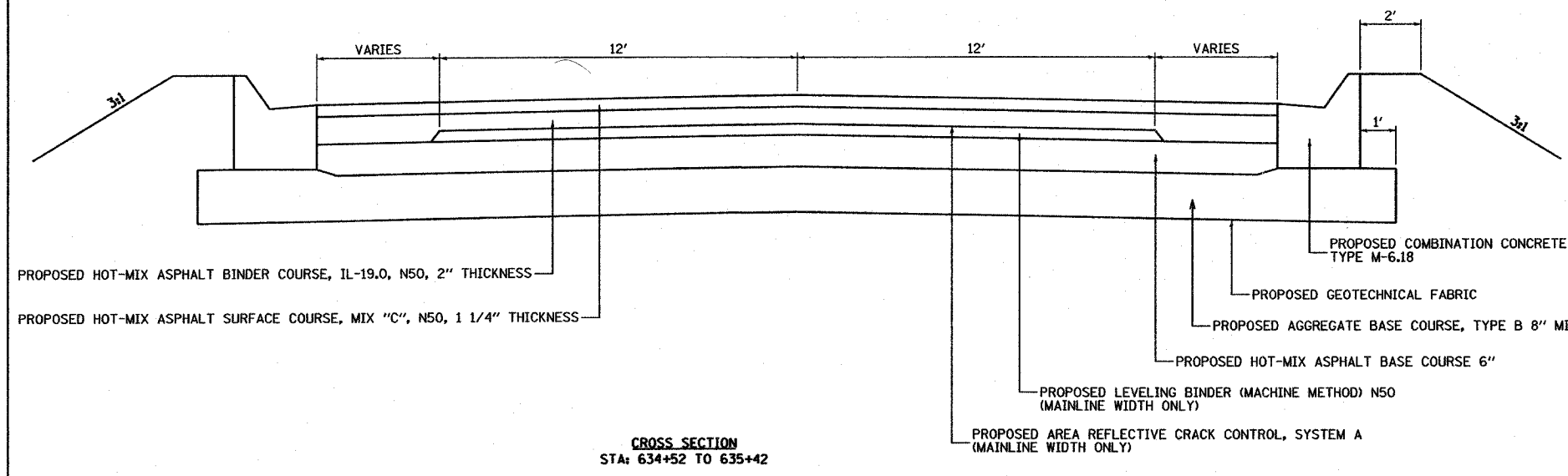

**CROSS SECTION
STA: 634+52 TO 635+42**

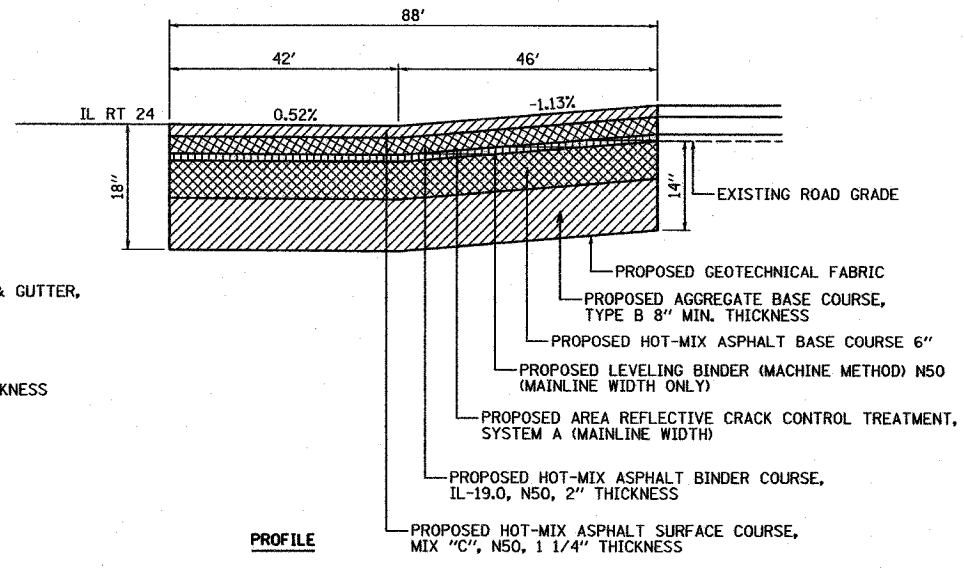

PROFILE

CO. HWY.	SECTION	COUNTY	TOTAL SHEETS	SHEET NO.
13	05-00130-14-RS	McLEAN	5	5
FED. ROAD DIST. NO. 5		ILLINOIS	FED. AID PROJECT	



SCALE: 1" = 1500'

CH 13
ALIGNMENT DIAGRAM

