

INDEX OF SHEETS:

SHEET NO.	SHEET
1	TITLE SHEET
2	SUMMARY OF QUANTITIES GENERAL NOTES
3	TYPICAL CROSS SECTIONS
4-7	PLAN SHEETS
8	SIDE ROAD & ENTRANCE DETAILS BUTT JOINT DETAIL
STANDARD	701001-01
STANDARD	701006-02
STANDARD	701301-02
STANDARD	701306-01
STANDARD	701901
STANDARD	BLR 24-1

STATE OF ILLINOIS
DEPARTMENT OF TRANSPORTATION

DIVISION OF HIGHWAYS
PLANS FOR PROPOSED
SURFACE TRANSPORTATION/RURAL PROGRAM
LOCAL AGENCY PAVEMENT PRESERVATION

FAS 1603 (CH 39) SECTION 08-00205-00-RS ADAMS COUNTY
PROJECT NO. RS-1603(101) JOB NO. C-96-221-08

COUNTY	ROUTE	SECTION	TOTAL SHEETS	SHEET
ADAMS	FAS 1603	08-00205-00-RS	8	1

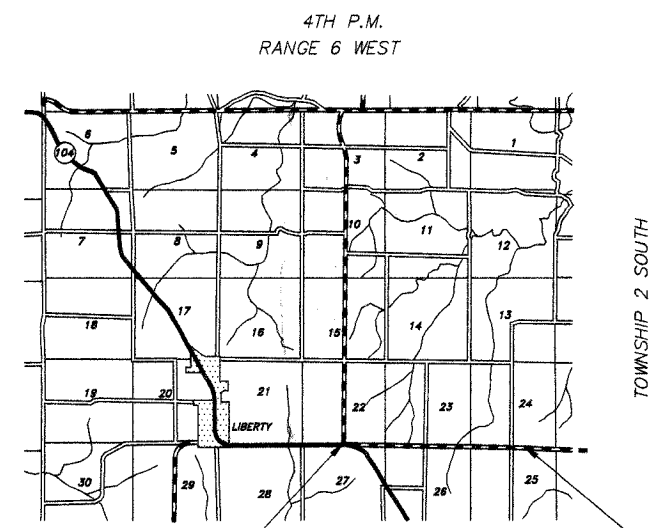
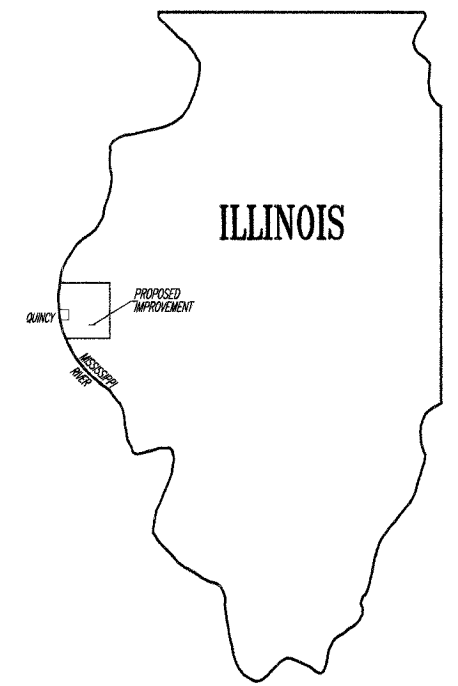

STATION 0+00
SEC. 08-00205-00-RS
BEGINS

STATION 105+60
SEC. 08-00205-00-RS
ENDS

LOCATION MAP

FUNCTIONAL CLASS: MAJOR COLLECTOR (NON-URBAN)
ADT=275

PROPOSED IMPROVEMENT CONSISTS OF PLACING 1 1/2" POLYMERIZED HOT-MIX ASPHALT SURFACE COURSE, MIX "C", N50 OVER 3/4" OF LEVELING BINDER (MACHINE METHOD) N50 ON THE EXISTING 22" ROADWAY WITH OTHER MISCELLANEOUS CONSTRUCTION

UTILITIES:

J.U.L.I.E.	1-800-892-0123
AMERITECH	QUINCY, IL
ADAMS RURAL ELECTRICAL CO-OP	CAMP POINT, IL
ABS WATER DISTRICT	GOLDEN, IL
MCLEOD USA	SPRINGFIELD, IL

GROSS LENGTH:

STA. 0+00.00 TO STA. 105+60.00 = 10,560.00 FT.
NET LENGTH TO BE IMPROVED: 10,560.00 FT. = 2.000 MILES

THESE PLANS WERE PREPARED BY ME OR BY A FULL-TIME MEMBER OF MY STAFF WORKING UNDER MY PERSONAL SUPERVISION.

SUBMITTED BY Ronald A. Klump DATE 2-26-08
COUNTY ENGINEER
LICENSE NO. 062-032961
LIC. EXPIRES 11/30/2009

APPROVED February 26th 2008
Ronald A. Klump COUNTY ENGINEER

PASSED FEB 31 2008
W.R. Jones DISTRICT ENGINEER OF CONSTRUCTION

PASSED APRIL 1ST 2008
Jim Jones DISTRICT ENGINEER OF LOCAL ROADS AND STREETS

RELEASING FOR BID BASED ON LIMITED REVIEW APRIL 1ST 2008
Christine M. Reed DEPUTY DIRECTOR OF HIGHWAYS REGION FOUR ENGINEER

STATE OF ILLINOIS
DEPARTMENT OF TRANSPORTATION

CONTRACT NO. 93456

COUNTY	ROUTE	SECTION	TOTAL SHEETS	SHEET NO.
ADAMS	FAS 1603	08-00205-00-RS	8	2

SUMMARY OF QUANTITIES - GENERAL NOTES

PROJECT NO. RS-1603(101)

GENERAL NOTES

- WHERE SECTION OR SUB-SECTION STONES, USGS BENCH MARK MONUMENTS, AND U.S. ARMY CORPS OF ENGINEERS SURVEY MARKERS ARE ENCOUNTERED, THE ENGINEER SHALL BE NOTIFIED BEFORE SUCH STONES AND MONUMENTS ARE REMOVED. THE CONTRACTOR SHALL PROTECT AND CAREFULLY PRESERVE ALL PROPERTY MARKS UNTIL AN OWNER, AN AUTHORIZED SURVEYOR OR THEIR REPRESENTATIVE HAS WITNESSED OR OTHERWISE REFERENCED THE PROPERTY MARKS LOCATION.
- ALL PRIVATELY OWNED UTILITIES, UNLESS OTHERWISE SPECIFIED, WILL BE MOVED BY THEIR RESPECTIVE OWNERS WHERE REQUIRED. THE FOLLOWING UTILITY COMPANIES HAVE FACILITIES WITHIN THE LIMITS OF CONSTRUCTION:

J.U.L.I.E.
ADAMS RURAL ELECTRICAL CO-OP
ABS WATER DISTRICT
AMERITECH
McLEOD USA

- THE NOMINAL THICKNESS FOR THE LEVELING BINDER, SURFACE COURSES AND AGGREGATE SHOULDERS ARE SHOWN ON THE TYPICAL SECTIONS, STANDARDS, SCHEDULES OR SPECIAL DETAILS. THE CONSTRUCTED THICKNESS OF THE ABOVE ITEMS SHALL NOT BE LESS THAN 90% OF THE NOMINAL THICKNESS AT ANY LOCATION. THE THICKNESS OF THE HOT-MIX ASPHALT MIXTURE SHOWN ON THE PLANS IS THE NOMINAL THICKNESS. DEVIATIONS FROM THE NOMINAL THICKNESS WILL BE PERMITTED WHEN SUCH DEVIATIONS OCCUR DUE TO IRREGULARITIES IN THE EXISTING SURFACE OR BASE WHICH THE HOT-MIX ASPHALT MIXTURE IS PLACED.
- THE CONTRACTOR SHALL BE RESPONSIBLE FOR DETERMINING THE LOCATION AND ELEVATION OF ALL EXISTING UTILITIES AND TO NOTIFY ALL UTILITY COMPANIES PRIOR TO THE BEGINNING OF CONSTRUCTION. THIS WILL BE CONSIDERED INCIDENTAL TO THE CONTRACT.
- APPLICATION RATES SHALL BE AS FOLLOWS UNLESS OTHERWISE SPECIFIED BY THE ENGINEER:
 - HOT-MIX ASPHALT MIXTURES
112 LBS PER SQUARE YARD
 - BITUMINOUS MATERIALS (PRIME COAT)
0.05-0.10 GALLON PER SQUARE YARD ON PCC OR BITUMINOUS CONCRETE
0.25-0.35 GALLON PER SQUARE YARD ON AGGREGATE
 - AGGREGATE (PRIME COAT)
4 LBS PER SQUARE YARD
- PERMANENT & TEMPORARY PAVEMENT MARKING TO BE DONE BY OTHERS. SHORT TERM PAVEMENT MARKING IS INCLUDED IN THE CONTRACT. THE REMOVAL OF THE SHORT TERM PAVEMENT MARKING TAPE WILL BE DONE BY OTHERS UPON COMPLETION OF THE PERMANENT PAVEMENT MARKING.

SUMMARY OF QUANTITIES

QUANTITY	UNIT	ITEM	CODE NO.	SPECIAL PROVISIONS
2,464	GALLON	BITUMINOUS MATERIALS (PRIME COAT)	40600100	*
49	TON	AGGREGATE (PRIME COAT)	40600300	
1,081	TON	LEVELING BINDER (MACHINE METHOD), N50	40600625	*
1	EACH	CONSTRUCTING TEST STRIP	40600895	
50	SQ. YD.	HOT-MIX ASPHALT SURFACE REMOVAL - BUTT JOINT	40600982	*
50	SQ. YD.	TEMPORARY RAMP	40600990	
81	TON	HOT-MIX ASPHALT SURFACE COURSE, MIX "C", N50	40603310	*
2,115	TON	POLYMERIZED HOT-MIX ASPHALT SURFACE COURSE, MIX "C", N50	40603510	*
1	L. SUM	MOBILIZATION	67100100	
1	L. SUM	TRAFFIC CONTROL AND PROTECTION	70101700	*
960	FOOT	SHORT TERM PAVEMENT MARKING	70300100	*

CONSTRUCTION TYPE CODE: I000

COUNTY	ROUTE	SECTION	TOTAL SHEETS	SHEET NO.
ADAMS	FAS 1603	08-00205-00-RS	8	3
TYPICAL CROSS SECTIONS				
PROJECT NO. RS-1603(101)				

TYPICAL CROSS SECTIONS

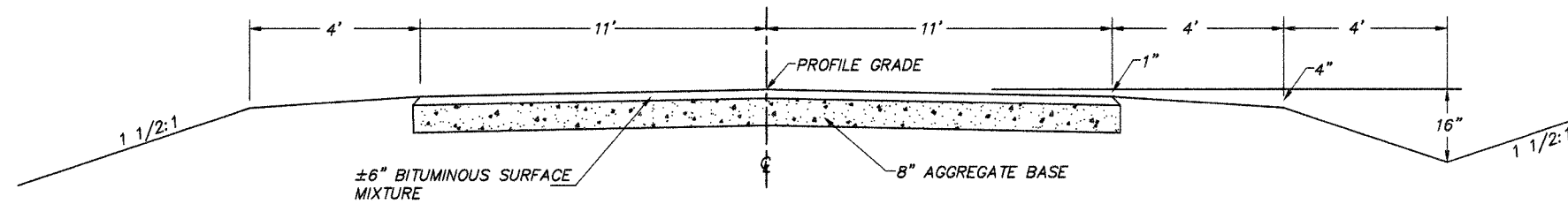

EXISTING CROSS SECTION

BUILT AS: SECTION 26-A-15d
STA. 0+00 TO STA. 105+60

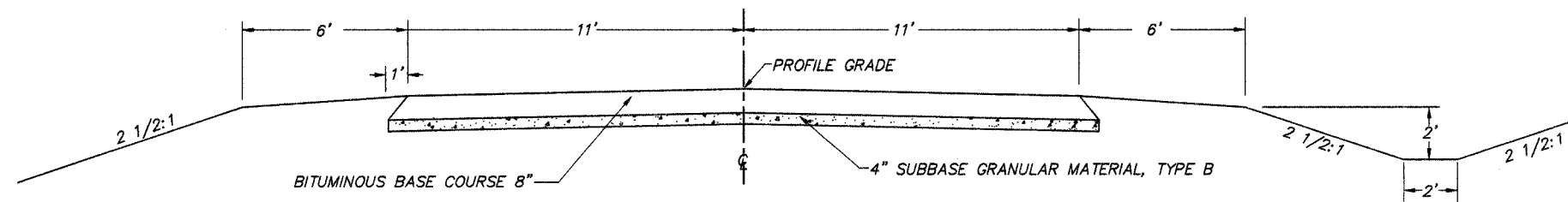

EXISTING CROSS SECTION

BUILT AS: CBF 704
STA. 68+13 TO STA. 68+93

HOT-MIX ASPHALT MIXTURE REQUIREMENTS

ITEM	ASPHALT GRADE	AGG. COMPOSITION	VOIDS
POLY. SURFACE	SBS PG 64-28	IL-9.5 or 12.5 MIX C	4.0% @ N50
SURFACE	PG 58-22	IL-9.5 or 12.5 MIX C	4.0% @ N50
LEVELING BINDER	PG 58-22	IL-9.5	4.0% @ N50

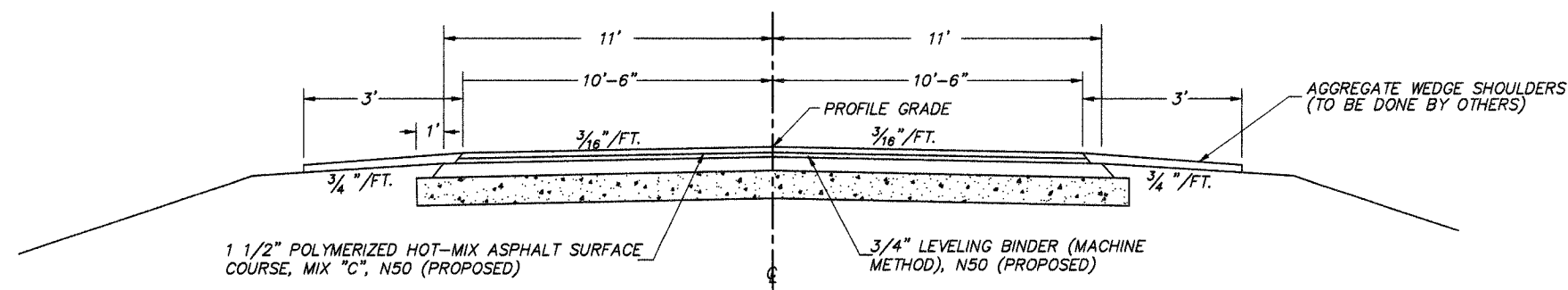

PROPOSED CROSS SECTION

STA. 0+00 TO STA. 105+60

COUNTY	ROUTE	SECTION	TOTAL SHEETS	SHEET NO.
ADAMS	FAS 1603	08-00205-00-RS	8	4
STATION 0+00 TO STATION 30+00				
PROJECT NO. RS-1603(101)				

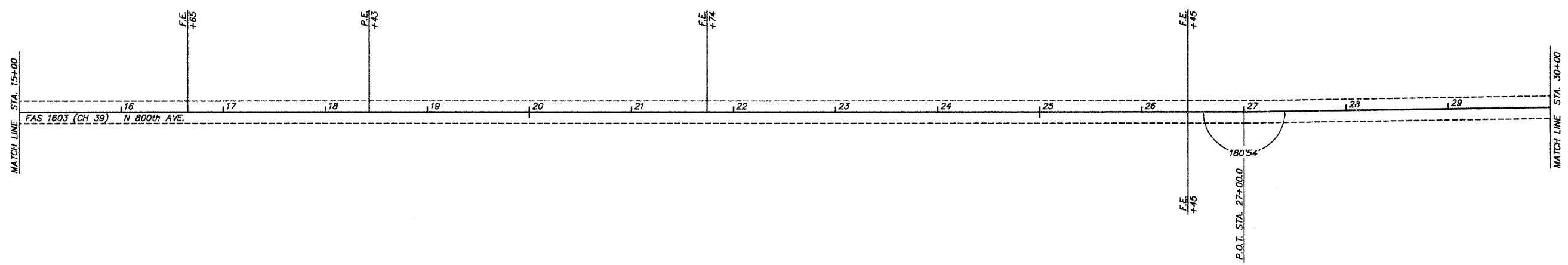
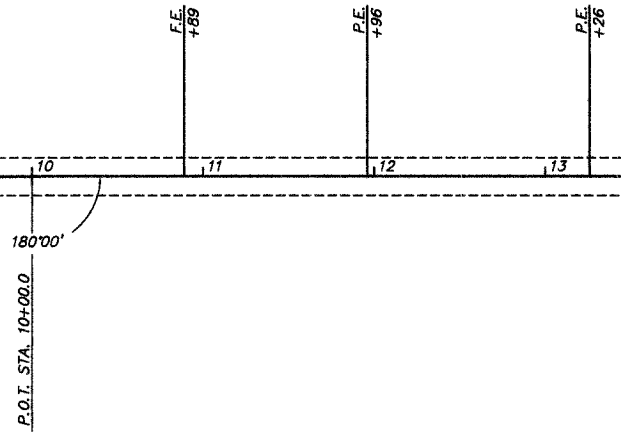
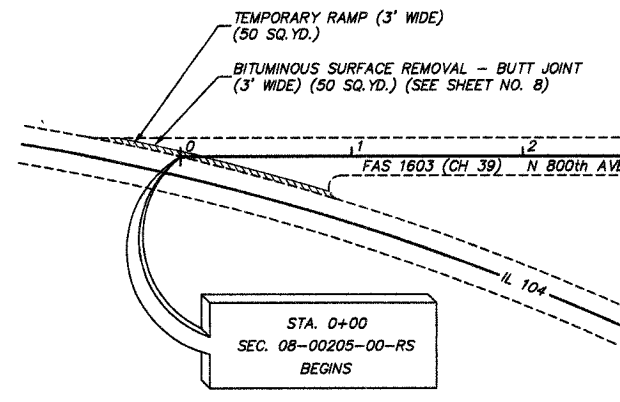
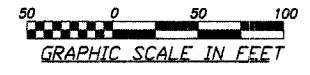

COUNTY	ROUTE	SECTION	TOTAL SHEETS	SHEET NO.
ADAMS	FAS 1603	08-00205-00-RS	8	5
STATION 30+00 TO STATION 60+00				
PROJECT NO. RS-1603(101)				

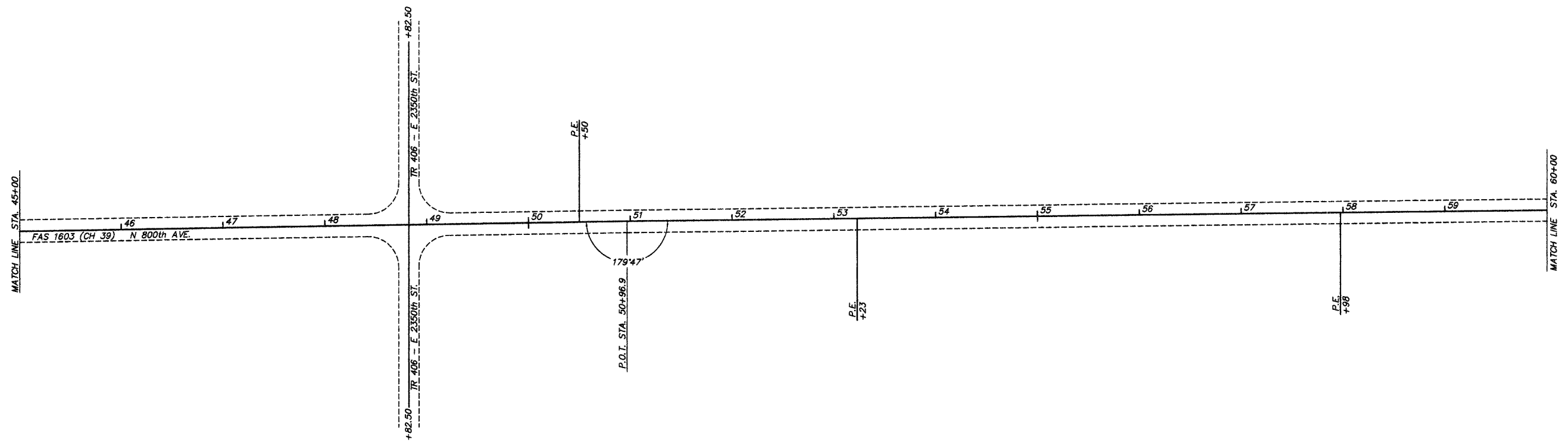
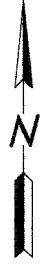
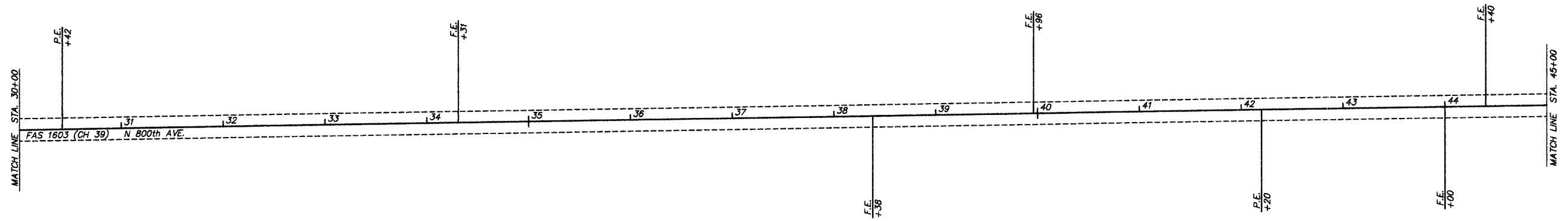
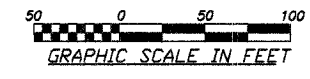

COUNTY	ROUTE	SECTION	TOTAL SHEETS	SHEET NO.
ADAMS	FAS 1603	08-00205-00-RS	8	6
STATION 60+00 TO STATION 90+00				
PROJECT NO. RS-1603(101)				

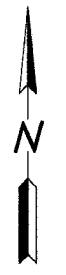
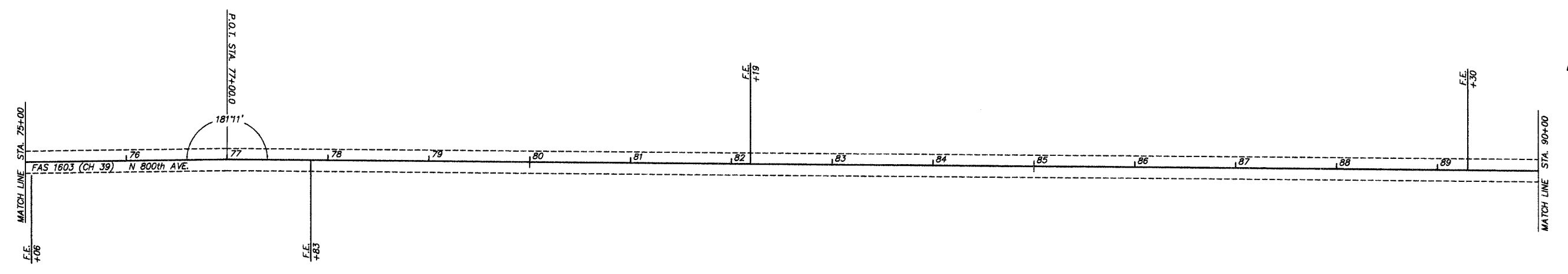
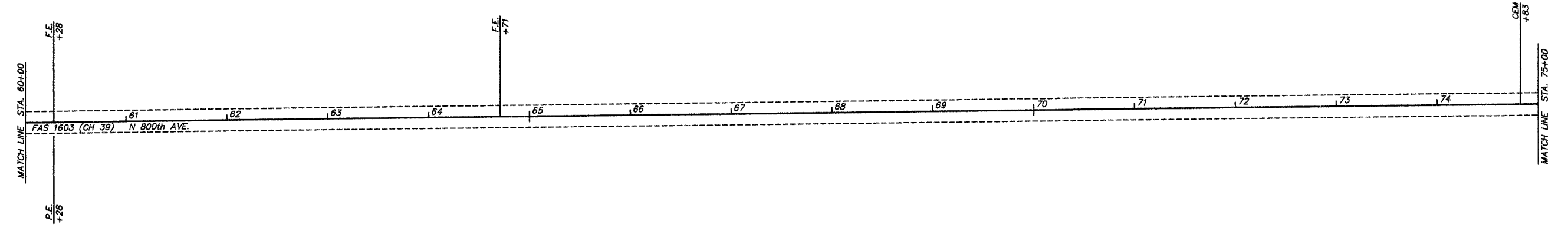
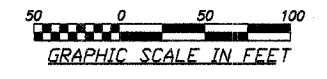

COUNTY	ROUTE	SECTION	TOTAL SHEETS	SHEET NO.
ADAMS	FAS 1603	08-00205-00-RS	8	7

STATION 90+00 TO STATION 105+00
PROJECT NO. RS-1603(101)

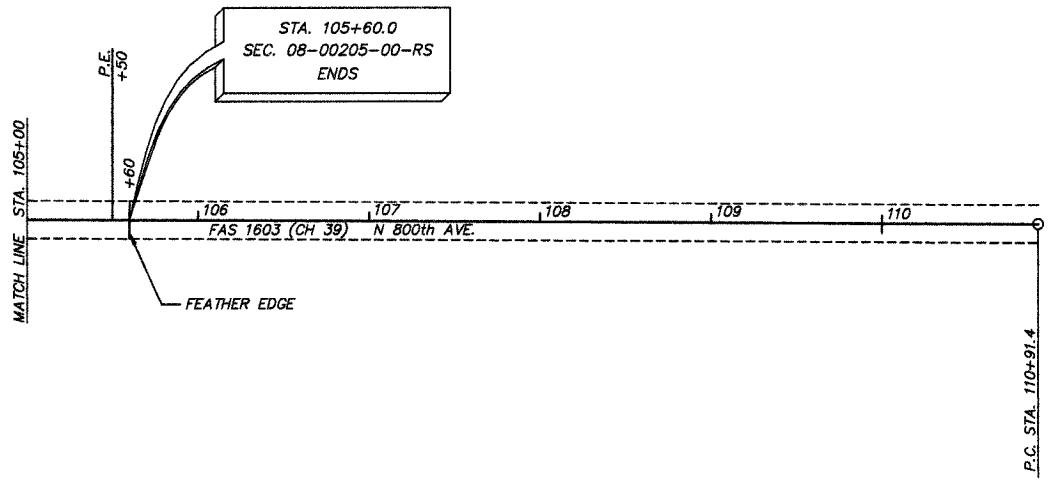
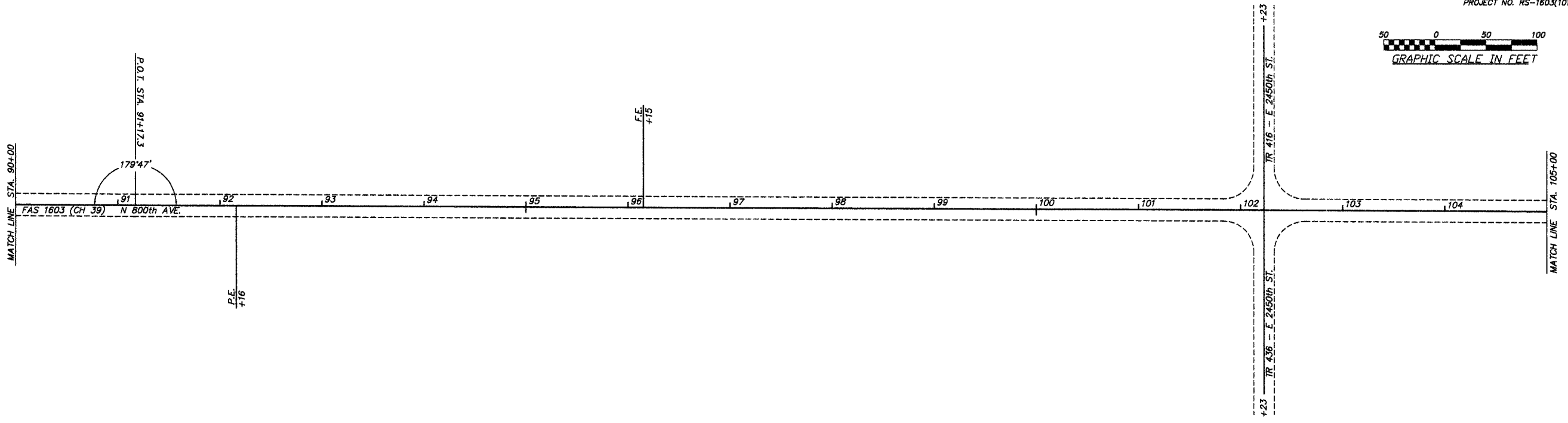
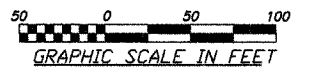

COUNTY	ROUTE	SECTION	TOTAL SHEETS	SHEET NO.
ADAMS	FAS 1603	08-00205-00-RS	8	8
BUTT JOINT DETAIL				
SIDE ROAD & ENTRANCE DETAILS				
PROJECT NO. RS-1603(101)				

BUTT JOINT DETAIL

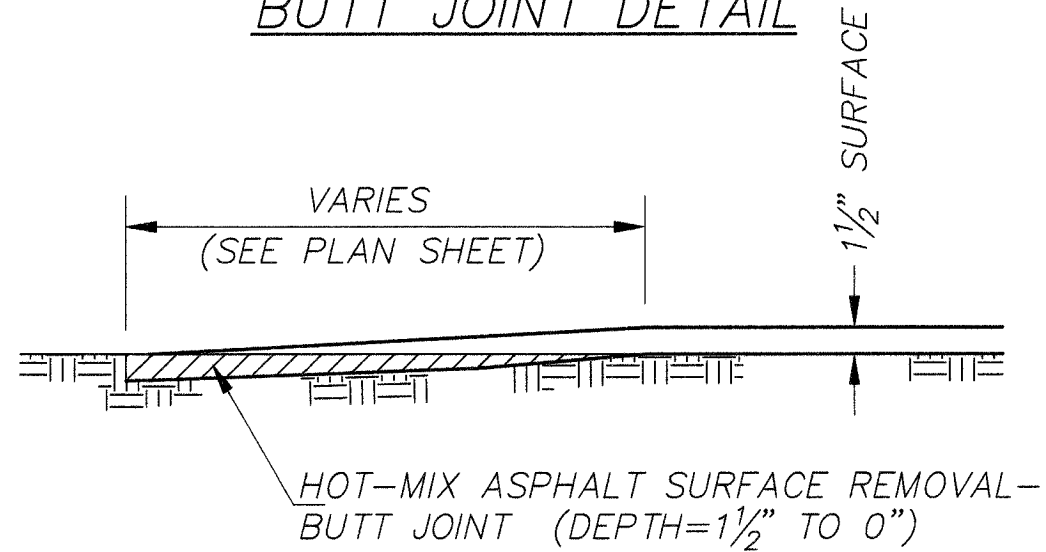

INTERSECTION DETAILS

ENTRANCE DETAILS

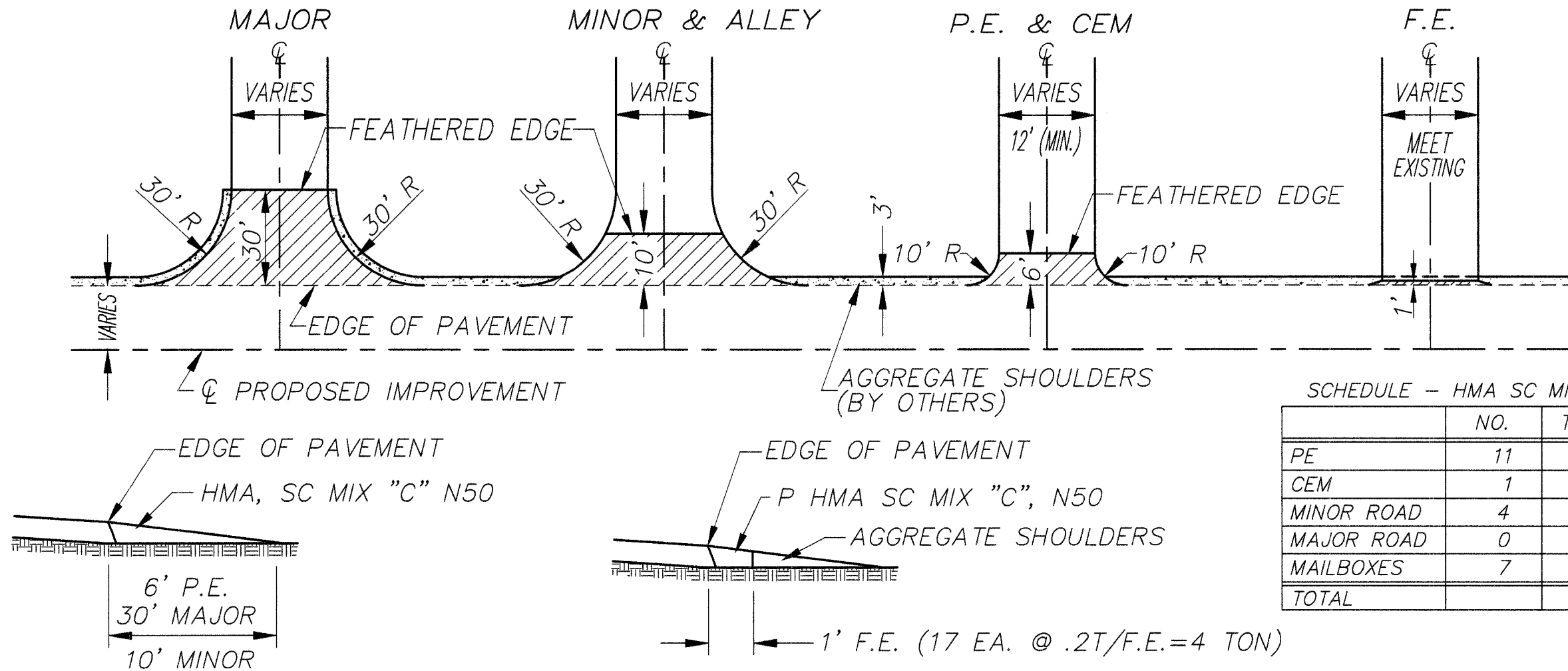

SCHEDULE - HMA SC MIX "C" N50

	NO.	TONS/	TONS
PE	11	2	22
CEM	1	2	2
MINOR ROAD	4	9	36
MAJOR ROAD	0	15	0
MAILBOXES	7	3	21
TOTAL			81