

F.A.U. ROUTE	SECTION	COUNTY	TOTAL SHEETS	SHEET NO.
8047	96-00379-00-PV	SANG	66	35
FED. ROAD DIST. NO.		ILLINOIS	FED. AID PROJECT	

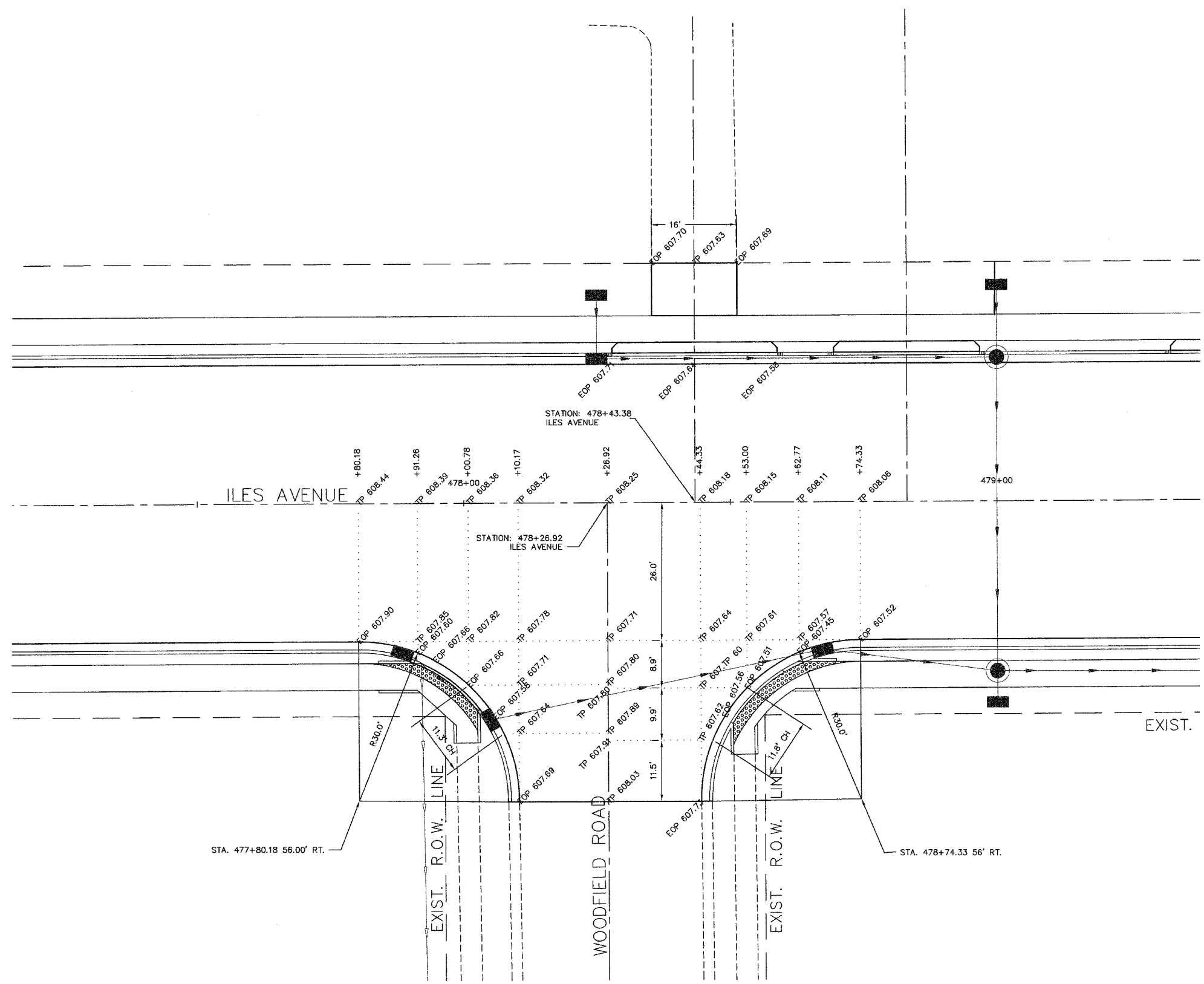
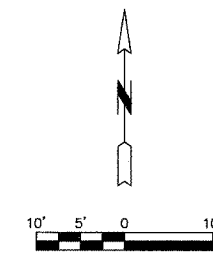

LEGEND
 TP - TOP OF PAVEMENT
 EOP - EDGE OF PAVEMENT

NOTES
 1) ALL SPOT ELEVATIONS AND DIMENSIONS THAT REFER TO CURBING REFERENCE THE FACE OF THE CURB (EOP), UNLESS OTHERWISE NOTED.

NO.	DATE	REVISION	BY
SHEET TITLE			
INTERSECTION DETAILS WOODFIELD ROAD			PROJECT NO. 96100
PROJECT			SCALE 1" = 10'
ILES AVENUE			DATE OCT., 2007
DRAWN BY MEC			CHECKED BY PBW
DRAWING TITLE C-INTR			DRAWING NO. 35
			OF 66 SHTS
<small>CONSULTING ENGINEERS AND SURVEYORS (ILLINOIS PROFESSIONAL DESIGN FIRM NO. 184-002843) 3223 S. MEADOWBROOK RD., SPRINGFIELD, ILLINOIS 62711 Phone: (217) 898-8900, Fax: (217) 898-8922, E-Mail: mecmart@martinengineeringco.com</small>			

Attached to: 96100\CONPLANS_2007\C-INTR.dwg, WOODFIELD, 3/21/2008 9:48 AM, RPOTTS, 1:1