

F.A.U. ROUTE	SECTION	COUNTY	TOTAL SHEETS	SHEET NO.
8047	96-00379-00-PV	SANG	66	36
FED. ROAD DIST. NO.		ILLINOIS	FED. AID PROJECT	

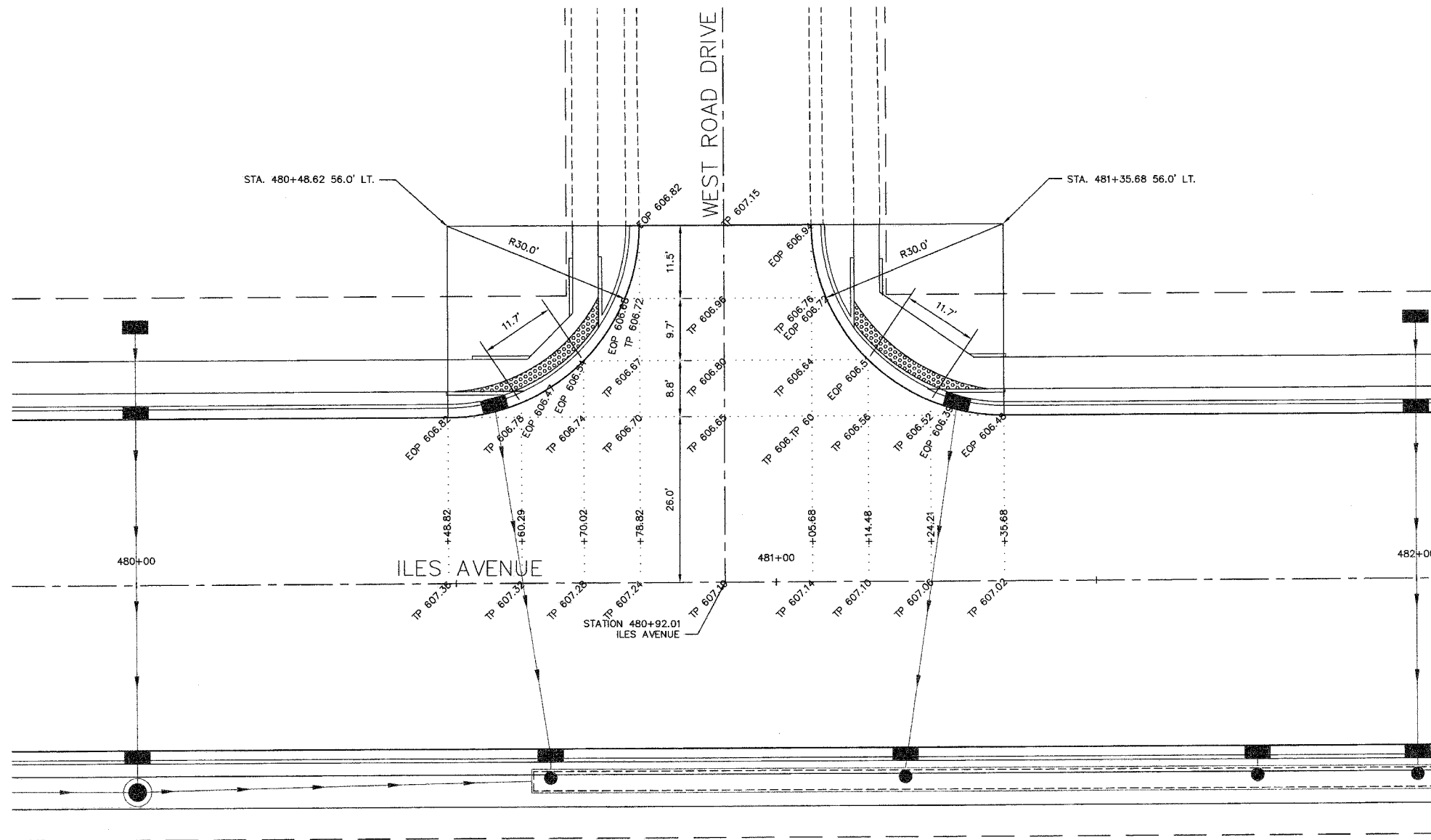
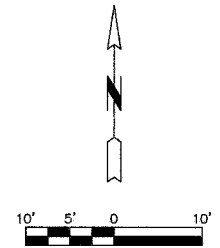

LEGEND
 TP - TOP OF PAVEMENT
 EOP - EDGE OF PAVEMENT

NOTES
 1) ALL SPOT ELEVATIONS AND DIMENSIONS THAT REFER TO CURBING REFERENCE THE FACE OF THE CURB (EOP), UNLESS OTHERWISE NOTED.

NO.	DATE	REVISION	BY
SHEET TITLE INTERSECTION DETAILS WEST ROAD DRIVE			
PROJECT ILES AVENUE		PROJECT NO. 06100	SCALE 1" = 10'
		DRAWN BY MEC	DATE OCT, 2007
		CHECKED BY PBW	DRAWING FILE C-INTR
		DRAWING NO. 36	OF 66 SHEETS
<small>CONSULTING ENGINEERS/LAND SURVEYORS (ILLINOIS PROFESSIONAL DESIGN FIRM NO. 184-002843) 3223 S. MEADOWBROOK RD., SPRINGFIELD, ILLINOIS 62711 Phone: (217) 698-8800, Fax: (217) 698-8922, E-Mail: meccna@martinengineeringco.com</small>			

Attached: 200710 CONPLANS_2007\C-INTR.dwg, WEST ROAD, 3/21/2008 9:48 AM, RPOTTS, 1:1
 1- BASE (E:\WORK\96100\CONPLANS_2007\1-BASE.dwg)
 2- INTR (E:\WORK\96100\CONPLANS_2007\1-INTR.dwg)