

F.A.U. ROUTE	SECTION	COUNTY	TOTAL SHEETS	SHEET NO.
8047	96-00379-00-PV	SANG	66	64
STA. 488+36.32 TO STA. 489+32.68				
FED. ROAD DIST. NO.		ILLINOIS	FED. AID PROJECT	

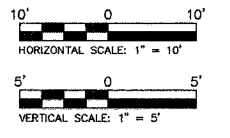
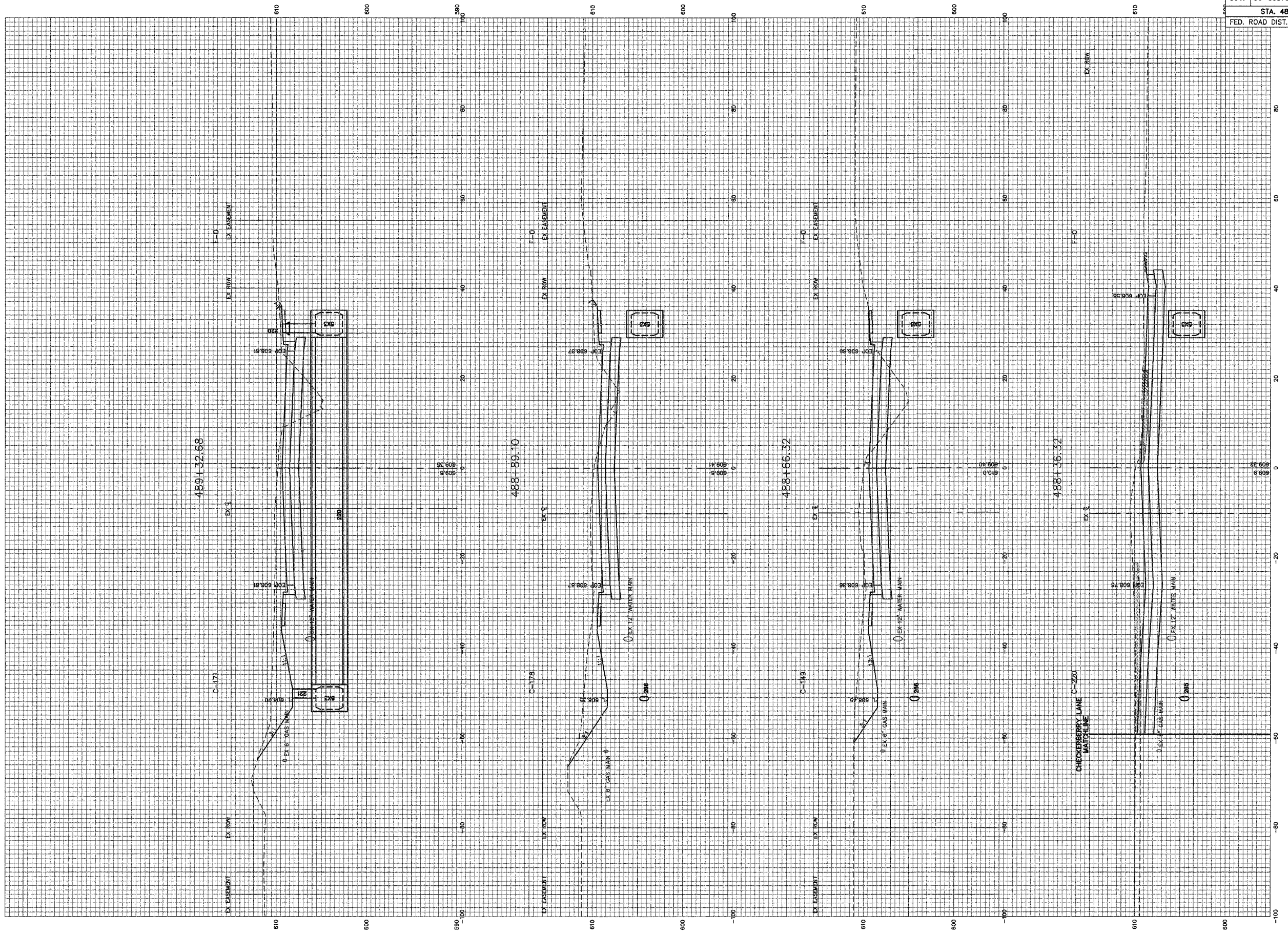

ILES AVENUE (FAU 8047) STA. 488+36.32 TO STA. 489+32.68

ATTACHED: XREF.dwg, Sheet 4
 3-TRIM (C:\Users\jrb100\COMP\ANSI_2007\A-TBL.dwg)