

F.A.U. ROUTE	SECTION	COUNTY	TOTAL SHEETS	SHEET NO.
8047	96-00379-00-PV	SANG	66	65
STA. 489+50 TO STA. 491+00				
FED. ROAD DIST. NO.	ILLINOIS	FED. AID PROJECT		

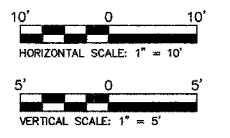
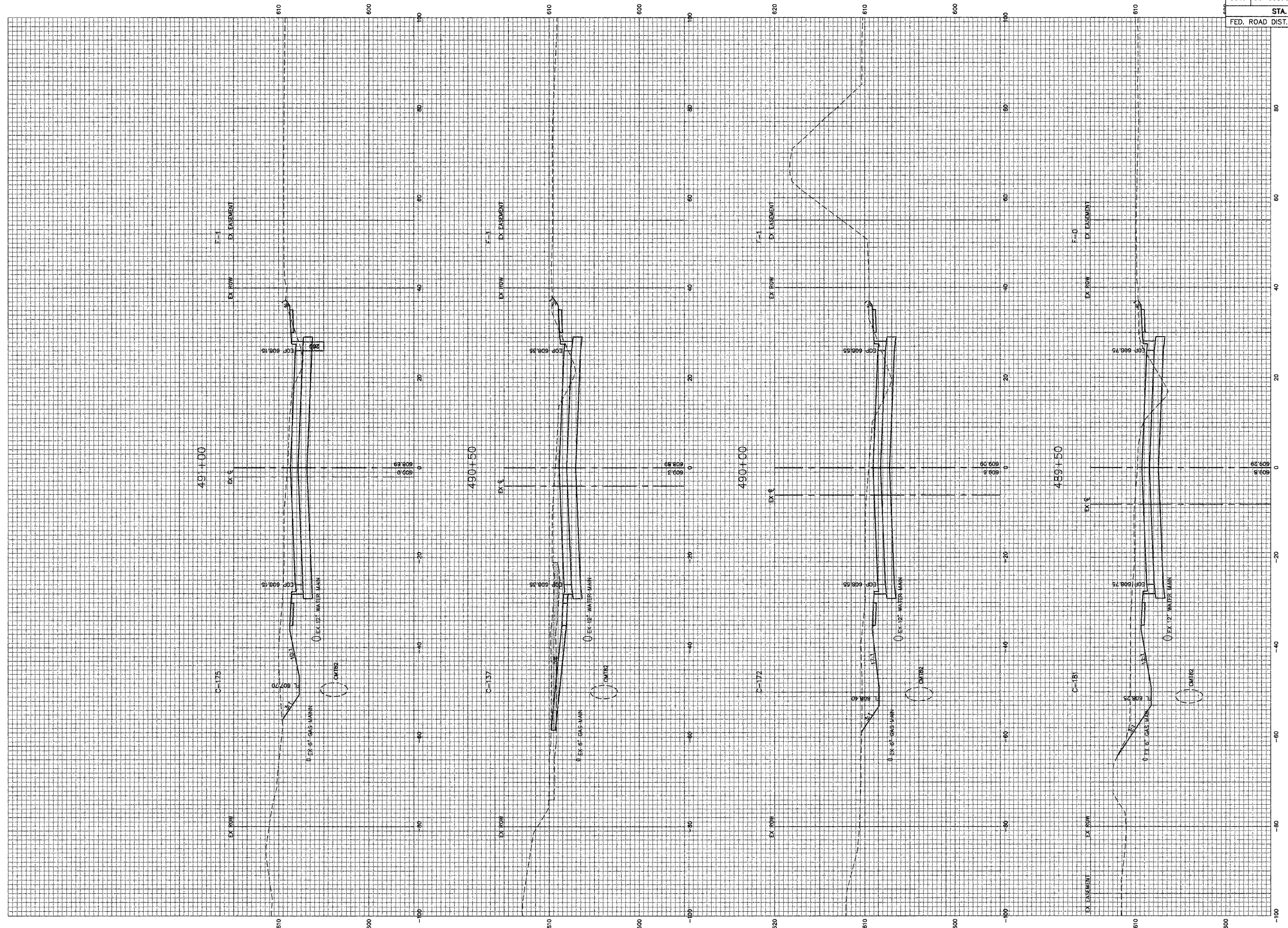

ILES AVENUE (FAU 8047) STA. 489+50 TO STA. 491+00

Attached 3/26/08 Rev'd 4/1
 3/26/08 10:32 AM (D:\proj\96100\CONPLANS_2007\C-XSEC-R2.dwg)