

F.A.U. ROUTE	SECTION	COUNTY	TOTAL SHEETS	SHEET NO.
8047	96-00379-00-PV	SANG	66	66
STA. 491+50 TO STA. 492+50				
FED. ROAD DIST. NO.	ILLINOIS	FED. AID PROJECT		

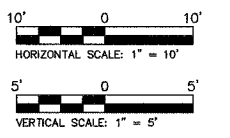
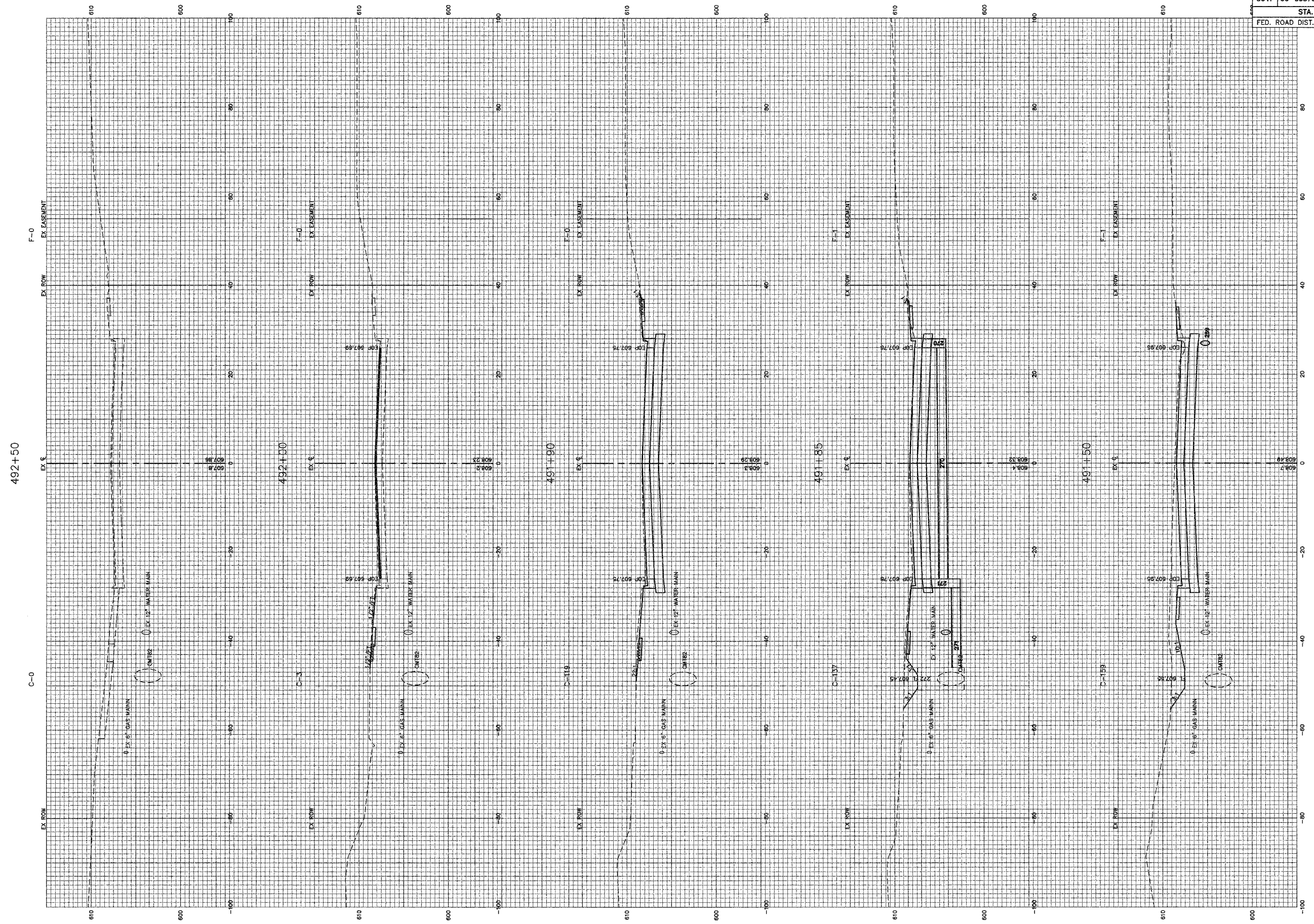

ILES AVENUE (FAU 8047) STA. 491+50 TO STA. 492+50

Attached to: 961001\CONPLANS\_2007\C-XSEC-R2.dwg, STA. 491+50 TO STA. 492+50, 3/21/2008 10:32 AM, RPOTTS, 1:1