

F.A.U.	SECTION	COUNTY	TOTAL SHEETS	SHEET NO.
7998	97-00030-06-WR	SANGAMON	117	34
FED. ROAD DIST. NO.		ILLINOIS	FED. AID PROJECT	

CURVE 3 DATA
 P.I. STA 45+66.81
 $\Delta = 58^\circ 10' 55''$ (RT)
 $D = 4^\circ 00' 00''$
 $T = 796.96'$
 $R = 1,432.39'$
 $L = 1,454.55'$
 $E = 206.78'$
 $e = 0.033'/'$
 $T.R = 49'$
 $S.E. RUN = 111'$
 P.C. STA 37+69.85
 P.T. STA 52+24.40

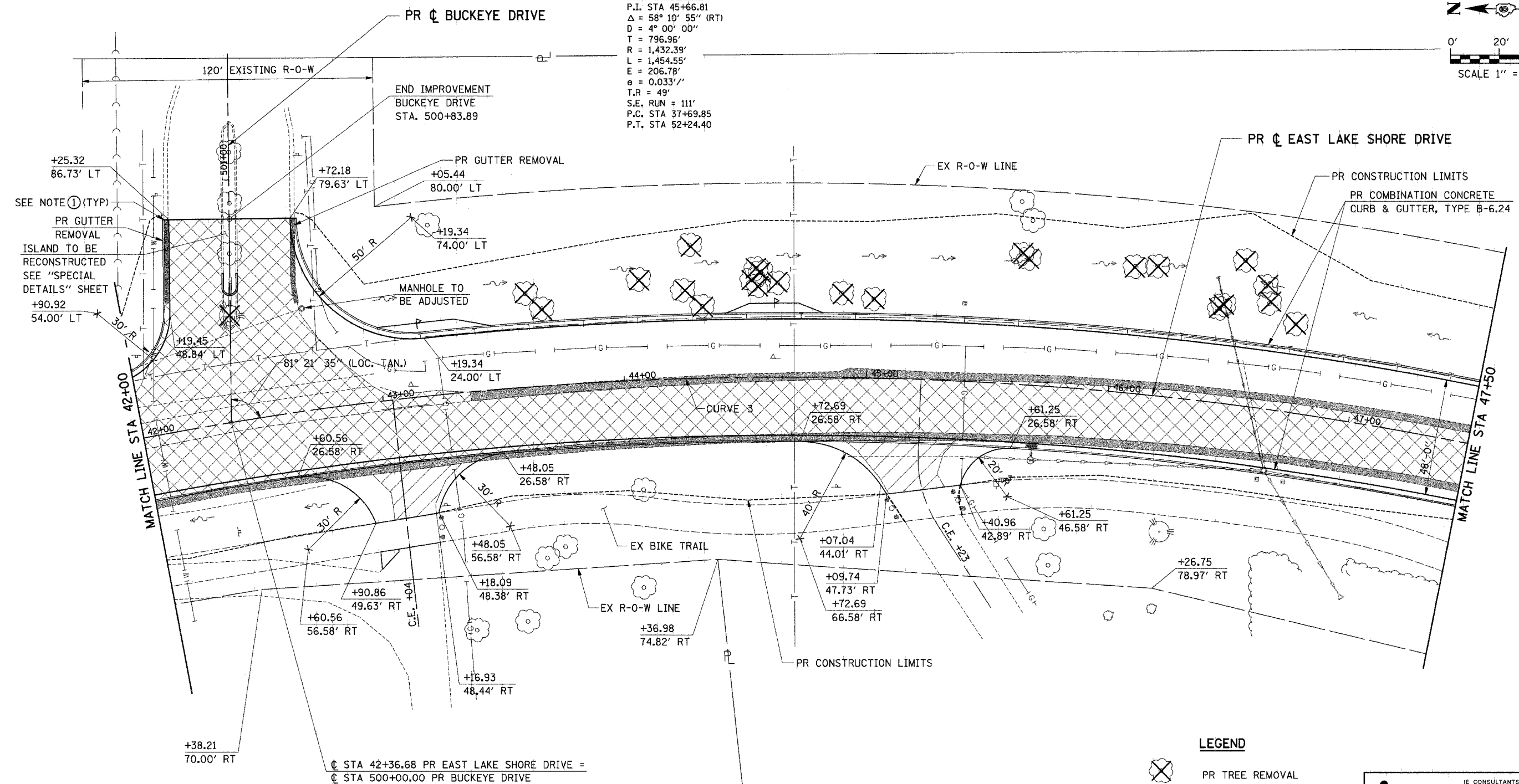
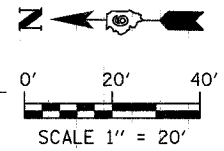

**B.M. #5 STA 42+43, 38' LT
 CHISELED "□" IN CURB, W. END
 OF MEDIAN PR BUCKEYE DRIVE
 ELEV. 589.40**

NOTES
 ① TRANSITION FROM PROPOSED COMBINATION CONCRETE CURB & GUTTER, TYPE B-6.24 TO EXISTING V-GUTTER OVER 10'. TRANSITION SHALL BE PAID FOR AS COMBINATION CONCRETE CURB & GUTTER, TYPE B-6.24

- LEGEND**
- PR TREE REMOVAL
 - PR HOT-MIX ASPHALT SURFACE REMOVAL (VARIABLE DEPTH)
 - PR PAVEMENT REMOVAL
 - PR DRIVEWAY PAVEMENT REMOVAL
 - PR PAVED SHOULDER REMOVAL

ie CONSULTANTS, INC.
 6420 SOUTH SIXTH STREET
 SPRINGFIELD, ILLINOIS 62712
 TEL. (217) 629-8027
 FAX (217) 629-4543
 IESPRINGFIELD@IE-CONSULTANTS.COM
 WWW.IE-CONSULTANTS.COM

**ROADWAY PLAN
 STA 42+00 TO STA 47+50**

DESIGNED BY: JEB	DRAWN BY: AAD	CHECKED BY: CMS	DATE: 4/4/08
---------------------	------------------	--------------------	-----------------