

FAU	SECTION	COUNTY	TOTAL SHEETS	SHEET NO.
7998	97-00030-06-WR	SANGAMON	117	67
FED. ROAD DIST. NO.		ILLINOIS	FED. AID PROJECT	

- (S-75) STA 47+88, 24.0' RT RD CATCH BASIN, 3' DIA, TYPE 3V FRAME & GRATE
EOP EL = 581.74
INV (S) = 578.80
INV (N) = 578.70
- (S-76) STA 48+03, 24.0' RT RD CATCH BASIN, 3' DIA, TYPE 3V FRAME & GRATE
EOP EL = 581.75
INV (S) = 579.00
INV (N) = 578.90
- (S-77) STA 49+00, 24.0' RT INLETS, TYPE A, TYPE 3V FRAME & GRATE
EOP EL = 582.23
INV (N) = 579.50
- (S-78) STA 50+30, 24.0' RT INLETS, TYPE A, TYPE 3V FRAME & GRATE
EOP EL = 583.03
INV (S) = 579.00
- (S-79) STA 50+30, 29.5' RT RD MANHOLES, 4' DIA, TYPE 1 FRAME, CLID
RIM EL = 583.60
INV (E) = 578.90
INV (S) = 578.72
CONNECT TO EX 12" SS
- (S-80) STA 51+04, 24.0' RT MANHOLES TO BE ADJUSTED w/ NEW TYPE 3V FRAME & GRATE
EOP EL = 583.48
EX INV (NE, SW) = 577.00
INV (E) = 575.10
EX INV (W) = 575.00
- (S-81) STA 50+55, 70.6' LT PRECAST REINFORCED CONCRETE FLARED END SECTIONS 24"
INV (W) = 577.00
- (S-82) STA 51+80, 24.0' RT INLETS, TYPE A, TYPE 3V FRAME & GRATE
EOP EL = 583.95
INV (W) = 579.34
- (S-83) STA 51+80, 29.7' RT RD MANHOLES, 4' DIA, TYPE 1 FRAME, CLID
RIM EL = 584.90
INV (E) = 579.24
INV (S) = 579.14
CONNECT TO EX 12" SS

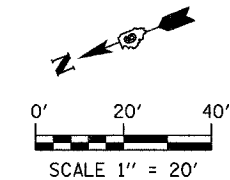

NOTES:
 ① PIPE CULVERT REMOVAL (R.C.P 21") = 84'

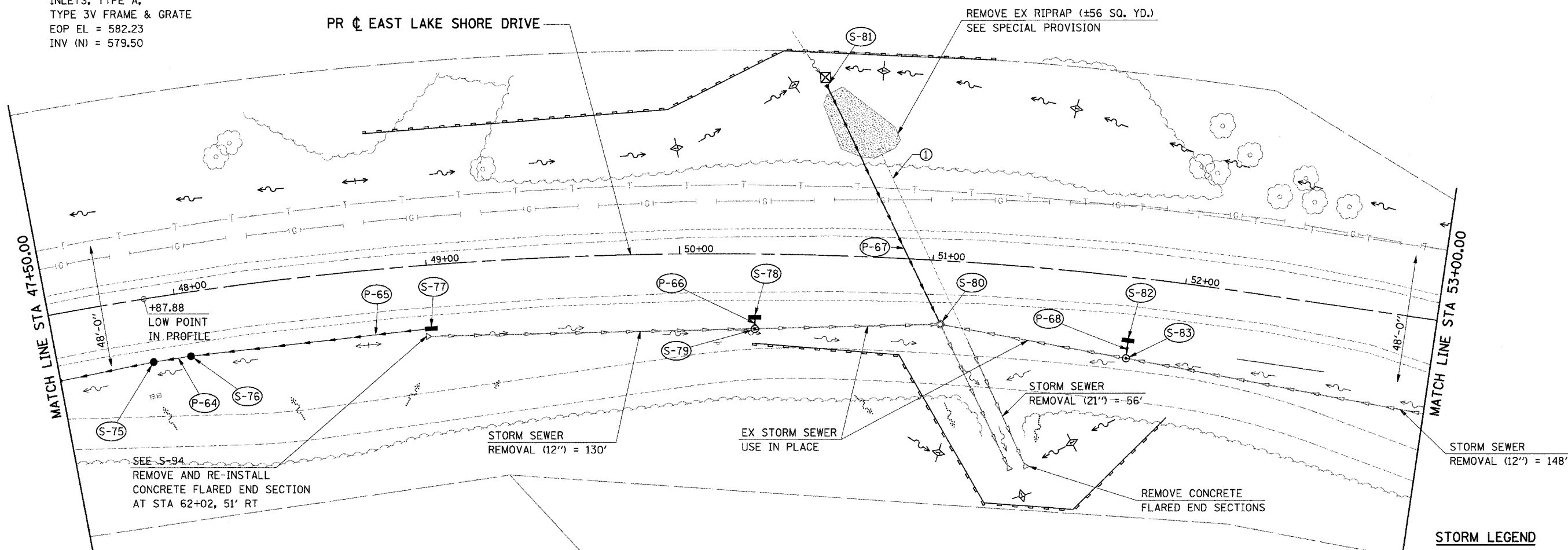

- (P-64) S-76 TO S-75 // 15' @ 0.67%
STORM SEWERS, CLASS A, TYPE 1 12"
- (P-65) S-77 TO S-76 // 95' @ 0.53%
STORM SEWERS, CLASS A, TYPE 1 12"
- (P-66) S-78 TO S-79 // 2' @ 5.00%
STORM SEWERS, CLASS A, TYPE 2 12"
- (P-67) S-81 TO S-80 // 102' @ 1.73%
STORM SEWERS, CLASS A, TYPE 2 24"
- (P-68) S-82 TO S-83 // 4' @ 2.50%
STORM SEWERS, CLASS A, TYPE 2 12"

- EROSION/SEDIMENT LEGEND**
- ◆ TEMPORARY DITCH CHECK
 - ⊕ INLET & PIPE PROTECTION
 - PERIMETER EROSION BARRIER
 - ↔ EX DITCH SUMMIT
 - ↔ PR DITCH SUMMIT
 - EX FLOW LINE
 - PR FLOW LINE
 - PR SWALE
 - ... EX SHEET FLOW
 - ... PR SHEET FLOW
 - ▨ PR RIP RAP

- STORM LEGEND**
- INLET
 - CATCH BASIN
 - MANHOLE
 - STORM SEWER
 - ◄ FLARED END SECTION

ie consultants
 IE CONSULTANTS, INC.
 8420 SOUTH SIXTH STREET
 SPRINGFIELD, ILLINOIS 62712
 TEL: (217) 529-8027
 FAX: (217) 529-4543
 IESPRINGFIELD@IE-CONSULTANTS.COM
 WWW.IE-CONSULTANTS.COM

DRAINAGE PLAN
STA 47+50 TO STA 53+00

DESIGNED BY: JEB	DRAWN BY: AAD	CHECKED BY: CMS	DATE: 4/4/08
---------------------	------------------	--------------------	-----------------