

FAU	SECTION	COUNTY	TOTAL SHEETS	SHEET NO.
7998	97-00030-06-WR	SANGAMON	117	68
FED. ROAD DIST. NO.		ILLINOIS	FED. AID PROJECT	

- NOTES:
- ① PIPE CULVERT REMOVAL (C.M.P. 24") - 23'
 - ② PIPE CULVERT REMOVAL (R.C.P. 15") - 24'
 - ③ PIPE CULVERT REMOVAL (C.M.P. 12") - 31'
 - ④ PIPE CULVERT REMOVAL (R.C.P. 15") - 92'

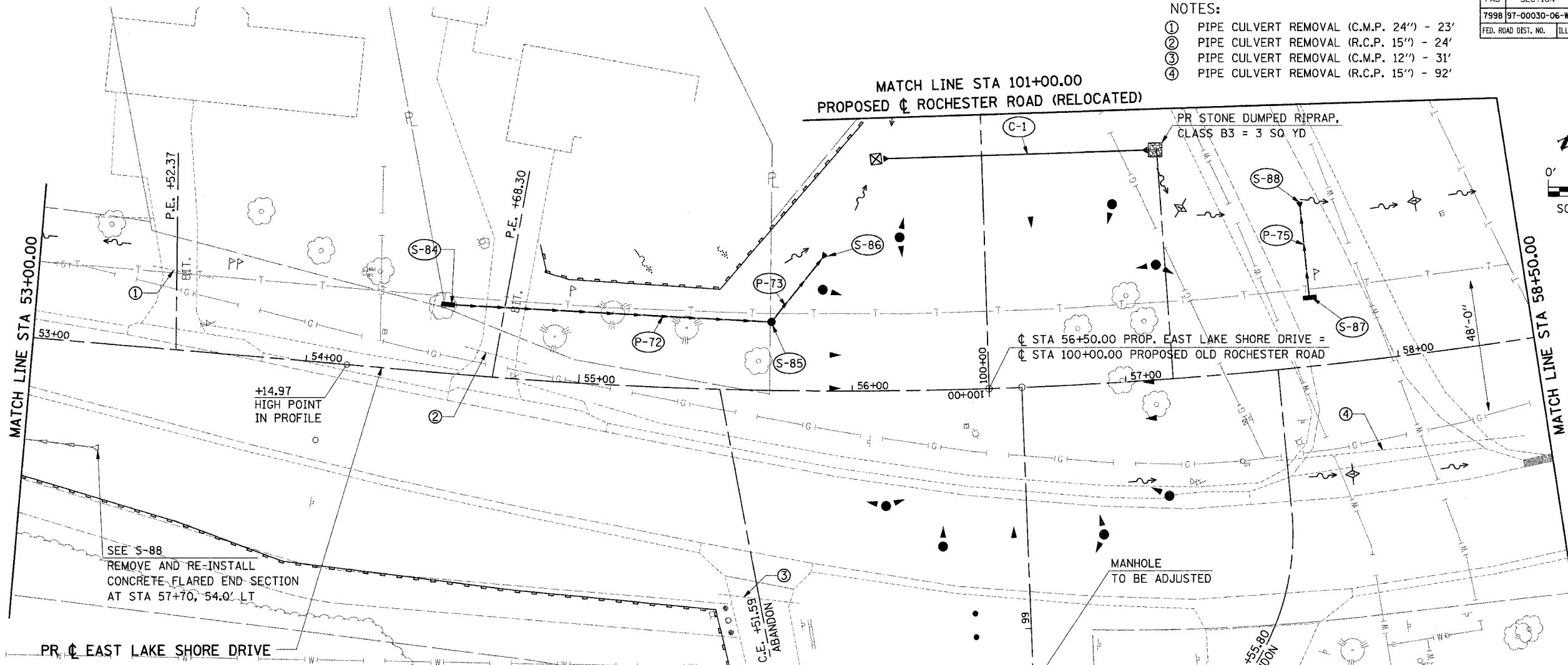
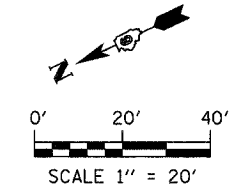

- (S-84) STA 54+50, 24.0' LT INLETS, TYPE A, TYPE 3V FRAME & GRATE
EOP EL = 585.20
INV (S) = 582.35
- (S-85) STA 55+70, 24.0' LT RD CATCH BASIN, 3' DIA, TYPE 3V FRAME & GRATE
EOP EL = 584.48
INV (N) = 581.45
INV (S) = 581.45
- (S-86) STA 55+90, 50.0' LT PRECAST REINFORCED CONCRETE FLARED END SECTIONS 15"
INV (W) = 580.75
- (S-87) STA 57+70, 24.0' LT INLETS, TYPE A, TYPE 3V FRAME & GRATE
EOP EL = 582.59
INV (E) = 578.70
- (S-88) STA 57+70, 54.0' LT PRECAST REINFORCED CONCRETE FLARED END SECTIONS 12"
INV (W) = 578.14
(END SECTION TAKEN FROM STA 53+25, 38' RT)
- (P-72) S-84 TO S-85 // 118' @ 0.76% STORM SEWERS, CLASS A, TYPE 1 12"
- (P-73) S-85 TO S-86 // 26' @ 2.20% STORM SEWERS, CLASS A, TYPE 1 15"
- (P-75) S-87 TO S-88 // 22' @ 2.00% STORM SEWERS, CLASS A, TYPE 1 12"
- (C-1) STA 56+12.3, 84.6' LT TO STA 57+13.8, 83.8' LT PIPE CULVERTS, CLASS A, TYPE 1 24" - 84" @ 0.52% PRECAST REINFORCED CONCRETE FLARED END SECTIONS 24" - 2 EACH
INV 579.00 @ 84.6' LT, STA 56+12.3
INV 578.50 @ 83.8' LT, STA 57+13.8

- EROSION/SEDIMENT LEGEND**
- ◇ TEMPORARY DITCH CHECK
 - ◇ INLET & PIPE PROTECTION
 - PERIMETER EROSION BARRIER
 - EX DITCH SUMMIT
 - PR DITCH SUMMIT
 - EX FLOW LINE
 - PR FLOW LINE
 - PR SWALE
 - EX SHEET FLOW
 - PR SHEET FLOW
 - PR RIP RAP

- STORM LEGEND**
- INLET
 - CATCH BASIN
 - MANHOLE
 - STORM SEWER
 - ▲ FLARED END SECTION

ie consultants
 IE CONSULTANTS, INC.
 8420 SOUTH SIXTH STREET
 SPRINGFIELD, ILLINOIS 62712
 TEL. (217) 529-8027
 FAX (217) 529-4543
 IESPRINGFIELD@IE-CONSULTANTS.COM
 WWW.IE-CONSULTANTS.COM

**DRAINAGE PLAN
 STA 53+00 TO STA 58+50**

DESIGNED BY:	DRAWN BY:	CHECKED BY:	DATE:
JEB	AAD	CMS	4/4/08