

| | | | | |
|---------------------|--------------|----------|------------------|-----------|
| F.A.P. RTE. | SECTION | COUNTY | TOTAL SHEETS | SHEET NO. |
| 781 | 1YRS, 2ZRS-1 | CRAWFORD | 378 | 168 |
| STA. | | TO STA. | | |
| FED. ROAD DIST. NO. | | ILLINOIS | FED. AID PROJECT | |

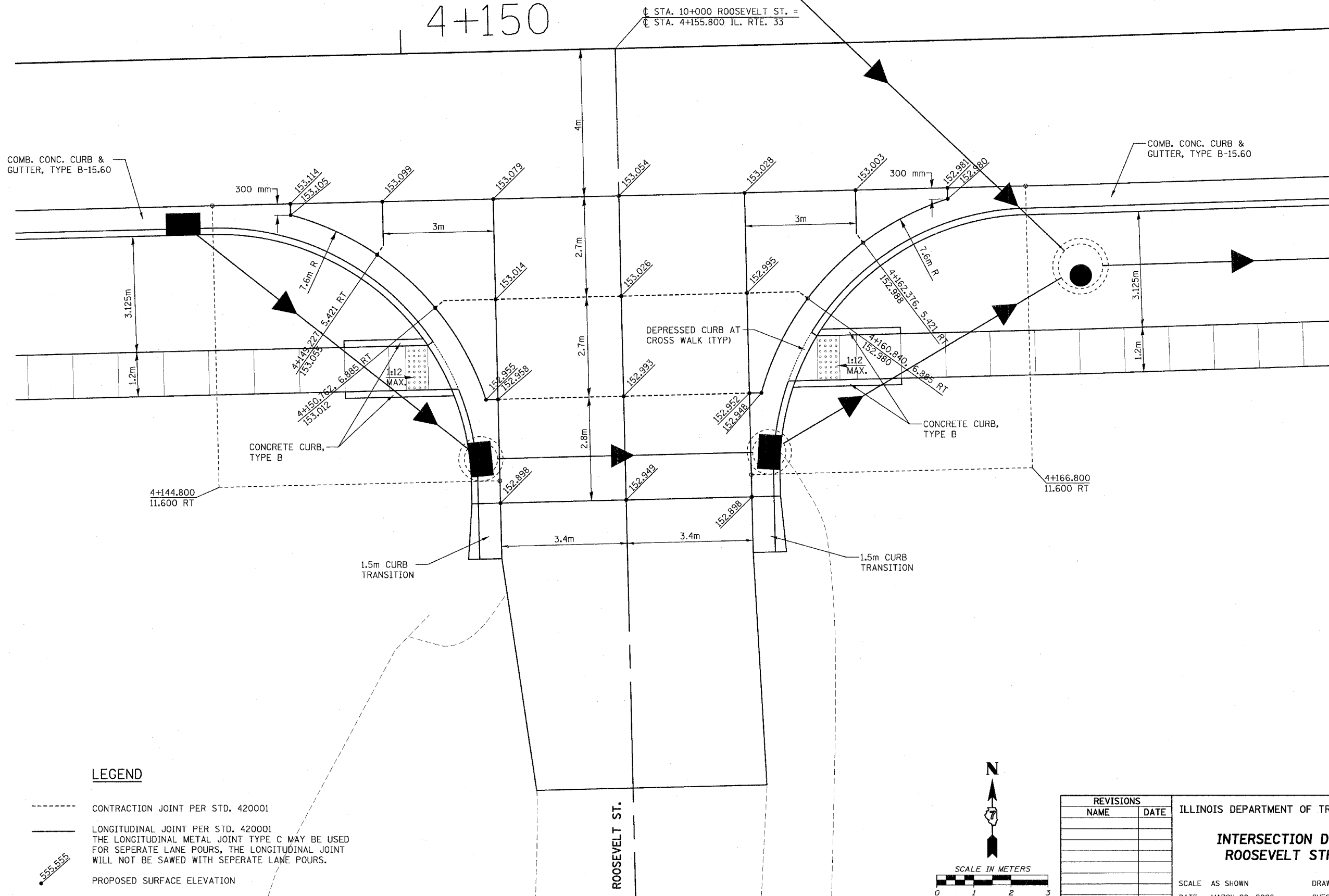

LEGEND

- CONTRACTION JOINT PER STD. 420001
- LONGITUDINAL JOINT PER STD. 420001
THE LONGITUDINAL METAL JOINT TYPE C MAY BE USED FOR SEPERATE LANE POURS, THE LONGITUDINAL JOINT WILL NOT BE SAWED WITH SEPERATE LANE POURS.
- 555.555 PROPOSED SURFACE ELEVATION

| REVISIONS | |
|-----------|------|
| NAME | DATE |
| | |
| | |
| | |
| | |
| | |
| | |
| | |
| | |
| | |
| | |

ILLINOIS DEPARTMENT OF TRANSPORTATION

**INTERSECTION DETAIL
ROOSEVELT STREET**

SCALE AS SHOWN DRAWN BY EDW
DATE MARCH 20, 2008 CHECKED BY RGH

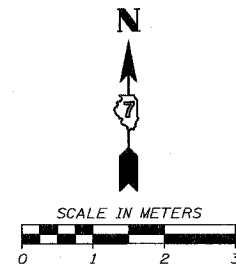

PLOT DATE = 3/20/2008
 FILE NAME = H:\4426\78168.int.Road1.dgn

H. M. & G. NO. 4420