

F.A.P. RTE.	SECTION	COUNTY	TOTAL SHEETS	SHEET NO.
332		WABASH	36	28
STA.		TO STA.		
FED. ROAD DIST. NO.	ILLINOIS	FED. AID PROJECT		

(122,12,13)RS-3

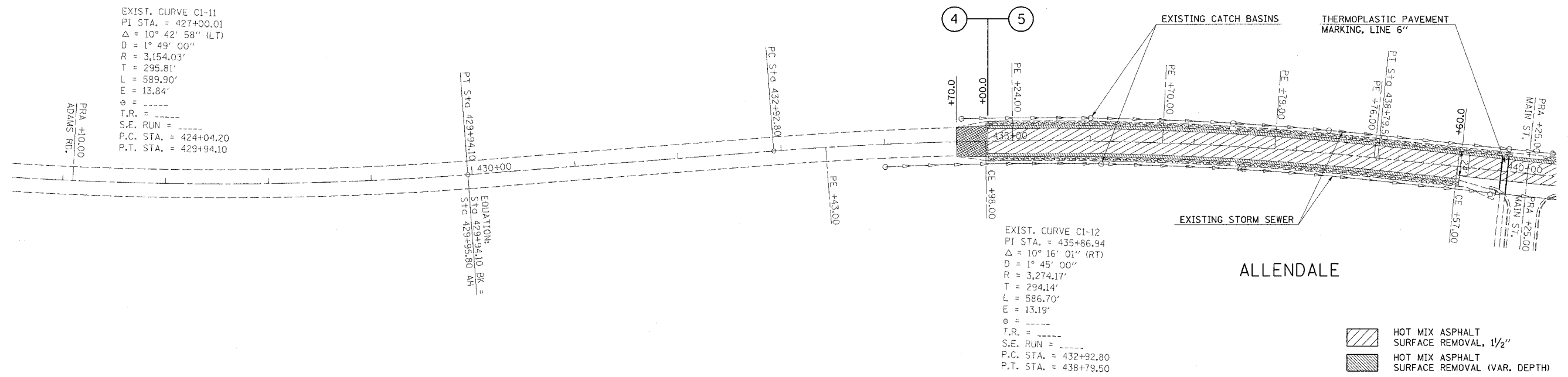

EXIST. CURVE C1-11  
 PI STA. = 427+00.01  
 $\Delta = 10^\circ 42' 58''$  (LT)  
 $D = 1^\circ 49' 00''$   
 $R = 3,154.03'$   
 $T = 295.81'$   
 $L = 589.90'$   
 $E = 13.84'$   
 $\theta = \dots$   
 T.R. = \dots  
 S.E. RUN = \dots  
 P.C. STA. = 424+04.20  
 P.T. STA. = 429+94.10

EXIST. CURVE C1-12  
 PI STA. = 435+86.94  
 $\Delta = 10^\circ 16' 01''$  (RT)  
 $D = 1^\circ 45' 00''$   
 $R = 3,274.17'$   
 $T = 294.14'$   
 $L = 586.70'$   
 $E = 13.19'$   
 $\theta = \dots$   
 T.R. = \dots  
 S.E. RUN = \dots  
 P.C. STA. = 432+92.80  
 P.T. STA. = 438+79.50

- HOT MIX ASPHALT SURFACE REMOVAL, 1/2"
- HOT MIX ASPHALT SURFACE REMOVAL (VAR. DEPTH)
- HOT MIX ASPHALT SURFACE REMOVAL, VARIABLE DEPTH (PAVEMENT TRANSITION)
- PAVED SHOULDER REMOVAL

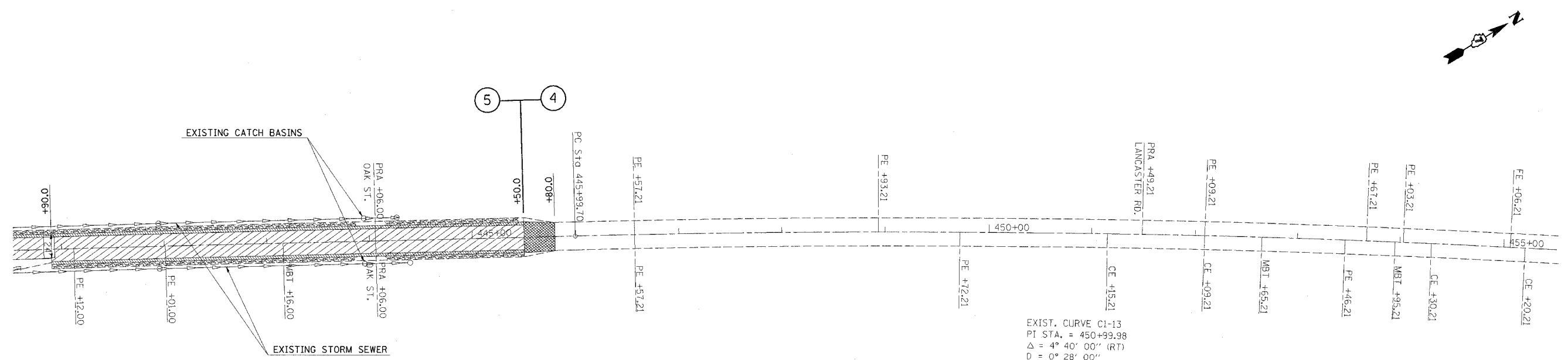

EXIST. CURVE C1-13  
 PI STA. = 450+99.98  
 $\Delta = 4^\circ 40' 00''$  (RT)  
 $D = 0^\circ 28' 00''$   
 $R = 12,277.70'$   
 $T = 500.28'$   
 $L = 1,000.00'$   
 $E = 10.19'$   
 $\theta = \dots$   
 T.R. = \dots  
 S.E. RUN = \dots  
 P.C. STA. = 445+99.70  
 P.T. STA. = 455+99.70

- HOT MIX ASPHALT SURFACE REMOVAL, 1/2"
- HOT MIX ASPHALT SURFACE REMOVAL (VAR. DEPTH)
- HOT MIX ASPHALT SURFACE REMOVAL, VARIABLE DEPTH (PAVEMENT TRANSITION)
- PAVED SHOULDER REMOVAL

PLOT DATE = 3/28/2007  
 FILE NAME = c:\p\proj\05\94984\plan\_l.dgn  
 PLOT SCALE = 50.0000' / IN.  
 USER NAME = murtcr