

STATE OF ILLINOIS  
DEPARTMENT OF TRANSPORTATION

PLANS FOR PROPOSED  
HIGHWAY BRIDGE PROGRAM

TR 175A OVER LAMOTTE CREEK  
SECTION 07-03123-00-BR  
CRAWFORD COUNTY  
PROJECT NO. BROS-033(049)  
JOB NO. C-97-076-08

ROUTE	SECTION	COUNTY	TOTAL SHEETS	SHEET NO.
TR 175A	07-03123-00-BR	CRAWFORD	11	1
		ILLINOIS	FEDERAL AID PROJECT	
CONTRACT NO. 95556				

INDEX OF SHEETS

- COVER SHEET
- SUMMARY OF QUANTITIES AND TYPICAL SECTIONS
- PLAN AND PROFILE OF ROADWAY
- CROSS SECTIONS OF ROADWAY
- GENERAL PLAN AND ELEVATION
- 7.-8. PRECAST PRESTRESSED CONCRETE DECK BEAM DETAILS
- STEEL RAILING, TYPE SM DETAILS
- ABUTMENT DETAILS
- PIER DETAILS

- 000001-05 STANDARD SYMBOLS, ABBREVIATIONS AND PATTERNS  
515001-02 NAME PLATE FOR BRIDGES  
630301-04 SHOULDER WIDENING FOR TYPE 1 (SPECIAL) GUARDRAIL TERMINALS  
631032-03 TRAFFIC BARRIER TERMINAL, TYPE 6A  
635006-02 REFLECTOR AND TERMINAL MARKER PLACEMENT  
701901 TRAFFIC CONTROL DEVICES  
BLR 21-7 TYPICAL APPLICATION OF TRAFFIC CONTROL DEVICES FOR CONSTRUCTION ON RURAL LOCAL HIGHWAYS

SOIL BORINGS (SEE SPECIFICATIONS)

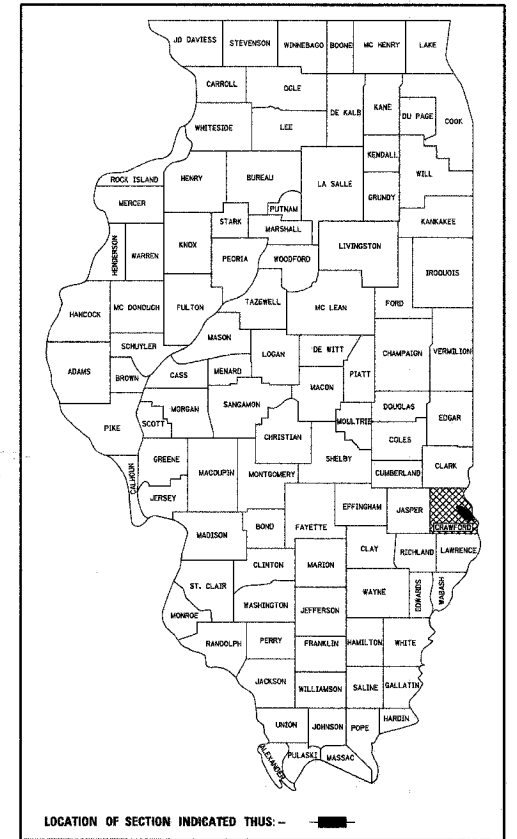

CRAWFORD COUNTY  
HIGHWAY DEPARTMENT

APPROVED April 9, 20 08  
*Justin R. Hill*  
CRAWFORD COUNTY, COUNTY ENGINEER

PASSED 4-11, 20 08  
*Maureen E. Kestel*  
DISTRICT SEVEN ENGINEER OF LOCAL ROADS & STREETS

RELEASING FOR BID  
BASED ON LIMITED  
REVIEW 4-11, 20 08  
*Christina M. Keenan*  
DEPUTY DIRECTOR OF HIGHWAYS, REGION FOUR ENGINEER

DESIGN CLASSIFICATION: RURAL LOCAL ROAD  
ADT<sub>2008</sub> : 350  
ADT<sub>2028</sub> : 400  
DESIGN SPEED - 40 MPH

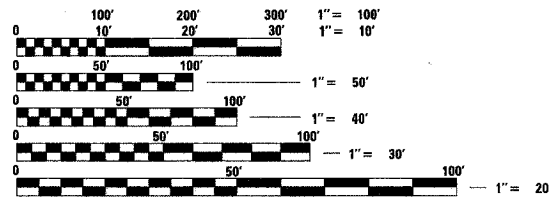

FULL SIZE PLANS HAVE BEEN PREPARED USING STANDARD ENGINEERING SCALES, REDUCED SIZED PLANS WILL NOT CONFORM TO STANDARD SCALES, IN MAKING MEASUREMENTS ON REDUCED PLANS, THE ABOVE SCALES MAY BE USED.

J.U.L.I.E.  
JOINT UTILITY LOCATING INFORMATION FOR EXCAVATORS  
1-800-892-0123 Website: <http://www.illinois1call.com>

CONTRACT NO. 95556

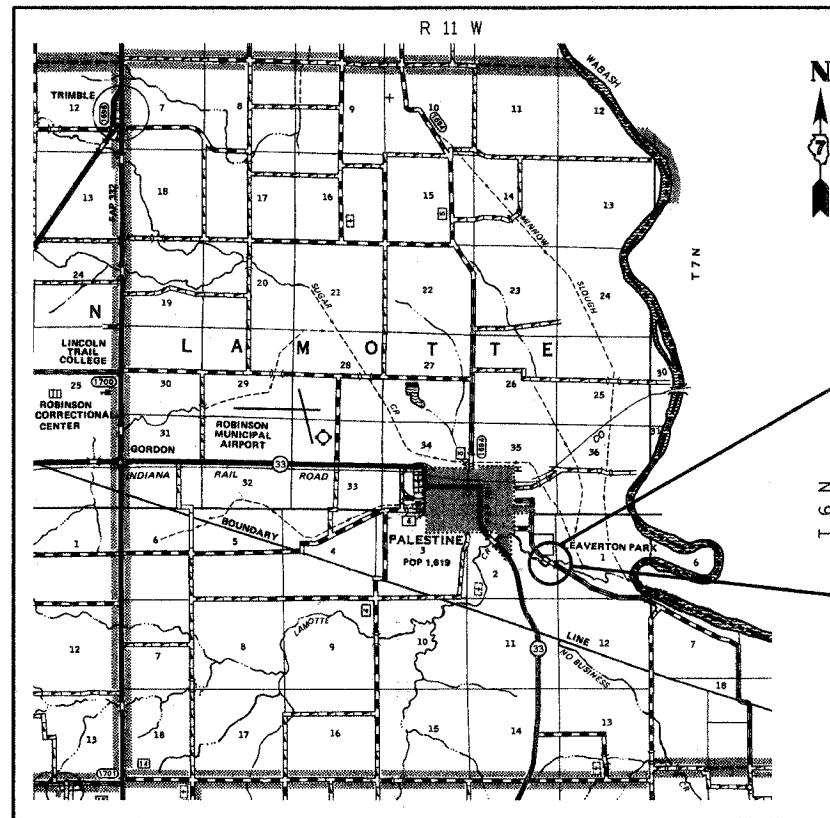

SECTION BEGINS  
STA. 11+66.78

SECTION 07-03123-00-BR

INCLUDES THE CONSTRUCTION OF A THREE SPAN PRECAST PRESTRESSED CONCRETE DECK BEAM BRIDGE CARRYING TR 175A OVER LAMOTTE CREEK, 157'-4 1/2" BK. TO BK. ABUTMENTS, 45° AHEAD LEFT SKEW. EXISTING STRUCTURE NO. 017-3314 PROPOSED STRUCTURE NO. 017-3325

SECTION ENDS  
STA. 14+24.14

LOCATION: NEAR THE NE CORNER, SE 1/4, SECTION 2, T6N, R11W, 2ND P.M.  
NET LENGTH OF PROJECT: 257.36 FT = 0.049 MI



*Gary L. Hahn* 04-09-08  
GARY L. HAHN  
CENTRALIA, ILLINOIS  
ILLINOIS LICENSED PROFESSIONAL  
ENGINEER NO. 62-42606  
EXPIRES NOV. 30, 2009