

STATE OF ILLINOIS
DEPARTMENT OF TRANSPORTATION

Contract # 97312

ROUTE NO.	SECTION	COUNTY	TOTAL SHEETS	SHEET NO.
-	99-00009 -01-PP	ST. CLAIR		73
FED. ROAD DIST. NO. 8		ILLINOIS	FED. AID PROJECT- 98-089-97	
CULVERT STRUCTURAL				

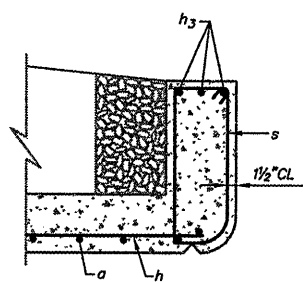

**HEADWALL SECTION
AT UPSTREAM END**
(Steel Railing Not Shown)

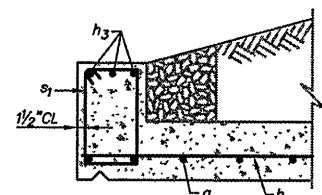

**HEADWALL SECTION
AT DOWNSTREAM END**
(Steel Railing Not Shown)

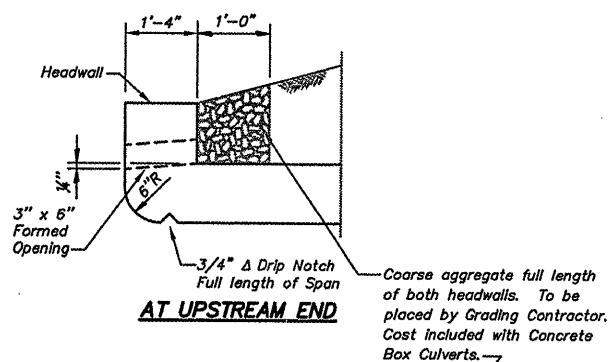

AT UPSTREAM END

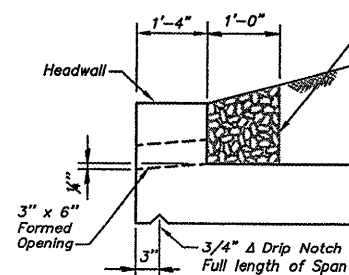

AT DOWNSTREAM END

DRAIN DETAIL

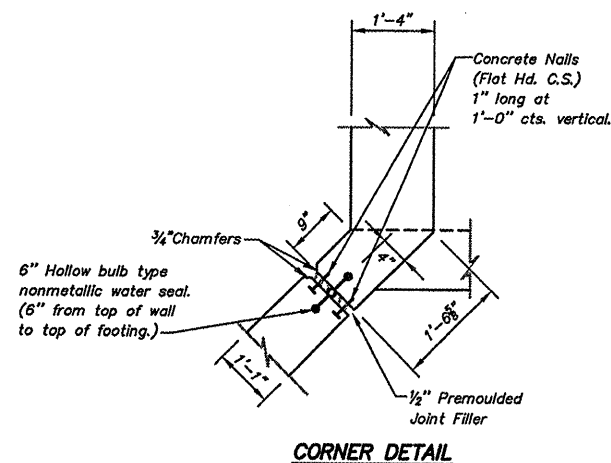

CORNER DETAIL

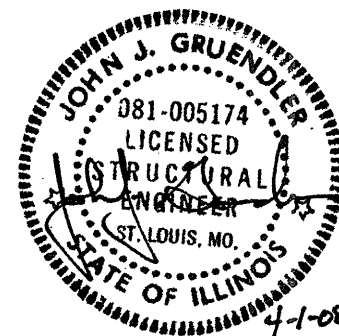

Lic. Exp. 11-30-08

DESIGNED	
CHECKED	
DRAWN	PES
CHECKED	TPW

200
EXAMINED
ENGINEER OF BRIDGE DESIGN
PASSED
ENGINEER OF BRIDGE AND STRUCTURES

(Drawing Not To Scale)