

FA-RT#	SECTION	COUNTY	TOTAL SHEETS	SHEET NO.
	03-00026-00-PK 06-00026-01-MS	MADISON	53	41

FEDERAL AID PROJECT

**KEYED NOTES**

- 1 CONDUIT SHALL BE EXTENDED TO PROPERTY LINE, CAPPED AND LABELED TELEPHONE, AND STAKED FOR LOCATION.
- 2 DIMENSION DENOTES HEIGHT OF CONCRETE BASE ABOVE GRADE. TYPICAL FOR ALL POLES. SEE DETAILS ON SHEET E6-02 FOR ADDITIONAL INFORMATION.
- 3 E.C. SHALL FURNISH AND INSTALL TRANSFORMER PAD. SEE DETAIL B, SHEET E6-02.
- 4 EXTEND AND CONNECT TO PANEL VIA CONTACTOR C1. SEE SHEET E4-01 FOR CONTACTOR LOCATION.
- 5 (2) 5" UNDERGROUND PVC CONDUITS FOR PRIMARY SERVICE ENTRANCE. EXTEND TO PROPERTY LINE AND CAP OFF BELOW GRADE. PROVIDE IN ACCORDANCE WITH AMEREN UE REQUIREMENTS.
- 6 EXTEND AND CONNECT TO PANEL VIA CONTACTOR. SEE SHEET E4-01 FOR LOCATION OF CONTACTOR C2.
- 7 DIMENSION DENOTES HEIGHT OF CONCRETE BASE ABOVE GRADE. TYPICAL FOR ALL POLES. SEE DETAIL A ON SHEET E6-02 AND DETAIL E ON SHEET E6-01 FOR ADDITIONAL INFORMATION.

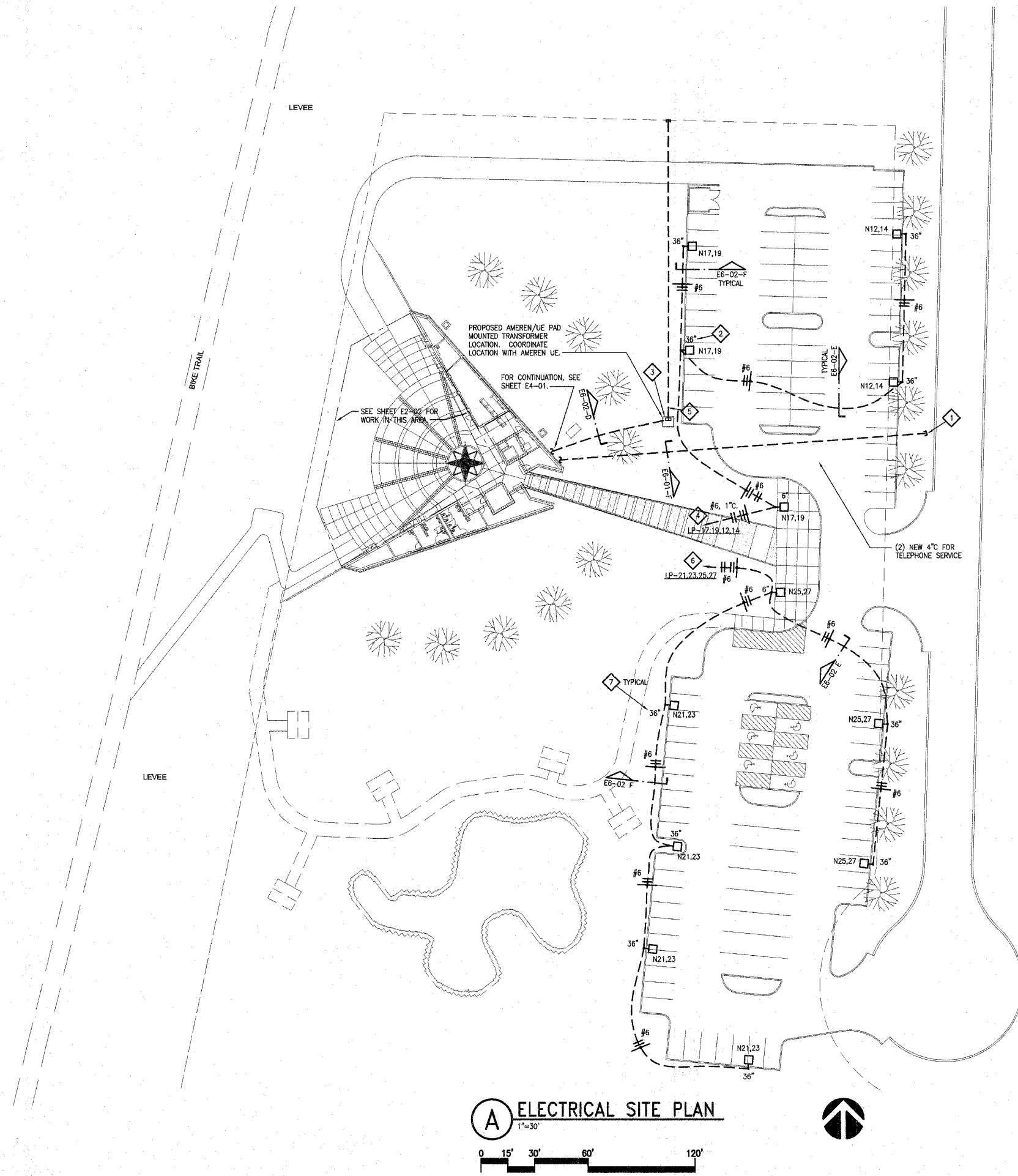

**A ELECTRICAL SITE PLAN**  
1"=30'

211 N. Broadway  
Suite 1600  
St. Louis, MO 63102  
(314) 241-8188  
FAX (314) 241-0125



**LEWIS AND CLARK MEMORIAL TOWER**  
**VILLAGE OF HARTFORD, ILLINOIS**  
HARTFORD, ILLINOIS 62049

SHEET TITLE  
**ELECTRICAL SITE PLAN**

REV. NO.	REMARKS	DATE

KENNEDY PROJECT NO  
KAI# 10-02048

ISSUE DATE  
APRIL 11, 2008

SHEET NO

**E2-01**