

F.A.U. ROUTE	SECTION	COUNTY	TOTAL SHEETS	SHEET NUMBER
9170	03-00054-00-RP	ST. CLAIR	41	21
STA. 2+22.78		TO	STA. 37+18.35	
FEDERAL AID PROJECT			CONTRACT 97335	

MAINTENANCE OF TRAFFIC AND SEQUENCE OF CONSTRUCTION

GENERAL
 THE CONTRACTOR SHALL USE TYPE III BARRICADES WITH FLASHING LIGHTS AND SIGNS "ROAD CLOSED THRU TRAFFIC" (R11-4) AT ALL CLOSURE POINTS. "ROAD CONSTRUCTION AHEAD" (W20-1(O)) AND "ROAD CLOSED AHEAD" (W20-3(O)) WARNING SIGNS WITH FLASHING LIGHTS SHALL BE PLACED IN CONFORMANCE WITH STANDARD BLR 22 AND AS DIRECTED BY THE ENGINEER TO ACCOMMODATE FIELD CONDITIONS.

STAGE I
 OBERNUEFEMANN ROAD/PORTER ROAD SHALL BE CLOSED TO THRU TRAFFIC FROM STA. 30+30 TO STA. 37+20. THE EXISTING SOUTH WYE ACCESS TO POHLMAN ROAD SHALL REMAIN OPEN UNTIL SUCH TIME AS THE NORTH ENTRANCE AT STA. 33+58 IS COMPLETED. THE CONTRACTOR SHALL PROVIDE ACCESS TO THE PRIVATE ENTRANCE AT STA. 60+69 AT ALL TIMES.

STAGE 1A
 OGLE ROAD SHALL BE COMPLETED ACROSS THE SOUTH WYE ACCESS. THE CONTRACTOR SHALL INSTALL THE ROAD CLOSURE SIGNING AS SHOWN IN DETAIL "A".

STAGE II
 OBERNUEFEMANN ROAD SHALL BE CLOSED TO THRU TRAFFIC FROM STA. 20+15 TO STA. 30+30. ACCESS TO W. NIXON DRIVE WILL BE MAINTAINED VIA W. MADISON DRIVE AND OGLE ROAD. THE CONTRACTOR SHALL PROVIDE ACCESS TO ALL PROPERTIES AT ALL TIMES.

STAGE III
 OBERNUEFEMANN ROAD SHALL BE CLOSED TO THRU TRAFFIC FROM STA. 11+30 TO STA. 20+15. ACCESS TO W. MADISON DRIVE WILL BE MAINTAINED VIA W. NIXON DRIVE. THE CONTRACTOR SHALL PROVIDE ACCESS TO ALL PROPERTIES AT ALL TIMES.

STAGE IV
 OBERNUEFEMANN ROAD SHALL BE CLOSED TO THRU TRAFFIC FROM STA. 7+25 TO STA. 11+30. ACCESS TO THE FAMILY SPORTS PARK WILL BE MAINTAINED VIA THE WEST PARK ENTRANCE OFF OF VENITA DRIVE. THE CONTRACTOR SHALL PROVIDE ACCESS TO ALL PROPERTIES AND THE SOUTH ENTRANCE TO STEVEN DEE DRIVE SHALL REMAIN OPEN AT ALL TIMES.

STAGE V
 OBERNUEFEMANN ROAD SHALL BE CLOSED TO THRU TRAFFIC FROM STA. 1+75 TO STA. 7+25. THE CONTRACTOR SHALL PROVIDE ACCESS TO ALL PROPERTIES AND THE SOUTH ENTRANCE TO STEVEN DEE DRIVE AT ALL TIMES. THE CONTRACTOR SHALL PERFORM ALL CONSTRUCTION WORK WITHIN 25' OF THE RAILROAD TRACKS ACCORDING TO ARTICLES 107.11 AND 107.12 OF THE STANDARD SPECIFICATIONS.

STAGE VI
 THE CONTRACTOR SHALL CONSTRUCT THE FINAL SURFACE LIFT UNDER TRAFFIC UTILIZING THE APPLICABLE SECTIONS OF STANDARD 701501.

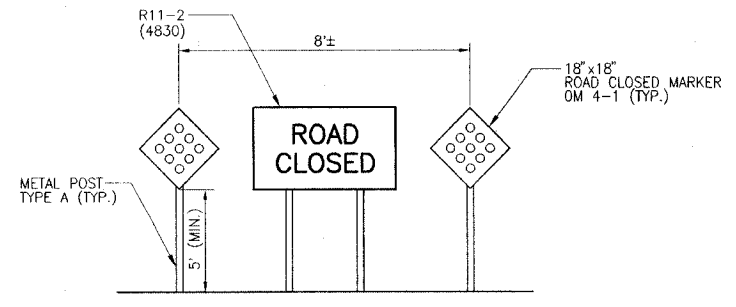
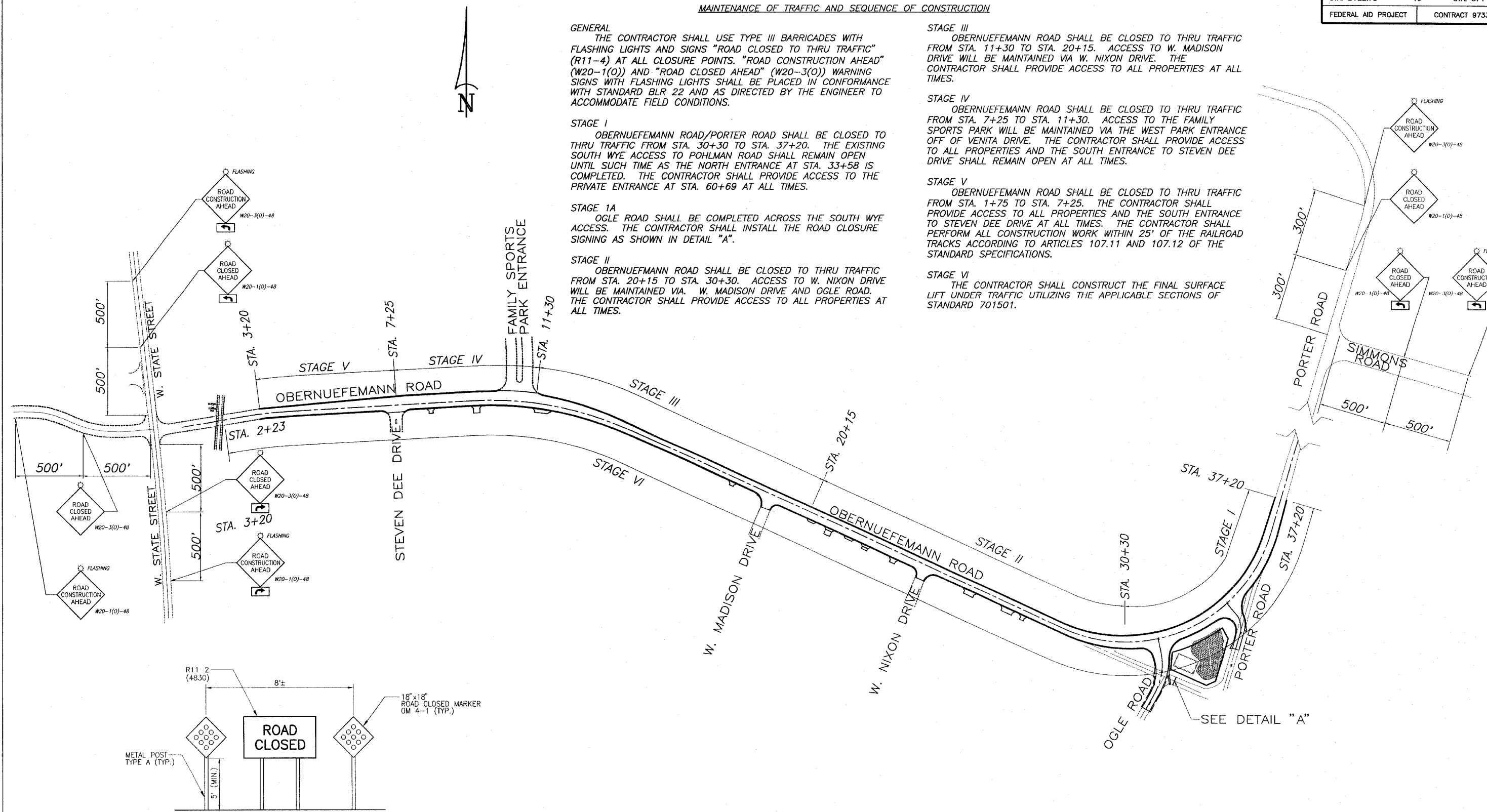

ROAD CLOSURE SIGNING DETAIL "A"
 N.T.S.

E:\14103 - Oberneufemann Road\97335-21 - TRAFFIC CONTROL.dwg, 2/25/2008, 12:16:48 PM, Revised by M.A.L.