

F.A.U. ROUTE	SECTION	COUNTY	TOTAL SHEETS	SHEET NUMBER
9170	03-00054-00-RP	ST. CLAIR	41	25
STA. 2+22.78		TO	STA. 37+18.35	
FEDERAL AID PROJECT			CONTRACT 97335	

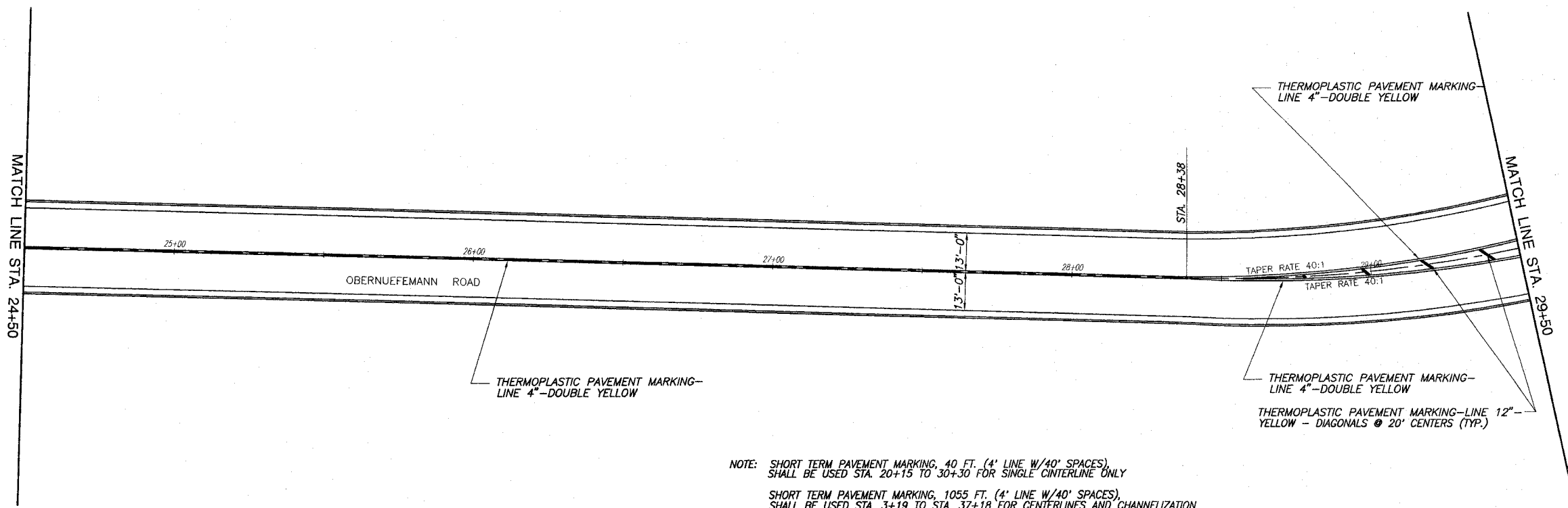

NOTE: SHORT TERM PAVEMENT MARKING, 40 FT. (4' LINE W/40' SPACES), SHALL BE USED STA. 20+15 TO 30+30 FOR SINGLE CENTERLINE ONLY
 SHORT TERM PAVEMENT MARKING, 1055 FT. (4' LINE W/40' SPACES), SHALL BE USED STA. 3+19 TO STA. 37+18 FOR CENTERLINES AND CHANNELIZATION
 WORK ZONE PAVEMENT MARKING REMOVAL, 352 SQ. FT. SHALL BE COMPLETED BEFORE PERMANENT PAVEMENT MARKING PUT INTO PLACE

SCALE:
 PLAN: 1"=20'

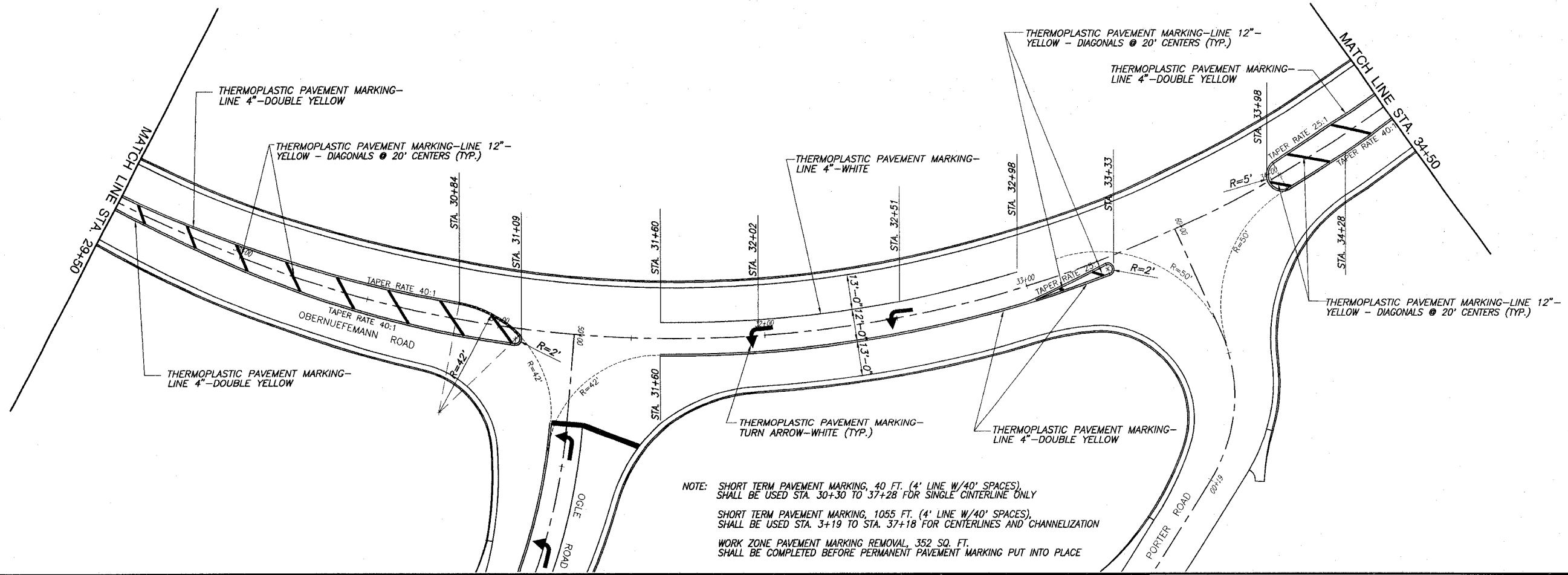

NOTE: SHORT TERM PAVEMENT MARKING, 40 FT. (4' LINE W/40' SPACES), SHALL BE USED STA. 30+30 TO 37+28 FOR SINGLE CENTERLINE ONLY
 SHORT TERM PAVEMENT MARKING, 1055 FT. (4' LINE W/40' SPACES), SHALL BE USED STA. 3+19 TO STA. 37+18 FOR CENTERLINES AND CHANNELIZATION
 WORK ZONE PAVEMENT MARKING REMOVAL, 352 SQ. FT. SHALL BE COMPLETED BEFORE PERMANENT PAVEMENT MARKING PUT INTO PLACE

PAVEMENT MARKING PLAN OBERNUEFEMANN ROAD IMPROVEMENTS
 SECTION 03-00054-00-RP ST. CLAIR COUNTY, ILLINOIS

E:\1\1311 - 03-00054-00-RP-PAVEMENT MARKING.DWG, 2/25/2008 11:59:49 AM, PLOTTED BY M.A.L.