

F.A.U. RTE.	SECTION	COUNTY	TOTAL SHEETS	SHEET NO.
9306 04-00042-01-PV		MONROE	42	10
STA. 26+50		TO STA. 32+50		
FED. ROAD DIST. NO.	ILLINOIS FED. AID PROJECT			

PLAN	DATE	BY
REVISIONS		
NO.	DESCRIPTION	

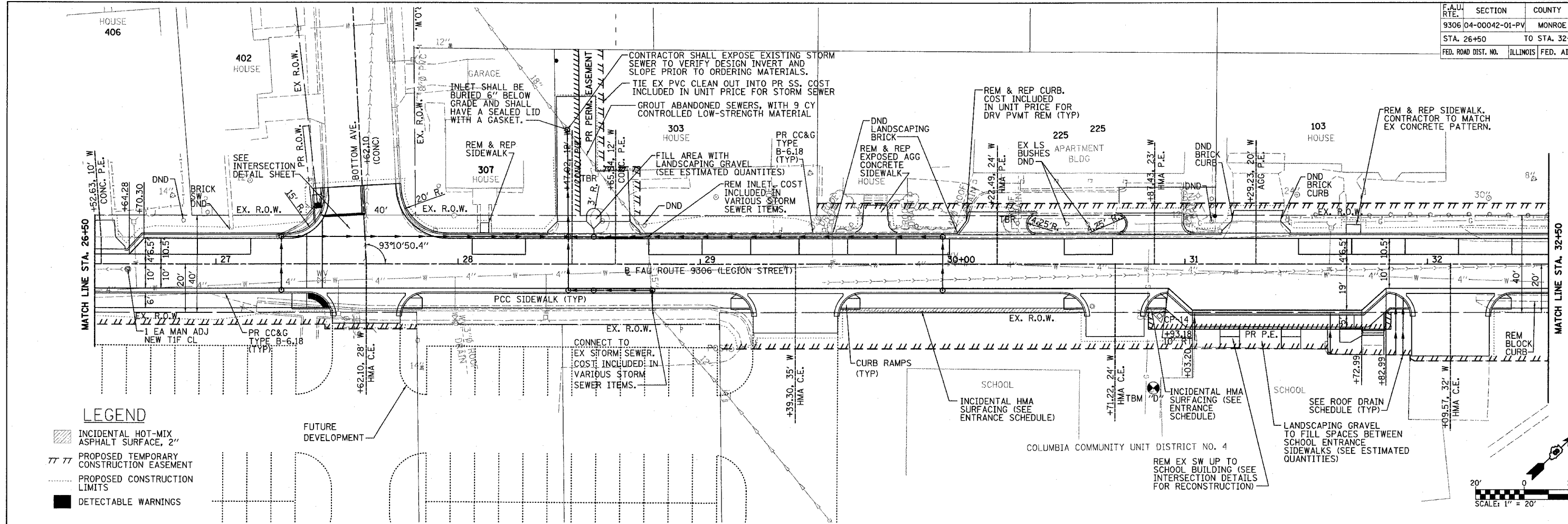

- LEGEND**
- INCIDENTAL HOT-MIX ASPHALT SURFACE, 2"
  - PROPOSED TEMPORARY CONSTRUCTION EASEMENT
  - PROPOSED CONSTRUCTION LIMITS
  - DETECTABLE WARNINGS

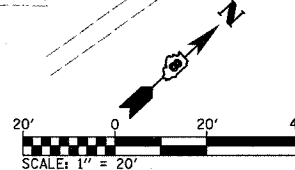

PROFILE	DATE	BY
REVISIONS		
NO.	DESCRIPTION	

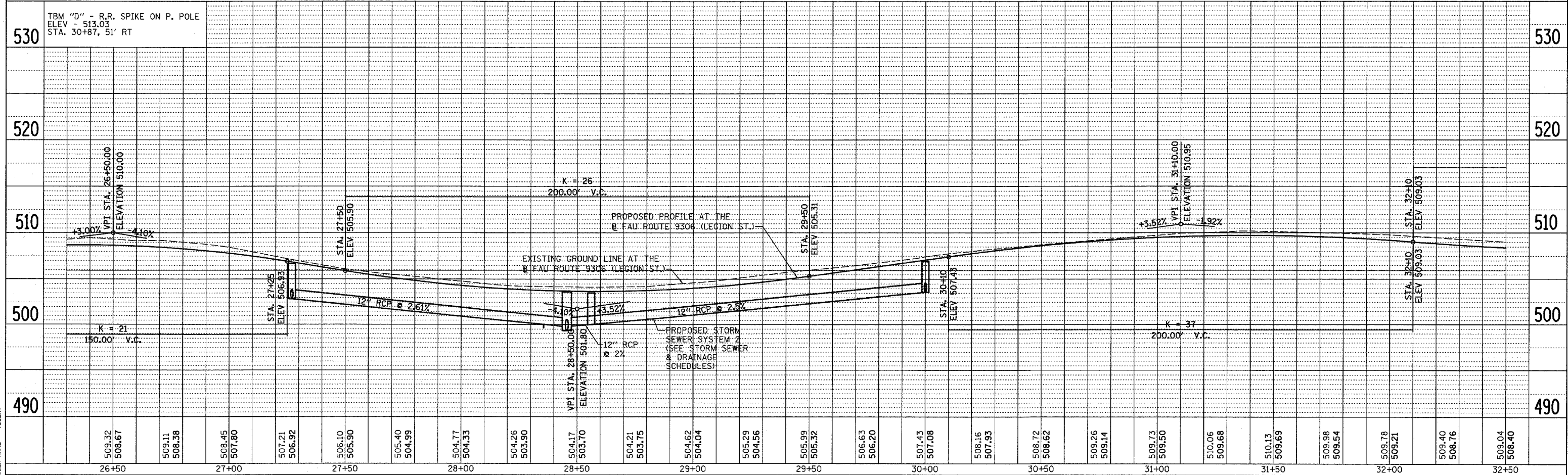

LEGION ST. STA. 26+50 TO STA. 32+50

PLOT DATE = 5/16/2008  
FILE NAME = #FILE#  
PLOT SCALE = #SCALE#  
USER NAME = #USER#