

FULL DEPTH REMOVAL OF EXISTING OIL & CHIP FOR WIDENING
 DEPTH TO MATCH PROPOSED WIDENING AT LOCATIONS SHOWN ON TYPICAL SECTIONS
 (COST TO BE INCLUDED IN BID UNIT PRICE FOR EARTH EXCAVATION)

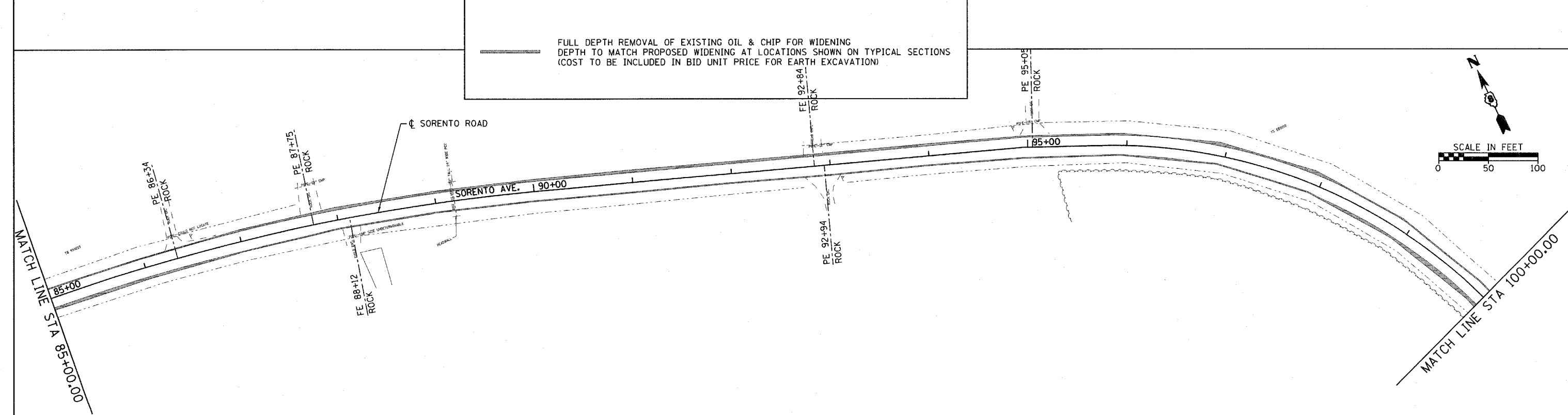
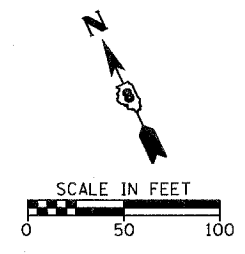

FILE NAME =
 H:\0592\REMOVAL_SR_0592_3.dgn

USER NAME = _USERDESCR_
 PLOT SCALE = 50.0000' / IN.
 PLOT DATE = 3/21/2008

DESIGNED - DLD
 DRAWN - KOJ
 CHECKED -
 DATE - 1-17-08

REVISED -
 REVISED -
 REVISED -
 REVISED -

STATE OF ILLINOIS
DEPARTMENT OF TRANSPORTATION

PAVEMENT REMOVAL & EXISTING TOPOGRAPHY - SORENTO ROAD
 SCALE: 50 SHEET NO. OF SHEETS STA. 70+00 TO STA. 100+00

F.A.S. RTE.	SECTION	COUNTY	TOTAL SHEETS	SHEET NO.
777	05-00080-00-RS	BOND	90	12
FED. ROAD DIST. NO. 8 ILLINOIS FED. AID PROJECT				
CONTRACT NO. 97341				