

NO.	SECTION	COUNTY	TOTAL SHEETS	SHEET NO.
9392	05-00024-00-PV	MADISON	81	9
TYPICAL SECTIONS				

CONTRACT NO. 97347

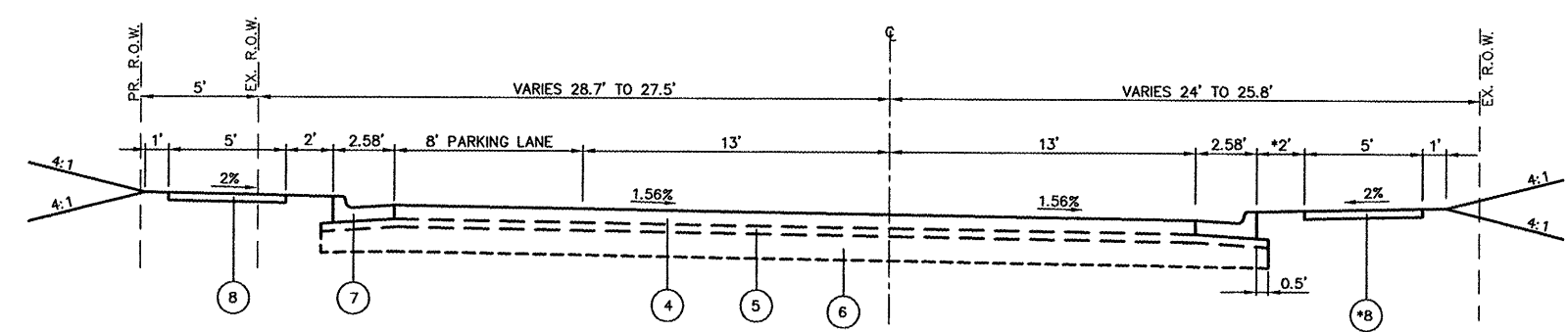

PROPOSED
 STA. 10+20.96 TO STA. 12+89.96
 *REMOVE BUFFER SPACE AND PLACE PCC
 SIDEWALK, 4" BEGINNING @ STA 12+35.70 RT

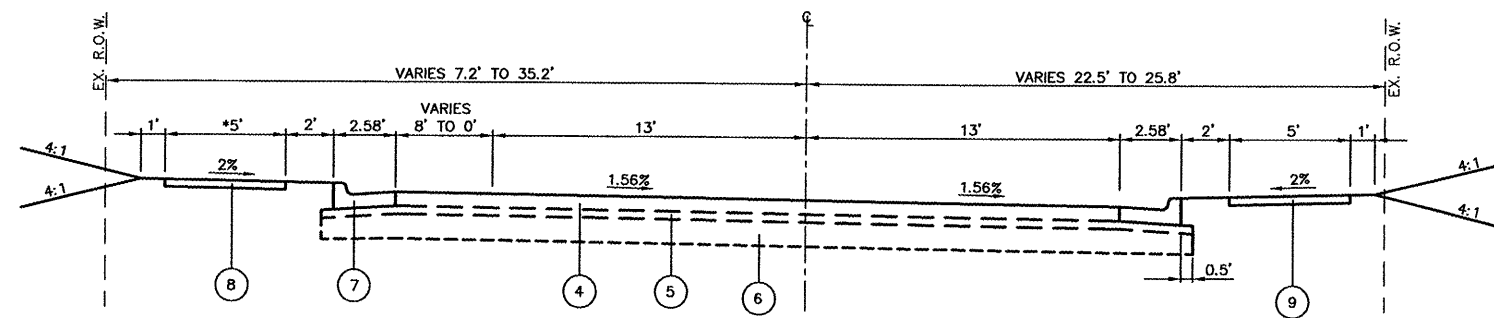

PROPOSED
 STA. 12+89.96 TO STA. 13+67.40
 *END WALK STA 13+02.70

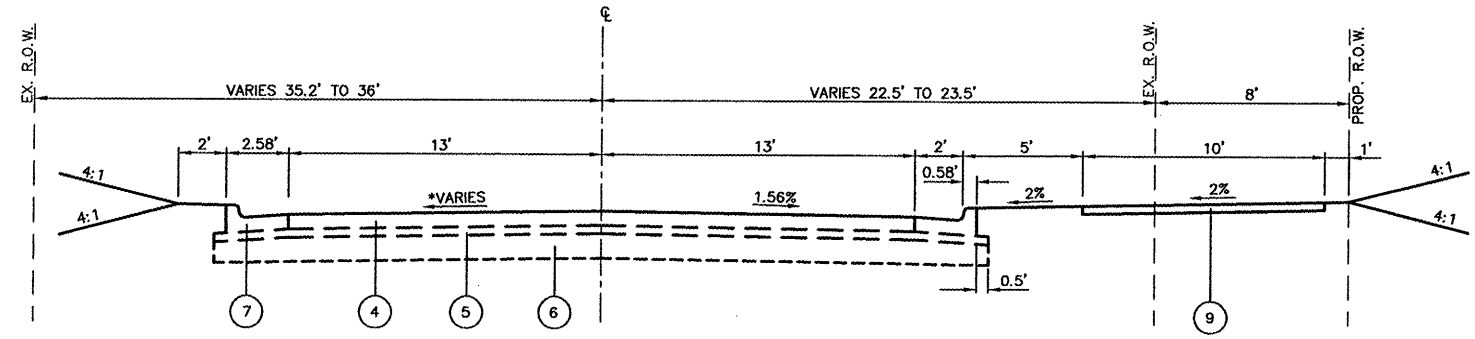

PROPOSED
 STA. 13+67.40 TO STA. 14+27.40
 *TRANSITION FROM +1.56% TO -1.56%

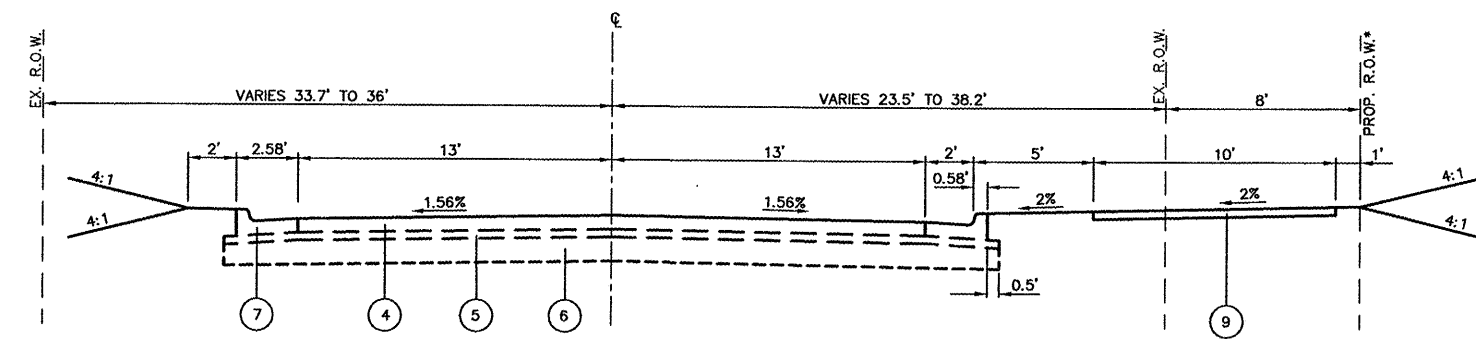

PROPOSED
 STA. 14+27.40 TO STA. 36+03.61
 *END PROP. R.O.W. AT STA 15+64.62

LEGEND	
④	PROPOSED PCC PAVEMENT, 7"
⑤	PROPOSED SUBBASE GRANULAR MATERIAL, TYPE A, 4"
⑥	PROPOSED LIME MODIFIED SOIL, 12"
⑦	PROPOSED COMBINATION CONCRETE CURB & GUTTER, TYPE B-6.24
⑧	PROPOSED PCC SIDEWALK, 4"
⑨	PROPOSED SHARED-USE TRAIL, 4" (PEDESTRIAN - BICYCLE) (PAID FOR AS PCC SIDEWALK)

REVISIONS	
NAME	DATE

PROPOSED
 TYPICAL SECTIONS

NORTH STAUNTON ROAD IMPROVEMENTS
 CITY OF TROY
 MADISON COUNTY, ILLINOIS

030131TYP001.dwg 4/12/2008 9:42am