

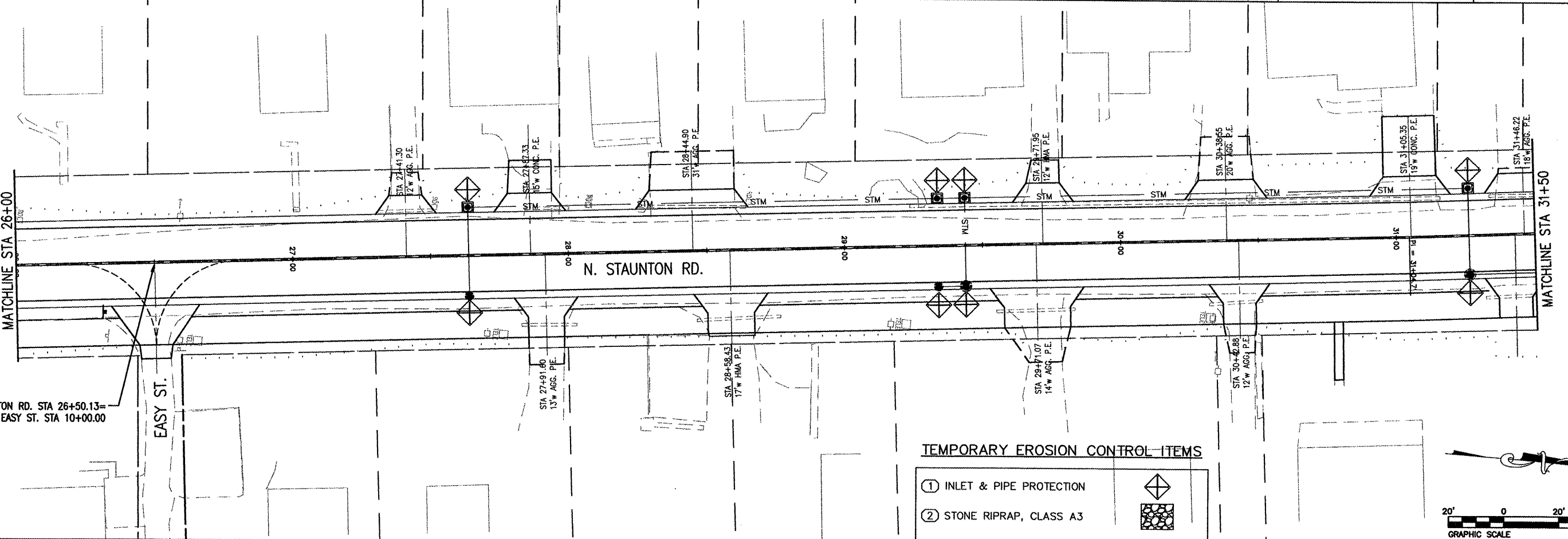

PAV ROUTE	SECTION	COUNTY	TOTAL SHEETS	SHEET NO
9392	05-00024-00-PV	MADISON	81	20
STA. 20+50		TO STA. 31+50		
TEMPORARY EROSION CONTROL				

CONTRACT NO. 97347

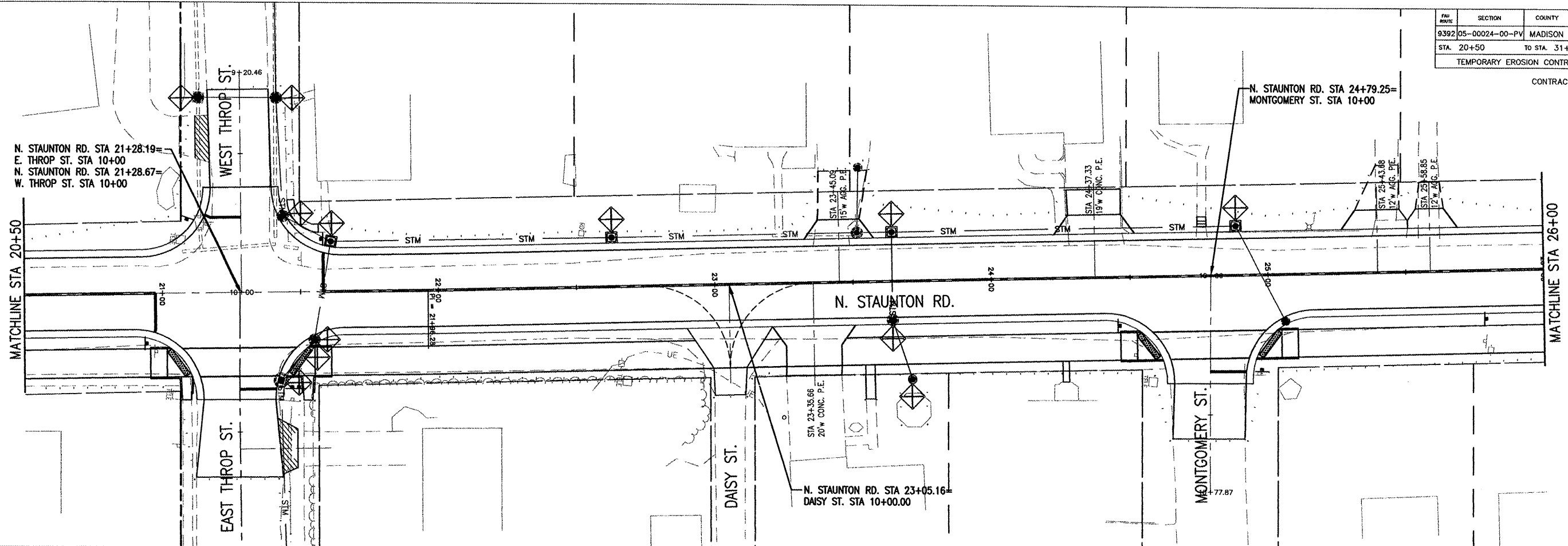

TEMPORARY EROSION CONTROL ITEMS

- ① INLET & PIPE PROTECTION 
- ② STONE RIPRAP, CLASS A3 

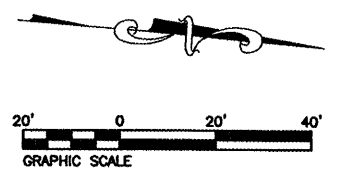

N. STAUNTON RD. STA 21+28.19=
E. THROP ST. STA 10+00
N. STAUNTON RD. STA 21+28.67=
W. THROP ST. STA 10+00

N. STAUNTON RD. STA 24+79.25=
MONTGOMERY ST. STA 10+00

N. STAUNTON RD. STA 23+05.16=
DAISY ST. STA 10+00.00

N. STAUNTON RD. STA 26+50.13=
EASY ST. STA 10+00.00

STA 31+46.22
118' W AGG. P.E.