

PAV ROUTE	SECTION	COUNTY	TOTAL SHEETS	SHEET NO.
9392	05-00024-00-PV	MADISON	81	21
STA. 31+50		To STA. 36+65.40		

TEMPORARY EROSION CONTROL

CONTRACT NO. 97347

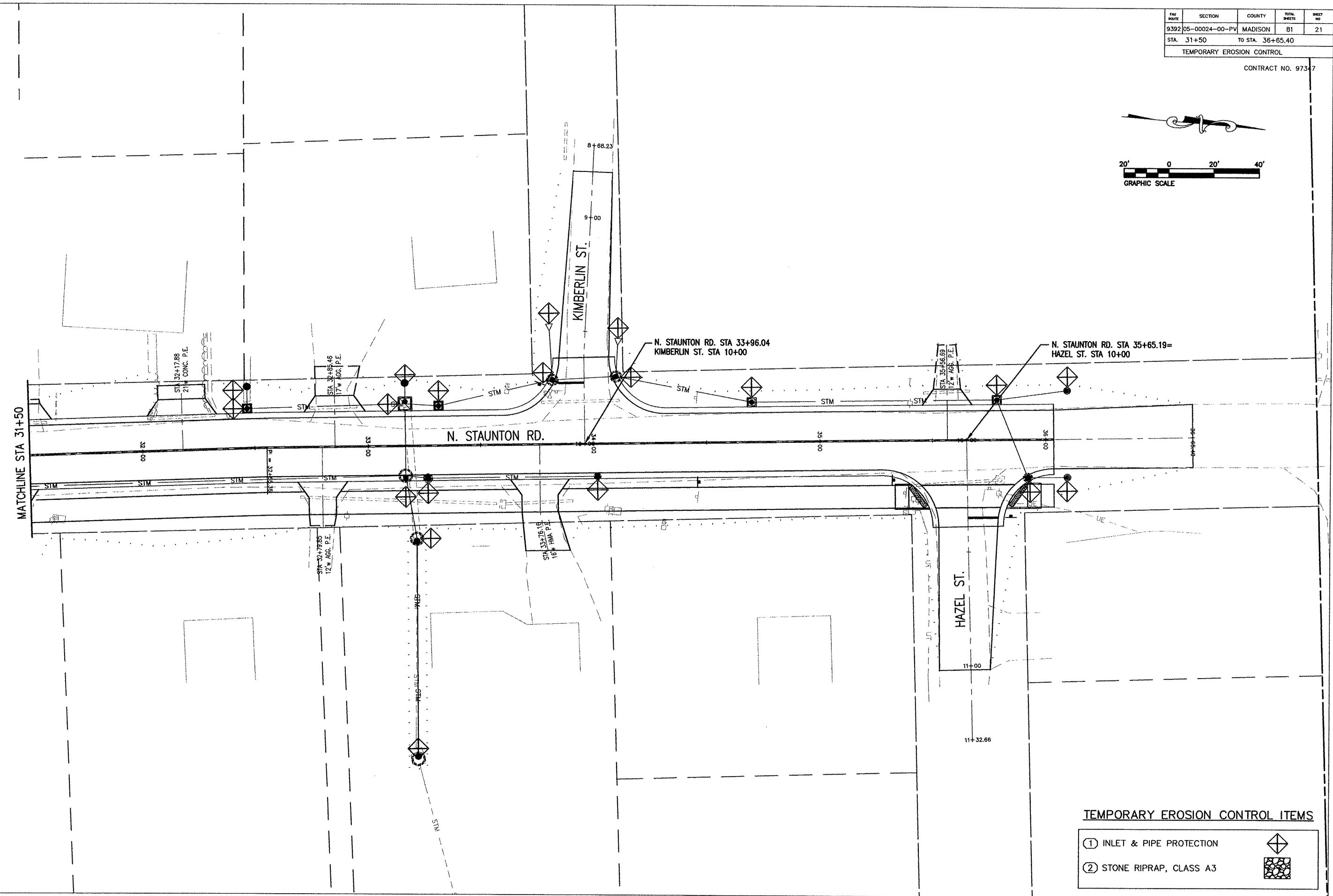
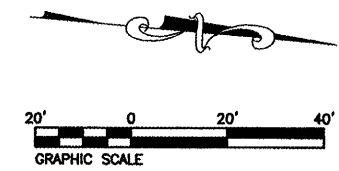

TEMPORARY EROSION CONTROL ITEMS

① INLET & PIPE PROTECTION	
② STONE RIPRAP, CLASS A3	