

INDEX OF SHEETS

SHEET NO.	DESCRIPTION
1	TITLE SHEET & SUMMARY OF QUANTITIES
2	PLAN & PROFILE, TYPICAL SECTIONS & GENERAL NOTES
3-4	ROADWAY CROSS SECTIONS
5-12	BRIDGE DESIGN
13	CURLED END SECTIONS & STONE RIPRAP DITCH DESIGN

THE FOLLOWING STANDARDS ARE A PART OF THESE PLANS AND ARE INCLUDED IN THE PROPOSAL:

000001-05	STANDARD SYMBOLS, ABBREVIATIONS & PATTERNS
280001-04	TEMPORARY EROSION CONTROL SYSTEMS
701901	TRAFFIC CONTROL DEVICES
B.L.R. 21-7	TYPICAL APPLICATION OF TRAFFIC CONTROL DEVICES FOR CONSTRUCTION ON RURAL LOCAL HIGHWAYS
B.L.R. 22-5	TYPICAL APPLICATION OF TRAFFIC CONTROL DEVICES FOR CONSTRUCTION ON RURAL LOCAL HIGHWAYS (TWO-LANE TWO-WAY RURAL TRAFFIC) (ROAD CLOSED TO THRU TRAFFIC)
B.L.R. 23-2	TRAFFIC BARRIER TERMINAL TYPE 1
B.L.R. 27	TRAFFIC BARRIER TERMINAL TYPE 5A

SUMMARY OF QUANTITIES

CODE NO.	ITEM	UNIT	QUANTITY
20200100	EARTH EXCAVATION	CU YD	144.00
20300100	CHANNEL EXCAVATION	CU YD	176.00
20400800	FURNISHED EXCAVATION	CU YD	74.00
25001000	SEEDING, CLASS 2 (SPECIAL)	ACRE	0.30
28000300	TEMPORARY DITCH CHECKS	EACH	4.00
28001000	AGGREGATE (EROSION CONTROL)	TON	13.00
28100807	STONE DUMPED RIPRAP, CLASS A4	TON	250.00
28102600	STONE RIPRAP DITCH	TON	62.00
40200800	AGGREGATE SURFACE COURSE, TYPE B	TON	417.00
50100100	REMOVAL OF EXISTING STRUCTURES	EACH	1.00
50300225	CONCRETE STRUCTURES	CU YD	18.20
50300260	CONCRETE ENCASEMENT	CU YD	2.10
50400505	PRECAST PRESTRESSED CONCRETE DECK BEAMS (27" DEPTH)	SQ FT	1440.00
50800105	REINFORCEMENT BARS	POUND	2300.00
50900205	STEEL RAILING, TYPE S1	FOOT	120.00
51201400	FURNISHING STEEL PILES HP10X42	FOOT	176.00
51202305	DRIVING PILES	FOOT	176.00
51500100	NAME PLATES	EACH	1.00
54200220	PIPE CULVERTS, CLASS D TYPE 1 15"	FOOT	40.00
* 63100075	TRAFFIC BARRIER TERMINAL, TYPE 5A	EACH	1.00
67100100	MOBILIZATION	L SUM	1.00
* LR631020	TRAFFIC BARRIER TERMINAL, TYPE 1	EACH	1.00

* SPECIALTY ITEMS

DESIGN DESIGNATION:
 DESIGN SPEED: 30 MPH
 HIGHWAY CLASS - LOCAL ROAD
 EXISTING STRUCTURE NO.: 033-3050
 PROPOSED STRUCTURE NO.: 033-3306
 CURRENT A.D.T. = 100
 CONTRACT NO. 99317

J.U.L.I.E.
JOINT UTILITY LOCATION INFORMATION FOR EXCAVATION
1-800-892-0123

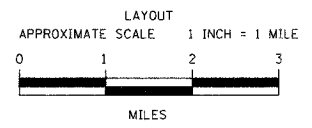
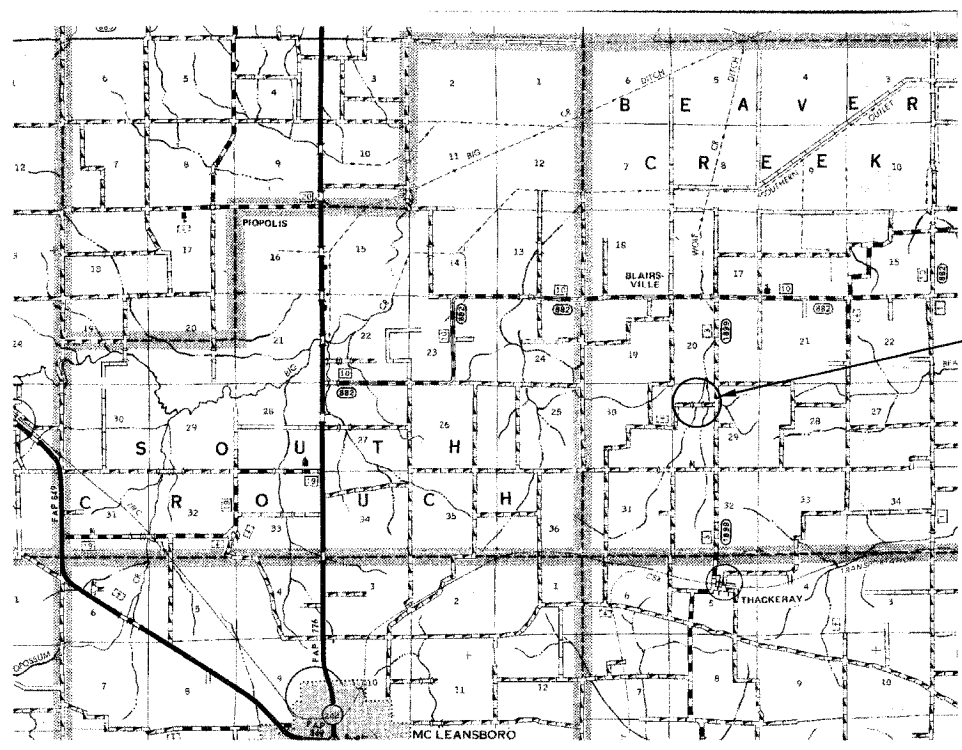

GROSS LENGTH	650.00 FT	0.123 MILES
OMISSIONS	0.00 FT	0.000 MILES
NET LENGTH	650.00 FT	0.123 MILES

STATE OF ILLINOIS
DEPARTMENT OF TRANSPORTATION
PLANS FOR PROPOSED
FEDERAL AID – H.B.P. PROJECT

T.R. 131 HAMILTON COUNTY SECTION 05-01114-00-BR
PROJECT NO. BROS-191(55) JOB NO. C-99-534-06
CONTRACT # 99317 WOLF CREEK

T.R.	SECTION	COUNTY	TOTAL SHEETS	SHEET NO.
131	05-01114-00-BR	HAMILTON	13	1

323 W. 3RD ST.
 P.O. BOX 160
 MT. CARMEL, IL 62863
 PHONE: (618)-262-8651
 FAX: (618)-263-3327

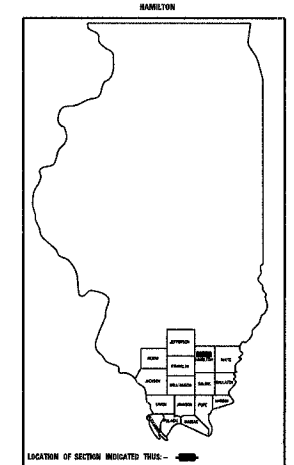

405 W. STATE ST
 SUITE 1
 PRINCETON, IN 47670
 PHONE: (812)-386-7611
 FAX: (812)-385-2812



PROFESSIONAL DESIGN FIRM
 LAND SURVEY & PROFESSIONAL ENGINEERING CORPORATION
 184-00087
 (62-032435)(35-002769)



AARON M. MEFFORD
 NAME
 SIGNATURE
 12-3-07
 DATE
 11-30-09
 EXPIRES

PLAN	1" = 50'	0 50' 100'
PROFILE	1" = 50'	0 50' 100'
PROFILE VERT.	1" = 5'	0 5' 10'
CROSS SECTION	1" = 5'	0 5' 10'

SECTION 05-01114-00-BR
 BEGINS STATION 1+50

STATION 5+00, STRUCTURE NO. 033-3306
 A 60' LONG SINGLE SPAN PRECAST
 PRESTRESSED CONCRETE DECK BEAM
 BRIDGE (27" DEPTH, 24' ROADWAY,
 3.00% GRADE, 0° SKEW.

SECTION 05-01114-00-BR
 ENDS STATION 8+00

STATE OF ILLINOIS
 DEPARTMENT OF TRANSPORTATION

APPROVED 11/29/2007

 COUNTY ENGINEER

PASSED Jan. 25, 2008

 ENGINEER OF LOCAL ROADS AND STREETS

RELEASING FOR BID
 BASED ON LIMITED
 REVIEW Jan 25, 2008

 MARY C. LAMIE, P.E.
 DEPUTY DIRECTOR OF HIGHWAYS
 REGION FIVE ENGINEER

BEAVER CREEK TOWNSHIP
 OVER WOLF CREEK
 HAMILTON COUNTY, ILLINOIS

SHEET TITLE:
 TITLE SHEET

SCALE: VARIES

BY: /MM
 DATE: 1607
 REV:

1 OF 13
 SHEETS

SHEET NO.
 1