

T.R.	SECTION	COUNTY	TOTAL SHEETS	SHEET NO.
131	05-01114-00-BR	HAMILTON	13	3
FED. ROAD DIST. NO. 9 ILLINOIS		WOLF CREEK		
PROJECT# BROS-191(55)		CONTRACT# 99317		
LEC JOB # H061020HM				

323 W. 3RD ST.
P.O. BOX 160
MT. CARMEL, IL
62863
PHONE:
(618)-262-8661
FAX:
(618)-263-3327

405 W. STATE ST.
SUITE
PRINCETON, IN
47670
PHONE:
(812)-386-7611
FAX:
(812)-385-2812



PROFESSIONAL
DESIGN FIRM
LAND SURVEY &
ENGINEERING
CORPORATION
184-000887
(62-032435)(35-002769)



AARON M. MEFFORD
NAME
Aaron M. Mefford
SIGNATURE
12-3-07
DATE
11-30-09
EXPIRES

BEAVER CREEK TOWNSHIP
OVER WOLF CREEK
HAMILTON COUNTY, ILLINOIS

C = 15.6
F = 37.7

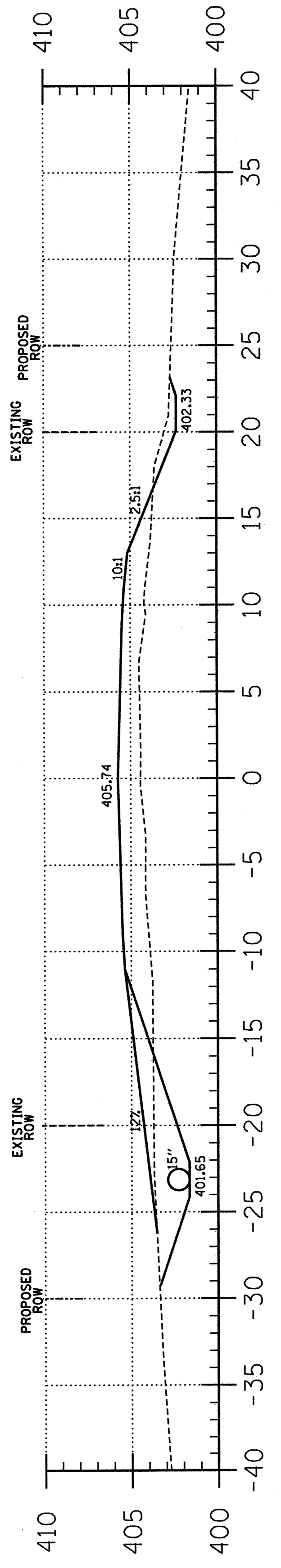

C = 10.6
F = 58.0

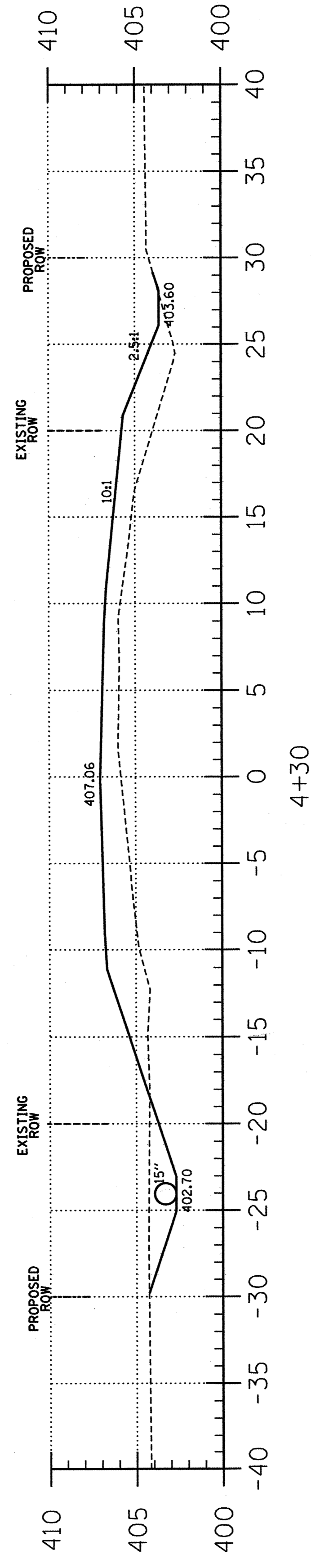

C = 1.6
F = 37.2

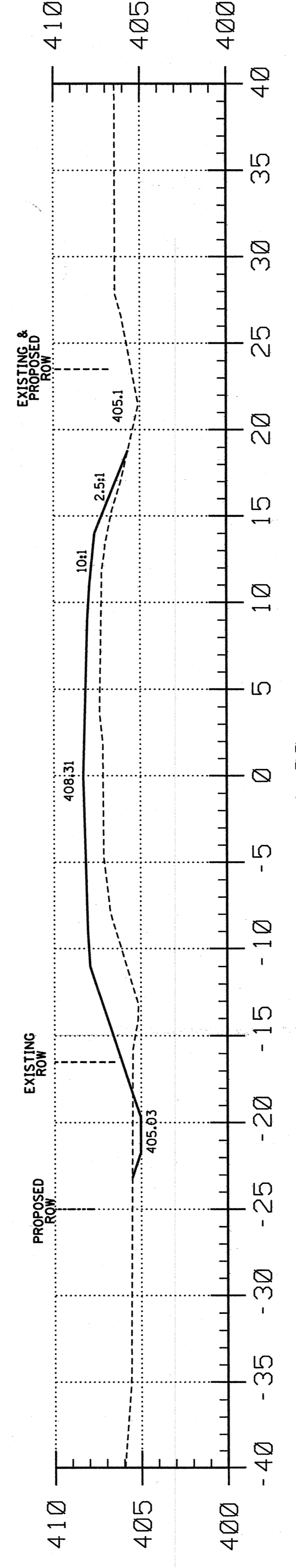

C = 9.2
F = 3.3

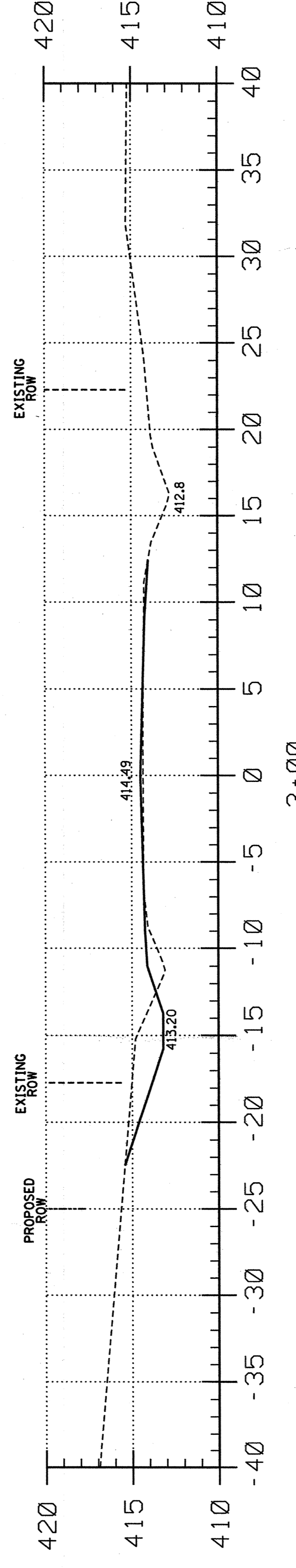

C = 20.3
F = 0.0

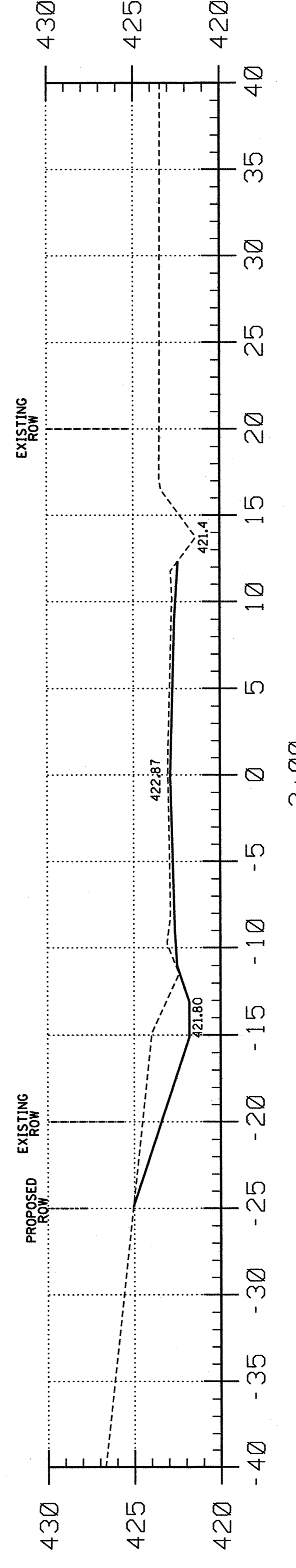

C = 0.0

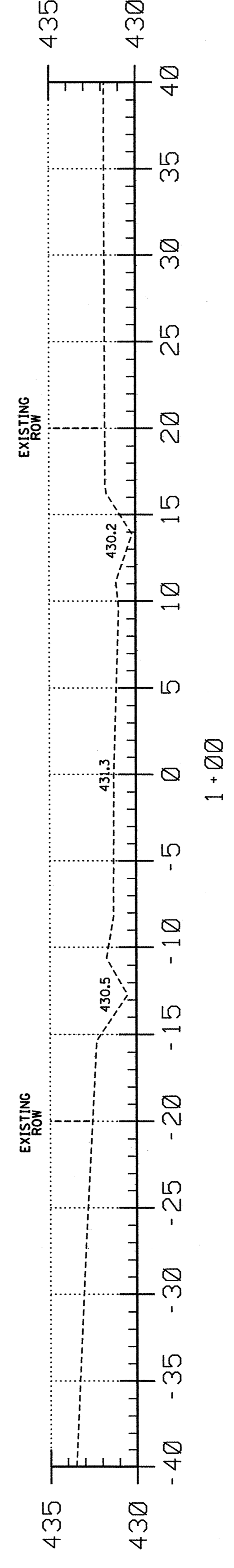

EARTHWORK SCHEDULE

LOCATION	EARTH EXCAVATION	CHANNEL EXCAVATION	ESTIMATED UNSUITABLE MATERIAL	SUITABLE MATERIAL ADJUSTED FOR SHRINKAGE	EMBANKMENT	EARTHWORK BALANCE WASTE (+) OR SHORTAGE (-)
	CUBIC YARD	CUBIC YARD	CUBIC YARD	CUBIC YARD	CUBIC YARD	CUBIC YARD
STA 0+00 TO 4+69.2	130.4	0.0	0.0	97.8	167.5	-69.7
STA 4+69.2 TO 5+30.7	0.0	176.2	88.1	66.1	0.0	66.1
STA 5+30.7 TO 10+00	13.1	0.0	0.0	9.8	63.1	-53.3
FIELD ENTRANCE	0.0	0.0	0.0	0.0	17.2	-17.2
TOTAL	143.5	176.2	88.1	173.7	247.8	-74.1

SHEET TITLE:
CROSS-SECTIONS
SCALE: 1" = 5'
BY: AMM
DATE: 11/6/07
REV: MLG
3 OF 13 SHEETS
SHEET NO. 3