

ROAD CLASSIFICATION: MAJOR COLLECTOR
 DESIGN SPEED: 50 M.P.H.

ADT:
 (2003) 1000
 (2018) 1140
 PC = 1080
 SU = 60
 MU = 0
 DHV₂₀ = 130

JOINT UTILITY LOCATING INFORMATION
 FOR EXCAVATIONS (J.U.L.I.E.)
 PHONE 1-800-892-0123

STATE OF ILLINOIS
 DEPARTMENT OF TRANSPORTATION
 DIVISION OF HIGHWAYS

PLANS FOR PROPOSED ROADWAY IMPROVEMENTS

FAS. ROUTE 1876 and C.H. 26

Franklin County, Illinois

Section 05-00161-00-RS

Project RS-1876 (102)

JOB C-99-547-05

RTE.	SECTION	COUNTY	TOTAL SHEETS	SHEET NO
FAS 1876	05-00161-00-RS	FRANKLIN	6	1

SHEET NO.	TITLE
1.	COVER SHEET
2.	SUMMARY OF QUANTITIES AND MISCELLANEOUS DETAILS
3.	TYPICAL SECTIONS AND MISCELLANEOUS DETAILS
4.-6	PLAN

STANDARDS:

- 701006-02
- 701301-02
- 701306-01
- 701311-02
- 701901
- 780001-01
- B.L.R. 24-1

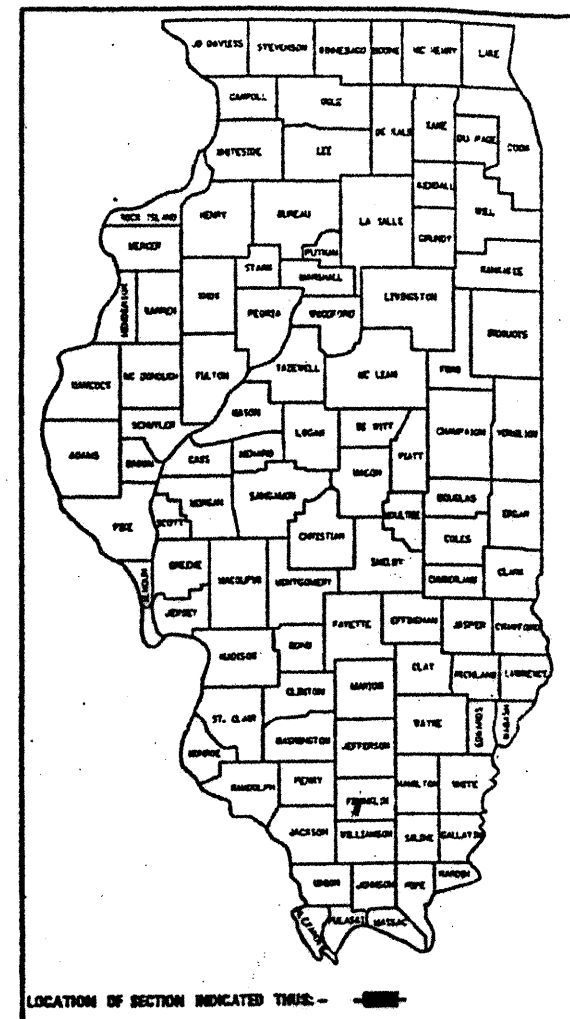
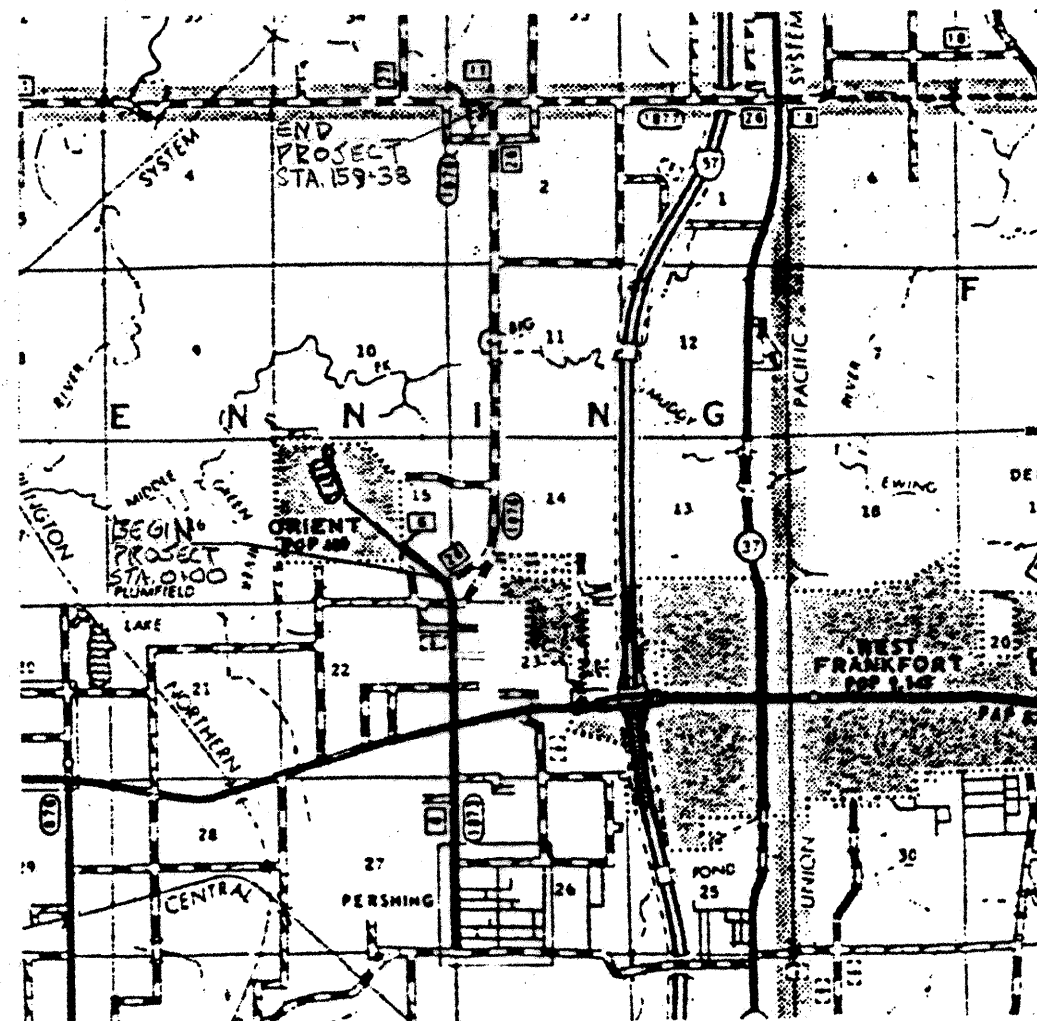

SUMMARY OF QUANTITIES			
CODE NO.	PAY ITEM	UNIT	TOTAL
40200800	AGGREGATE SURFACE, TYPE B	TON	60
40600982	HOT-MIX ASPHALT SURFACE REMOVAL	SQ YD	734
	-BUTT JOINT		
40603085	HOT-MIX ASPHALT BINDER COURSE, IL 19.0, N70	TON	4,630
40603315	HOT-MIX ASPHALT SURFACE COURSE, MIX 'C', N70	TON	3,365
40800010	BITUMINOUS MATERIALS (PRIME COAT)	GALLON	171
48100100	AGGREGATE SHOULDERS, TYPE A	TON	2,230
67100100	MOBILIZATION	L SUM	1
70300100	SHORT-TERM PAVEMENT MARKING	FOOT	1,560
* 78001110	PAINT PAVEMENT MARKING LINE-4"	FOOT	40,067

* SPECIALTY ITEMS

NET LENGTH OF IMPROVEMENT = 15939 FEET (3.020 MILES)

CONTRACT NO. 99319

STATE OF ILLINOIS DEPARTMENT OF TRANSPORTATION	
APPROVED	11/28/2007 <i>Michael A. Rolla</i> FRANKLIN COUNTY HIGHWAY ENGINEER
PASSED	FEB. 5, 2008 <i>Dennis W. Hillebrand</i> DISTRICT 9 ENGINEER OF LOCAL ROADS & STREETS
RELEASING FOR BID BASED ON LIMITED REVIEW	<i>May C. Ramis</i> 3-6-08 DEPUTY DIRECTOR OF HIGHWAYS, REGION 5 ENGINEER



Michael A. Rolla
 MICHAEL A. ROLLA
 ILLINOIS REGISTERED PROFESSIONAL ENGINEER
 #062-056332
 LIC. EXPIRES NOVEMBER 30, 2009

ROUTE	SECTION	COUNTY	TOTAL SHEETS	SHEET NO.
FAS 1876	05-00161-00-RS	FRANKLIN	6	2
CONTRACT No. 96319				

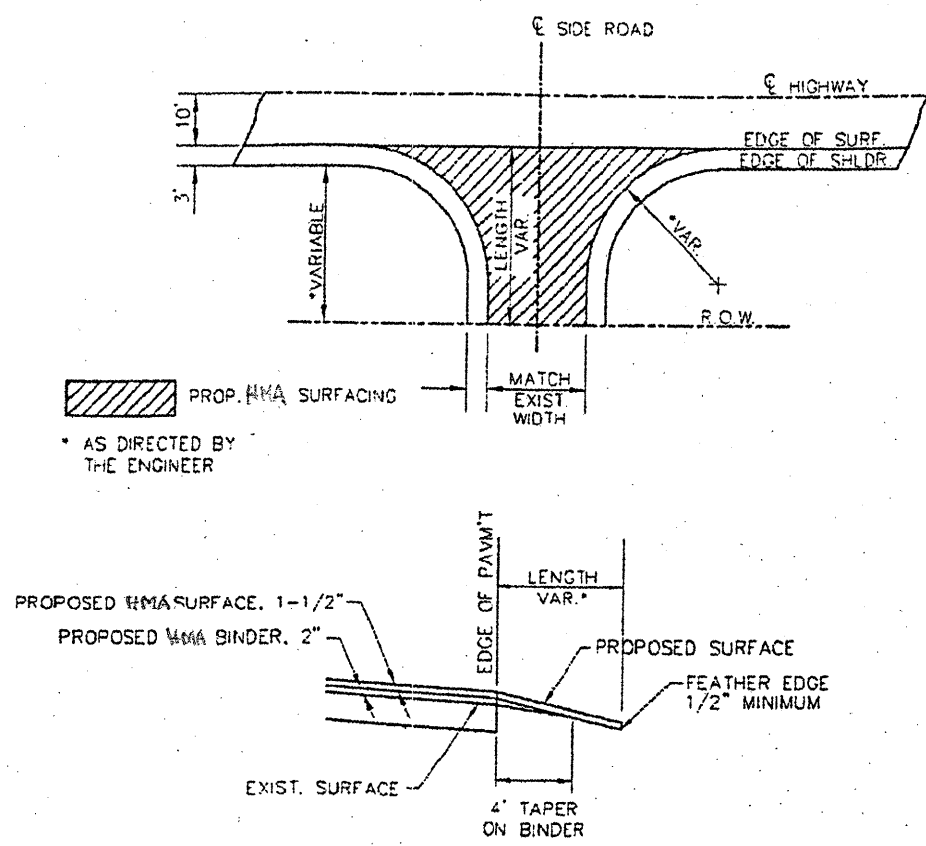

SIDEROAD DETAILS

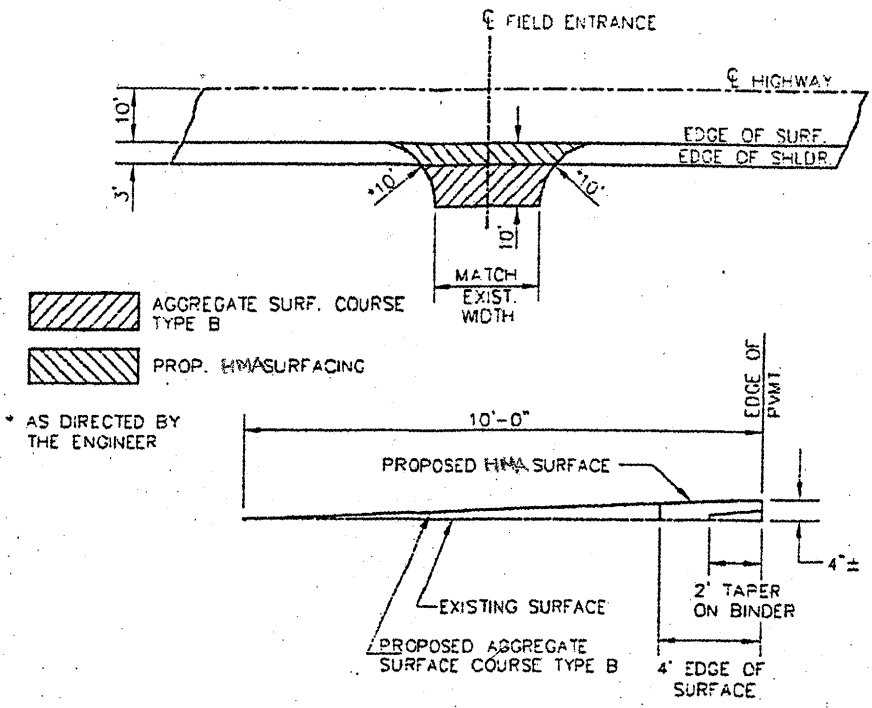

FIELD ENTRANCE DETAILS

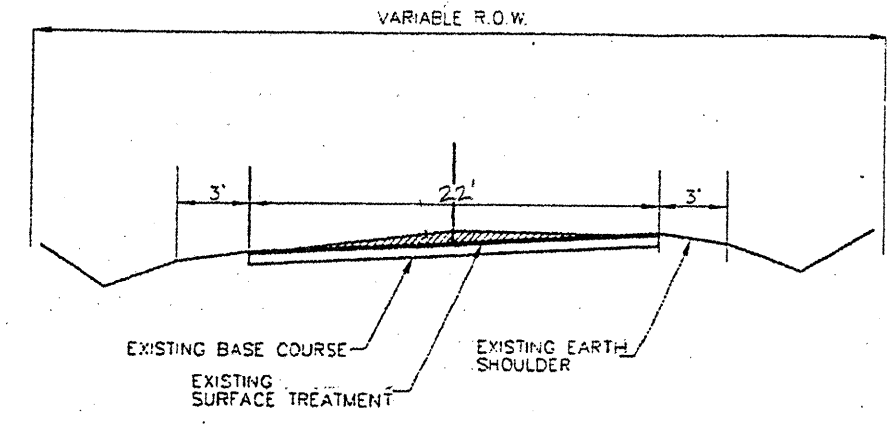

TYPICAL EXISTING SUPERELEVATED SECTION

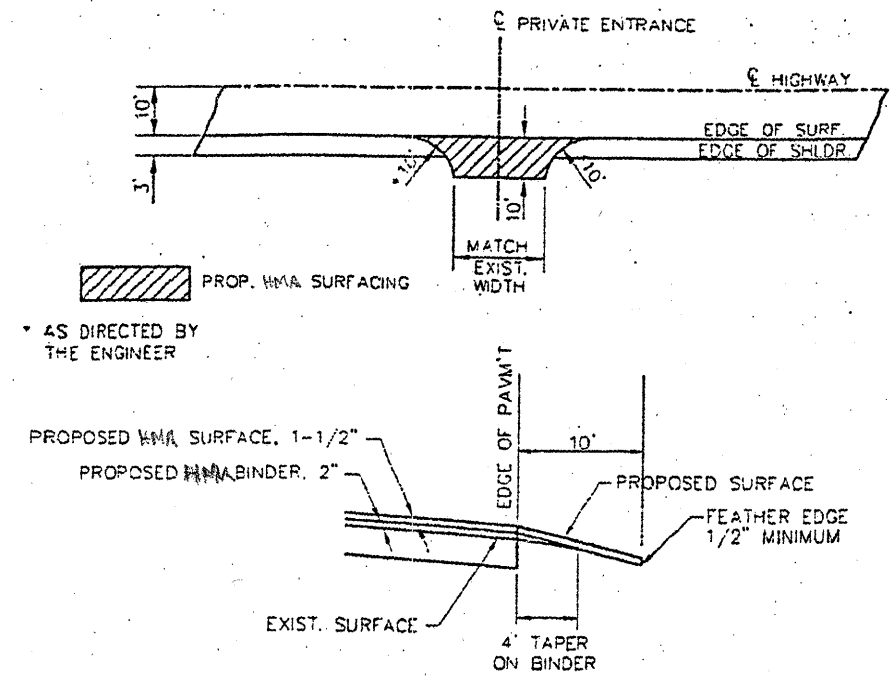

PRIVATE ENTRANCE DETAILS

FIELD ENTRANCE QUANTITIES		
ENTRANCES	AGGREGATE SURFACE COURSE TYPE B, TON	HOT MIX ASPHALT SURF. COURSE, MIX "C", N70 TON
ONE (1) ENTRANCE	5	1
TOTAL = 12 ENTRANCES	60	12

SIDEROAD ENTRANCE QUANTITIES	
LOCATION	HOT MIX ASPHALT SURF. COURSE, MIX "C", N70 TON
RT. STA. 15+75.0	26
LT. STA. 41+68.2	23
RT. STA. 108+44.8	13
LT. STA. 147+23.5	8
RT. STA. 147+23.5	8
TOTALS	78 TON

MAILBOX TURNOUT QUANTITIES		
TURNOUT	BITUMINOUS MATERIALS PRIME (COAT) GALLON	HOT MIX ASPHALT SURF. COURSE, MIX "C", N70 TON
ONE (1) ENTRANCE	3	2
TOTAL = 15 TURNOUTS	45	30

PRIVATE ENTRANCE QUANTITIES		
ENTRANCES	BITUMINOUS MATERIALS PRIME (COAT) GALLON	HOT MIX ASPHALT SURF. COURSE, MIX "C", N70 TON
ONE (1) ENTRANCE	6	4
TOTAL = 21 ENTRANCES	126	84

SUMMARY OF QUANTITIES & MISCELLANEOUS DETAILS

ROUTE	SECTION	COUNTY	TOTAL SHEETS	SHEET NO.
FAS 1876	05-00161-CO-RS	FRANKLIN	6	3
CONTRACT No.: 99319				

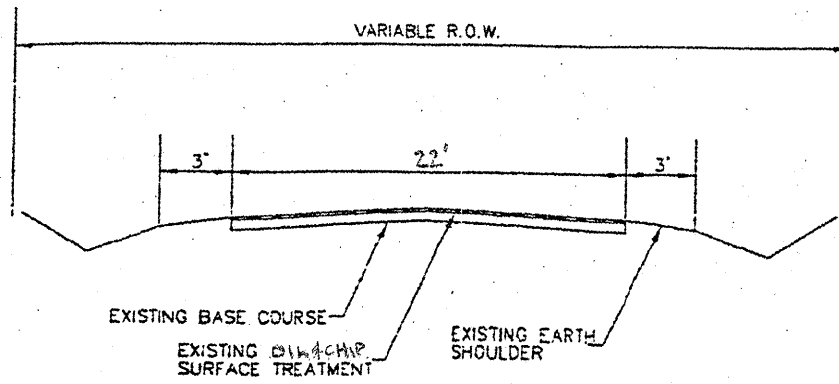

TYPICAL EXISTING SECTION

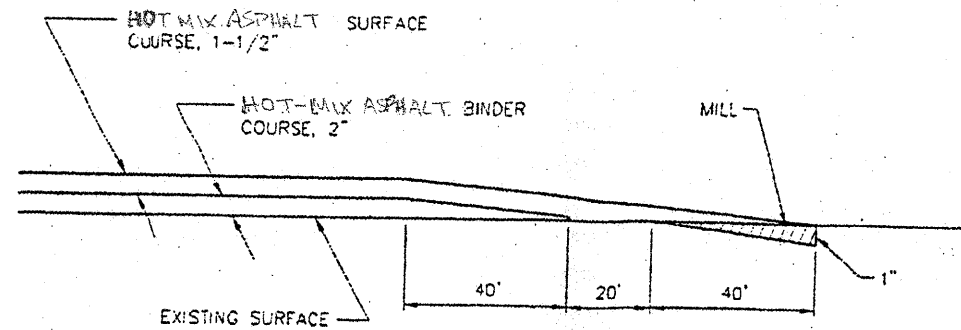

TYPICAL BUTT JOINT

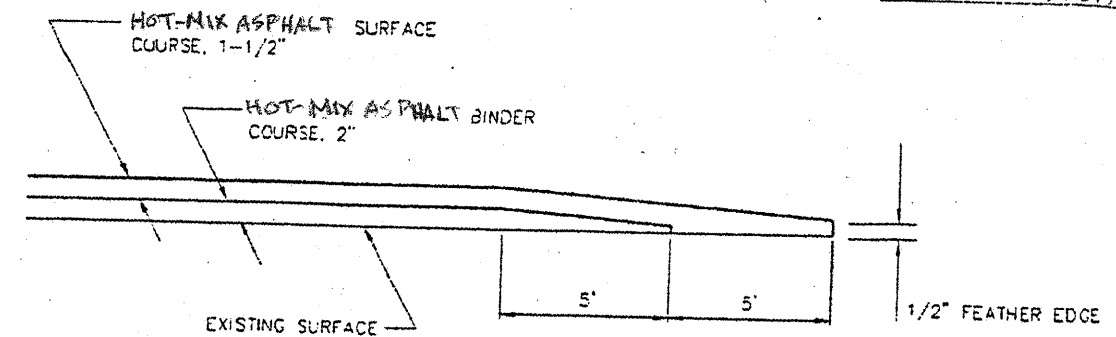

TYPICAL FEATHER JOINT

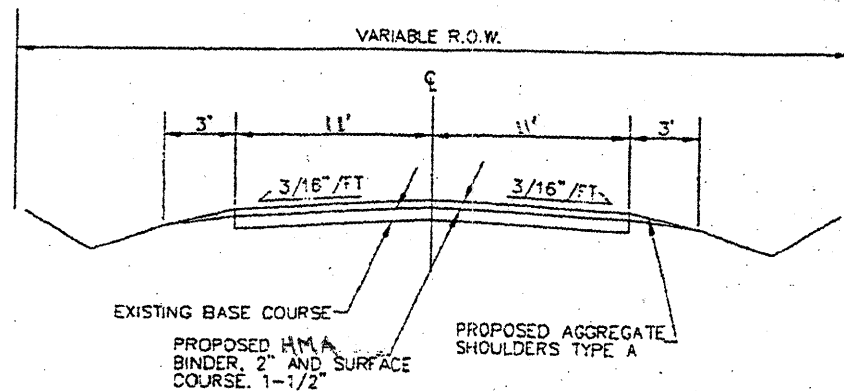

TYPICAL PROPOSED SECTION

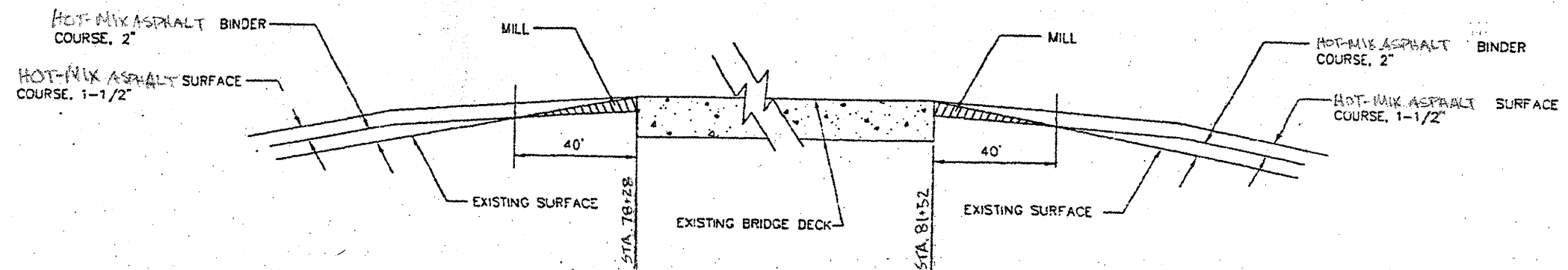

SURFACING AT BRIDGE

SCHEDULE OF PAVEMENT MARKING LINE, 4"

NORTHBOUND LANE			SOUTHBOUND LANE				
STATION	NO PASSING (YELLOW SOLID)	CENTERLINE (YELLOW DASHED)	STATION	NO PASSING (YELLOW SOLID)	CENTERLINE (YELLOW DASHED)	STATION	EDGE LINE (WHITE SOLID)
STA. 0+12 - 6+60	-	162 FT	STA. 6+60 - 15+21	-	215 FT	0+12.0 to 159+38	31,384 FT
STA. 6+60 - 18+15	1,155 FT	-	STA. 15+21 - 36+00	2,079 FT	-		
STA. 18+15 - 22+85	-	118 FT	STA. 36+00 - 104+25	-	276 FT		
STA. 22+85 - 25+75	290 FT	-	STA. 104+25 - 110+40	615 FT	-		
STA. 25+75 - 93+20	-	1680 FT		-	-		
STA. 93+20 - 101+36	816 FT	-		-	-		
STA. 101+36 - 159+38	-	1451 FT		-	-		
	-	-		-	-		
	-	-		-	-		
	-	-		-	-		
	-	-		-	-		
	-	-		-	-		
TOTALS	2,261 FT	3,417 FT	TOTALS	2,694 FT	491 FT	TOTALS	31,384 FT

TYPICAL SECTIONS & MISCELLANEOUS DETAILS

ROUTE	SECTION	COUNTY	TOTAL SHEETS	SHEET NO.
FAS 1876	06-0016L-00-RS	FRANKLIN	6	4
CONTRACT No.: 99319				

CURVE DATA
 $\Delta = 57^{\circ}12'30''$
 $D = 8^{\circ}-00'$
 $R = 716.78$
 $L = 715.10'$
 $T = 390.94$
 $E = 99.65$

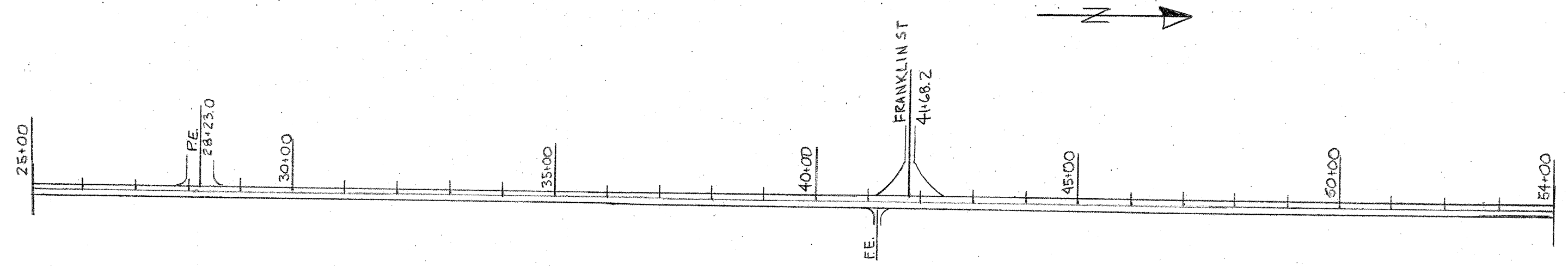
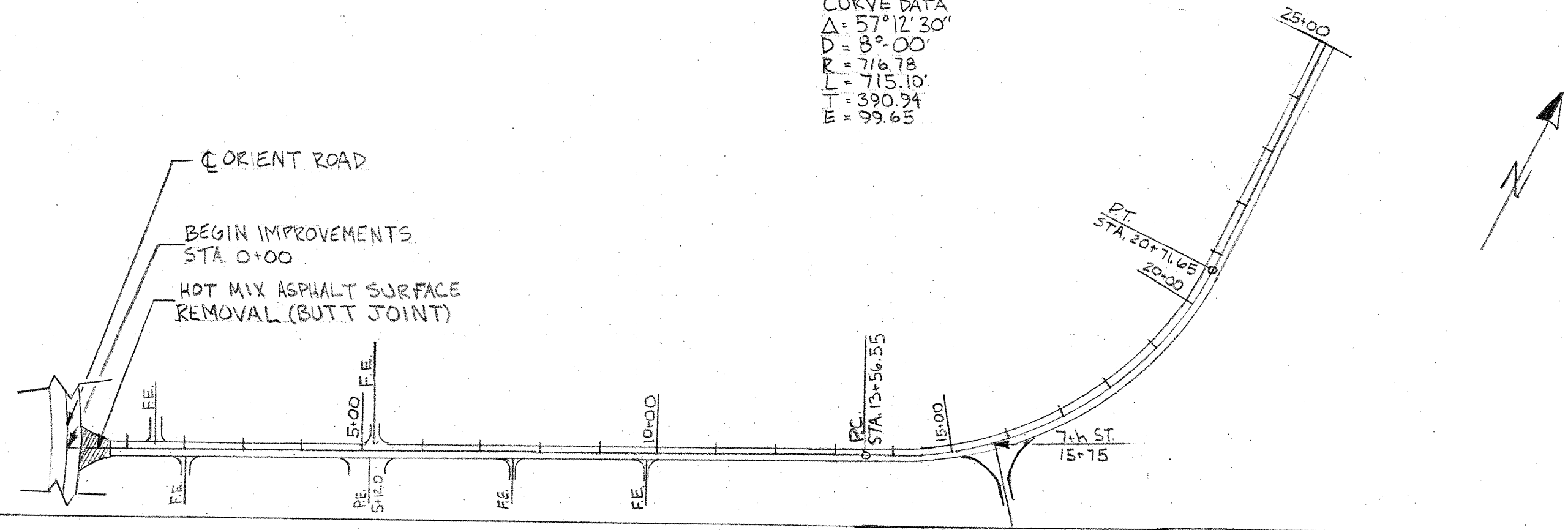

SCALE
 1"=200'

PLAN
 STATION 0+00 TO 54+00

ROUTE	SECTION	COUNTY	TOTAL SHEETS	SHEET NO.
FAS 187	03-00161-00-RS	FRANKLIN	6	5
CONTRACT No.: 99319				

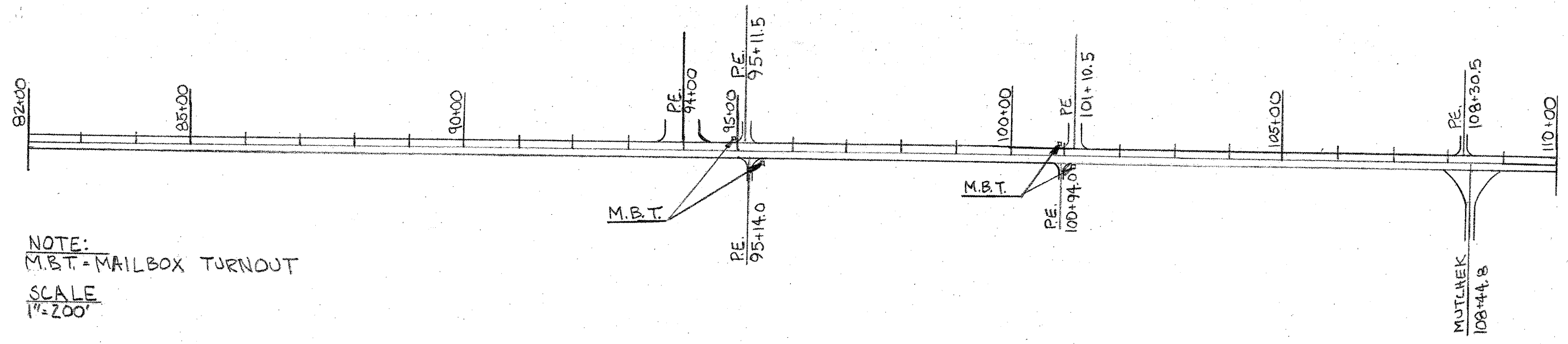
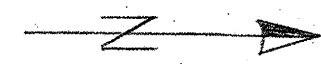
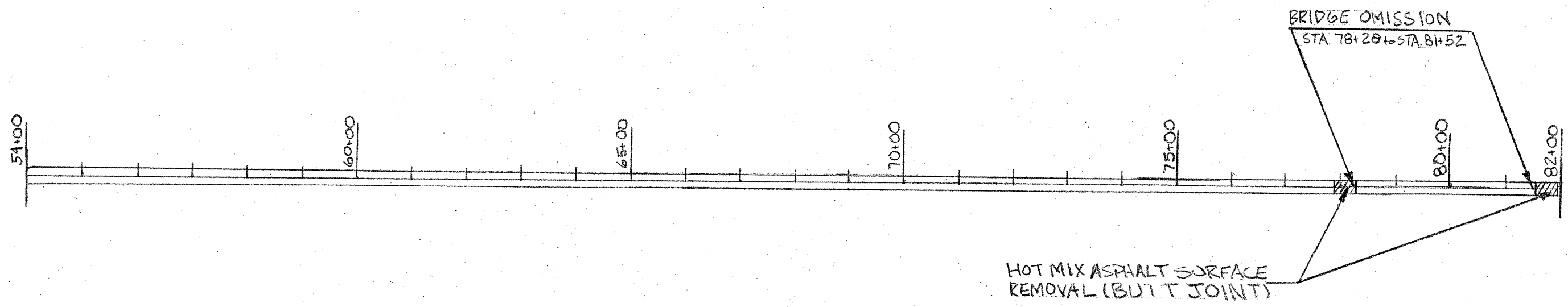
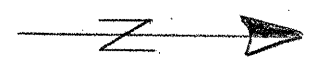

NOTE:
M.B.T. = MAILBOX TURNOUT
SCALE
1" = 200'

PLAN
STATION 54+00 TO 110+00

ROUTE	SECTION	COUNTY	TOTAL SHEETS	SHEET NO.
FAS 1876	05-00161-00-RS	FRANKLIN	6	6
CONTRACT No.: 99319				

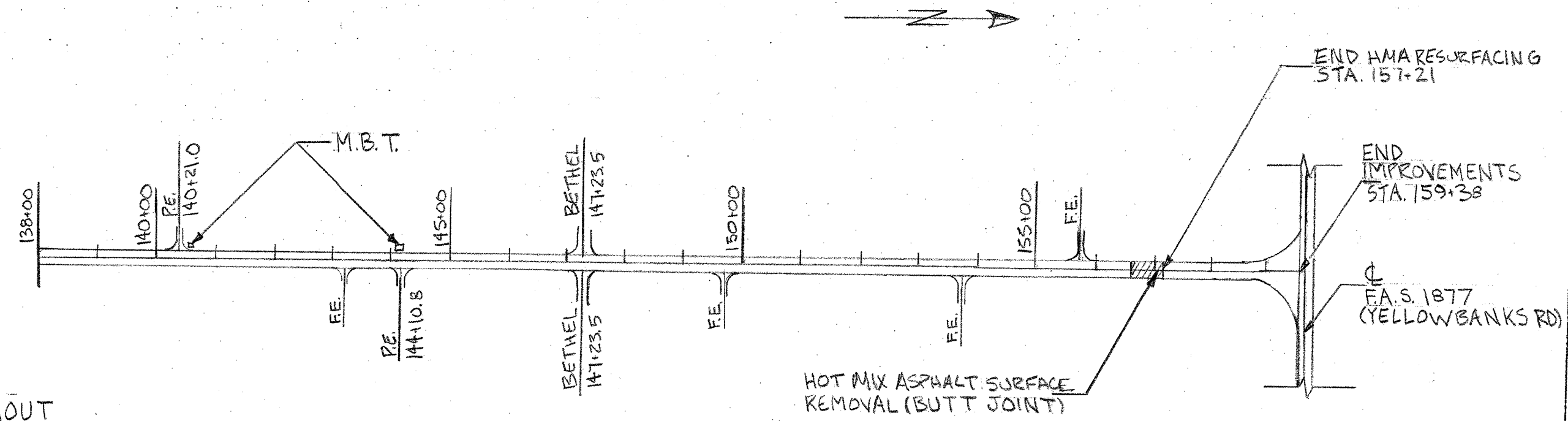
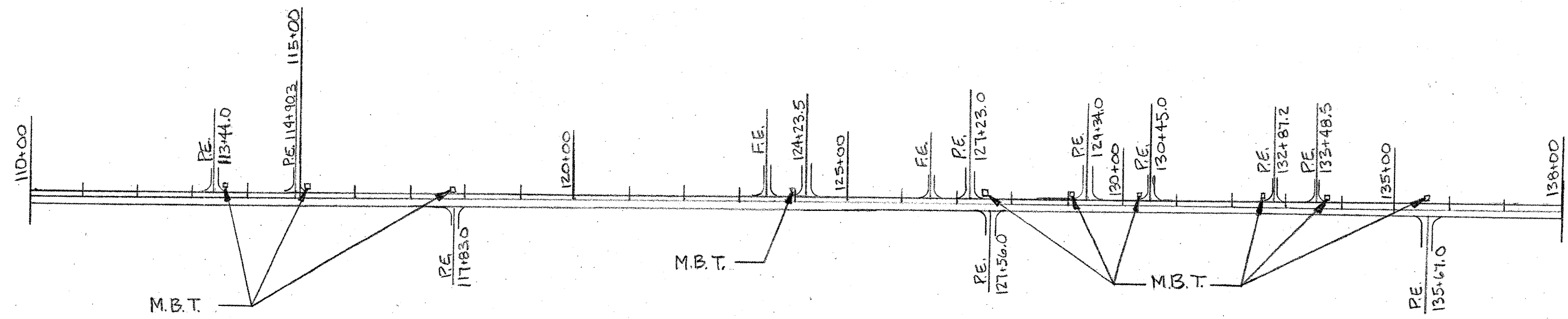

NOTE:
M.B.T.=MAILBOX TURNOUT

SCALE
1"=200'

PLAN
STATION 110+00 TO 159+38