

LEGEND

- 840 — EXISTING CONTOURS
- 840 — NEW CONTOUR
- - - EXISTING DITCH
- - - NEW PAVED DITCH
- SS EXISTING STORM SEWER
- (300) STRUCTURE NUMBER



BL063

K:\Bloomington\0708502\Draw\EGPT
 FILE: RCP01006.dwg
 UPDATE BY: Kristy Brod
 PLOT DATE: 4/14/2008 9:43 AM
 rcp01006
 CL_STA
 BASE_EXISTTOPO
 BASE_PROPCON
 BASE_EXISTGEO
 BASE_CONTOURS30SCALE
 tbinfo
 BASE_PROPIP

REVISIONS

NUMBER	BY	DATE

0 1 2
 THIS BAR IS EQUAL TO 2"
 AT FULL SCALE (34X22).

SCALES:
 1" = 50' HOR
 1" = 1' VER

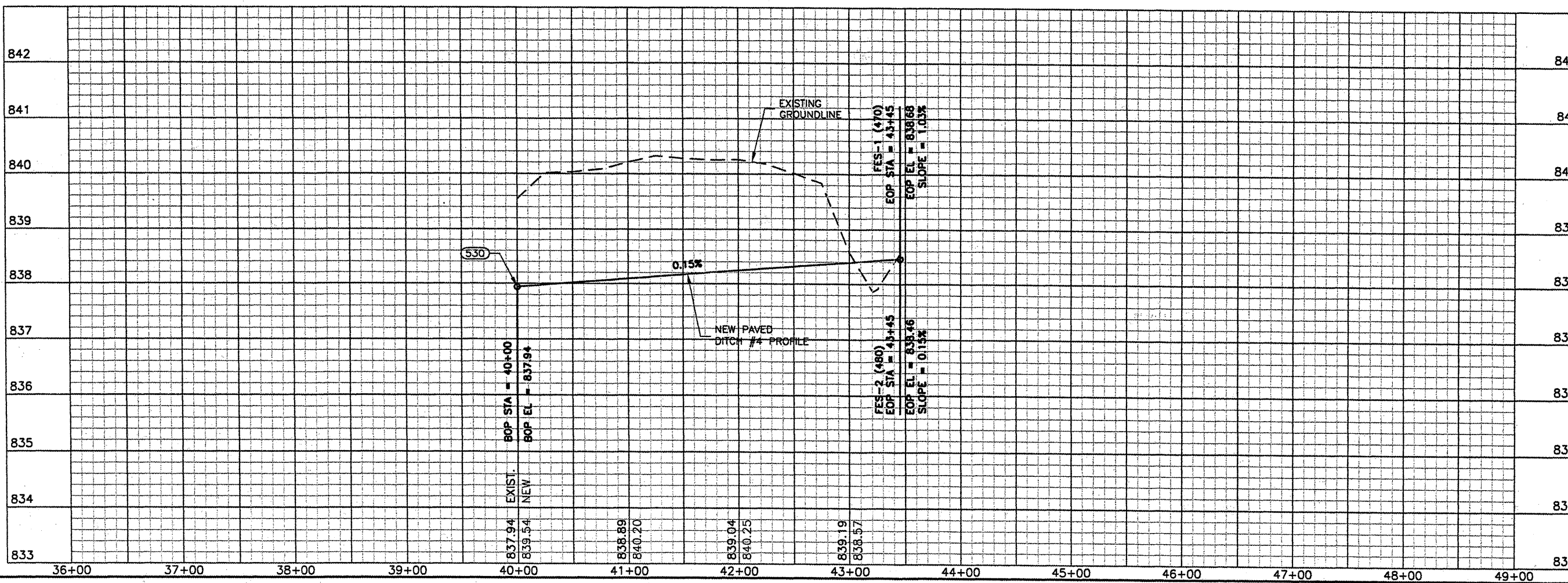

BLOOMINGTON-NORMAL AIRPORT AUTHORITY
CENTRAL ILLINOIS REGIONAL AIRPORT
BLOOMINGTON, ILLINOIS

CONSTRUCT DRAINAGE IMPROVEMENTS
DITCH 4 GRADING
PLAN & PROFILE
STA. 40+00 TO STA. 43+45

© Copyright CMT, Inc.
CMT
 CRAWFORD, MURPHY & TILLY, INC.
 CONSULTING ENGINEERS
 License No. 184-000813

DESIGN BY:	KLB
DRAWN BY:	DPA
CHECKED BY:	REV
APPROVED BY:	REV
DATE:	04/01/2008
JOB No:	0708502

IL PROJ NO. BMI-3793
 AIP PROJ NO. 3-17-0006-45
 SHEET 17 OF 46 SHEETS