

**BL063**

K:\Bloomington\0708502\Draw\EGPT  
 FILE: RCp02011.dwg  
 UPDATE BY: Kristy Brod  
 PLOT DATE: 4/14/2008 9:44 AM  
 rcp011  
 BASE\_EXISTGEO  
 BASE\_AERIAL  
 BASE\_EXISTTOPO  
 CL\_STA  
 BASE\_PROPCON  
 BASE\_CONTOURS30SCALE  
 tbinfa

**STREID DRIVE**

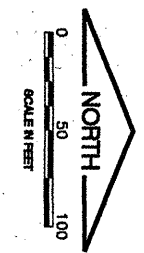

**LEGEND**

- 840 — EXISTING CONTOURS
- 840 — NEW CONTOUR
- - - EXISTING DITCH

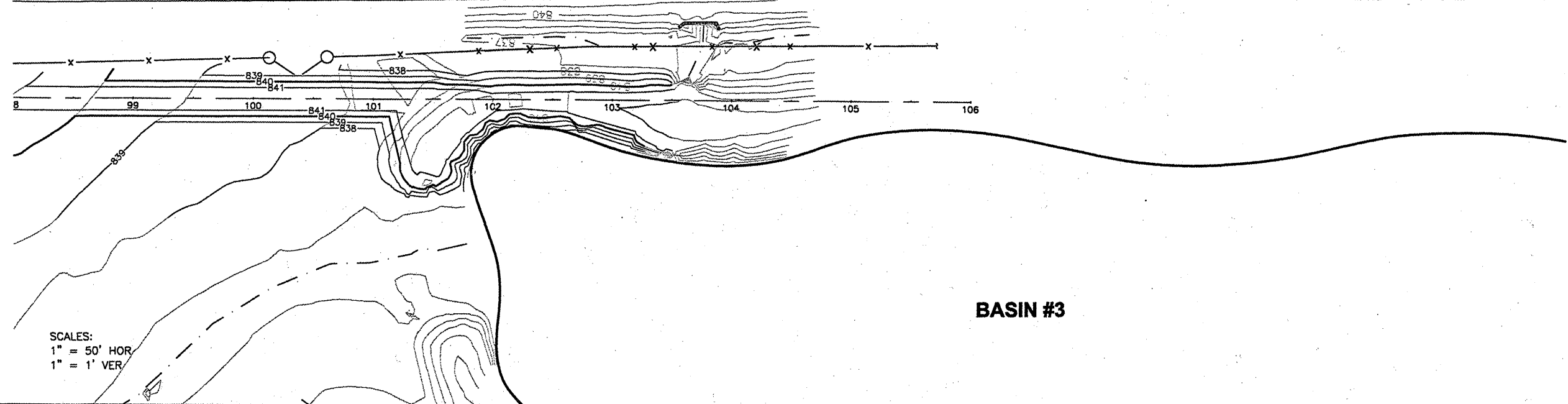

REVISIONS		
NUMBER	BY	DATE

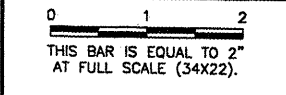

SCALES:  
 1" = 50' HOR  
 1" = 1' VER

**BASIN #3**

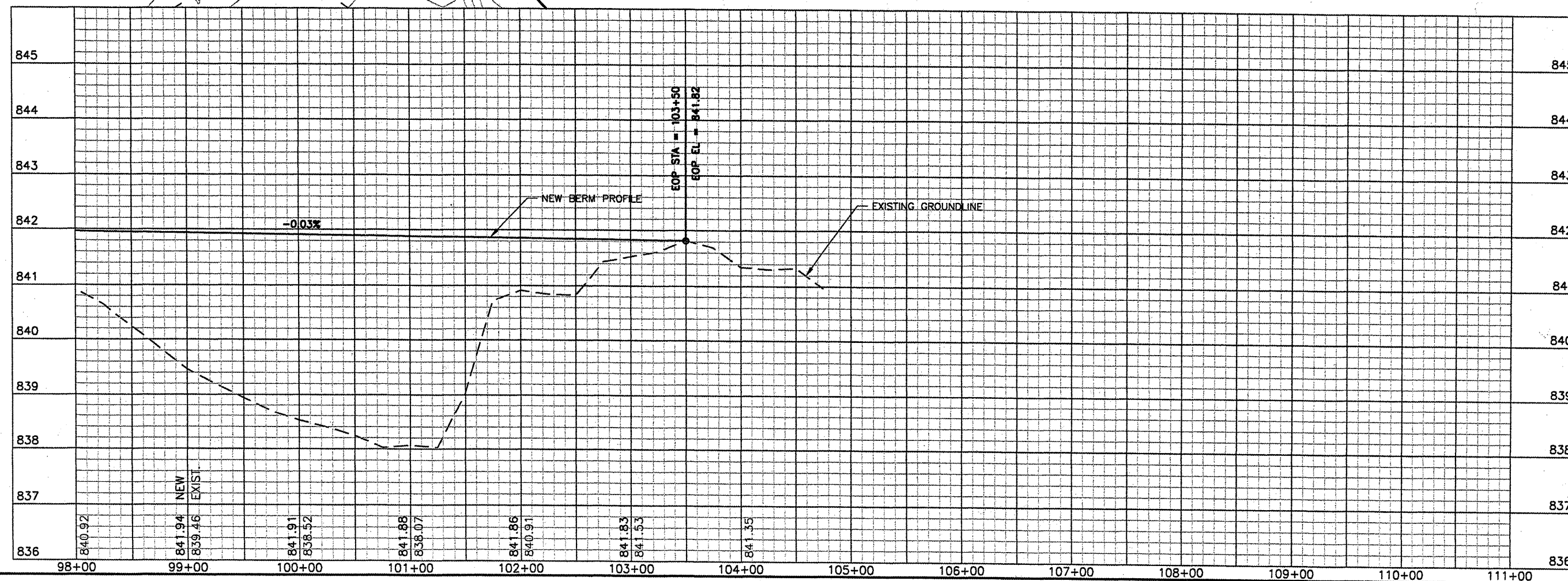

**BLOOMINGTON-NORMAL AIRPORT AUTHORITY**  
**CENTRAL ILLINOIS REGIONAL AIRPORT**  
**BLOOMINGTON, ILLINOIS**

**CONSTRUCT DRAINAGE IMPROVEMENTS**  
**BERM GRADING**  
**PLAN & PROFILE 2**  
**STA. 98+00 TO STA. 103+50**

© Copyright CMT, Inc.  
**CMT**  
 CRAWFORD, MURPHY & TILLY, INC.  
 CONSULTING ENGINEERS  
 License No. 84-000613

DESIGN BY:	KLB
DRAWN BY:	DPA
CHECKED BY:	<i>REN</i>
APPROVED BY:	<i>REN</i>
DATE:	04/01/2008
JOB No:	0708502

IL PROJ NO. BMI-3793  
 AIP PROJ NO. 3-17-0006-45  
 SHEET 20 OF 46 SHEETS