



HANSON PROFESSIONAL SERVICES INC.

815 Commerce Drive, Suite 200
Oak Brook, Illinois 60523
Telephone: 630.990.3800
Fax: 630.990.3801

Illinois Professional Design Firm
Registration No. 184-001084

© Copyright Hanson Professional Service Inc. 2008



JOLIET REGIONAL PORT DISTRICT

1 George Michas Drive
Romeoville, Illinois 60446
Telephone: 815.838.9497
Fax: 815.838.9524

EXTEND RUNWAY 2-20: CONSTRUCT
TAXIWAY TURNAROUND

AIP PROJECT NO. 3-17-0140-B42
IDA PROJECT NO. LOT-3792

GROUND CHECK POINT	STATION	OFFSET
R11	161+87.77	255.00' LT
R3	145+06.10	156.74' LT
L3	146+06.08	156.34' RT
L11	150+30.96	480.00' RT

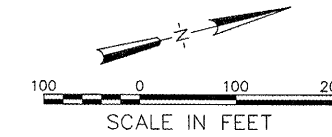

LEGEND
● PROPOSED IMBEDDED GROUND CHECK POINT

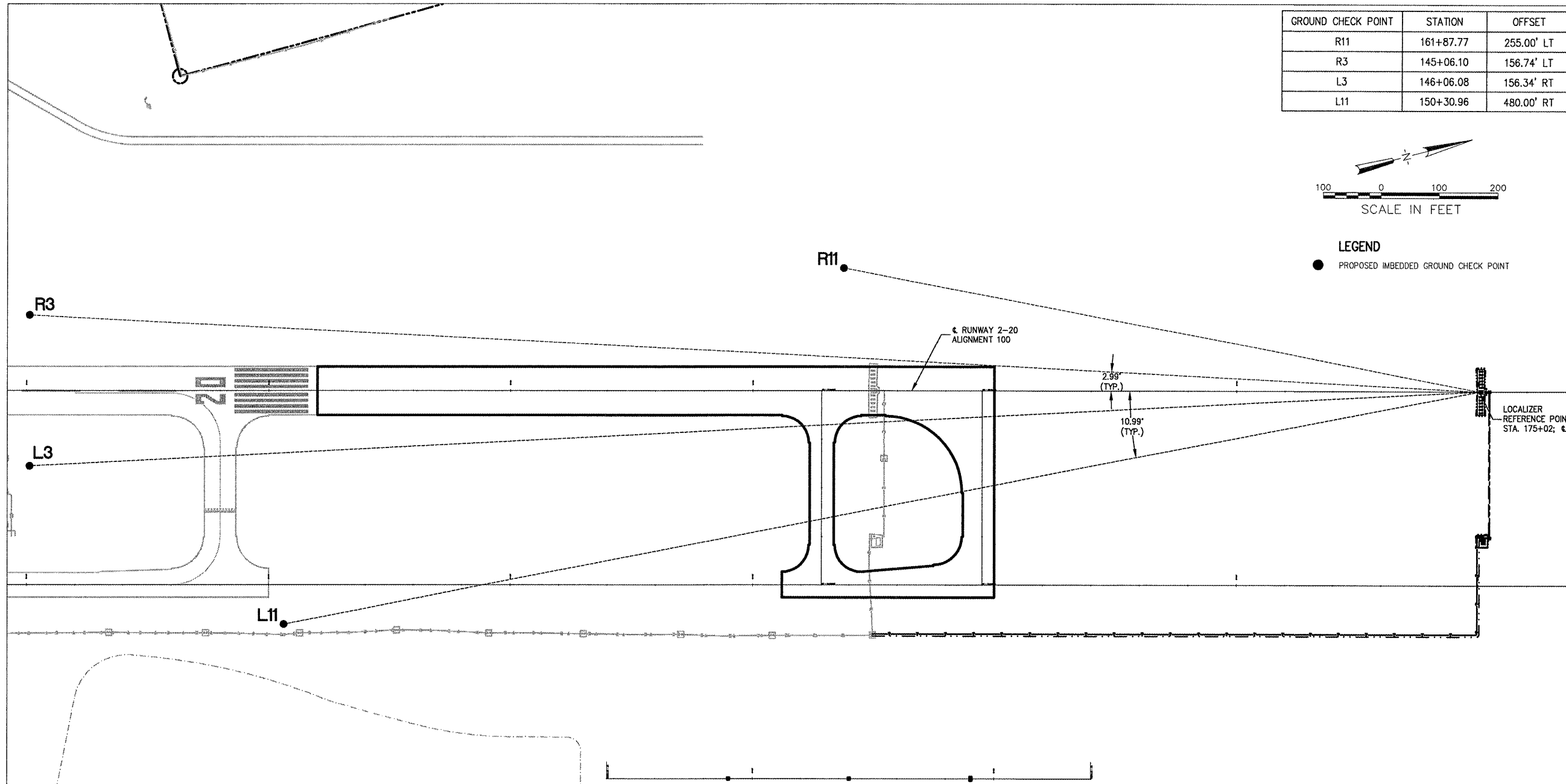

CHECK POINT LAYOUT

NOTES:

- COURSE WIDTH CHECK POINTS SHALL BE IMBEDDED TYPE AS PER DETAIL. INSTALL THE CHECK POINT SO IT WILL NOT CONFLICT WITH PAVED SURFACE.
- CONTRACTOR TO PROVIDE 4 IMBEDDED CHECK POINTS AS SHOWN. THREE ADDITIONAL IMBEDDED GROUND CHECK POINTS SHALL BE LOCATED AT THE LOCALIZER ANTENNA (SEE SHEET 69). COST INCIDENTAL TO LOCALIZER.

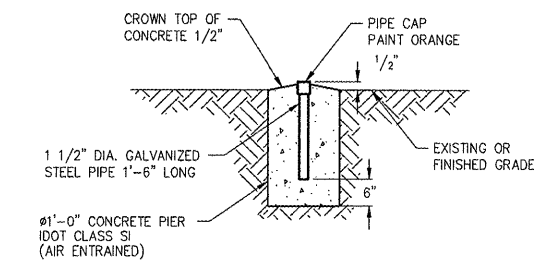

IMBEDDED GROUND CHECK POINT DETAIL
(NOT TO SCALE)

No.	Drawing Issue Description	Date	By

Date
APRIL 18, 2008
Sheet Title

LOCALIZER GROUND
CHECK POINT PLAN
AND DETAIL

07A0166
Project Number
LDH 03/20/08
Layout By Date
LDH 03/20/08
Designed By Date
RMH 03/20/08
Reviewed By Date
RJT
Drawn By Sheet No.

I:\07\08\100840\07A0166\DR\HW\CS\SHEETS\74-GROUND CHECK PT PLAN & DETAILS.DWG APR 18, 2008 10:20AM HANSON00802