

AR201-BITUMINOUS BASE COURSE NOTES

A TRACK PAVER WILL BE REQUIRED TO OVERLAY THIS APRON PAVEMENT. THE CONTRACTOR WILL MONITOR THE CONDITION OF THE EXISTING PAVEMENT. THE CONTRACTOR WILL REDUCE TRUCK WEIGHTS AND MINIMIZE TURNING ON THE EXISTING PAVEMENT SO AS NOT TO DETERIORATE THE EXISTING PAVEMENT.

THE CONTRACTOR WILL OFFSET FROM THE EXISTING PAVEMENT JOINTS BY A MINIMUM OF 1.5 FEET.

THE BITUMINOUS BASE COURSE (201) SHALL BE PLACED IN ACCORDANCE WITH ITEM AR201001 "BITUMINOUS BASE COURSE-METHOD 1" AS STATED ON PAGE 187 OF THE INTERIM REVISIONS TO THE SUPPLEMENTAL SPECIFICATIONS AND RECURRING SPECIAL PROVISIONS, ADOPTED MAY 11, 2007.

THIS ITEM OF WORK SHALL CONSIST OF CONSTRUCTING ONE LIFT OF BITUMINOUS BASE COURSE (2-1/2 INCH DEPTH) ON THE EXISTING BITUMINOUS SURFACE COURSE FOR THE PROPOSED RUNWAY EXTENSION.

THE PROPOSED BITUMINOUS BASE COURSE WILL BE DESIGNED TO A MARSHALL DESIGN OF LESS THAN 60,000 POUNDS.

AR401611 BITUMINOUS SURFACE COURSE - METHOD 1

A TRACK PAVER WILL BE REQUIRED TO OVERLAY THIS APRON PAVEMENT. THE BITUMINOUS SURFACE COURSE (401) SHALL BE PLACED IN ACCORDANCE WITH ITEM AR401001 "BITUMINOUS SURFACE COURSE-METHOD 1" AS STATED ON PAGE 247 OF THE INTERIM REVISIONS TO THE SUPPLEMENTAL SPECIFICATIONS AND RECURRING SPECIAL PROVISIONS, ADOPTED MAY 11, 2007.

THIS ITEM OF WORK SHALL CONSIST OF CONSTRUCTING 1 LIFT OF BITUMINOUS SURFACE COURSE (1-1/2" INCH DEPTH) ON THE PROPOSED BITUMINOUS BASE COURSE.

THE CONTRACTOR SHALL BE RESPONSIBLE FOR THE QUALITY CONTROL IN THE PRODUCTION AND CONSTRUCTION OF THE BITUMINOUS SURFACE COURSE.

PRIOR TO STARTING THE BITUMINOUS SURFACE COURSE OPERATION, THE CONTRACTOR SHALL SUBMIT TO THE RESIDENT ENGINEER A DETAILED OUTLINE SHOWING AREAS AND ORDER OF PAVING WIDTHS OF PAVING LANES, AND REQUIRED OFFSETS FOR ELECTRONIC GRADE. NO STRINGLINE GRADE CONTROL WILL BE REQUIRED PROVIDED THE PROPOSED GRADE HAS BEEN ESTABLISHED DURING THE PAVING OF THE BASE COURSE.

THE PROPOSED BITUMINOUS SURFACE COURSE WILL BE DESIGNED TO A MARSHALL DESIGN OF LESS THAN 60,000 POUNDS.

401-4.9 ADD THE FOLLOWING TO THIS SECTION:

WHEN HAND SPREADING IS PERMITTED, THE MIXTURE WILL BE DISTRIBUTED AND SPREAD USING HAND TOOLS. WHEN THE WORK IS COMPLETED, THE LAYER WILL HAVE THE REQUIRED THICKNESS AND CONFORM TO THE GRADE AND SURFACE CONTOUR SHOWN ON THE PLANS.

401-4.12 ADD THE FOLLOWING TO THIS PARAGRAPH:

ALL PAVEMENT EDGES (LONGITUDINAL, RADIUS, AND PAVEMENT ENDS) MUST BE LEFT IN PROPER ALIGNMENT AS SHOWN ON THE PLANS. THIS MAY BE ACCOMPLISHED BY THE TRIMMING METHOD OUTLINED ABOVE OR AT THE CONTRACTOR'S OPTION BY SAWING AFTER THE PAVING HAS BEEN COMPLETED. NO ADDITIONAL COMPENSATION WILL BE MADE IF THE SAWING METHOD IS USED.

603-BITUMINOUS TACK COAT NOTES:

THE BITUMINOUS TACK COAT (603) SHALL BE PLACED IN ACCORDANCE WITH ITEM AR603 "BITUMINOUS TACK COAT" AS STATED ON PAGE 62 OF THE SUPPLEMENTAL SPECIFICATIONS AND RECURRING SPECIAL PROVISIONS, ADOPTED JULY 1, 2004.

THE PROPOSED BITUMINOUS TACK COAT SHALL BE PLACED ON THE PROPOSED BITUMINOUS PAVEMENT PRIOR TO THE PLACEMENT OF THE NEXT LIFT OF PROPOSED BITUMINOUS SURFACE COURSE. THE PROPOSED BITUMINOUS PAVEMENT SHALL HAVE A TACK COAT OF BITUMINOUS MATERIAL APPLIED IN ACCORDANCE WITH THE REQUIREMENTS OF THE SUPPLEMENTAL SPECIFICATIONS AND RECURRING SPECIAL PROVISIONS.

THE PROPOSED BITUMINOUS TACK COAT WILL BE PAID FOR UNDER ITEM:
AR603510 BITUMINOUS TACK COAT _____ PER GAL.

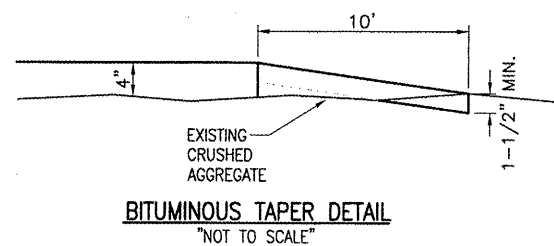
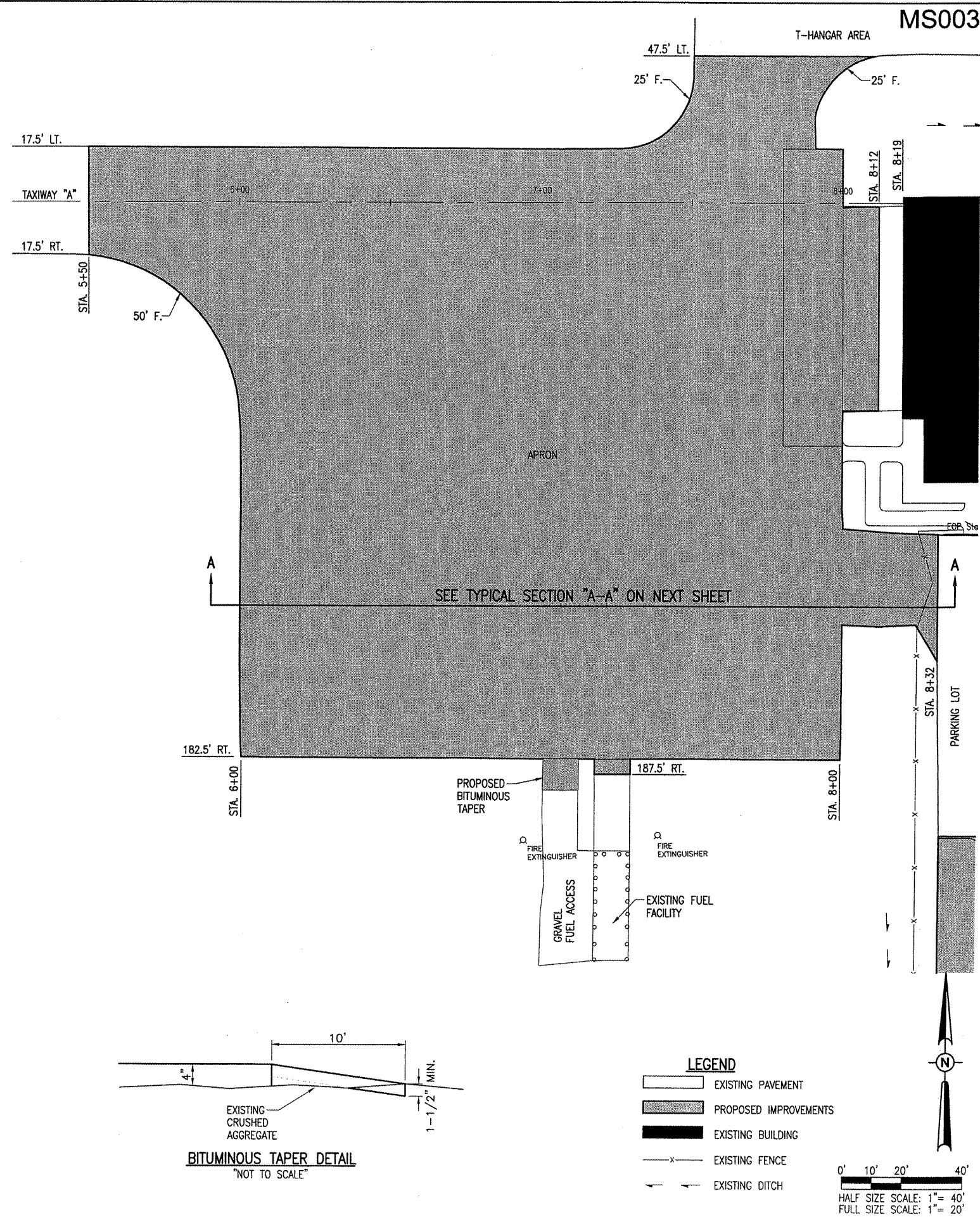

- LEGEND**
- EXISTING PAVEMENT
 - PROPOSED IMPROVEMENTS
 - EXISTING BUILDING
 - EXISTING FENCE
 - EXISTING DITCH

0' 10' 20' 40'
 HALF SIZE SCALE: 1" = 40'
 FULL SIZE SCALE: 1" = 20'

DATE	REVISION	BY
5/12/08	REVISED AS PER IDA REVIEW	CAH

**ROBERT F. TRACY MUNICIPAL AIRPORT
 MT. STERLING, ILLINOIS**

IL PROJ.: 163-3715 A.I.P. PROJ.: 3-17-0147-B9

I&E Project No. 07A00580_0800 Drawing R-12.1.CON.DWG Scale 1" = 20' Date 12/03/07	LAYOUT KDM 12/03/07 DRAWN BAK 12/03/07 REVIEWED CAH 04/14/08
--	--

HANSON
 Hanson Professional Services Inc.
 1525 S. St. Louis
 Springfield, Illinois 62703-2886
 Offices Nationwide

**EXPAND AUTO PARKING
 LOT & OVERLAY APRON**

PROPOSED
 CONSTRUCTION PLAN FOR
 AIRCRAFT PARKING APRON

MAY 11, 2008 4:46 PM HAGL000382
 I:\AIRPORTS\MTSTERLING\07A00580\CAD\SHEETS\R-12.1.CON.DWG - APRON