

- LEGEND FOR TYPICAL SECTION "A-A"**
- ① EXISTING GRADE
  - ② EXISTING BITUMINOUS SURFACE COURSE (4" DEPTH)
  - ③ EXISTING CRUSHED AGGREGATE BASE COURSE (6" DEPTH)
  - ④ PROPOSED BITUMINOUS SURFACE COURSE (2" DEPTH)
  - ⑤ PROPOSED BITUMINOUS TACK COAT (0.10 GAL./S.Y.)
  - ⑥ PROPOSED BITUMINOUS PRIME COAT (0.35 GAL./S.Y.)
  - ⑦ PROPOSED CRUSHED AGGREGATE BASE COURSE (6" DEPTH)
  - ⑧ PROPOSED GRADE
  - ⑨ SEPARATION FABRIC

**602-BITUMINOUS PRIME COAT NOTES:**  
 THE BITUMINOUS PRIME COAT (602) SHALL BE PLACED IN ACCORDANCE WITH ITEM AR602 "BITUMINOUS PRIME COAT" AS STATED ON PAGE 58 OF THE SUPPLEMENTAL SPECIFICATIONS AND RECURRING SPECIAL PROVISIONS, ADOPTED JULY 1, 2004.  
 THE PROPOSED BITUMINOUS PRIME COAT SHALL BE PLACED ON THE PROPOSED AGGREGATE BASE COURSE PRIOR TO THE PLACEMENT OF THE FIRST LIFT OF PROPOSED BITUMINOUS BASE COURSE. THE PROPOSED AGGREGATE BASE COURSE SHALL HAVE A PRIME COAT OF BITUMINOUS MATERIAL APPLIED IN ACCORDANCE WITH THE REQUIREMENTS OF THE SUPPLEMENTAL SPECIFICATIONS AND RECURRING SPECIAL PROVISIONS.  
 THE PROPOSED BITUMINOUS PRIME COAT WILL BE PAID FOR UNDER ITEM: AR602510 BITUMINOUS PRIME COAT \_\_\_\_ PER GAL.

**AR209-CRUSHED AGGREGATE BASE COURSE NOTES**  
 THE CRUSHED AGGREGATE BASE COURSE (209) SHALL BE PLACED IN ACCORDANCE WITH ITEM 209 "CRUSHED AGGREGATE BASE COURSE" AS STATED ON PAGE 45 OF THE SUPPLEMENTAL SPECIFICATIONS AND RECURRING SPECIAL PROVISIONS, ADOPTED JULY 1, 2004.  
 THE CRUSHED AGGREGATE BASE COURSE MATERIAL (CA-6) WILL BE USED TO CONSTRUCT A BASE COURSE FOR THE PROPOSED BITUMINOUS BASE COURSE (201). THE CRUSHED AGGREGATE BASE COURSE MATERIAL WILL BE 6" IN DEPTH AND COMPACTED TO NOT LESS THAN 95 PERCENT DENSITY.  
 THE PROPOSED AGGREGATE FOR THE BASE COURSE MATERIAL SHALL MEET THE REQUIREMENTS OF GRADATION "B" IN TABLE 1 OF THE SUPPLEMENTAL SPECIFICATIONS.  
**209-3.2 EQUIPMENT.** ADD THE FOLLOWING PARAGRAPHS TO THIS SECTION:  
 "PROVISIONS SHALL BE MADE BY THE CONTRACTOR FOR FURNISHING WATER AT THE PLANT AND AT THE SITE OF THE WORK BY EQUIPMENT OF AMPLE CAPACITY AND OF SUCH DESIGN AS TO ASSURE UNIFORM MIXING AND APPLICATION."  
 THE CONTRACTOR WILL PROVIDE THE RESIDENT ENGINEER A PROCTOR CURVE SHOWING OPTIMUM DENSITY AND MOISTURE FOR THE SUPPLIED BASE COURSE MATERIAL.  
 THE COMPACTION CONTROL TEST TO BE USED SHALL BE FAA COMPACTION CONTROL TEST T-611 FOR AIRCRAFT WEIGHING LESS THAN 60,000 LBS.  
**209-4.1.** DELETE THE FIFTH SENTENCE AND REPLACE IT WITH THE FOLLOWING:  
 "IF AT THE TIME THE AGGREGATES ARE WEIGHED THEY CONTAIN MORE THAN SIX (6) PERCENT OF ABSORBED AND FREE MOISTURE BY WEIGHT, A DEDUCTION FOR THE MOISTURE IN EXCESS OF THIS AMOUNT SHALL BE MADE IN DETERMINING THE PAY QUANTITY."

**603-BITUMINOUS TACK COAT NOTES:**  
 THE BITUMINOUS TACK COAT (603) SHALL BE PLACED IN ACCORDANCE WITH ITEM AR603 "BITUMINOUS TACK COAT" AS STATED ON PAGE 62 OF THE SUPPLEMENTAL SPECIFICATIONS AND RECURRING SPECIAL PROVISIONS, ADOPTED JULY 1, 2004.  
 THE PROPOSED BITUMINOUS TACK COAT SHALL BE PLACED ON THE PROPOSED BITUMINOUS PAVEMENT PRIOR TO THE PLACEMENT OF THE NEXT LIFT OF PROPOSED BITUMINOUS SURFACE COURSE. THE PROPOSED BITUMINOUS PAVEMENT SHALL HAVE A TACK COAT OF BITUMINOUS MATERIAL APPLIED IN ACCORDANCE WITH THE REQUIREMENTS OF THE SUPPLEMENTAL SPECIFICATIONS AND RECURRING SPECIAL PROVISIONS.  
 THE PROPOSED BITUMINOUS TACK COAT WILL BE PAID FOR UNDER ITEM: AR603510 BITUMINOUS TACK COAT \_\_\_\_ PER GAL.

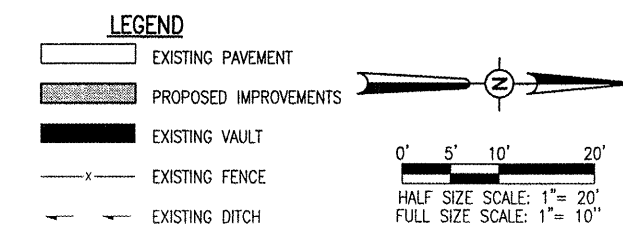

BY		REVISION		DATE	
<p><b>ROBERT F. TRACY MUNICIPAL AIRPORT                  MT. STERLING, ILLINOIS</b></p> <p>IL. PROJ.: 163-3715      A.I.P. PROJ.: 3-17-0147-B9</p>					
H&E Project No. 07A0058D_0800 Filename R-122CON.DWG Scale 1" = 10' Date 12/03/07	LAYOUT KDM 12/03/07 DRAWN BHK 12/03/07 REVIEWED CAH 04/14/08	<p>Hanson Professional Services Inc.                  1525 South Sixth Street                  Springfield, Illinois 62703-2886                  Offices Nationwide</p>			
EXPAND AUTO PARKING LOT & OVERLAY APRON		PROPOSED CONSTRUCTION PLAN FOR AUTO PARKING LOT			
18					
18 of 25 sheets					