

NOTES:

1. TURFING LIMITS SHOWN ARE APPROXIMATE. ACTUAL TURFING LIMITS SHALL BE DETERMINED BY THE RESIDENT ENGINEER.
2. AN ADDITIONAL 2000 SY OF EXCELSIOR BLANKET HAS BEEN INCLUDED IN THE QUANTITIES FOR ADDITIONAL DISTURBED AREAS AS REQUIRED BY THE ENGINEER.
3. RESTORATION AND TURFING OF DISTURBED AREAS BEYOND THE LIMITS SHOWN (SUCH AS EDGE LIGHTING, CABLING, SIGNAGE, ACCESS, STAGING, ETC.) SHALL BE INCIDENTAL TO THE PROJECT.

EARTHWORK SUMMARY

T-HANGAR SITEWORK		
STATION	EXCAVATE END AREA (S.F.)	EMBANK END AREA (S.F.)
9+83.97	15.87	90.23
10+00	21.93	91.61
10+50	25.51	87.50
11+00	26.29	128.57
11+50	24.02	169.15
12+00	21.76	228.42
12+54.97	8.83	210.75
13+00	0.00	0.00

ENTRANCE ROAD		
STATION	EXCAVATE END AREA (S.F.)	EMBANK END AREA (S.F.)
3+48	4.04	21.20
4+00	2.87	39.90
4+50	0.36	52.30
5+00	0.00	37.77
5+58	2.27	12.64
6+00	3.96	10.12

LEGEND

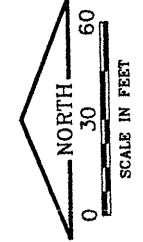
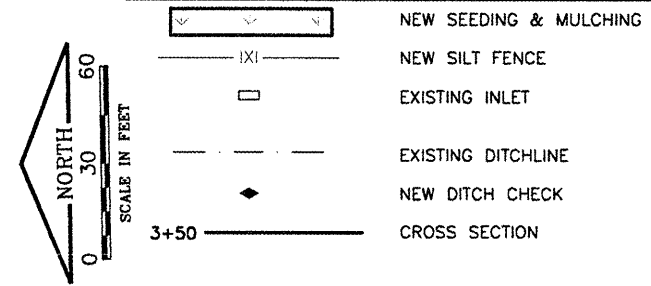

K:\Pckneyville\AP\0706203 SITE WORK HDR\Draw\SH
 FILE: EROS01.dwg
 UPDATE BY: Kristy Brod
 PLOT DATE: 4/9/2008 9:22 AM
 PROP-GEO
 BASE_EXISSTOPO
 ALP1A
 TOPD1A
 OO--OO--OO
 ALP3A
 BASE_PROPTURF
 BASE_PROPDRAIN

REVISIONS		
NUMBER	BY	DATE

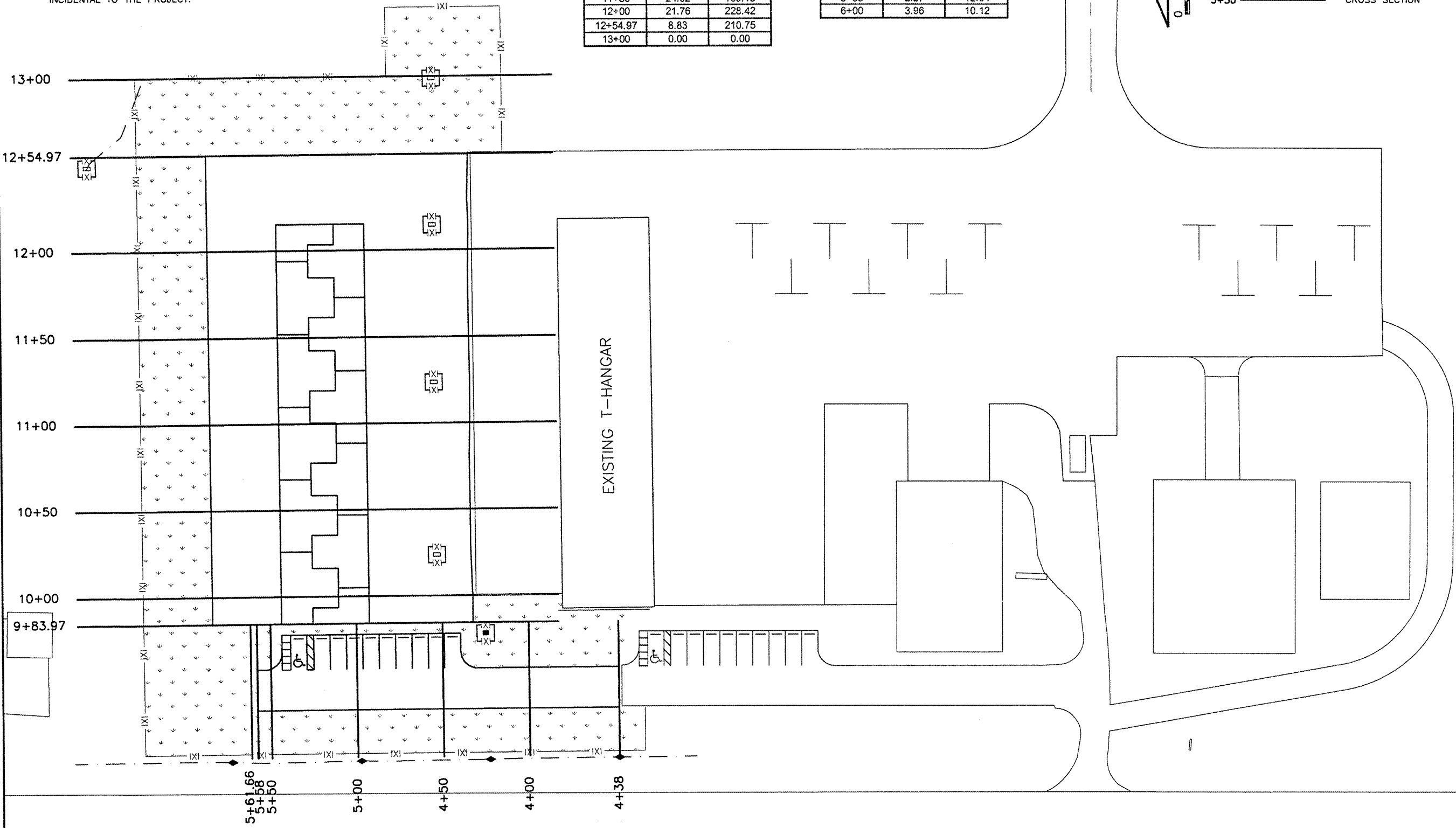
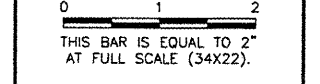

PINCKNEYVILLE-DUQUOIN AIRPORT
PERRY COUNTY, ILLINOIS
T-HANGAR SITE WORK
EROSION CONTROL PLAN
&
EARTHWORK SUMMARY

© Copyright CMT, Inc.
CMT
 CRAWFORD, MURPHY & TILLY, INC.
 CONSULTING ENGINEERS
 License No. 184-000613

DESIGN BY:	KLB
DRAWN BY:	CMT
CHECKED BY:	JEF
APPROVED BY:	JEF
DATE:	04/18/2008
JOB No:	07062-03-00

IL PROJECT NO. PJY-3373
 A.I.P. PROJECT NO. 3-17-0037-B6
 SHEET 14 OF 17 SHEETS