

K:\PekinAp\0606903 W Apron\Draw\Sheets\
 FILE: PROP-IMPV.dwg
 LAYOUT: Layout1
 UPDATE BY: cgroth
 SURVEY BOOK #
 DATE: Fri 4/25/08 8:56am
 XREF DWG: base.dwg
 C:\info.dwg

NOTES

1. CONTRACTOR SHALL PROTECT EXISTING BUILDINGS AND ADJACENT STRUCTURES FROM DAMAGE. REMOVAL AND REINSTALLATION OF EXISTING VERTICAL DRAINS MAY BE NEEDED AT NO ADDITIONAL COST TO THE CONTRACT.
2. CONTRACTOR SHALL PROTECT EXISTING TIE DOWNS FROM BEING FILLED IN WITH SURFACE TREATMENT AT NO ADDITIONAL COST TO THE CONTRACT. PROTECTION OF THE TIE DOWNS SHALL BE OF MEANS SUITABLE TO THE ENGINEER. APPROXIMATELY 81 TIE DOWNS ARE LOCATED IN THE PAVEMENT EACH 12" IN DIAMETER.

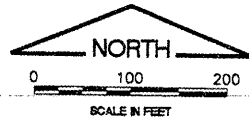

REVISIONS		
NUMBER	BY	DATE

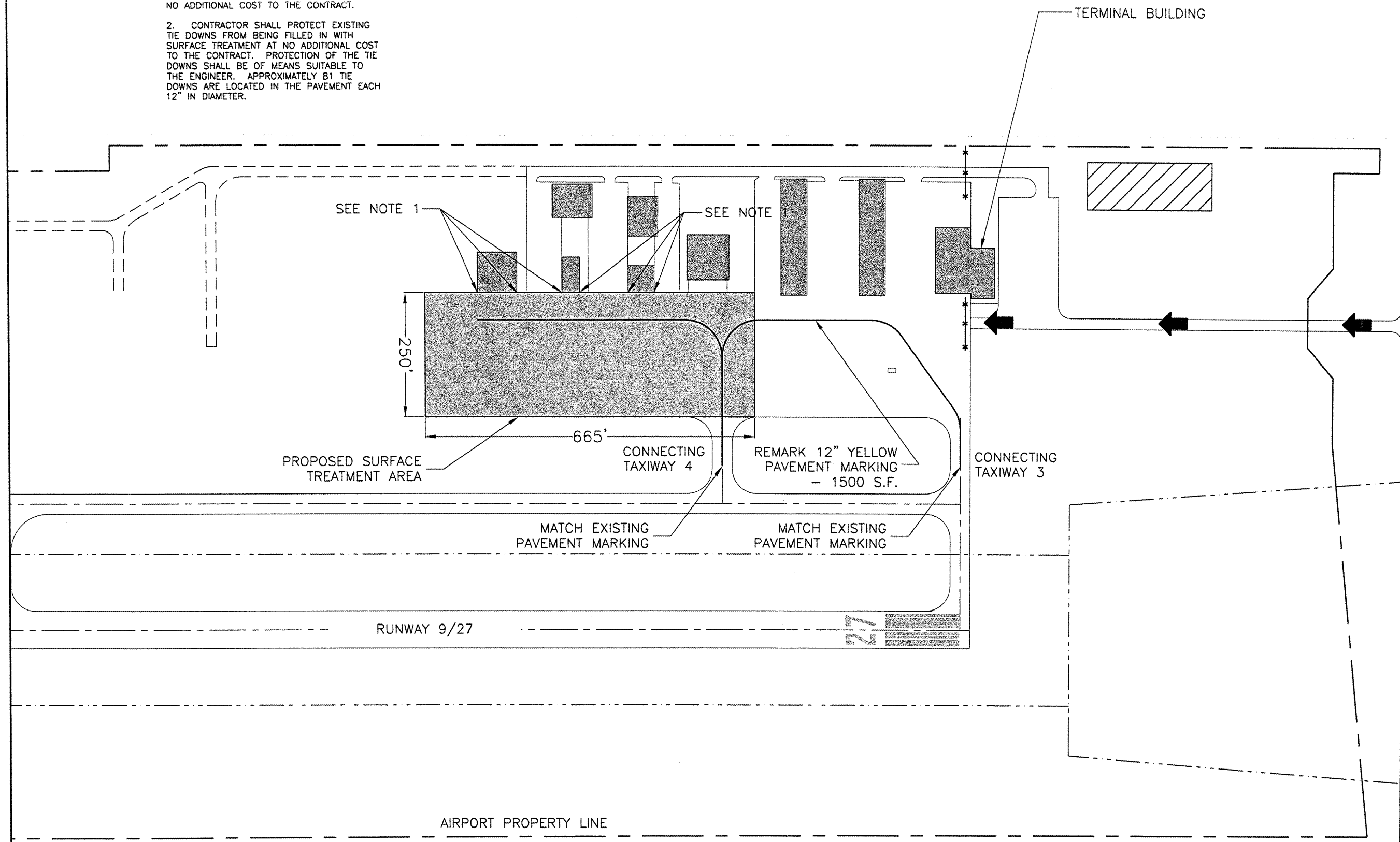
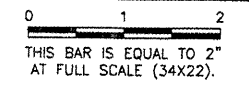

**PEKIN MUNICIPAL AIRPORT
 PEKIN, TAZEWELL COUNTY, ILLINOIS**

**REHABILITATE WEST PORTION OF GENERAL AVIATION RAMP
 PROPOSED IMPROVEMENTS**

© Copyright CMT, Inc.
CMT
 CRAWFORD, MURPHY & TILLY, INC.
 CONSULTING ENGINEERS
 License No. 184-000619



DESIGN BY:	CBG
DRAWN BY:	CMT
CHECKED BY:	<i>CBG</i>
APPROVED BY:	<i>[Signature]</i>
DATE:	5/02/2008
JOB No:	06069-03-00
IL PROJECT:	C15-3802
A.I.P. PROJECT:	3-17-0078-810
SHEET	3 OF 3 SHEETS