

**TYPICAL FRONT ELEVATION**  
With lights and handrail omitted for clarity.

Walkway and truss grating dimensions are nominal and may vary (width ±½", depth ±½") based on available standard widths.

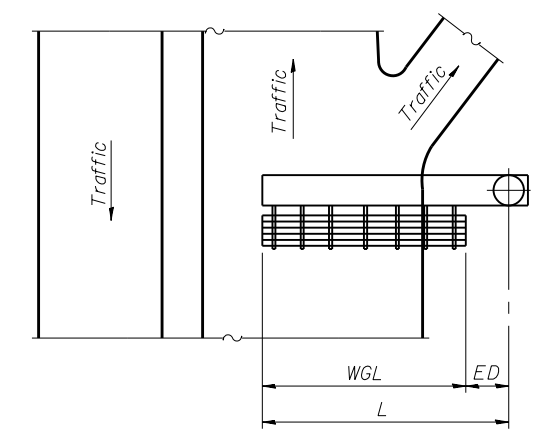

**PLAN WALKWAY AND HANDRAIL SKETCH**  
(Road plan beneath truss varies)

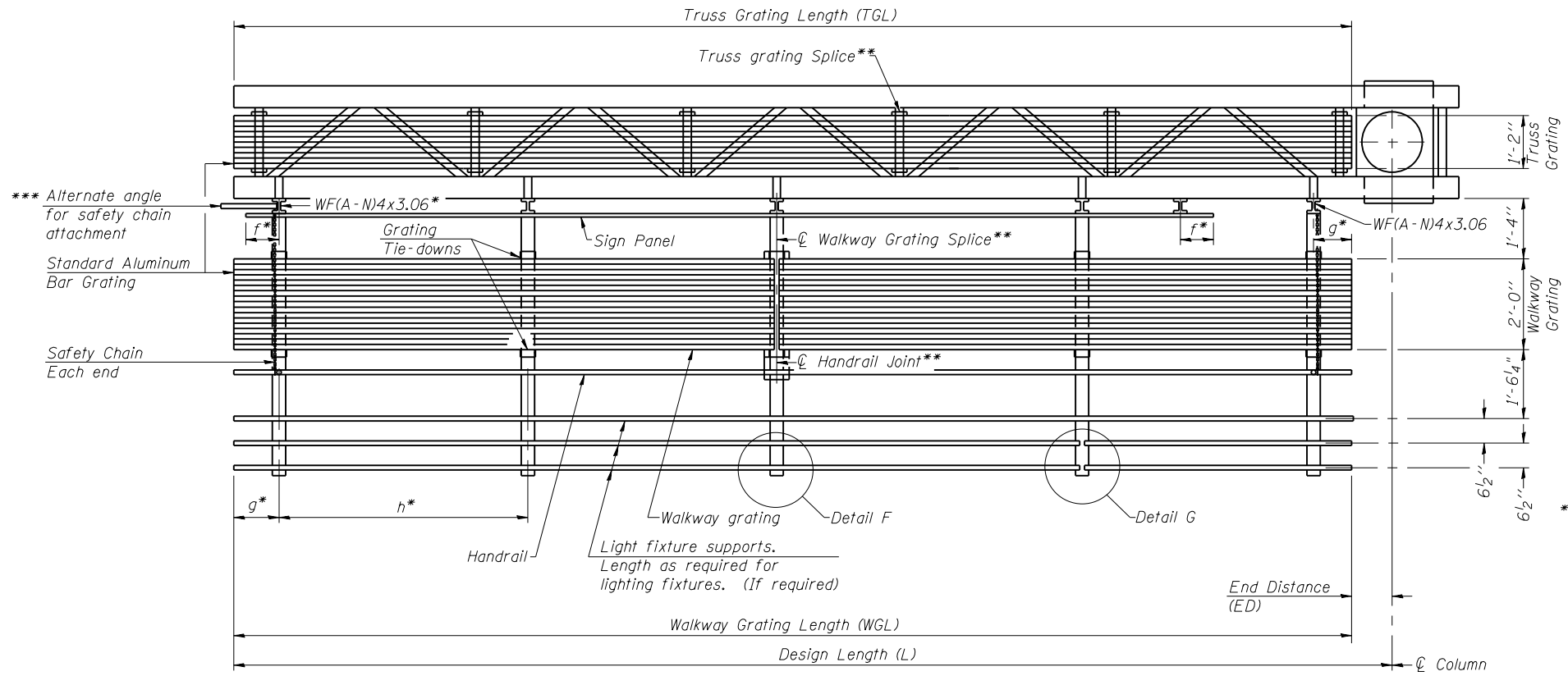

**SECTION A-A**

Truss grating to facilitate inspection shall run full length of cantilevers. Cost of truss grating is included in Overhead Sign Structure Cantilever.

Handrail and walkway grating shall span a minimum of three brackets between splices.  
\*\* Use and location of handrail joints or grating splices are optional, based on lengths needed and material availability.

$$TGL = L - \left( \frac{\text{Post O.D.}}{2} + 6'' \right)$$

D-2 Inventory #  
SN-098  
SN-141

Structure Number	Station	WGL	ED	TGL see note below
2C0811080L003.3		20'-4"	9'-8"	28'-6"
2C0815092R029.3		18'-1"	11'-11"	28'-6"

Notes:  
\* Space walkway brackets WF(A-N)4x3.06 and sign brackets WF(A-N)4x1.79 for efficiency and within limits shown:  
f = 12" maximum, 4" minimum (End of sign to center of nearest bracket)  
g = 12" maximum, 4" minimum (End of walkway to center of nearest bracket)  
h = 6'-0" maximum (center to center sign and/or walkway support brackets, WF(A-N)4x1.79 or WF(A-N)4x3.06)  
\*\*\* If walkway bracket at safety chain location is behind sign, add angle to bracket. See alternate safety chain attachment on base sheet OSC-A-8.  
For details of sign placement, sign/walkway brackets, truss and walkway gratings, grating splices and Section B-B, see Base Sheet OSC-A-7.  
For details of handrail, handrail joint, safety chain and Details F and G, see Base Sheet OSC-A-8.

**BRACKET TABLE**

Sign Width		Number Brackets Required
Greater Than	Less Than or Equal To	
	8'-0"	2
8'-0"	14'-0"	3
14'-0"	20'-0"	4
20'-0"	26'-0"	5
26'-0"	32'-0"	6

OSC-A-6

6-1-12

**HBM**  
ENGINEERING GROUP, LLC  
4415 WEST HARRISON ST.  
SUITE 231  
HILLSIDE, IL 60162  
PHONE: (708) 236-0900  
FAX: (708) 236-0901

USER NAME =	DESIGNED - JMG	REVISED -
	CHECKED - JJS	REVISED -
PLOT SCALE =	DRAWN - AI	REVISED -
PLOT DATE = 3/12/2014	CHECKED - MAI	REVISED -

**STATE OF ILLINOIS  
DEPARTMENT OF TRANSPORTATION**

**CANTILEVER SIGN STRUCTURES - ALUMINUM WALKWAY  
DETAILS - ALUMINUM TRUSS & STEEL POST**

Sheet No. 6 of 9

F.A. RTE.	SECTION	COUNTY	TOTAL SHEETS	SHEET NO.
VAR.		ROCK ISLAND	45	26
• D-2 OVD SIN STR REPL 14-26			CONTRACT NO. 46287	
ILLINOIS FED. AID PROJECT				