

**LEGEND**

- ⊥ TYPE III BARRICADE WITH TWO (2) FLASHING LIGHTS
- ⊥ SIGN
- DRUMS WITH STEADY BURN MONODIRECTIONAL LIGHT
  - USE BI-DIRECTIONAL LIGHTING IN 2-LANE SECTIONS
- 50' C-C TANGENTS
- 25' C-C LANE SHIFTS & TAPERS
- 10' C-C RADII (TYP)
- FLASHING ARROW BOARD
- ▨ WORK AREA

WORK ZONE	W21-1115(O)
SPEED LIMIT	R2-1
PHOTO ENFORCED	R10-1108p
MINIMUM	RP2-1106

**BEGIN PROJECT**  
STA. 192 + 69.58

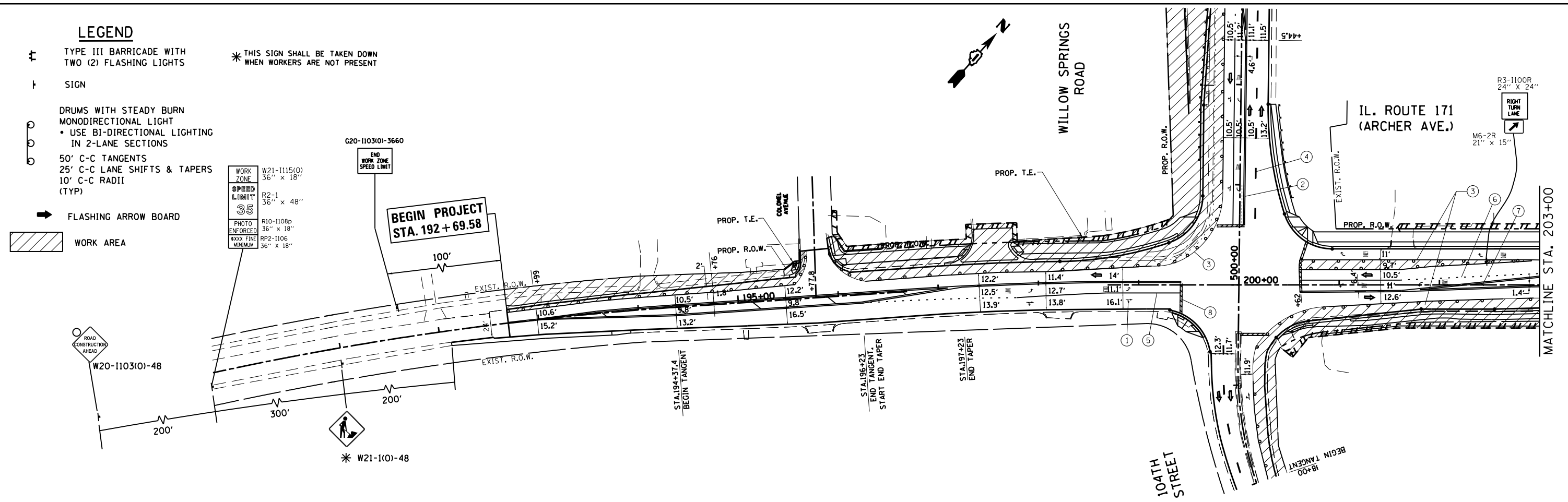

- PAVEMENT MARKING LEGEND**
- ① WET REFLECTIVE TEMPORARY TAPE TYPE III, LETTERS & SYMBOLS (WHITE) (TYP.)
  - ② WET REFLECTIVE TEMPORARY TAPE TYPE III, 4" (DOUBLE SOLID YELLOW) (TYP.)
  - ③ WET REFLECTIVE TEMPORARY TAPE TYPE III, 4" (SINGLE SOLID WHITE) (TYP.)
  - ④ WET REFLECTIVE TEMPORARY TAPE TYPE III, 4" (30' SKP, 10' DASH, WHITE) (TYP.)
  - ⑤ WET REFLECTIVE TEMPORARY TAPE TYPE III, 6" (SOLID, WHITE) (TYP.)
  - ⑥ WET REFLECTIVE TEMPORARY TAPE TYPE III, 6" (6' SKIP, 2' DASH, WHITE) (TYP.)
  - ⑦ WET REFLECTIVE TEMPORARY TAPE TYPE III, 12" (DIAGONAL, YELLOW) (TYP.)
  - ⑧ WET REFLECTIVE TEMPORARY TAPE TYPE III, 24" (STOP LINE, WHITE) (TYP.)

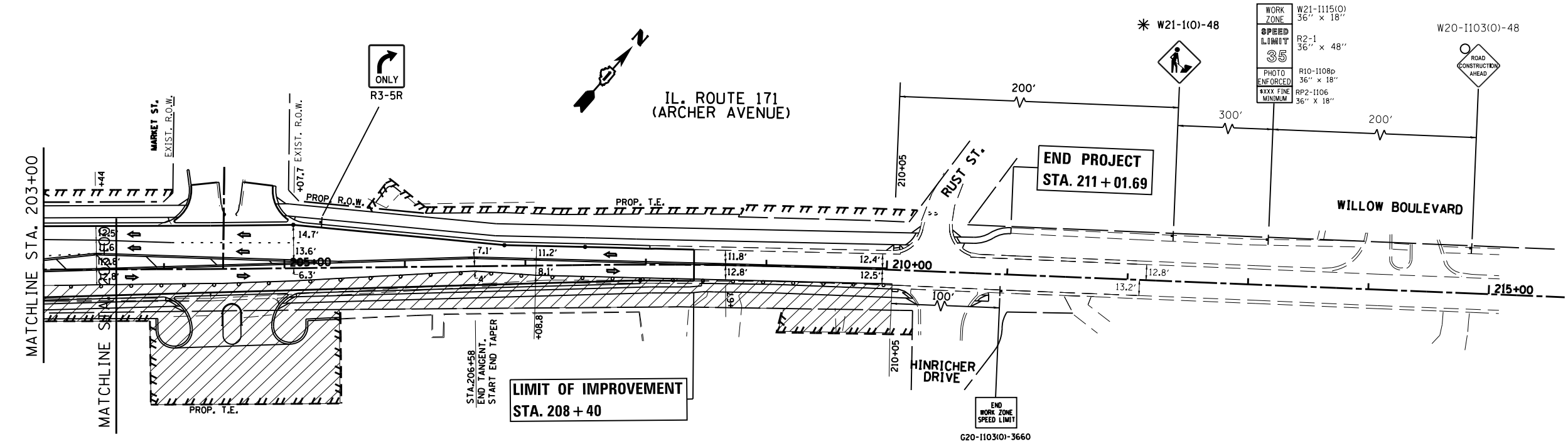

FILE NAME =	USER NAME = paraynoal	DESIGNED -	REVISED -	<b>STATE OF ILLINOIS DEPARTMENT OF TRANSPORTATION</b>	<b>SUGGESTED STAGING AND TRAFFIC CONTROL STAGE 2 IL. ROUTE 171 (ARCHER AVE.) AT 104th AVE.</b>	F.A.U. RTE.	SECTION	COUNTY	TOTAL SHEETS	SHEET NO.	
Default	PLOT DATE = 3/18/2014	DRAWN -	REVISED -			3565	B-N-5	COOK	129	37	
		CHECKED -	REVISED -			<b>CONTRACT NO. 60T24</b>					
		DATE -	REVISED -			ILLINOIS FED. AID PROJECT					