

F.A.P. RTE.	SECTION	COUNTY	TOTAL SHEETS	SHEET NO.
372	0303S-TS	COOK	87	1
		ILLINOIS	CONTRACT NO. 60X08	

STATE OF ILLINOIS
DEPARTMENT OF TRANSPORTATION
DIVISION OF HIGHWAYS

PROPOSED
HIGHWAY PLANS

F.A.P. RTE. 372 (IL RTE. 171)
 AT FOREST AVE./RIDGEWOOD RD.
 SECTION 0303S-TS
 PROJECT: *ACHSIP-0372 (011)*
 TRAFFIC SIGNAL MODERNIZATION
 AND CHANNELIZATION
 COOK COUNTY
 C-91-436-13

FOR INDEX OF SHEETS, SEE SHEET NO. 2

THIS PROJECT IS LOCATED IN THE VILLAGE OF RIVERSIDE

TRAFFIC DATA:

IL RTE. 171
 2013 ADT = 42,700
 SPEED LIMIT = 35 MPH

FOREST AVE./RIDGEWOOD RD.
 2010 ADT = 6,300
 SPEED LIMIT = 25 MPH

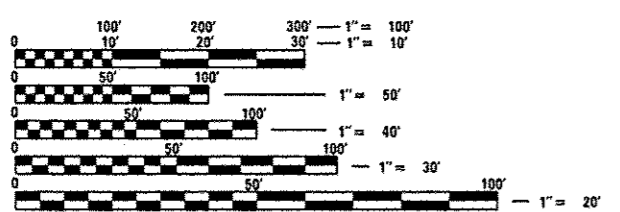

FULL SIZE PLANS HAVE BEEN PREPARED USING STANDARD ENGINEERING SCALES. REDUCED SIZED PLANS WILL NOT CONFORM TO STANDARD SCALES. IN MAKING MEASUREMENTS ON REDUCED PLANS, THE ABOVE SCALES MAY BE USED.

J.U.L.I.E.
 JOINT UTILITY LOCATION INFORMATION FOR EXCAVATION
 1-800-892-0123
 OR 811

PROJECT ENGINEER: DAN WILGREEN (847) 705-4240
 PROJECT MANAGER: KEN ENG (847) 705-4247

CONTRACT NO. 60X08

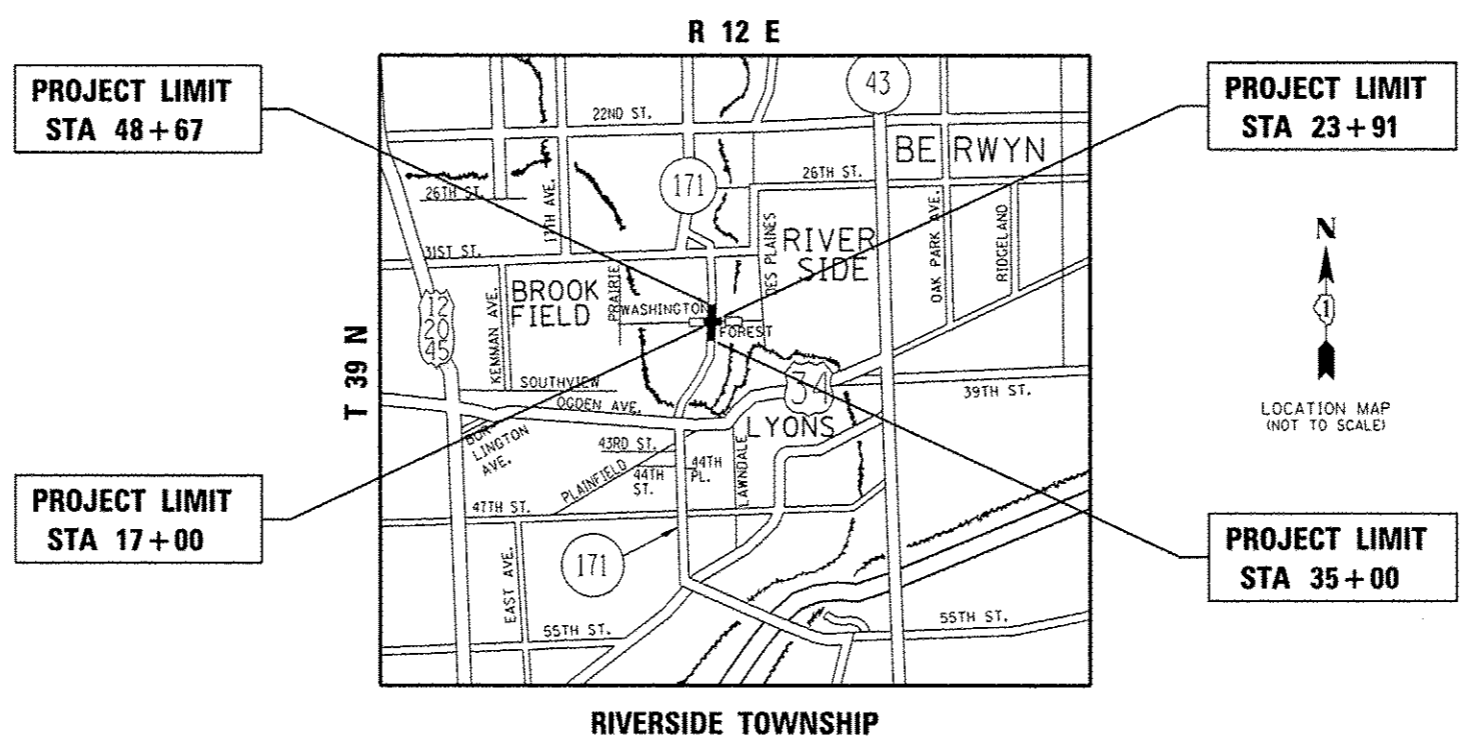
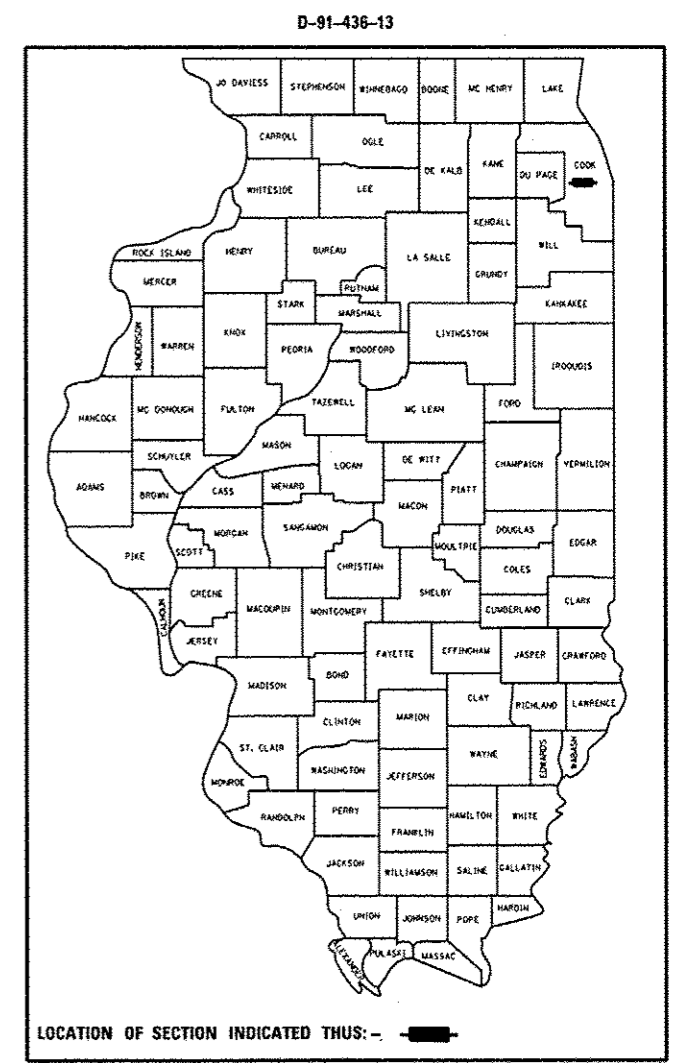

GROSS AND NET LENGTH = 2058 FT. = 0.390 MILE

STATE OF ILLINOIS
 DEPARTMENT OF TRANSPORTATION
 DIVISION OF HIGHWAYS

SUBMITTED *March 21* 20 *14*

John Forman Jr
 DEPUTY DIRECTOR OF HIGHWAYS, REGION ENGINEER

May 9 20 *14*
John D. Baranzelli PE, Inc
 ENGINEER OF DESIGN AND ENVIRONMENT

May 9 20 *14*
Orker Osman PE, Inc
 DIRECTOR OF HIGHWAYS, CHIEF ENGINEER

PRINTED BY THE AUTHORITY OF THE STATE OF ILLINOIS