

THE EXISTING SPAN WIRE TRAFFIC SIGNAL INSTALLATION SHALL REMAIN IN PLACE AND BE USED AS THE TEMPORARY TRAFFIC SIGNAL INSTALLATION FOR THIS CONTRACT.

NOTE:  
THE TRAFFIC SIGNAL CONTROLLER EQUIPMENT FOR THIS PROJECT SHALL BE "ECONOLITE" TO MATCH THE EXISTING ADJACENT SYSTEM.

THE CONTRACTOR SHALL REMOVE AND DISPOSE THE EXISTING SPAN WIRE TRAFFIC SIGNAL INSTALLATION OUTSIDE THE RIGHT OF WAY AFTER THE PROPOSED TRAFFIC SIGNAL TURN ON. THIS WORK WILL BE PAID UNDER THE PAY ITEM REMOVE EXISTING TRAFFIC SIGNAL EQUIPMENT. THE FOLLOWING ITEMS WILL BE RETURNED TO THE ILLINOIS DEPARTMENT OF TRANSPORTATION:

- 1 EACH CONTROLLER AND CABINET (COMPLETE)
- 1 EACH UNINTERRUPTIBLE POWER SUPPLY
- 12 EACH TRAFFIC SIGNAL HEAD
- 8 EACH PEDESTRIAN SIGNAL HEAD
- 8 EACH PEDESTRIAN PUSH-BUTTON
- 1 EACH VIDEO DETECTION (COMPLETE)
- 1 EACH WIRELESS INTERCONNECT COMPLETE

THE FOLLOWING EXISTING TRAFFIC SIGNAL EQUIPMENT SHALL BE RELOCATED TO THE NEW MAST ARMS AND TRAFFIC SIGNAL CONTROLLER CABINET WHEN IT IS LONGER NEEDED FOR THE TEMPORARY TRAFFIC SIGNAL INSTALLATION:

- 2 EACH CONFIRMATION BEACON
- 2 EACH LIGHT DETECTOR
- 1 EACH LIGHT DETECTOR AMPLIFIER

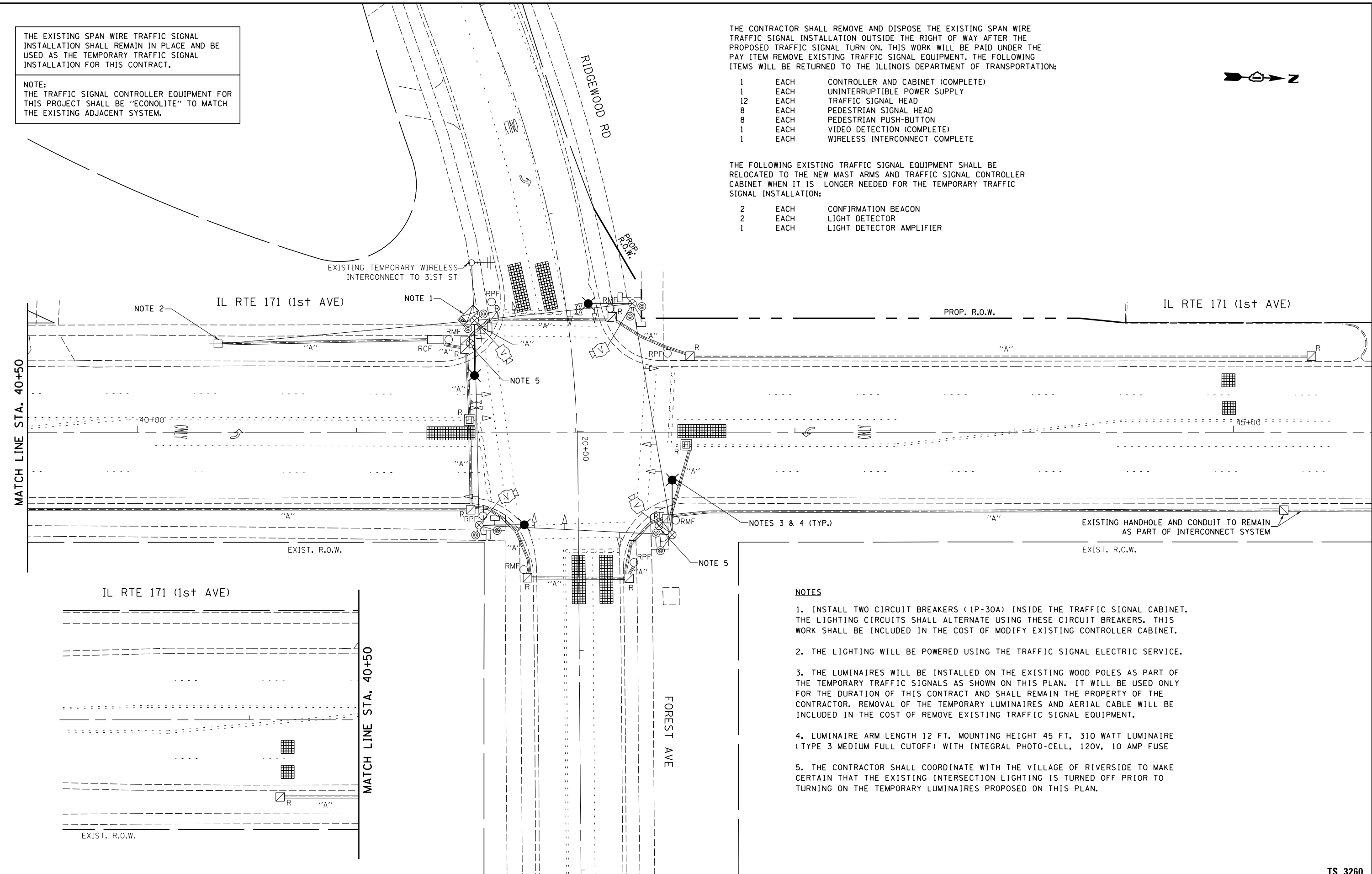

**NOTES**

1. INSTALL TWO CIRCUIT BREAKERS (1P-30A) INSIDE THE TRAFFIC SIGNAL CABINET. THE LIGHTING CIRCUITS SHALL ALTERNATE USING THESE CIRCUIT BREAKERS. THIS WORK SHALL BE INCLUDED IN THE COST OF MODIFY EXISTING CONTROLLER CABINET.
2. THE LIGHTING WILL BE POWERED USING THE TRAFFIC SIGNAL ELECTRIC SERVICE.
3. THE LUMINAIRES WILL BE INSTALLED ON THE EXISTING WOOD POLES AS PART OF THE TEMPORARY TRAFFIC SIGNALS AS SHOWN ON THIS PLAN. IT WILL BE USED ONLY FOR THE DURATION OF THIS CONTRACT AND SHALL REMAIN THE PROPERTY OF THE CONTRACTOR. REMOVAL OF THE TEMPORARY LUMINAIRES AND AERIAL CABLE WILL BE INCLUDED IN THE COST OF REMOVE EXISTING TRAFFIC SIGNAL EQUIPMENT.
4. LUMINAIRE ARM LENGTH 12 FT, MOUNTING HEIGHT 45 FT, 310 WATT LUMINAIRE (TYPE 3 MEDIUM FULL CUTOFF) WITH INTEGRAL PHOTO-CELL, 120V, 10 AMP FUSE
5. THE CONTRACTOR SHALL COORDINATE WITH THE VILLAGE OF RIVERSIDE TO MAKE CERTAIN THAT THE EXISTING INTERSECTION LIGHTING IS TURNED OFF PRIOR TO TURNING ON THE TEMPORARY LUMINAIRES PROPOSED ON THIS PLAN.

FILE NAME =	USER NAME = plascencia	DESIGNED - IP	REVISED -	<b>STATE OF ILLINOIS DEPARTMENT OF TRANSPORTATION</b>	<b>TEMPORARY TRAFFIC SIGNAL AND REMOVE EXISTING TRAFFIC SIGNAL EQUIPMENT PLAN IL RTE 171 (1ST AVE) AND FOREST AVE / RIDGEWOOD RD</b>	F.A.P. RTE.	SECTION	COUNTY	TOTAL SHEETS	SHEET NO.	
Default	et:\pw\work\p\idot\plascencia\14412-TS.dgn	DRAWN - IP	REVISED -			372	03035-TS	COOK	87	50	
	PLOT SCALE = 40.0000' / in.	CHECKED - LP	REVISED -			<b>CONTRACT NO. 60X08</b>					
	PLOT DATE = 3/28/2014	DATE - 3/15/14	REVISED -			ILLINOIS FED. AID PROJECT					