

INDEX OF SHEETS

1. COVER SHEET
2. GENERAL NOTES, SUMMARY OF QUANTITIES AND SIGNATURE BLOCK
3. SCHEDULES AND TYPICAL SECTIONS
4. - 5. LOCATION MAPS
6. DETAILS

STANDARDS

000001-06	STANDARD SYMBOLS, ABBREVIATIONS AND PATTERNS
001006	DECIMAL OF AN INCH AND OF A FOOT
701306-03	LANE CLOSURE, 2L, 2W, SLOW MOVING OPERATIONS DAY ONLY, FOR SPEEDS ≥45 MPH
701901-03	TRAFFIC CONTROL DEVICES
780001-04	TYPICAL PAVEMENT MARKINGS
781001-03	TYPICAL APPLICATIONS RAISED REFLECTIVE PAVEMENT MARKINGS

STATE OF ILLINOIS
DEPARTMENT OF TRANSPORTATION
DIVISION OF HIGHWAYS
PROPOSED
HIGHWAY PLANS

FAP 573 (US 30) & FAP 587 (US 34)
SECTION (19,20)RS-5&I-1 / (116)RS-4&I-1
PROJECT: ALHSIP-000S(989)
HIGH FRICTION SURFACE TREATMENT
DEKALB & LASALLE COUNTIES

C-93-114-14

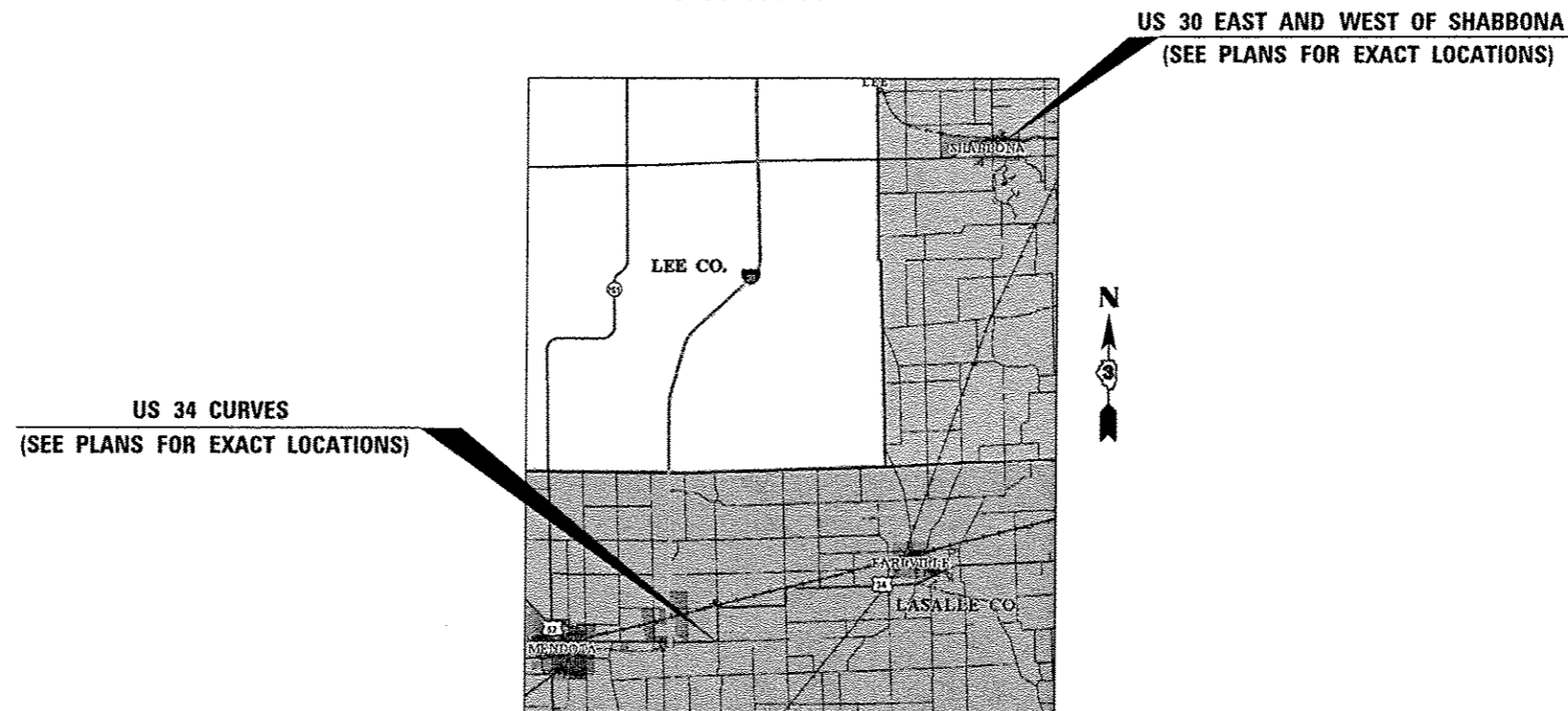

FULL SIZE PLANS HAVE BEEN PREPARED USING STANDARD ENGINEERING SCALES. REDUCED SIZED PLANS WILL NOT CONFORM TO STANDARD SCALES. IN MAKING MEASUREMENTS ON REDUCED PLANS, THE ABOVE SCALES MAY BE USED.

J.U.L.I.E.
 JOINT UTILITY LOCATION INFORMATION FOR EXCAVATION
 1-800-892-0123
 OR 811

DISTRICT 3 NO. (815) 434-6131
 PROJECT ENGINEER: JOE KANNEL, P.E.
 UNIT CHIEF: SCOTT A. FERGUSON

CONTRACT NO. 66D85

F.A.I. RTE.	SECTION	COUNTY	TOTAL SHEETS	SHEET NO.
*	**	***	6	1
ILLINOIS			CONTRACT NO. 66D85	

* FAP 573 (US 30) & FAP 587 (US 34)
 ** SECTION (19,20)RS-5&I-1 / (116)RS-4&I-1
 *** DEKALB & LASALLE

D-93-062-14

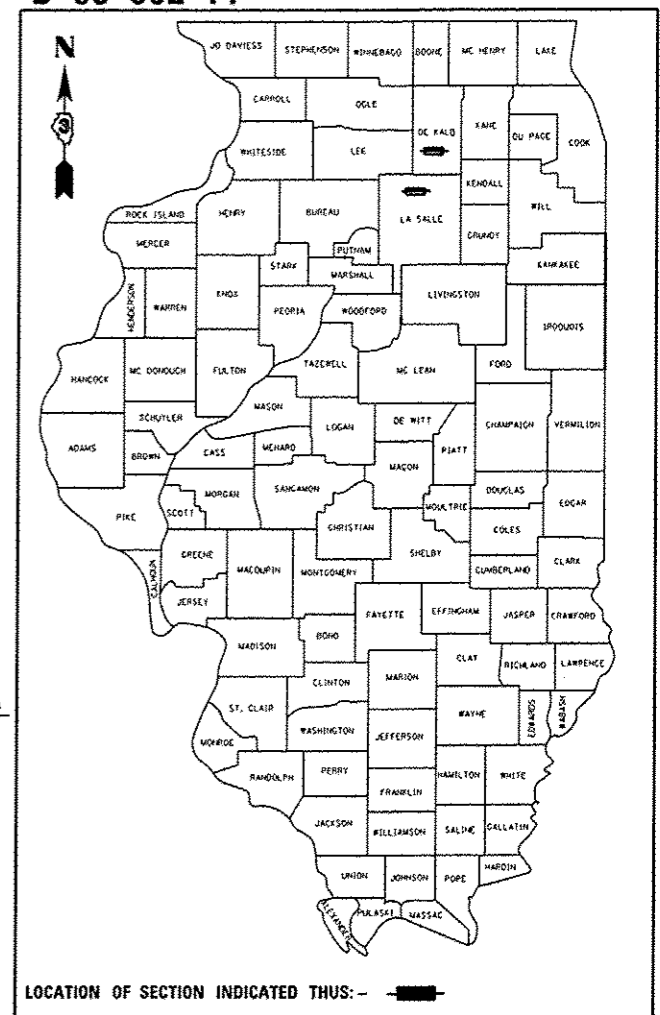

FUNCTIONAL CLASSIFICATION
US 30 - MINOR ARTERIAL
 2014 ADT = 2150
 P.V. = 1854 S.U. = 124 M.U. = 172
US 34 - MINOR ARTERIAL
 2014 ADT = 3800
 P.V. = 2785 S.U. = 215 M.U. = 800

STATE OF ILLINOIS
 DEPARTMENT OF TRANSPORTATION
 DIVISION OF HIGHWAYS

SUBMITTED Mar 28 20 14
Paul Coetzee, P.E.
 DEPUTY DIRECTOR OF HIGHWAYS, REGION ENGINEER

May 9 20 14
John D. Baranick, P.E.
 ENGINEER OF DESIGN AND ENVIRONMENT

May 9 20 14
Osman Osman, P.E.
 DIRECTOR OF HIGHWAYS, CHIEF ENGINEER

PRINTED BY THE AUTHORITY
OF THE STATE OF ILLINOIS

GENERAL NOTES

PLAN DIMENSIONS RELATIVE TO THE EXISTING ROADWAY HAVE BEEN TAKEN FROM EXISTING PLANS AND ARE SUBJECT TO NOMINAL CONSTRUCTION VARIATIONS. IT SHALL BE THE CONTRACTOR'S RESPONSIBILITY TO MAKE NECESSARY ADJUSTMENTS PRIOR TO CONSTRUCTION OR ORDERING OF MATERIALS. SUCH VARIATIONS SHALL NOT BE CAUSE FOR ADDITIONAL COMPENSATION FOR A CHANGE IN THE SCOPE OF THE WORK. HOWEVER, THE CONTRACTOR WILL BE PAID FOR THE QUANTITY FURNISHED AT THE UNIT PRICE BID FOR THE WORK.

ANY REFERENCE TO A STANDARD IN THESE PLANS SHALL BE INTERPRETED TO MEAN THE EDITION AS INDICATED BY THE SUBNUMBER SHOWN IN THE LIST OF STANDARDS OR THE COPY INCLUDED IN THESE PLANS.

THE CONTRACTOR SHALL CONTACT JULIE AT LEAST 48 HOURS PRIOR TO EXCAVATION TO DETERMINE WHICH UTILITIES ARE IN THE AREA.

ALL EXCAVATED MATERIAL, WHICH INCLUDES DIGGING OR GRADING OF ANY SOIL OR FILL MATERIAL, WITH THE EXCEPTION OF AGGREGATE FILLS, MUST BE LEFT ON, OR INCORPORATED WITHIN, THE IDOT RIGHT OF WAY DUE TO ENVIRONMENTAL DOCUMENTATION REQUIREMENTS.

EXCAVATED MATERIALS SHALL BE DISPOSED OF AT LOCATIONS DIRECTED BY THE ENGINEER. ANY SUCH DISPOSAL SHALL NOT CREATE AND UNSIGHTLY OR OBJECTIONABLE APPEARANCE OR DETRACT FROM THE NATURAL TOPOGRAPHIC FEATURES WITHOUT WRITTEN PERMISSION FROM THE ENGINEER.

THE FOLLOWING RATES OF APPLICATION HAVE BEEN USED IN CALCULATING PLAN QUANTITIES:

GRANULAR MATERIALS	2.05	TONS / CU YD
MIX FOR CRACKS, JTS, & FLGWYS	0.0003	TONS / SQ YD
SHORT-TERM PAVEMENT MARKING	4	FT / 40 FT OF APPLICATION

US 30 US 34

CODE NO.	ITEM	UNIT	TOTAL	CONSTR. CODE	
				DEKALB	LASALLE
				FED / STATE 90% / 10%	FED / STATE 90% / 10%
				ROADWAY 0021 RURAL	ROADWAY 0021 RURAL
40600400	MIXTURE FOR CRACKS, JOINTS, AND FLANGEWAYS	TON	5.2	2.2	3.0
67100100	MOBILIZATION	L SUM	1	0.5	0.5
70100460	TRAFFIC CONTROL AND PROTECTION, STANDARD 701306	L SUM	1	0.5	0.5
70300100	SHORT TERM PAVEMENT MARKING	FOOT	650	272	378
70301000	WORK ZONE PAVEMENT MARKING REMOVAL	SQ FT	182	91	91
* 78100100	RAISED REFLECTIVE PAVEMENT MARKER	EACH	81	34	47
78300100	PAVEMENT MARKING REMOVAL	SQ FT	8666	3628	5038
78300200	RAISED REFLECTIVE PAVEMENT MARKER REMOVAL	EACH	81	34	47
X0327693	HIGH FRICTION SURFACE TREATMENT	SQ YD	17346	7270	10076
* 78009004	MODIFIED URETHANE PAVEMENT MARKING - LINE 4"	FOOT	25997	10884	15113
Z0030850	TEMPORARY INFORMATION SIGNING	SQ FT	42	21	21

*Specialty Item

DATE: 3-28-14

PREPARED BY: Don Benoit
DISTRICT STUDIES & PLANS ENGINEER

EXAMINED BY: Harold Jany (unclear)
DISTRICT CONSTRUCTION ENGINEER

[Signature]
DISTRICT MATERIALS ENGINEER

[Signature]
DISTRICT OPERATIONS ENGINEER

FAP 573 (US 30) & FAP 587 (US 34)
SECTION (19.20RS-581-1 / 116RS-481-1)
DEKALB & LASALLE

FILE NAME: c:\pwork\pmdot\ferguson\0337253\0337253.dgn	USER NAME: ferguson	DESIGNED: DBS	REVISED: -	STATE OF ILLINOIS DEPARTMENT OF TRANSPORTATION	GENERAL NOTES AND SUMMARY OF QUANTITIES	F.A.I. RATE: *	SECTION: **	COUNTY: ***	TOTAL SHEETS: 6	SHEET NO.: 2		
PLLOT SCALE: 100.0000 / in.	CHECKED: -	REVISED: -	REVISED: -			SCALE: SHEET 1 OF 1 SHEETS	STA. TO STA.	ILLINOIS FED. AID PROJECT				
PLLOT DATE: 3/28/2014	DATE: FEBRUARY 2013	REVISED: -	REVISED: -			CONTRACT NO. 66085						

MAINLINE SCHEDULE

			PVMT WIDTH	PVMT AREA	PVMT MARKING REMOVAL	RRPM REMOVAL	HIGH FRICTION SURFACE TREATMENT	SHORT-TERM PAVEMENT MARKING	WORK ZONE PVMT MARK. REMOVAL	RRPM	URETHANE PAVT MARK. 4" WHITE	URETHANE PAVT MARK. 4" YELLOW	MIX FOR CRACKS, JTS FLGWYS
US 30	DEKALB COUNTY	LENGTH	FOOT	SQ YD	SQ FT	EACH	SQ YD	FOOT	SQ FT	EACH	FOOT	FOOT	TON
START PROJECT	STA 1494+94.60 PC OF CURVE TO STA 1501+28.41	633.8	24	1690.2	845	8	1690	63	21	8	1268	1268	0.5
CURVE WEST OF	STA 1501+28.41 TO STA 1503+82.06 PT OF CURVE	253.7	34	958.2	338	3	958	25	8	3	507	507	0.3
SHABBONA	STA 1503+82.06 TO STA 1504+71.95 PRESERVE RD	89.9	36	359.6	120	1	360	9	3	1	180	180	0.1
CURVES EAST OF	STA 362+07.18 PC CURVE TO STA 373+32.18 PT CURVE	1047.2	22	2559.8	1396	13	2560	105	35	13	2094	2094	0.8
SHABBONA	STA EQN 372+54.39 BK = 373+32.18 AH												
	STA 376+83.66 PC CURVE TO STA 383+80 UNIVERSITY RD	696.3	22	1702.2	928	9	1702	70	23	9	1393	1393	0.5
DEKALB TOTAL					3628	34	7270	272	91	34	5442	5442	2
US 34	LASALLE COUNTY												
	STA 214+30.07 PC CURVE 1 TO STA 222+27.10 PT CURVE 1	797.0	24	2125.4	1063	10	2125	80	27	10	1594	1594	0.6
	STA 265+03.67 PC CURVE 2 TO STA 273+07.83 PT CURVE 2	804.2	24	2144.4	1072	10	2144	80	27	10	1608	1608	0.6
END PROJECT	STA 358+54.11 PC CURVE 3 TO STA 366+52.27 PT CURVE 3	798.2	24	2128.4	1064	10	2128	80	27	10	1596	1596	0.6
	STA 380+84.54 PC CURVE 4 TO STA 394+64.41 PT CURVE 4	1379.0	24	3677.3	1839	17	3677	138	46	17	2758	2758	1.1
LASALLE TOTAL					5038	47	10076	378	126	47	7557	7557	3
GRAND TOTAL		6499.3			8666	81	17346	650	217	81	12999	12999	5

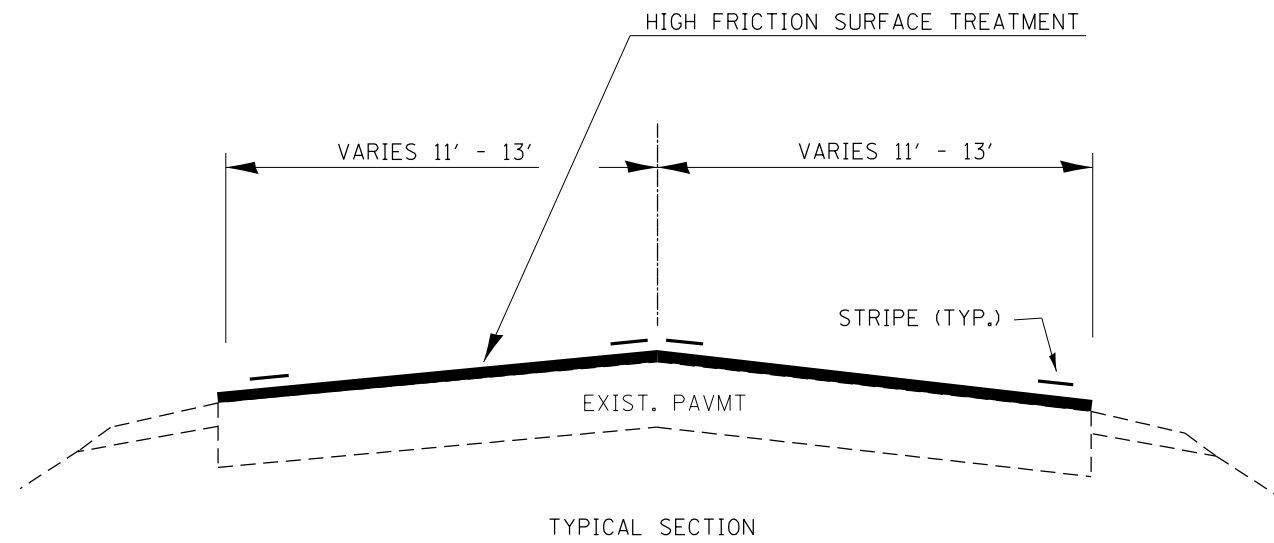

* FAP 573 (US 30) & FAP 587 (US 34)
 ** SECTION (19,20RS-5&I-1 / (116RS-4&I-1)
 *** DEKALB & LASALLE

FILE NAME =	USER NAME = fergusonse	DESIGNED - DBS	REVISED - _____
et:\pw\work\p\dot\fergusonse\d0337253\0xxxxx-sht-cover.dgn		DRAWN - DBS	REVISED - _____
	PLOT SCALE = 100.0000' / 1in.	CHECKED - _____	REVISED - _____
	PLOT DATE = 3/28/2014	DATE - FEBRUARY 2013	REVISED - _____

STATE OF ILLINOIS
 DEPARTMENT OF TRANSPORTATION

SCHEDULES AND TYPICAL SECTION

SCALE: SHEET 1 OF 1 SHEETS STA. TO STA.

F.A.I. RTE.	SECTION	COUNTY	TOTAL SHEETS	SHEET NO.
*	**	***	6	3
*			CONTRACT NO. 66D85	
ILLINOIS FED. AID PROJECT				

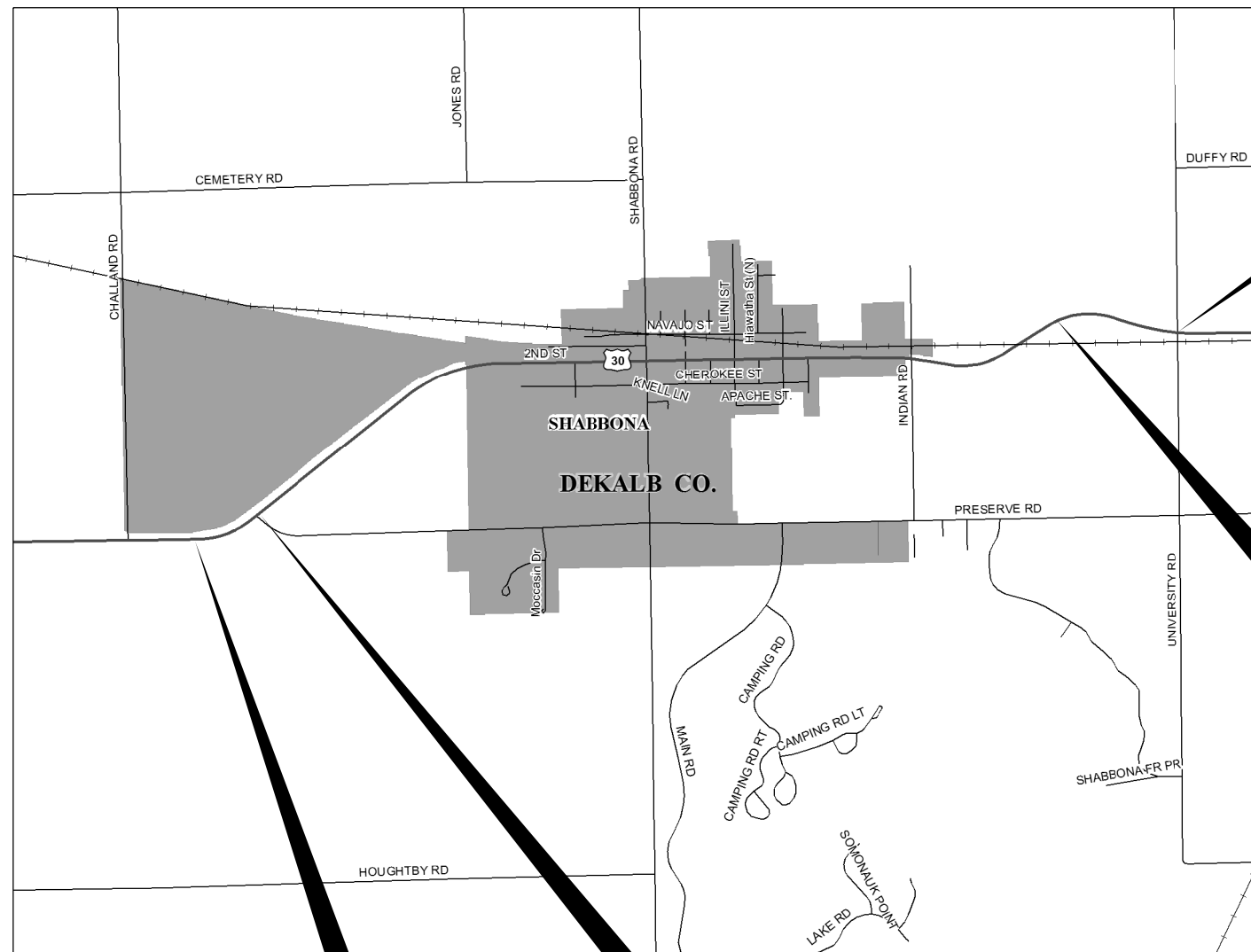

END OF EAST CURVE UNIVERSITY RD

START OF EAST CURVE

END OF WEST CURVE PRESERVE RD

START OF WEST CURVE

FILE NAME =	USER NAME = fergusonse	DESIGNED - DBS	REVISED - _____
et:\pw\work\p1dot\fergusonse\d0337253\0xxxxx-sht-cover.dgn		DRAWN - DBS	REVISED - _____
	PLOT SCALE = 100.0000' / in.	CHECKED - _____	REVISED - _____
	PLOT DATE = 3/28/2014	DATE - FEBRUARY 2013	REVISED - _____

STATE OF ILLINOIS
DEPARTMENT OF TRANSPORTATION

LOCATION MAP US 30 CURVES

SCALE: SHEET 1 OF 1 SHEETS STA. TO STA.

* FAP 573 (US 30) & FAP 587 (US 34)
** SECTION (19,20)RS-5&I-1 / (16)RS-4&I-1
*** DEKALB & LASALLE

F.A.I. RTE.	SECTION	COUNTY	TOTAL SHEETS	SHEET NO.
*	**	***	6	4
				CONTRACT NO. 66D85
ILLINOIS FED. AID PROJECT				

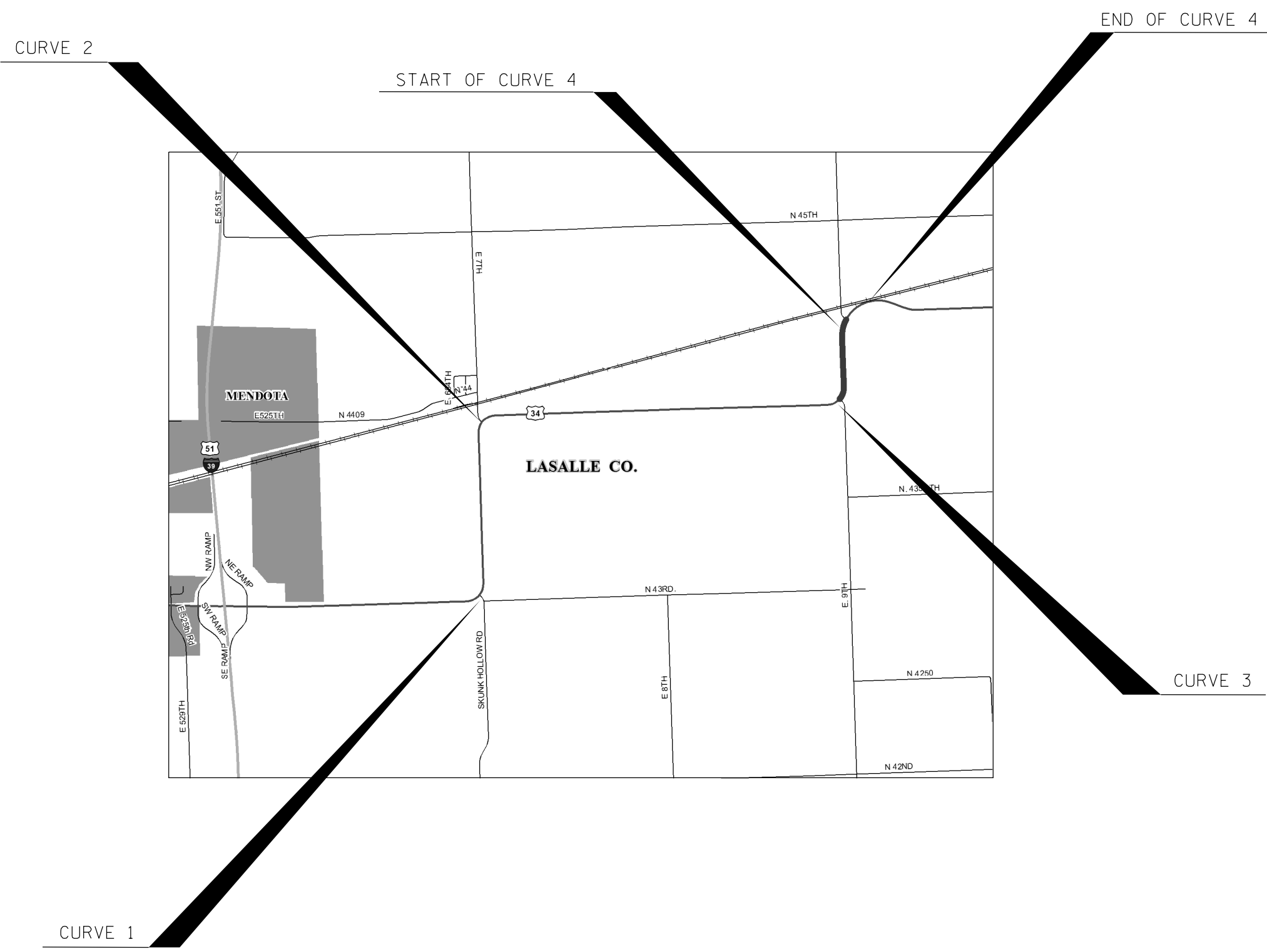

FILE NAME =	USER NAME = fergusonse	DESIGNED - DBS	REVISED - _____
et:\pwork\pwork\fergusonse\d0337253\0xxxxx-sht-cover.dgn		DRAWN - DBS	REVISED - _____
	PLOT SCALE = 100.0000' / in.	CHECKED - _____	REVISED - _____
	PLOT DATE = 3/28/2014	DATE - FEBRUARY 2013	REVISED - _____

**STATE OF ILLINOIS
DEPARTMENT OF TRANSPORTATION**

LOCATION MAP US 34 CURVES

SCALE: SHEET 1 OF 1 SHEETS STA. TO STA.

* FAP 573 (US 30) & FAP 587 (US 34)
 ** SECTION (19,20)RS-5&I-1 / (116)RS-4&I-1
 *** DEKALB & LASALLE

F.A.I. RTE.	SECTION	COUNTY	TOTAL SHEETS	SHEET NO.
*	*	***	6	5
			CONTRACT NO. 66D85	
ILLINOIS FED. AID PROJECT				

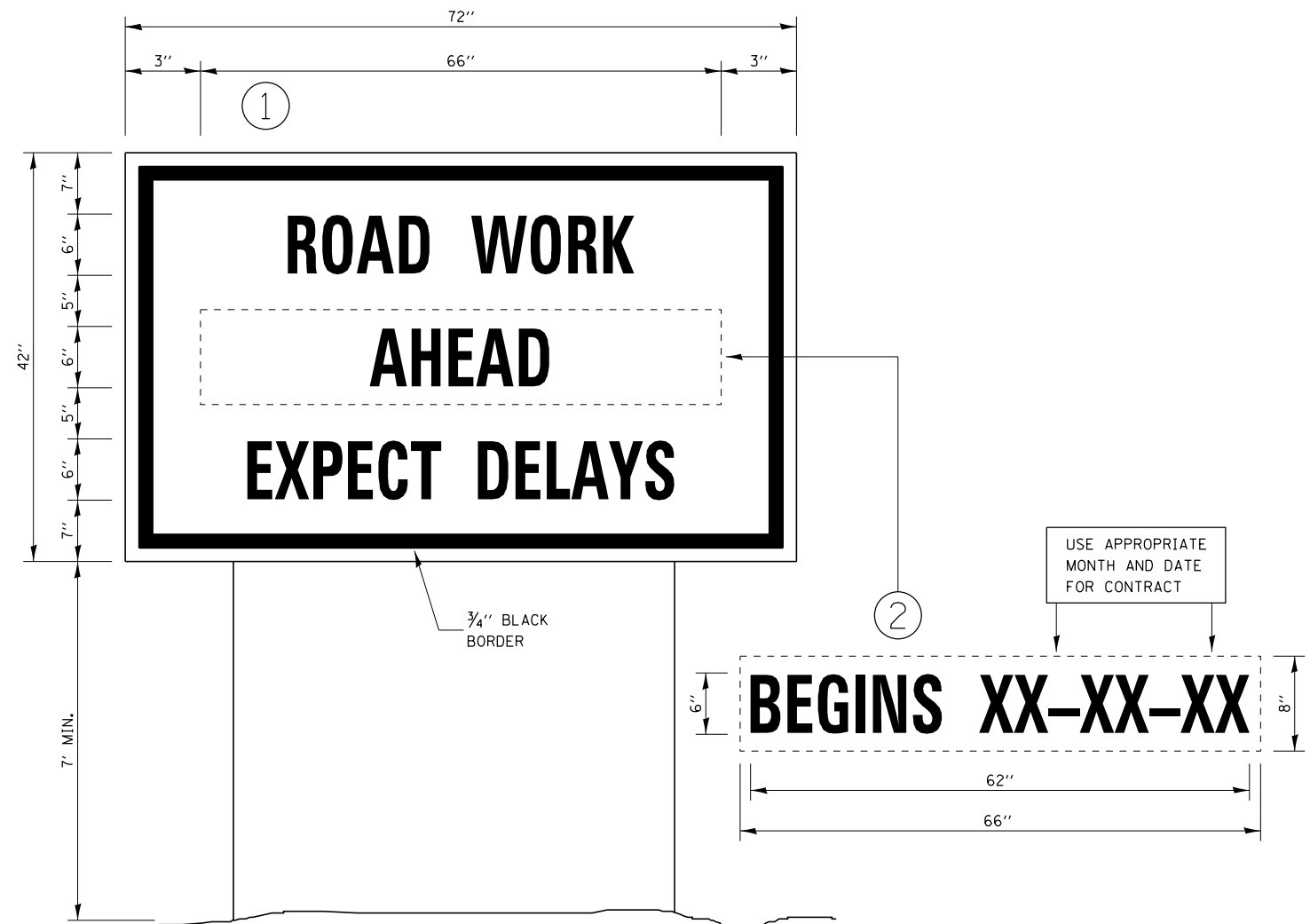
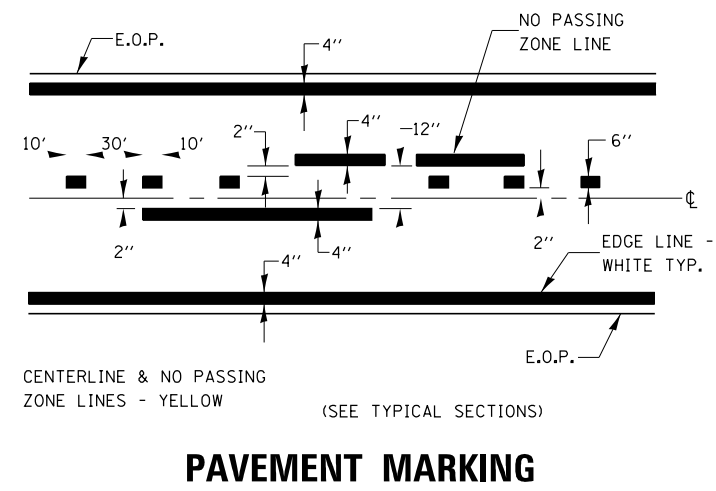

NOTES:

1. USE 6" D BLACK LETTERING ON FLOURESENT ORANGE BACKGROUND.
2. ERECT SIGNS AT LOCATIONS IN ADVANCE OF THE "ROAD CONSTRUCTION AHEAD" SIGNS AS DIRECTED BY THE ENGINEER.
3. ERECT SIGN ① WITH INSTALLED PANEL ② A MINIMUM OF ONE WEEK PRIOR TO THE START OF THE LANE CLOSURE.
4. REMOVE PANEL ② ON THAT DATE.
5. SEE SPECIAL PROVISION "TEMPORARY INFORMATION SIGNING" FOR ADDITIONAL INFORMATION.
6. WILL BE PAID FOR PER SQ FT AS "TEMPORARY INFORMATION SIGNING". EACH SIGN = 21 SQ FT AND THE DATE PANEL ② WILL NOT BE MEASURED SEPARATELY FOR PAYMENT.

* FAP 573 (US 30) & FAP 587 (US 34)
 ** SECTION (19,20)RS-5&I-1 / (16)RS-4&I-1
 *** DEKALB & LASALLE

FILE NAME =	USER NAME = fergusonse	DESIGNED - _____	REVISED - _____	STATE OF ILLINOIS DEPARTMENT OF TRANSPORTATION	DETAILS	F.A.P. RTE.	SECTION	COUNTY	TOTAL SHEETS	SHEET NO.	
ci:\pw\work\p\idot\fergusonse\d0337253\0xxxxx-sht-cover.dgn	PLOT SCALE = 100.0000' / 1in.	DRAWN - _____	REVISED - _____			*	*	***	6	6	
\$MODELNAME\$	PLOT DATE = 3/28/2014	CHECKED - _____	REVISED - _____			CONTRACT NO. 66D85					
						ILLINOIS FED. AID PROJECT					