

INDEX OF SHEETS

- 1 COVER SHEET
- 2 GENERAL NOTES
- 3-5 SUMMARY OF QUANTITIES
- 6-8 TYPICAL SECTIONS
- 9-10 SCHEDULES
- 11-14 PROJECT LAYOUT MAPS
- 15-21 DETECTOR LOOP INFORMATION
- 22-24 DETAILS

LIST OF ILLINOIS DOT HIGHWAY STANDARDS

- 000001-06 STANDARD SYMBOLS, ABBREVIATIONS AND PATTERNS
- 001006 DECIMAL OF AN INCH AND OF A FOOT
- 424001-07 PERPENDICULAR CURB RAMPS FOR SIDEWALKS
- 424008-01 DIAGONAL CURB RAMPS FOR SIDEWALKS
- 424011-01 CORNER PARALLEL CURB RAMPS FOR SIDEWALKS
- 424016-01 MID-BLOCK CURB RAMPS FOR SIDEWALKS
- 424021-02 DEPRESSED CORNER FOR SIDEWALKS
- 701101-04 OFF-ROAD OPERATIONS MULTILANE, 15' (4.5 m) TO 24" (600 mm) FROM PAVEMENT EDGE
- 701301-04 LANE CLOSURE, 2L, 2W, SHORT TIME OPERATIONS
- 701308-03 LANE CLOSURE, 2L, 2W, SLOW MOVING OPERATIONS DAY ONLY, FOR SPEEDS ≥ 45 MPH
- 701311-03 LANE CLOSURE, 2L, 2W, MOVING OPERATIONS - DAY ONLY
- 701427-02 LANE CLOSURE, MULTILANE INTERMITTENT OR MOVING OPERATION, FOR SPEEDS ≤ 40 MPH
- 701501-08 URBAN LANE CLOSURE, 2L, 2W, UNDIVIDED
- 701602-07 URBAN LANE CLOSURE, MULTILANE, 2W WITH BIDIRECTIONAL LEFT TURN LANE
- 701606-09 URBAN LANE CLOSURE, MULTILANE, 2W WITH MOUNTABLE MEDIAN
- 701701-09 URBAN LANE CLOSURE, MULTILANE INTERSECTION
- 701801-05 LANE CLOSURE, MULTILANE 1W OR 2W CROSSWALK OR SIDEWALK CLOSURE
- 701901-03 TRAFFIC CONTROL DEVICES
- 780001-04 TYPICAL PAVEMENT MARKINGS
- 886001-01 DETECTOR LOOP INSTALLATIONS
- 886006-01 TYPICAL LAYOUT FOR DETECTION LOOPS

STATE OF ILLINOIS  
DEPARTMENT OF TRANSPORTATION  
DIVISION OF HIGHWAYS  
**PROPOSED  
HIGHWAY PLANS**

VARIOUS ROUTES  
*INTMT* SPRING RD REPAIR 2014-6  
PROJECT  
INTERMITTENT ROAD REPAIRS  
KANKAKEE COUNTY

C-93-120-14

- LOCATION 1 - US 45/52 FROM ARMOUR RD TO INDIAN OAKS RD
- LOCATION 2 - IL 50 FROM 0.4 MILES SOUTH OF I-57 IN BRADLEY TO GRINNELL RD IN KANKAKEE
- LOCATION 3 - US 45/52 FROM WILL COUNTY LINE TO MANTENO RD
- LOCATION 4 - IL 114 FROM IL 1/17 TO INDIANA STATE LINE
- LOCATION 5 - IL 17 FROM HERSCHER RD TO 150' WEST OF NORFOLK SOUTHERN RR

F.A.P. RTE.	SECTION	COUNTY	TOTAL SHEETS	SHEET NO.
VAR	*	KANKAKEE	24	1
		ILLINOIS	CONTRACT NO. 66D91	

• INTERMITTENT SPRING ROAD REPAIR 2014-6

D-93-069-14

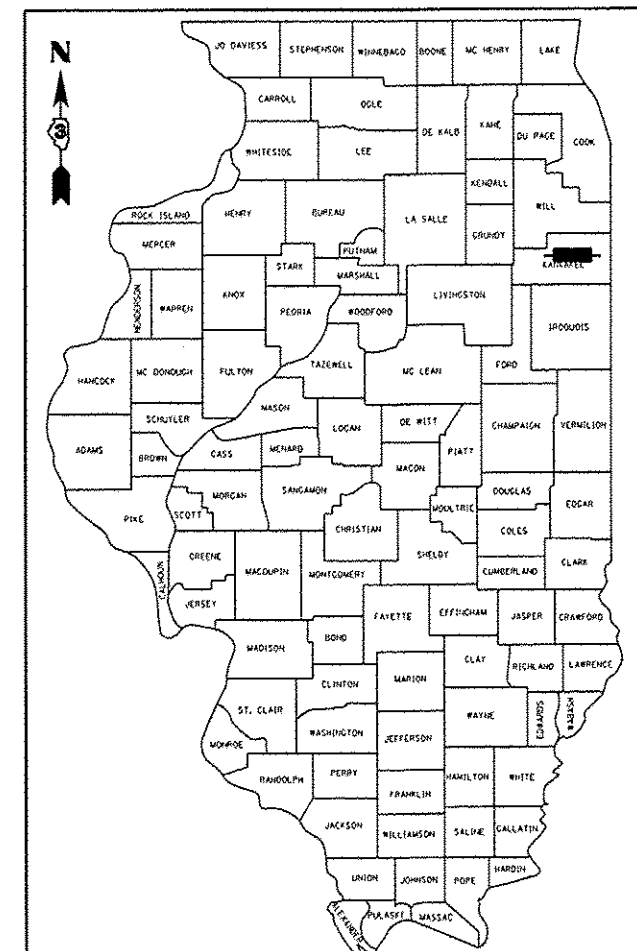

LOCATION OF SECTION INDICATED THUS: - [black rectangle] -

SEE PAGE 2 FOR ADT AND FUNCTIONAL CLASSIFICATION

LOCATION 4  
IL 114

STATE OF ILLINOIS  
DEPARTMENT OF TRANSPORTATION  
DIVISION OF HIGHWAYS

SUBMITTED April 11 20 14

Paul Leste  
DEPUTY DIRECTOR OF HIGHWAYS, REGION ENGINEER

May 9 20 14  
John D. Baranzelli, PE  
ENGINEER OF DESIGN AND ENVIRONMENT

May 9 20 14  
Omer Osman, PE  
DIRECTOR OF HIGHWAYS, CHIEF ENGINEER

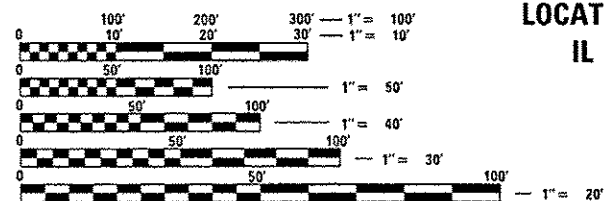

FULL SIZE PLANS HAVE BEEN PREPARED USING STANDARD ENGINEERING SCALES. REDUCED SIZED PLANS WILL NOT CONFORM TO STANDARD SCALES. IN MAKING MEASUREMENTS ON REDUCED PLANS, THE ABOVE SCALES MAY BE USED.

J.U.L.I.E.  
JOINT UTILITY LOCATION INFORMATION FOR EXCAVATION  
1-800-892-0123  
OR 811

PROJECT ENGINEER: JOE KANNEL, PE  
UNIT CHIEF: MICHELE LINDEMANN, PE  
DISTRICT 3 NO. (815) 434-6131  
CONTRACT NO. 66D91

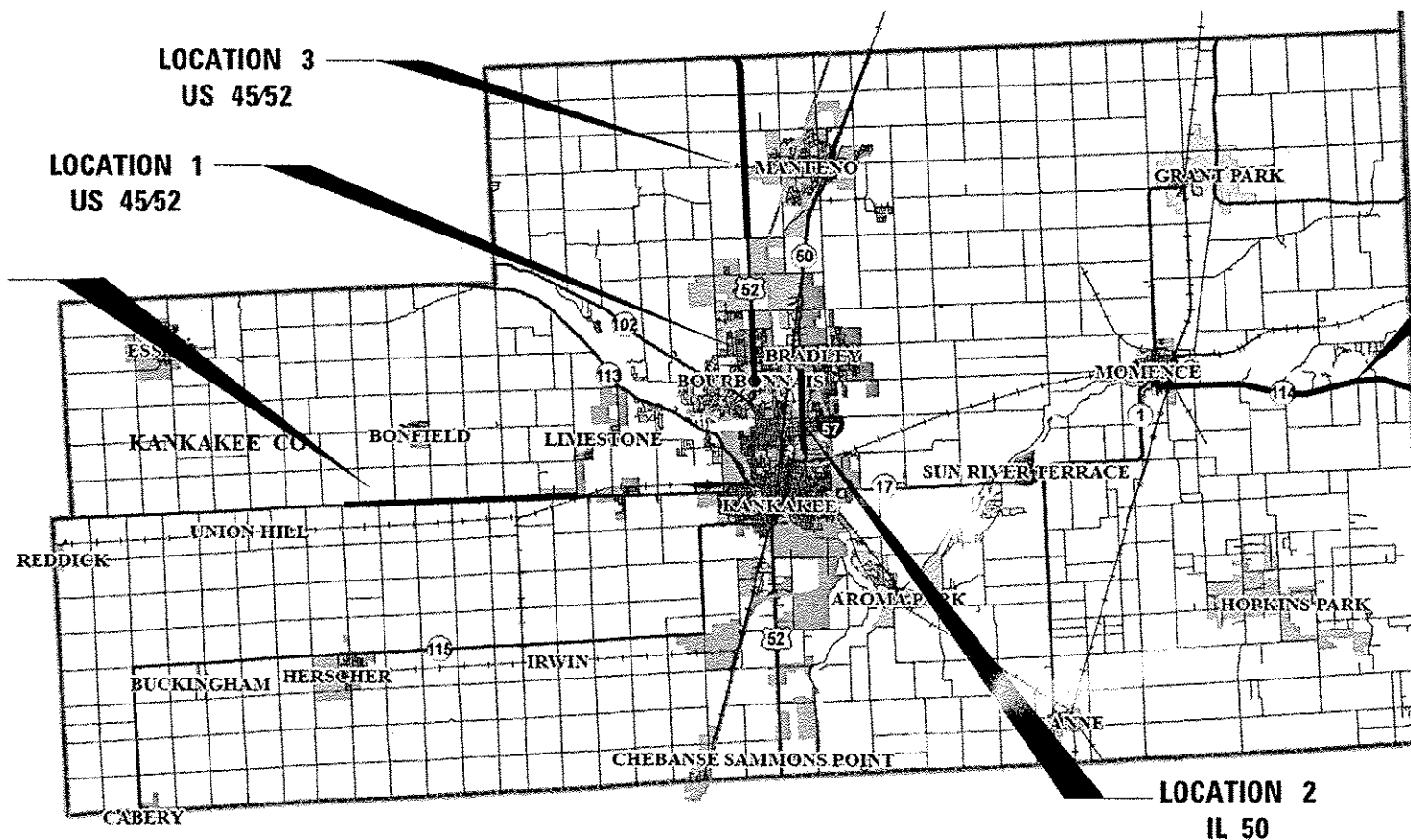

GROSS LENGTH = 21.24 MILES

PRINTED BY THE AUTHORITY  
OF THE STATE OF ILLINOIS

**GENERAL NOTES**

THE THICKNESS OF HMA SHOWN ON THE PLANS IS THE NOMINAL THICKNESS. DEVIATIONS FROM THE NOMINAL THICKNESS WILL BE PERMITTED WHEN SUCH DEVIATIONS OCCUR DUE TO IRREGULARITIES IN THE EXISTING SURFACE OR BASE ON WHICH THE HMA IS PLACED.

THE ENGINEER WILL BE THE SOLE JUDGE CONCERNING CURING TIME FOR THE VARIOUS HMA LIFTS.

FOR STABILIZATION, ALL TYPE III BARRICADES WILL REQUIRE A MINIMUM OF FOUR SAND BAGS PER BARRICADE.

ON EXISTING PAVEMENT WHICH MAY BE SUPERELEVATED, THE NEW HMA PAVEMENT SHALL BE BUILT WITH THE SAME SUPERELEVATION UNLESS NEW SUPERELEVATION RATES ARE GIVEN ON THE PLANS.

ANY REFERENCE TO A STANDARD IN THESE PLANS SHALL BE INTERPRETED TO MEAN THE EDITION AS INDICATED BY THE SUBNUMBER SHOWN IN THE LIST OF STANDARDS OR THE COPY INCLUDED IN THESE PLANS.

ALL EXCAVATED MATERIAL, WHICH INCLUDES DIGGING OR GRADING OF ANY SOIL OR FILL MATERIAL, WITH THE EXCEPTION OF AGGREGATE FILLS, MUST BE INCORPORATED WITHIN THE IDOT RIGHT OF WAY DUE TO ENVIRONMENTAL DOCUMENTATION REQUIREMENTS.

NO CONSTRUCTION ACTIVITIES SHALL BE PERFORMED WITHIN 150 FEET OF RAILROAD RIGHT OF WAY.

THE FOLLOWING RATES OF APPLICATION HAVE BEEN USED IN CALCULATING PLAN QUANTITIES:

HMA RESURFACING	112	LBS / SQ YD / IN
SHORT TERM PAVEMENT MARKING	10	FT /100 FT OF APPLICATION
MIX FOR CRACKS, JTS & FLGWYS	0.0003	TONS / SQ YD
LEVEL BINDER (HAND METHOD)	0.0005	TONS / SQ YD

THE CONTRACTOR SHALL CONTACT JULIE AT LEAST 48 HOURS PRIOR TO EXCAVATION TO DETERMINE WHICH UTILITIES ARE IN THE AREA.

THE CONTRACTOR SHALL CONTACT THE IDOT DISTRICT 3 TRAFFIC SECTION AT (815) 434-6131 BEFORE MILLING TO VERIFY DETECTOR LOOP LOCATIONS.

**FUNCTIONAL CLASSIFICATION AND ADT**

LOCATION 1 - US 45/52  
 ARMOUR RD TO INDIAN OAKS RD (2.05 MILES)  
 URBAN PRINCIPAL ARTERIAL  
 2013 ADT = 24600  
 P.V. = 93.39%  
 S.U. = 4.89%  
 M.U. = 1.72%

LOCATION 2 - IL 50  
 0.4 MILES S OF I-57 IN BRADLEY TO GRINNELL RD IN KANKAKEE (2.03 MILES)  
 URBAN PRINCIPAL ARTERIAL  
 2013 ADT = 22800  
 P.V. = 90.46%  
 S.U. = 5.92%  
 M.U. = 3.62%

LOCATION 3 - US 45/52  
 WILL COUNTY LINE TO MANTENO RD (3.10 MILES)  
 OTHER PRINCIPAL ARTERIAL  
 2013 ADT = 7100  
 P.V. = 84.15%  
 S.U. = 6.34%  
 M.U. = 9.51%

LOCATION 4 - IL 114  
 IL 1/17 TO THE INDIANA STATE LINE (7.40 MILES)  
 RURAL MINOR ARTERIAL  
 2013 ADT = 6400  
 P.V. = 69.14%  
 S.U. = 8.98%  
 M.U. = 21.88%

LOCATION 5 - IL 17  
 HERSCHER RD TO WEST OF NORFOLK SOUTHERN RR (6.68 MILES)  
 RURAL MINOR ARTERIAL  
 2013 ADT = 5150  
 P.V. = 78.64%  
 S.U. = 13.59%  
 M.U. = 7.77%

STATE OF ILLINOIS  
 DEPARTMENT OF TRANSPORTATION  
 DISTRICT THREE

PREPARED BY: *Tom Bonil*  
 DISTRICT STUDIES & PLANS ENGINEER

DATE: 4-11-14

EXAMINED BY: *Harold J. [unclear]*  
 DISTRICT CONSTRUCTION ENGINEER

*[Signature]*  
 DISTRICT MATERIALS ENGINEER

*Russell A. Hecker*  
 DISTRICT OPERATIONS ENGINEER

FILE NAME *	USER NAME * carpenterdj	DESIGNED -	REVISED -	<b>STATE OF ILLINOIS DEPARTMENT OF TRANSPORTATION</b>	<b>GENERAL NOTES</b>	F.A.P. RTE.	SECTION	COUNTY	TOTAL SHEETS	SHEET NO.	
c:\pw_work\pmdot\carpentardj\0307081\	0xxxxx-shr-cover.dgn	DRAWN -	REVISED -			VAR	*	KANKAKEE	24	2	
	PLOT SCALE * 1/8"=1'-0"	CHECKED -	REVISED -			CONTRACT NO. 66D91					
	PLOT DATE * 4/11/2014	DATE -	REVISED -			ILLINOIS FED. AID PROJECT					
					SCALE:	SHEET	OF	SHEETS	STA.	TO STA.	

\* INTERMITTENT SPRING ROAD REPAIR 2014-6

CODE NO.	ITEM	UNIT	TOTAL QUANTITY	CONSTRUCTION CODE	
				ROADWAY 0005 URBAN	ROADWAY 0005 RURAL
				40600400	MIXTURE FOR CRACKS, JOINTS, AND FLANGEWAYS
40600535	LEVELING BINDER (HAND METHOD), N70	TON	25	9	16
40603340	HOT-MIX ASPHALT SURFACE COURSE, MIX "D", N70	TON	5686	2072	3614
42400100	PORTLAND CEMENT CONCRETE SIDEWALK 4 INCH	SQ FT	800	400	400
42400800	DETECTABLE WARNINGS	SQ FT	160	80	80
44000157	HOT-MIX ASPHALT SURFACE REMOVAL, 2"	SQ YD	50176	18503	32273
44000500	COMBINATION CURB AND GUTTER REMOVAL	FOOT	128	64	64
44000600	SIDEWALK REMOVAL	SQ FT	800	400	400
60605000	COMBINATION CONCRETE CURB AND GUTTER, TYPE B-6.24	FOOT	128	64	64
67100100	MOBILIZATION	L SUM	1	0.5	0.5
70100460	TRAFFIC CONTROL AND PROTECTION, STANDARD 701306	L SUM	1		1
70102620	TRAFFIC CONTROL AND PROTECTION, STANDARD 701501	L SUM	1	1	
70102625	TRAFFIC CONTROL AND PROTECTION, STANDARD 701606	L SUM	1	1	
70102632	TRAFFIC CONTROL AND PROTECTION, STANDARD 701602	L SUM	1	1	

• SPECIALTY ITEMS

FILE NAME = c:\pwwork\p1s\dot\carpentardj\d8587081\2-drawings\ht-500.dgn USER NAME = carpentardj PLOT SCALE = 100.0000 1/1 in. PLOT DATE = 4/11/2014				DESIGNED - DRAWN - CHECKED - DATE -				REVISED - REVISED - REVISED - REVISED -				<b>STATE OF ILLINOIS DEPARTMENT OF TRANSPORTATION</b>				<b>SUMMARY OF QUANTITIES</b>				F.A.P. RTE. VAR		SECTION		COUNTY KANKAKEE		TOTAL SHEETS 24		SHEET NO. 3		CONTRACT NO. 66D91		ILLINOIS FED. AID PROJECT	
SCALE:		SHEET NO.		OF SHEETS		STA.		TO STA.																									

• INTERMITTENT SPRING ROAD REPAIR 2014-6

CODE NO.	ITEM	UNIT	TOTAL QUANTITY	CONSTRUCTION CODE	
				ROADWAY 0005 URBAN	ROADWAY 0005 RURAL
				70102635	TRAFFIC CONTROL AND PROTECTION, STANDARD 701701
70102640	TRAFFIC CONTROL AND PROTECTION, STANDARD 701801	L SUM	1	0.5	0.5
70300100	SHORT TERM PAVEMENT MARKING	FOOT	2250	900	1350
70301000	WORK ZONE PAVEMENT MARKING REMOVAL	SO FT	750	300	450
78001110	PAINT PAVEMENT MARKING - LINE 4"	FOOT	62616		62616
78001130	PAINT PAVEMENT MARKING - LINE 6"	FOOT	10647		10647
78001150	PAINT PAVEMENT MARKING - LINE 12"	FOOT	1268		1268
78009000	MODIFIED URETHANE PAVEMENT MARKING - LETTERS AND SYMBOLS	SO FT	347.4	112.5	234.9
78009004	MODIFIED URETHANE PAVEMENT MARKING - LINE 4"	FOOT	20942	5808	15134
78009006	MODIFIED URETHANE PAVEMENT MARKING - LINE 6"	FOOT	7337	5018	2319
78009008	MODIFIED URETHANE PAVEMENT MARKING - LINE 8"	FOOT	2000	2000	
78009012	MODIFIED URETHANE PAVEMENT MARKING - LINE 12"	FOOT	192	192	
78009024	MODIFIED URETHANE PAVEMENT MARKING - LINE 24"	FOOT	192	96	96
78300200	RAISED REFLECTIVE PAVEMENT MARKER REMOVAL	EACH	615	267	348

14 • SPECIALTY ITEMS

• INTERMITTENT SPRING ROAD REPAIR 2014-6

FILE NAME *	USER NAME * carpenterdj	DESIGNED -	REVISED -	<b>STATE OF ILLINOIS DEPARTMENT OF TRANSPORTATION</b>	<b>SUMMARY OF QUANTITIES</b>	F.A.P. RTE.	SECTION	COUNTY	TOTAL SHEETS	SHEET NO.	
c:\pr_work\p\d\carpenterdj\0307801	3xxxxsht-500.dgn	DRAWN -	REVISED -			VAR		KANKAKEE	24	4	
	PLOT SCALE * 1/8" = 1' / 1/4"	CHECKED -	REVISED -					CONTRACT NO. 66091			
	PLOT DATE * 4/11/2014	DATE -	REVISED -			SCALE:	SHEET OF	SHEETS STA.	TO STA.	[ILLINOIS] FED. AID PROJECT	

CODE NO.	ITEM	UNIT	TOTAL QUANTITY	CONSTRUCTION CODE	
				ROADWAY 0005 URBAN	ROADWAY 0005 RURAL
88600100	DETECTOR LOOP, TYPE I	FOOT	656	656	
X4060110	BITUMINOUS MATERIALS (PRIME COAT)	POUND	22850	8327	14523
X8860100	LOOP DETECTOR TESTING	EACH	2	2	

3 • SPECIALTY ITEMS

FILE NAME =	USER NAME = carperterd	DESIGNED -	REVISED -	<b>STATE OF ILLINOIS DEPARTMENT OF TRANSPORTATION</b>	<b>SUMMARY OF QUANTITIES</b>	F.A.P. RTE.	SECTION	COUNTY	TOTAL SHEETS	SHEET NO.
c:\p-work\p1dot\carperterd\102087981\3xxxx-ah1-500.dgn	DRAWN -	REVISED -	VAR			*	KANKAKEE	24	5	
PLT SCALE = 1/2" = 1' / in.	CHECKED -	REVISED -	CONTRACT NO. 66091							
PLT DATE = 4/11/2014	DATE -	REVISED -	ILLINOIS FED. AID PROJECT							
				SCALE:	SHEET OF SHEETS	STA. TO STA.				

• INTERMITTENT SPRING ROAD REPAIR 2014-6

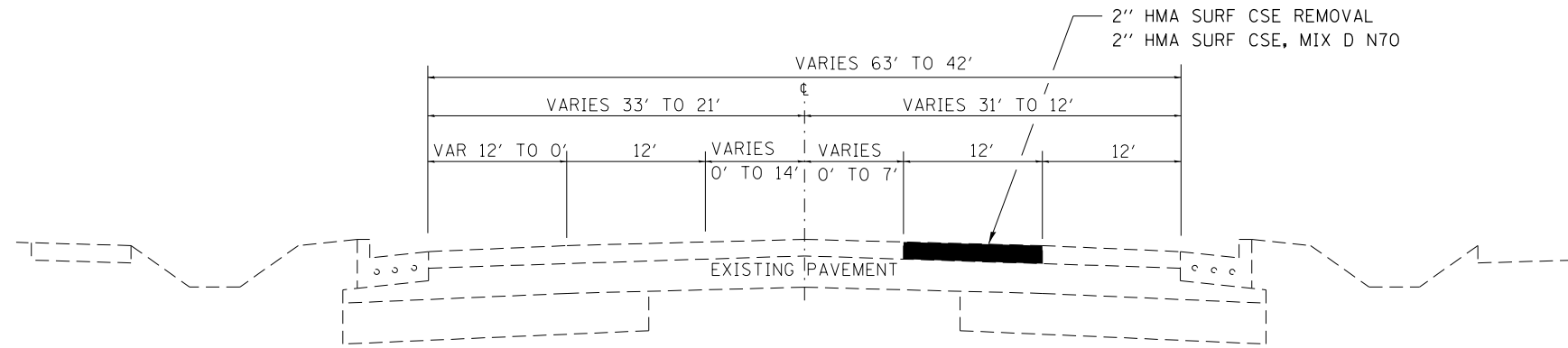

**LOCATION 1 – US 45/2**

ARMOUR RD TO INDIAN OAKS RD

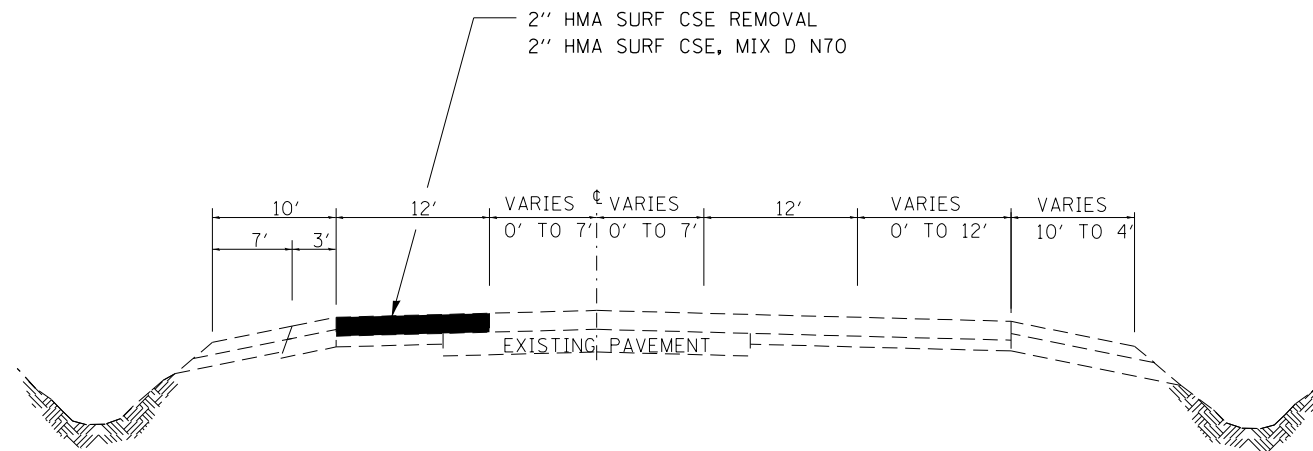

**LOCATION 1 – US 45/2**

ARMOUR RD TO INDIAN OAKS RD

**SEE SCHEDULES  
FOR WIDTHS AND LOCATIONS  
OF MILLING AND RESURFACING**

MIX DESIGN - ALL LOCATIONS					
MIX	PG GRADE	DESIGN AIR VOIDS	MIX COMPOSITION	FRICTION AGG	DENSITY CONTROL
HMA SURFACE	PG 64-22	4.0% @N70	IL 9.5	MIXTURE D	CORES

• INTERMITTENT SPRING ROAD REPAIR 2014-6

FILE NAME =	USER NAME = carpenterdj	DESIGNED -	REVISED -
c:\pwork\pwork\carpenterdj\d0387881\03xxxxx-sht-typicol.dgn		DRAWN -	REVISED -
	PLOT SCALE = 100.0000' / 1in.	CHECKED -	REVISED -
\$MODELNAME\$	PLOT DATE = 4/11/2014	DATE -	REVISED -

**STATE OF ILLINOIS  
DEPARTMENT OF TRANSPORTATION**

<b>TYPICAL SECTIONS</b>			
SCALE:	SHEET	OF SHEETS	STA. TO STA.

F.A.P. RTE.	SECTION	COUNTY	TOTAL SHEETS	SHEET NO.
VAR	*	KANKAKEE	24	6
				CONTRACT NO. 66D91
ILLINOIS FED. AID PROJECT				

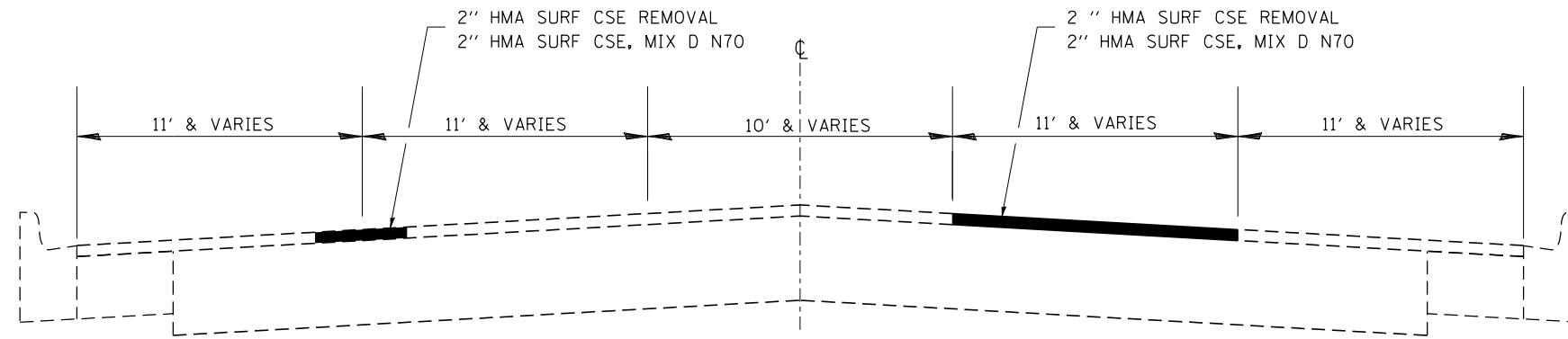

**LOCATION 2 – IL 50**

0.4 MILES S OF I-57 IN BRADLEY TO GRINNELL RD IN KANKAKEE

**SEE SCHEDULES  
FOR WIDTHS AND LOCATIONS  
OF MILLING AND RESURFACING**

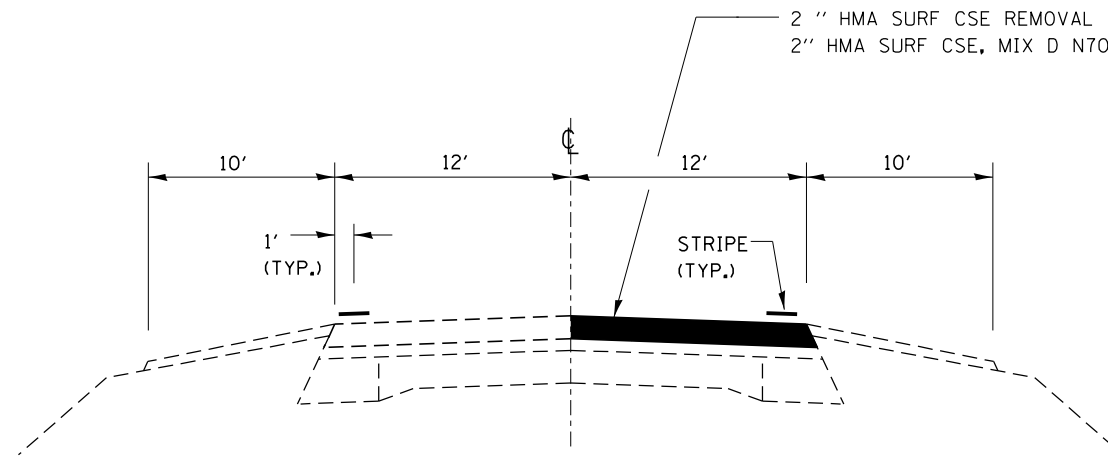

**LOCATION 3 – US 45/52**

WILL COUNTY LINE TO MANTENO RD

FILE NAME =	USER NAME = carpenterdj	DESIGNED -	REVISED -
ei:\pwork\pwork\carpenterdj\d0387881\03xxxxx-sht-typicol.dgn		DRAWN -	REVISED -
	PLOT SCALE = 100.0000' / in.	CHECKED -	REVISED -
	PLOT DATE = 4/11/2014	DATE -	REVISED -

**STATE OF ILLINOIS  
DEPARTMENT OF TRANSPORTATION**

**TYPICAL SECTIONS**

SCALE: SHEET OF SHEETS STA. TO STA.

F.A.P. RTE.	SECTION	COUNTY	TOTAL SHEETS	SHEET NO.
VAR	•	KANKAKEE	24	7
CONTRACT NO. 66D91				
ILLINOIS FED. AID PROJECT				

• INTERMITTENT SPRING ROAD REPAIR 2014-6

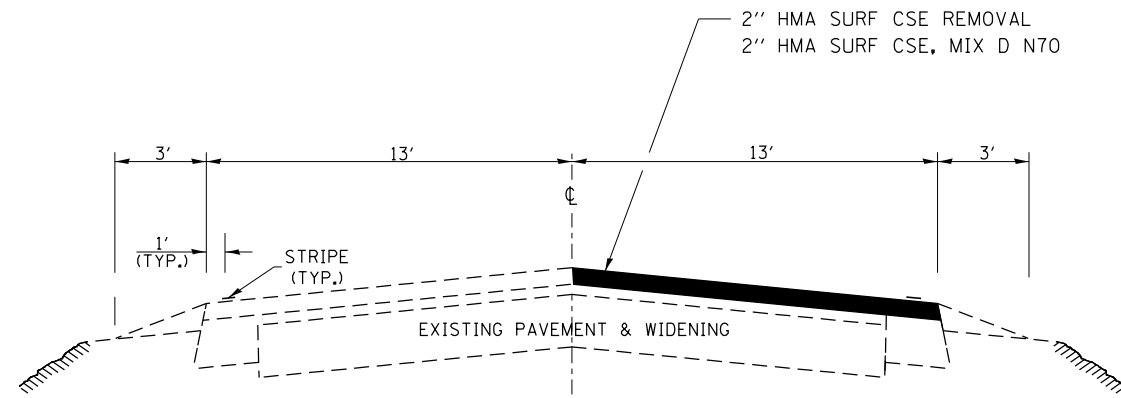

**LOCATION 4 – IL 114**

IL 1/17 TO INDIANA STATE LINE

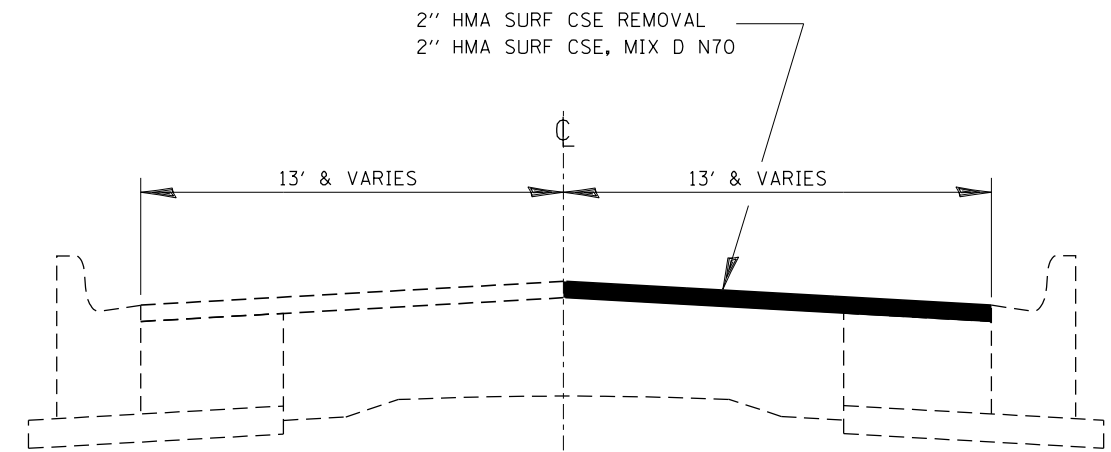

**LOCATION 4 – IL 114**

IL 1/17 TO INDIANA STATE LINE

**SEE SCHEDULES  
FOR WIDTHS AND LOCATIONS  
OF MILLING AND RESURFACING**

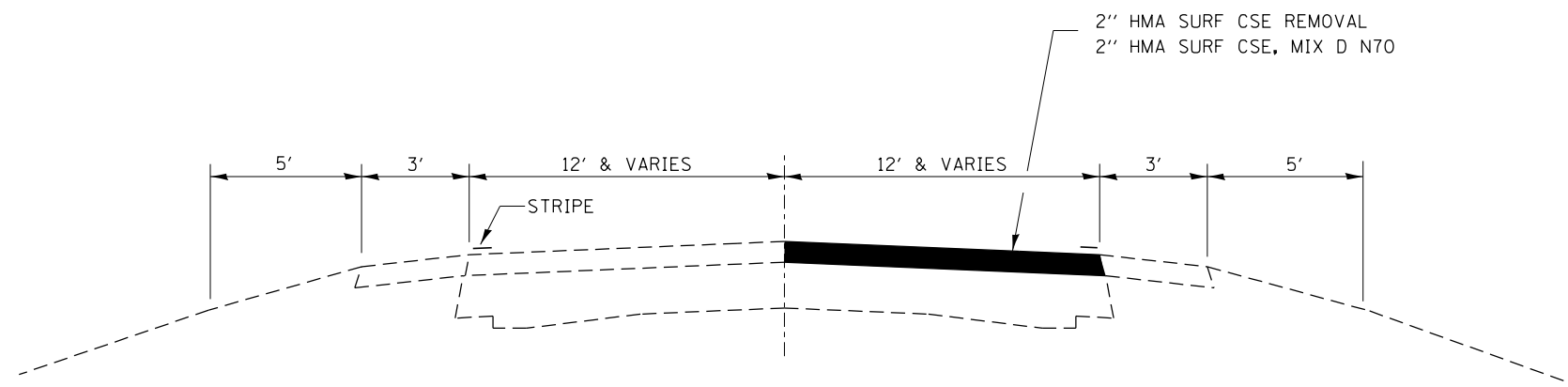

**LOCATION 5 – IL 17**

HERSCHER RD TO 150' WEST OF NORFOLK SOUTHERN RR

FILE NAME =	USER NAME = carpenterdj	DESIGNED -	REVISED -
c:\pwork\pwork\carpenterdj\d0387881\03xxxxx-sht-typicol.dgn		DRAWN -	REVISED -
	PLOT SCALE = 100.0000' / 1in.	CHECKED -	REVISED -
	PLOT DATE = 4/11/2014	DATE -	REVISED -

**STATE OF ILLINOIS  
DEPARTMENT OF TRANSPORTATION**

**TYPICAL SECTIONS**

SCALE: SHEET OF SHEETS STA. TO STA.

F.A.P. RTE.	SECTION	COUNTY	TOTAL SHEETS	SHEET NO.
VAR	•	KANKAKEE	24	8
CONTRACT NO. 66D91				
ILLINOIS FED. AID PROJECT				

• INTERMITTENT SPRING ROAD REPAIR 2014-6



RESURFACING SCHEDULE								
LOCATION		APPROX LENGTH	WIDTH	HMA SURF REM 2"	HMA SURF CSE	BIT MAT (PR CT)	MIX FOR CRACKS, JOINTS & FLGWYS	LEVEL BINDER (HM)
LOG MI		FOOT	FOOT	SQ YD	TON	LB	TON	TON
<b>LOCATION 1 (US 45/52 AT ARMOUR RD)</b>								
0.1 TO 0.15	NB PASS LANE EOP	264	4	117	13.1	52.8	0.04	0.06
0.1 TO 0.15	NB DRIVE LANE EOP	264	4	117	13.1	52.8	0.04	0.06
0.3 TO 0.4 (NORTH OF JOHN CASEY RD)	NB DRIVING LANE	528	12	704	78.8	316.8	0.21	0.35
0.3 TO 0.4 (NORTH OF JOHN CASEY RD)	NB PASSING LANE	528	12	704	78.8	316.8	0.21	0.35
0.3 TO 0.4 (NORTH OF JOHN CASEY RD)	SB LANE LINE	528	2	117	13.1	52.8	0.04	0.06
0.3 TO 0.4 (NORTH OF JOHN CASEY RD)	SB MEDIAN CENTERLINE	528	2	117	13.1	52.8	0.04	0.06
0.4	SB DRIVE LANE	50	12	67	7.5	30.0	0.02	0.03
0.4 TO 0.5	NB PASSING LANE	528	12	704	78.8	316.8	0.21	0.35
0.5 TO 1.10	SB LANE LINE	3168	2	704	78.8	316.8	0.21	0.35
0.8 TO 1.0 (BONDS TO SOUTH OF KIM)	NB DRIVING LANE	1056	12	1408	157.7	633.6	0.42	0.7
0.8 TO 1.0 (BONDS TO SOUTH OF KIM)	NB PASSING LANE	1056	12	1408	157.7	633.6	0.42	0.7
1.0 TO 1.1	SB MEDIAN CENTERLINE	528	2	117	13.1	52.8	0.04	0.06
1.0 TO 1.3	MEDIAN CENTERLINE	1584	2	352	39.4	158.4	0.11	0.18
1.2 TO 1.4 (SOUTH OF BURNS)	NB LANE LINE	1056	4	469	52.6	211.2	0.14	0.23
SUBTOTAL 1				7105	795.6	3198.0	2.15	3.54
<b>LOCATION 2 (IL 50)</b>								
0.0 TO 0.25 (ARMOUR RD TO K-MART ENTRANCE)	SB LANE LINE	13200	4	5867	657.1	2640.0	1.76	2.93
0.4 TO 0.5 (S OF LOWE'S ENTRANCE)	SB DRIVING LANE	528	12	704	78.8	316.8	0.21	0.35
0.4 TO 0.5 (S OF LOWE'S ENTRANCE)	SB PASSING LANE	528	12	704	78.8	316.8	0.21	0.35
0.7 (NORTH OF MULLIGAN)	SB PASSING LANE	50	12	67	7.5	30.0	0.02	0.03
0.7 TO 0.9	SB LANE LINE	1056	4	469	52.6	211.2	0.14	0.23
0.7 TO 1.2 (N OF MULLIGAN TO N OF BROADWAY)	NB DRIVE LANE EOP	2640	4	1173	131.4	528.0	0.35	0.59
0.75 (NORTH OF MULLIGAN)	NB DRIVING LANE	50	12	67	7.5	30.0	0.02	0.03
1.0 TO 1.4 (S OF NORTH ST)	SB DRIVING LANE EOP	2112	4	939	105.1	422.4	0.28	0.47
1.3 TO 1.5 (S BROADWAY TO N OF LIBERTY)	NB DRIVING LANE	1056	12	1408	157.7	633.6	0.42	0.7
SUBTOTAL 2				11398	1276.5	5128.8	3.41	5.68
URBAN TOTAL				18503	2072	8327	6	9

RESURFACING SCHEDULE (CONT)								
LOCATION		APPROX LENGTH	WIDTH	HMA SURF REM 2"	HMA SURF CSE	BIT MAT (PR CT)	MIX FOR CRACKS, JOINTS & FLGWYS	LEVEL BINDER (HM)
LOG MI		FOOT	FOOT	SQ YD	TON	LB	TON	TON
<b>LOCATION 3 (US 45/52 WILL CO. LINE)</b>								
0.0 TO 0.2	SB DRIVING LANE	1056	12	1408	157.7	633.6	0.42	0.7
0.4 TO 0.5	SB DRIVING LANE	5280	12	7040	788.5	3168.0	2.11	3.52
0.6 TO 0.9	NB EOP	1584	4	704	78.8	316.8	0.21	0.35
0.7 TO 1.1	CENTERLINE	2112	2	469	52.6	211.2	0.14	0.23
1.1	SB EOP	50	4	22	2.5	10.0	0.01	0.01
1.3 TO 1.5	SB EOP	1056	4	469	52.6	211.2	0.14	0.23
1.5	SB DRIVING LANE	50	12	67	7.5	30.0	0.02	0.03
1.6 (STRUCTURE APPROACH)	NB DRIVING LANE	20	12	27	3	12.0	0.01	0.01
1.9 TO 2.0	CENTERLINE	528	2	117	13.1	52.8	0.04	0.06
2.0 TO 2.3	NB EOP	1584	4	704	78.8	316.8	0.21	0.35
2.4 TO 2.6	CENTERLINE	1056	2	235	26.3	105.6	0.07	0.12
2.5 TO 2.7	NB EOP	1056	4	469	52.6	211.2	0.14	0.23
2.6	SB DRIVING LANE	50	12	67	7.5	30.0	0.02	0.03
SUBTOTAL 3				11798	1321.5	5309.2	3.54	5.87
<b>LOCATION 4 (IL 114)</b>								
0.2 TO 0.7	EB DRIVING LANE	2640	12	3520	394.2	1584.0	1.06	1.76
0.2 TO 0.7	WB DRIVING LANE	2640	13	3813	427.1	1716.0	1.14	1.91
0.8	EB DRIVING LANE	50	12	67	7.5	30.0	0.02	0.03
0.9	EB EOP	50	2	11	1.2	5.0	0	0.01
1.2 TO 1.3	WB EOP	528	2	117	13.1	52.8	0.04	0.06
1.2 TO 1.3	EB EOP	528	2	117	13.1	52.8	0.04	0.06
1.9 TO 2.1	CENTERLINE	1056	2	235	26.3	105.6	0.07	0.12
2.2	WB DRIVING LANE	50	12	67	7.5	30.0	0.02	0.03
2.9	WB DRIVING LANE	50	12	67	7.5	30.0	0.02	0.03
3.8 TO 3.9	CENTERLINE	528	2	117	13.1	52.8	0.04	0.06
4.7 TO 4.8	CENTERLINE	528	2	117	13.1	52.8	0.04	0.06
5.4 TO 5.5	CENTERLINE	528	2	117	13.1	52.8	0.04	0.06
5.6 TO 5.7	EB EOP	528	2	117	13.1	52.8	0.04	0.06
5.9 TO 6.0	CENTERLINE	528	2	117	13.1	52.8	0.04	0.06
6.4 TO 6.5	EB EOP	528	2	117	13.1	52.8	0.04	0.06
6.9	EB DRIVING LANE	50	12	67	7.5	30.0	0.02	0.03
7.0	WB DRIVING LANE	50	12	67	7.5	30.0	0.02	0.03
7.1 TO 7.2	WB EOP	528	2	117	13.1	52.8	0.04	0.06
7.3 TO 7.4	EB DRIVING LANE	528	12	704	78.8	316.8	0.21	0.35
7.3 TO 7.4	WB DRIVING LANE	528	12	704	78.8	316.8	0.21	0.35
SUBTOTAL 4				10375	1161.8	4669.4	3.15	5.19
<b>LOCATION 5 (IL 17)</b>								
0.1	EB LANE	50	12	67	7.5	30.0	0.02	0.03
0.2	WB LANE	50	12	67	7.5	30.0	0.02	0.03
0.6 TO 0.7	CENTERLINE	528	2	117	13.1	52.8	0.04	0.06
0.7 TO 0.8	EB LANE	528	12	704	78.8	316.8	0.21	0.35
0.7 TO 0.8	WB LANE	528	12	704	78.8	316.8	0.21	0.35
1.6 TO 1.7	EB LANE	528	12	704	78.8	316.8	0.21	0.35
1.7 TO 1.9	CENTERLINE	1056	2	235	26.3	105.6	0.07	0.12
1.9 TO 2.1	EB LANE	1056	12	1408	157.7	633.6	0.42	0.7
2.1 TO 2.6	CENTERLINE	2640	2	587	65.7	264.0	0.18	0.29
2.2	EB LANE	50	12	67	7.5	30.0	0.02	0.03
2.8 TO 3.0	CENTERLINE	1056	2	235	26.3	105.6	0.07	0.12
3.1 TO 3.2	CENTERLINE	528	2	117	13.1	52.8	0.04	0.06
3.6 TO 4.15	CENTERLINE	645	2	143	16.1	64.5	0.04	0.07
4.15 TO 4.3	WB LANE	792	12	1056	118.3	475.2	0.32	0.53
4.4 TO 4.6	EB LANE	1056	12	1408	157.7	633.6	0.42	0.7
4.7 TO 5.0	MEDIAN	1584	10	1760	197.1	792.0	0.53	0.88
4.8	WB LANE	50	12	67	7.5	30.0	0.02	0.03
5.4	WB LANE	50	12	67	7.5	30.0	0.02	0.03
5.7 TO 5.8	CENTERLINE	528	2	117	13.1	52.8	0.04	0.06
6.3 TO 6.5	MEDIAN / CL	1056	2	235	26.3	105.6	0.07	0.12
6.4 TO 6.6	MEDIAN / CL	1056	2	235	26.3	105.6	0.07	0.12
SUBTOTAL 5				10100	1131	4544.1	3.04	5.03
RURAL TOTAL				32273	3614	14523	10	16
TOTAL				50776	5686	22850	16	25

NOTE: NO CONSTRUCTION ACTIVITIES SHALL TAKE PLACE WITHIN 150 FEET OF ANY RAILROAD TRACKS

FILE NAME =	USER NAME = carpenterdj	DESIGNED -	REVISED -	<b>STATE OF ILLINOIS DEPARTMENT OF TRANSPORTATION</b>	<b>SCHEDULES</b>				F.A.P. RTE.	SECTION	COUNTY	TOTAL SHEETS	SHEET NO.
ei:\pw\work\p\midot\carpenterdj\d0387881\03xxxxx-sht-schedule.dgn	PLOT SCALE = 100.0000' / in.	DRAWN -	REVISED -						VAR	*	KANKAKEE	24	9
PLOT DATE = 4/11/2014	DATE -	CHECKED -	REVISED -		SCALE:	SHEET NO.	OF SHEETS	STA.	TO STA.	ILLINOIS FED. AID PROJECT			
										CONTRACT NO. 66D91			

• INTERMITTENT SPRING ROAD REPAIR 2014-6

PAVEMENT MARKING																
LOCATION	PAINT PAVEMENT MARKING LINE				MODIFIED URETHANE MARKING LINE									RAISED REFL PVMT MARKER REMOVAL EACH	SHORT TERM PAVEMENT MARKING FOOT	WORK ZONE PAVEMENT REMOVAL SQ FT
	4 INCH		6 INCH	12 INCH	4 INCH		6 INCH		8 INCH	12 INCH		24 INCH	LETTERS & SYMBOLS SQ FT			
	YELLOW FOOT	WHITE FOOT	YELLOW FOOT	YELLOW FOOT	YELLOW FOOT	WHITE FOOT	WHITE FOOT	YELLOW FOOT	WHITE FOOT	WHITE FOOT	WHITE FOOT	YELLOW FOOT	WHITE FOOT			
STA	FOOT	FOOT	FOOT	FOOT	FOOT	FOOT	FOOT	FOOT	FOOT	FOOT	FOOT	FOOT	FOOT	FOOT	FOOT	FOOT
LOCATION 1 (US 45/52 AT ARMOUR RD)					4752		937		1000	96		96	112.5	68	450	150
LOCATION 2 (IL 50)					1056		4081		1000	96				199	450	150
	0	0	0	0	5808	0	5018	0	2000	192	0	96	112.5	267	900	300
<b>URBAN TOTALS</b>	<b>0</b>	<b>0</b>	<b>0</b>	<b>0</b>	<b>5808</b>	<b>0</b>	<b>5018</b>	<b>0</b>	<b>2000</b>	<b>192</b>	<b>0</b>	<b>96</b>	<b>112.5</b>	<b>267</b>	<b>900</b>	<b>300</b>
LOCATION 3 (US 45/52 WILL CO. LINE)		23572	5076											126	450	150
LOCATION 4 (IL 114)					4802	10332		2319				96	234.9	83	450	150
LOCATION 5 (IL 17)	29568	9476	5571	1268										139	450	150
	29568	33048	10647	1268	4802	10332	0	2319	0	0	0	96	234.9	348	1350	450
<b>RURAL TOTALS</b>	<b>62616</b>	<b>33048</b>	<b>10647</b>	<b>1268</b>	<b>15134</b>	<b>10332</b>	<b>0</b>	<b>2319</b>	<b>0</b>	<b>0</b>	<b>0</b>	<b>96</b>	<b>234.9</b>	<b>348</b>	<b>1350</b>	<b>450</b>
<b>TOTALS</b>	<b>62616</b>	<b>33048</b>	<b>10647</b>	<b>1268</b>	<b>20942</b>	<b>10332</b>	<b>0</b>	<b>7337</b>	<b>2000</b>	<b>192</b>	<b>0</b>	<b>192</b>	<b>347.4</b>	<b>615</b>	<b>2250</b>	<b>750</b>

NOTE: ADDITIONAL QUANTITY HAS BEEN INCLUDED TO ALLOW FOR TWO SEPARATE APPLICATIONS OF PAINT PAVEMENT MARKING LINE

SIDEWALK SCHEDULE					
LOCATION	SIDEWALK REMOVAL SQ FT	PCC SIDEWALK 4" SQ FT	COMB C&G REM FT	COMBINATION CC&G TYPE B-6.24 FT	DETECTABLE WARNINGS SQ FT
<b>URBAN:</b>					
LOCATION 1 (US 45/52 AT ARMOUR RD)	400	400	64	64	80
<b>RURAL:</b>					
LOCATION 4 (IL 114)	400	400	64	64	80
<b>TOTALS</b>	<b>800</b>	<b>800</b>	<b>128</b>	<b>128</b>	<b>160</b>

DETECTOR LOOPS		
	DETECTOR LOOP TYPE I FOOT	DETECTOR LOOP TESTING EACH
LOCATION 1 (US 45/52 AT ARMOUR RD)		2
LOCATION 2 (IL 50)	656	
<b>URBAN TOTAL</b>	<b>656</b>	<b>2</b>

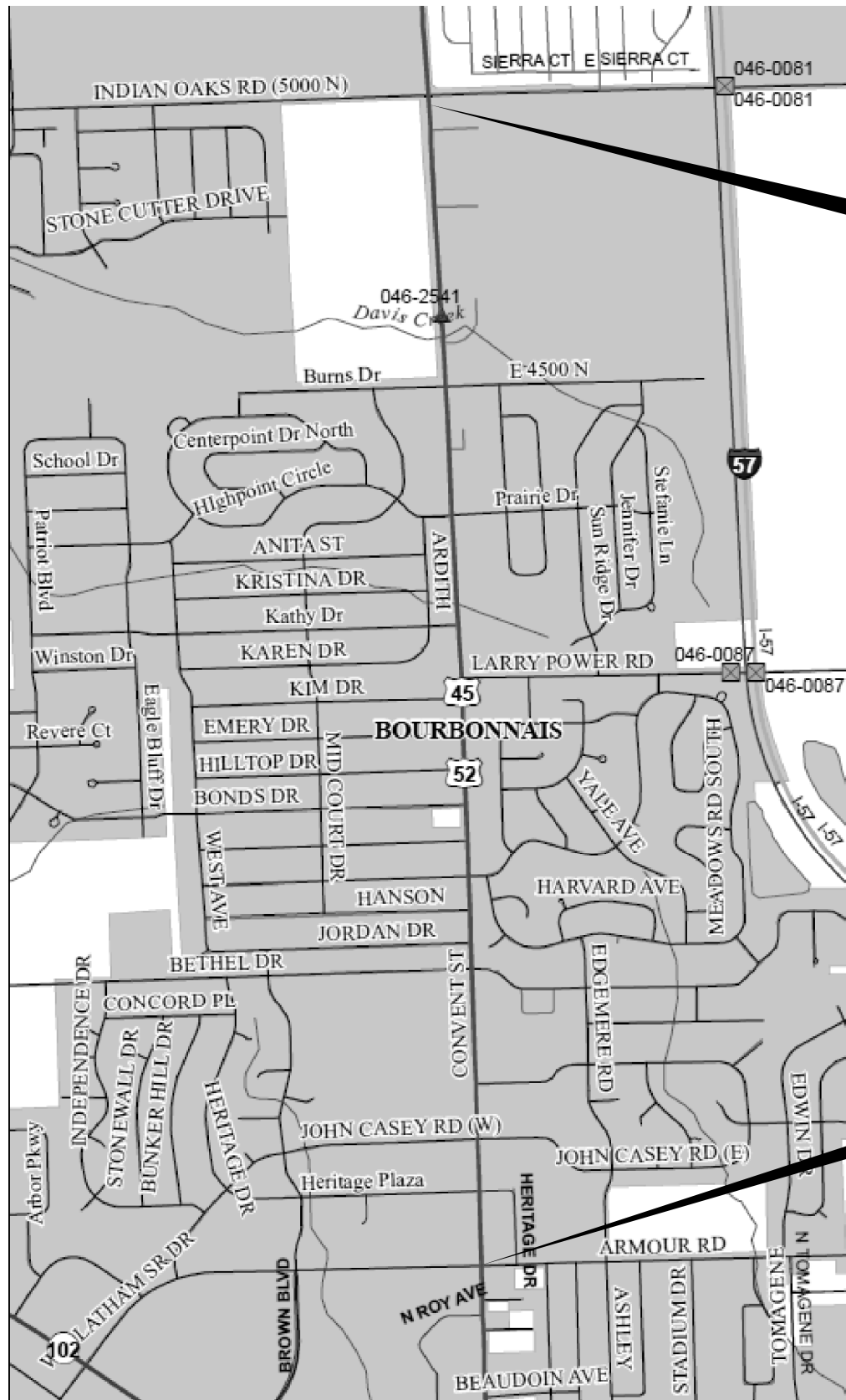

**LOCATION 1 - US 45/52**  
**ARMOUR RD TO INDIAN OAKS RD**

END IMPROVEMENT  
 LOG MILE 2.0

BEGIN IMPROVEMENT  
 LOG MILE 0.0

BEGIN IMPROVEMENT

LOG MILE 0.0

END IMPROVEMENT  
 LOG MILE 2.0



**LOCATION 2 - IL 50**  
**SOUTH OF I-57 TO GRINNELL RD**

FILE NAME =	USER NAME = carpenterdj	DESIGNED -	REVISED -
c:\pwork\pwork\carpenterdj\d0387881\03xxxx-sht-details.dgn		DRAWN -	REVISED -
\$MODELNAME\$	PLOT SCALE = 100.0000' / 1"	CHECKED -	REVISED -
	PLOT DATE = 4/11/2014	DATE -	REVISED -

**STATE OF ILLINOIS**  
**DEPARTMENT OF TRANSPORTATION**

<b>PROJECT LAYOUT</b>			
<b>LOCATIONS 1 &amp; 2</b>			
SCALE:	SHEET	OF SHEETS	STA. TO STA.

F.A.P. RTE.	SECTION	COUNTY	TOTAL SHEETS	SHEET NO.
VAR	.	KANKAKEE	24	11
CONTRACT NO. 66D91				
ILLINOIS FED. AID PROJECT				

• INTERMITTENT SPRING ROAD REPAIR 2014-6

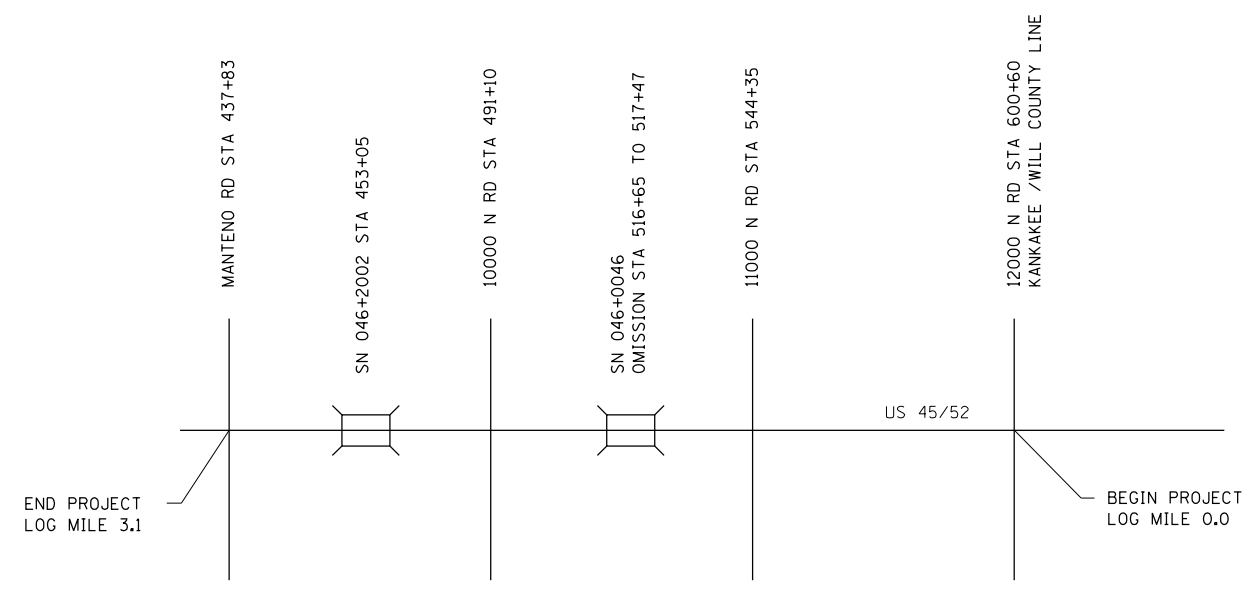
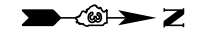

**LOCATION 3 - US 45/52  
WILL COUNTY TO MANTENO RD**

• INTERMITTENT SPRING ROAD REPAIR 2014-6

FILE NAME =	USER NAME = carpenterdj	DESIGNED -	REVISED -	<b>STATE OF ILLINOIS DEPARTMENT OF TRANSPORTATION</b>	<b>PROJECT LAYOUT LOCATION 3</b>	F.A.P. RTE.	SECTION	COUNTY	TOTAL SHEETS	SHEET NO.	
ci:\pw\work\p\idot\carpenterdj\d0387881\03xxxxx-sht-details.dgn		DRAWN -	REVISED -			VAR	•	KANKAKEE	24	12	
\$MODELNAME\$		CHECKED -	REVISED -			CONTRACT NO. 66D91					
	PLOT DATE = 4/11/2014	DATE -	REVISED -			SCALE:	SHEET OF SHEETS	STA. TO STA.	ILLINOIS FED. AID PROJECT		



BEGIN IMPROVEMENT  
LOG MILE 0.0

END IMPROVEMENT  
LOG MILE 7.4  
INDIANA STATE LINE

BEGIN IMPROVEMENT  
LOG MILE 0.0

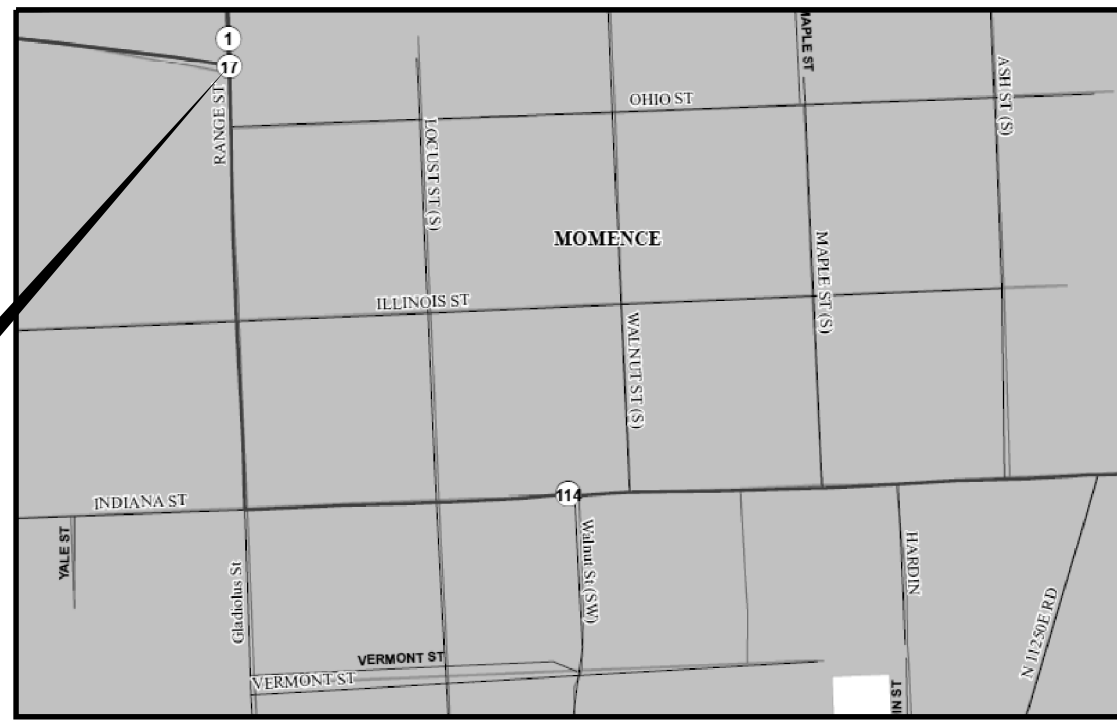

**DETAIL**

**LOCATION 4 - IL 114  
IL 117 TO INDIANA STATE LINE**

FILE NAME =	USER NAME = carpenterdj	DESIGNED -	REVISED -
c:\pwork\work\pwork\carpenterdj\d0387881\03xxxx-sht-details.dgn		DRAWN -	REVISED -
	PLOT SCALE = 100.0000' / in.	CHECKED -	REVISED -
\$MODELNAME\$	PLOT DATE = 4/11/2014	DATE -	REVISED -

**STATE OF ILLINOIS  
DEPARTMENT OF TRANSPORTATION**

**PROJECT LAYOUT  
LOCATION 4**

SCALE: SHEET OF SHEETS STA. TO STA.

• INTERMITTENT SPRING ROAD REPAIR 2014-6			
F.A.P. RTE.	SECTION	COUNTY	TOTAL SHEETS
VAR	•	KANKAKEE	24
			SHEET NO. 13
			CONTRACT NO. 66D91
ILLINOIS FED. AID PROJECT			

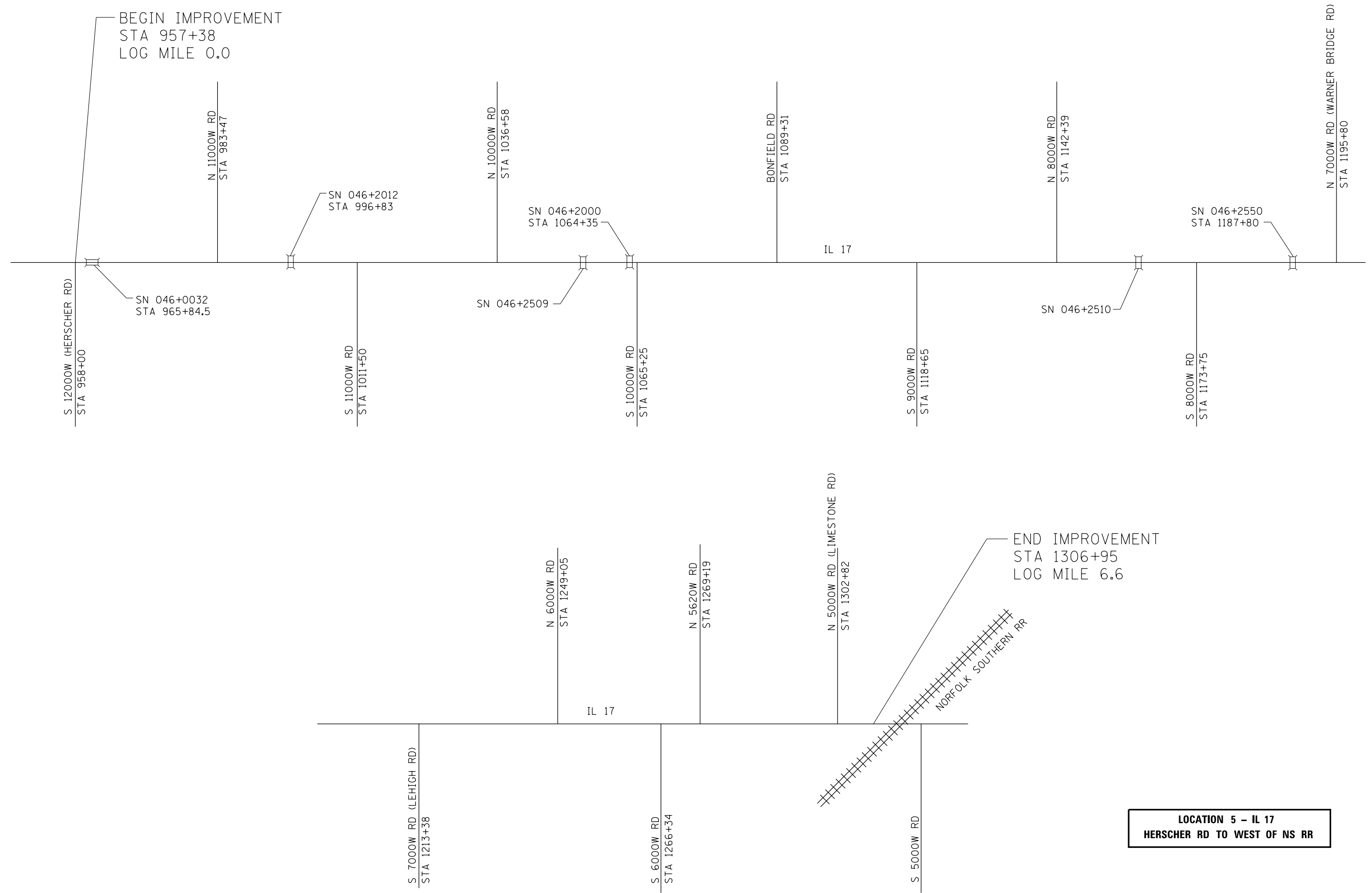

BEGIN IMPROVEMENT  
STA 957+38  
LOG MILE 0.0

END IMPROVEMENT  
STA 1306+95  
LOG MILE 6.6

**LOCATION 5 - IL 17**  
**HERSCHER RD TO WEST OF NS RR**

FILE NAME =	USER NAME = carpenterdj	DESIGNED -	REVISED -
c:\pwork\pwork\carpenterdj\d0387881\03xxxxx-sht-details.dgn		DRAWN -	REVISED -
	PLOT SCALE = 100.0000' / in.	CHECKED -	REVISED -
\$MODELNAME\$	PLOT DATE = 4/11/2014	DATE -	REVISED -

**STATE OF ILLINOIS**  
**DEPARTMENT OF TRANSPORTATION**

**PROJECT LAYOUT**  
**LOCATION 5**

SCALE: SHEET OF SHEETS STA. TO STA.

F.A.P. RTE.	SECTION	COUNTY	TOTAL SHEETS	SHEET NO.
VAR	•	KANKAKEE	24	14
			CONTRACT NO. 66D91	
ILLINOIS FED. AID PROJECT				

STA.	TO STA.
FED. ROAD DIST. NO.	ILLINOIS FED. AID PROJECT

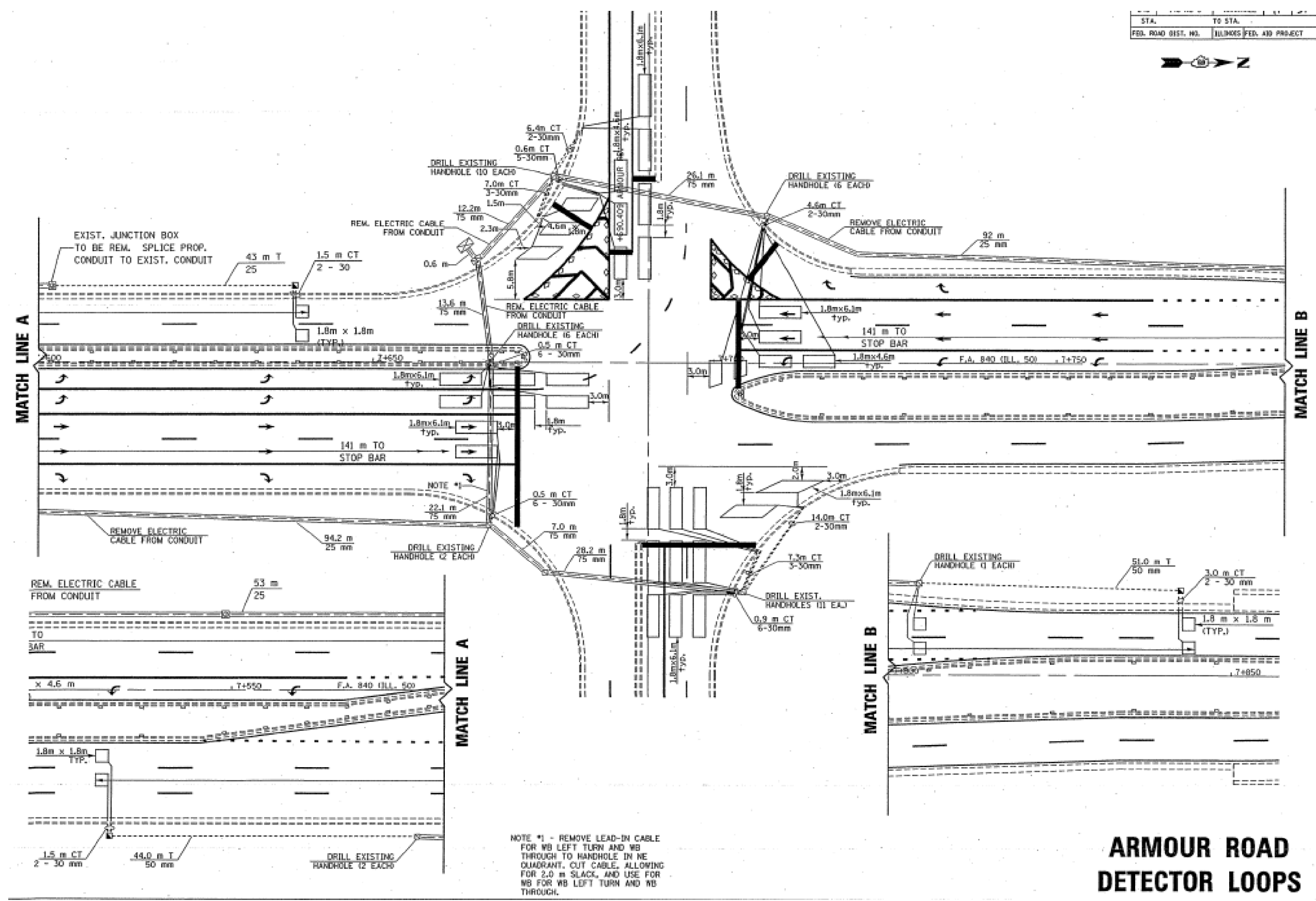

# ARMOUR ROAD DETECTOR LOOPS

**FOR INFORMATION ONLY**

THE CONTRACTOR SHALL CONTACT THE IDOT DISTRICT 3 TRAFFIC SECTION AT (815) 434-6131 BEFORE MILLING TO VERIFY DETECTOR LOOP LOCATIONS.

• INTERMITTENT SPRING ROAD REPAIR 2014-6

FILE NAME =	USER NAME = carpenterdj	DESIGNED -	REVISED -
ei:\pwork\pwork\carpenterdj\d0387881\03xxxx-sht-details.dgn		DRAWN -	REVISED -
\$MODELNAME\$	PLOT SCALE = 100.0000' / 1"	CHECKED -	REVISED -
	PLOT DATE = 4/11/2014	DATE -	REVISED -

**STATE OF ILLINOIS  
DEPARTMENT OF TRANSPORTATION**

**DETECTOR LOOP (FOR INFORMATION ONLY)  
LOCATION 2 - IL 50**

SCALE: SHEET OF SHEETS STA. TO STA.

F.A.P. RTE.	SECTION	COUNTY	TOTAL SHEETS	SHEET NO.
VAR	.	KANKAKEE	24	15
CONTRACT NO. 66D91				
ILLINOIS FED. AID PROJECT				

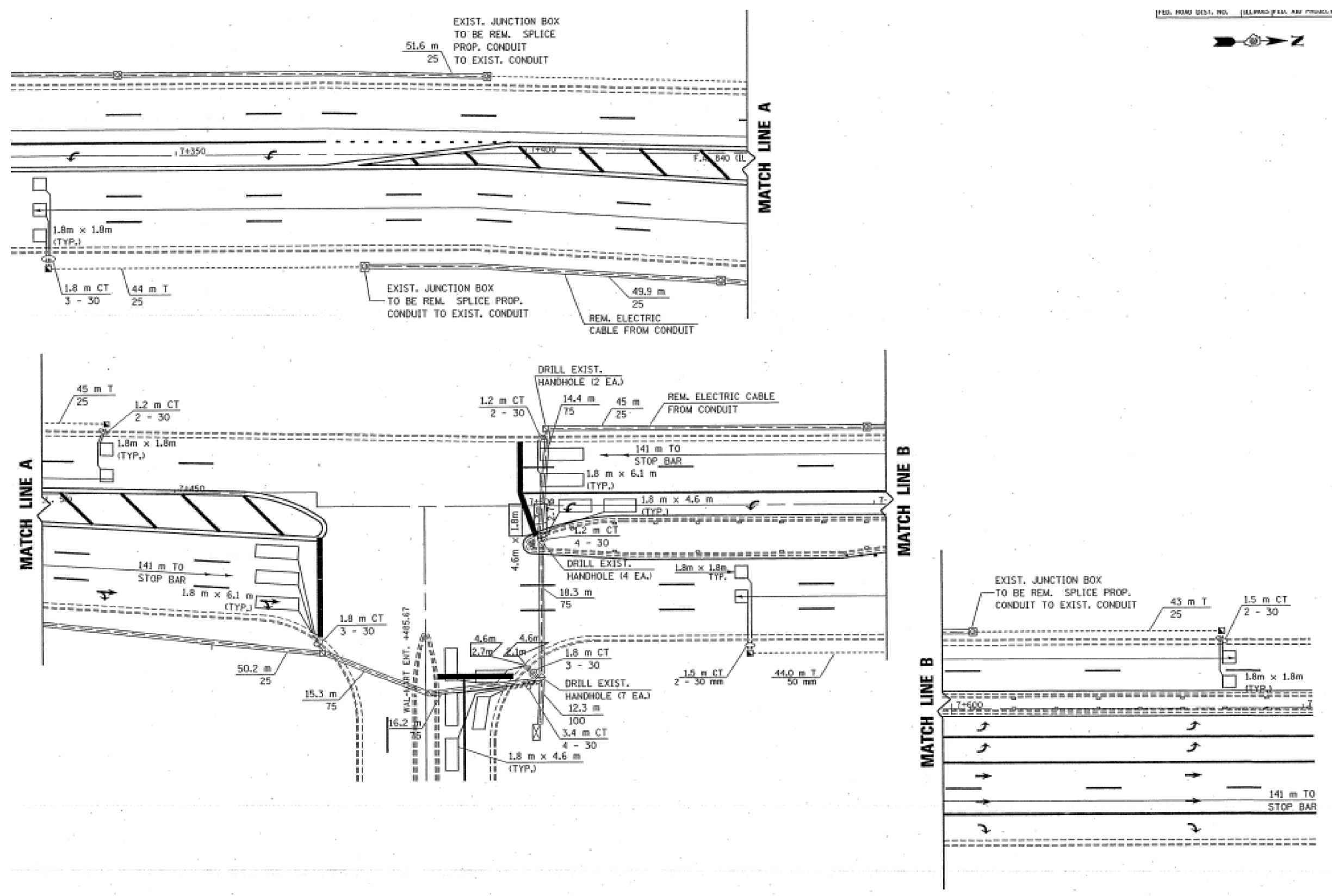

## WAL-MART DETECTOR LOOPS

**FOR INFORMATION ONLY**

THE CONTRACTOR SHALL CONTACT THE IDOT DISTRICT 3 TRAFFIC SECTION AT (815) 434-6131 BEFORE MILLING TO VERIFY DETECTOR LOOP LOCATIONS.

• INTERMITTENT SPRING ROAD REPAIR 2014-6

FILE NAME =	USER NAME = carpenterdj	DESIGNED -	REVISED -	<b>STATE OF ILLINOIS DEPARTMENT OF TRANSPORTATION</b>	<b>DETECTOR LOOP (FOR INFORMATION ONLY) LOCATION 2 - IL 50</b>	F.A.P. R.T.E.	SECTION	COUNTY	TOTAL SHEETS	SHEET NO.	
ci:\pw\work\p\idot\carpenterdj\d0387881\3xxxxx-sht-details.dgn	PLOT SCALE = 100.0000' / 1"	DRAWN -	REVISED -			VAR	.	KANKAKEE	24	16	
\$MODELNAME\$	PLOT DATE = 4/11/2014	CHECKED -	REVISED -			CONTRACT NO. 66D91					
		DATE -	REVISED -			ILLINOIS FED. AID PROJECT					



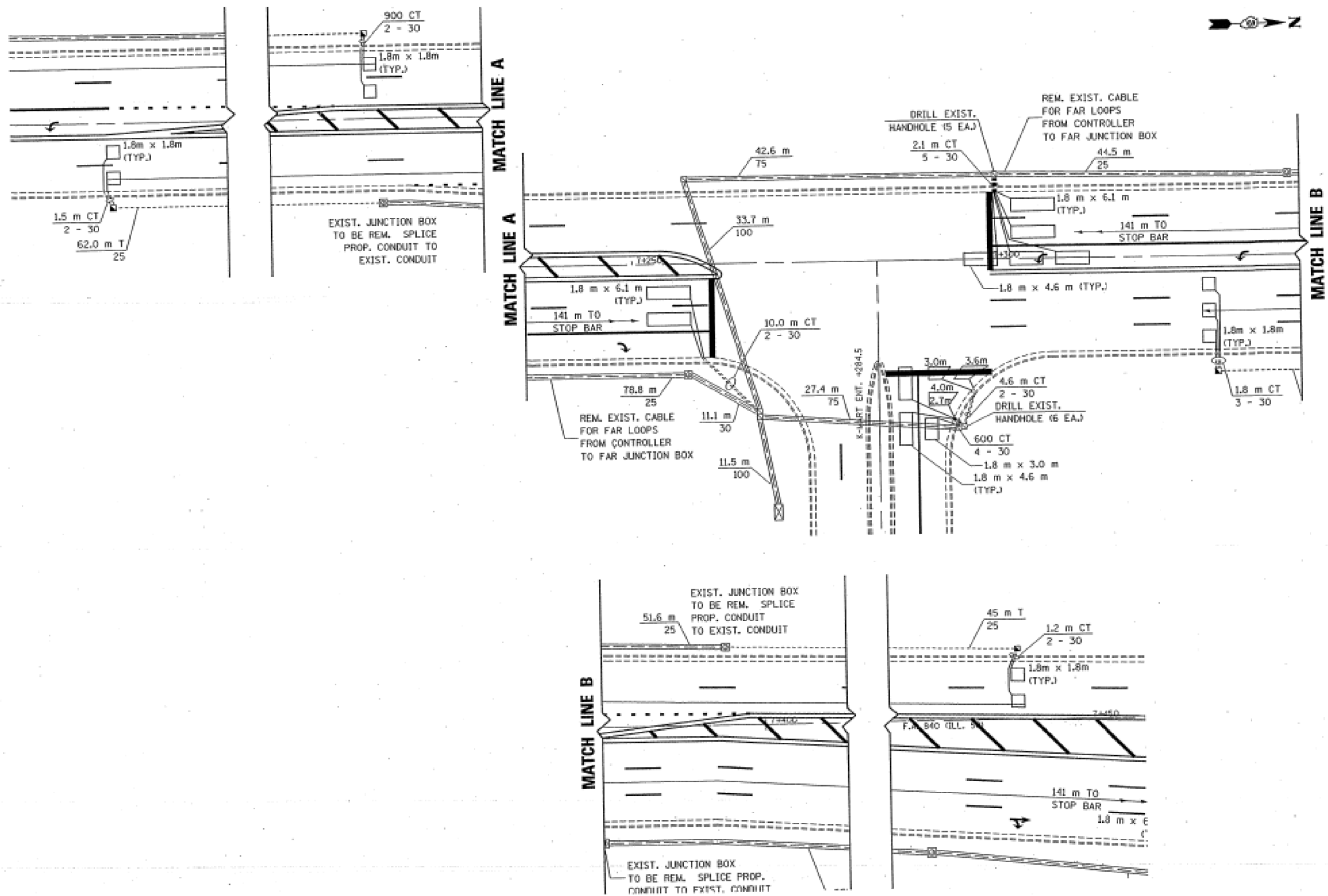

## K-MART DETECTOR LOOPS

**FOR INFORMATION ONLY**

THE CONTRACTOR SHALL CONTACT THE IDOT DISTRICT 3 TRAFFIC SECTION AT (815) 434-6131 BEFORE MILLING TO VERIFY DETECTOR LOOP LOCATIONS.

• INTERMITTENT SPRING ROAD REPAIR 2014-6

FILE NAME =	USER NAME = carpenterdj	DESIGNED -	REVISED -
c:\pwork\pwork\carpenterdj\d0387881\3xxxx-sht-details.dgn		DRAWN -	REVISED -
	PLOT SCALE = 100.0000' / 1"	CHECKED -	REVISED -
\$MODELNAME\$	PLOT DATE = 4/11/2014	DATE -	REVISED -

**STATE OF ILLINOIS  
DEPARTMENT OF TRANSPORTATION**

**DETECTOR LOOP (FOR INFORMATION ONLY)  
LOCATION 2 - IL 50**

SCALE: SHEET OF SHEETS STA. TO STA.

F.A.P. RTE.	SECTION	COUNTY	TOTAL SHEETS	SHEET NO.
VAR	•	KANKAKEE	24	17
CONTRACT NO. 66D91				
ILLINOIS FED. AID PROJECT				

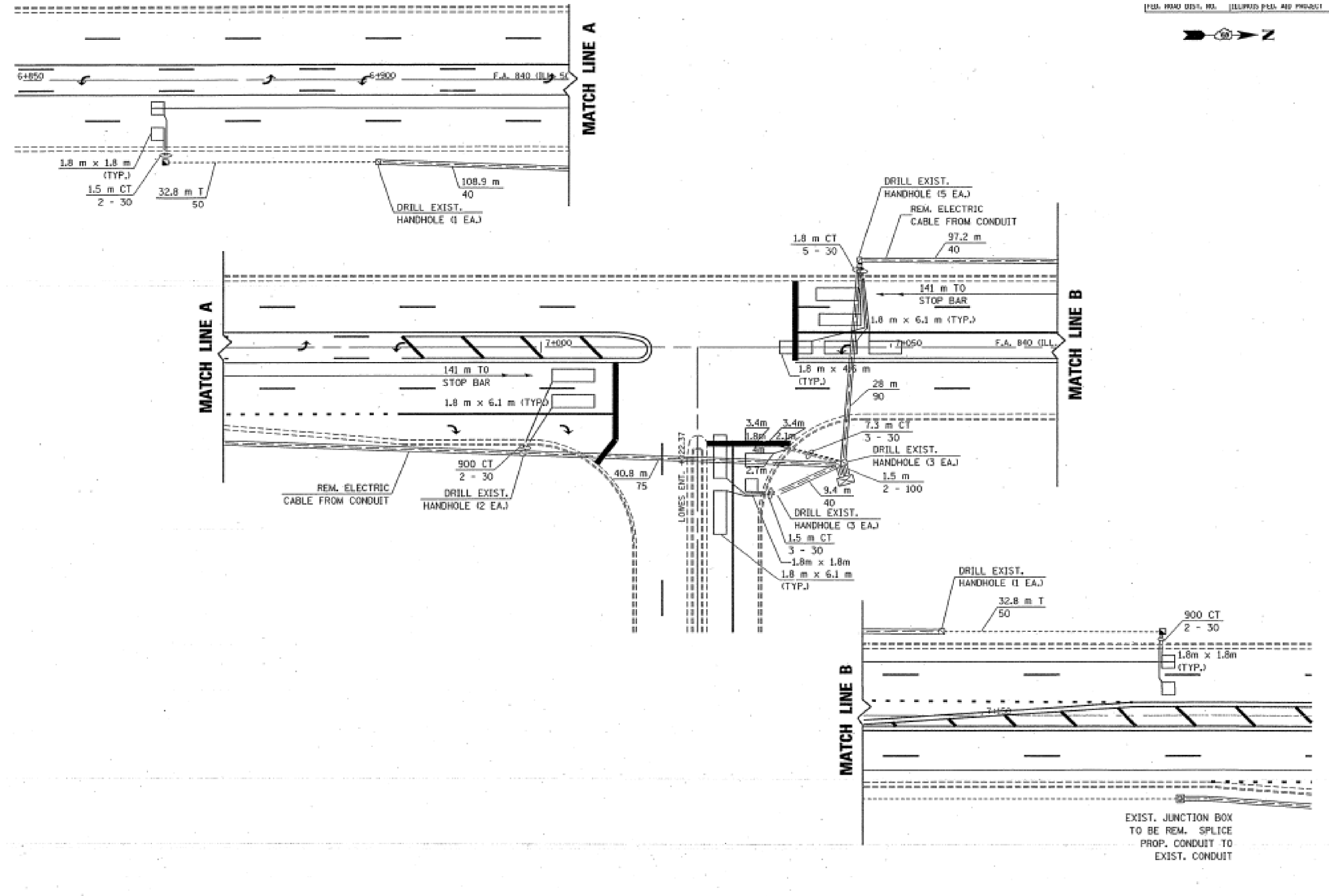

**FOR INFORMATION ONLY**

THE CONTRACTOR SHALL CONTACT THE IDOT DISTRICT 3 TRAFFIC SECTION AT (815) 434-6131 BEFORE MILLING TO VERIFY DETECTOR LOOP LOCATIONS.

• INTERMITTENT SPRING ROAD REPAIR 2014-6

FILE NAME = c:\p\work\p\idot\carpenterd\0387881\03xxxx-sht-details.dgn	USER NAME = carpenterdj	DESIGNED -	REVISED -	<b>STATE OF ILLINOIS DEPARTMENT OF TRANSPORTATION</b>	<b>DETECTOR LOOP (FOR INFORMATION ONLY) LOCATION 2 - IL 50</b>	F.A.P. RTE.	SECTION	COUNTY	TOTAL SHEETS	SHEET NO.		
	PLOT SCALE = 100.0000' / 1" =	DRAWN -	REVISED -									
		CHECKED -	REVISED -									
		DATE -	REVISED -									
						SCALE:	SHEET	OF	SHEETS	STA.	TO	STA.
						ILLINOIS FED. AID PROJECT						

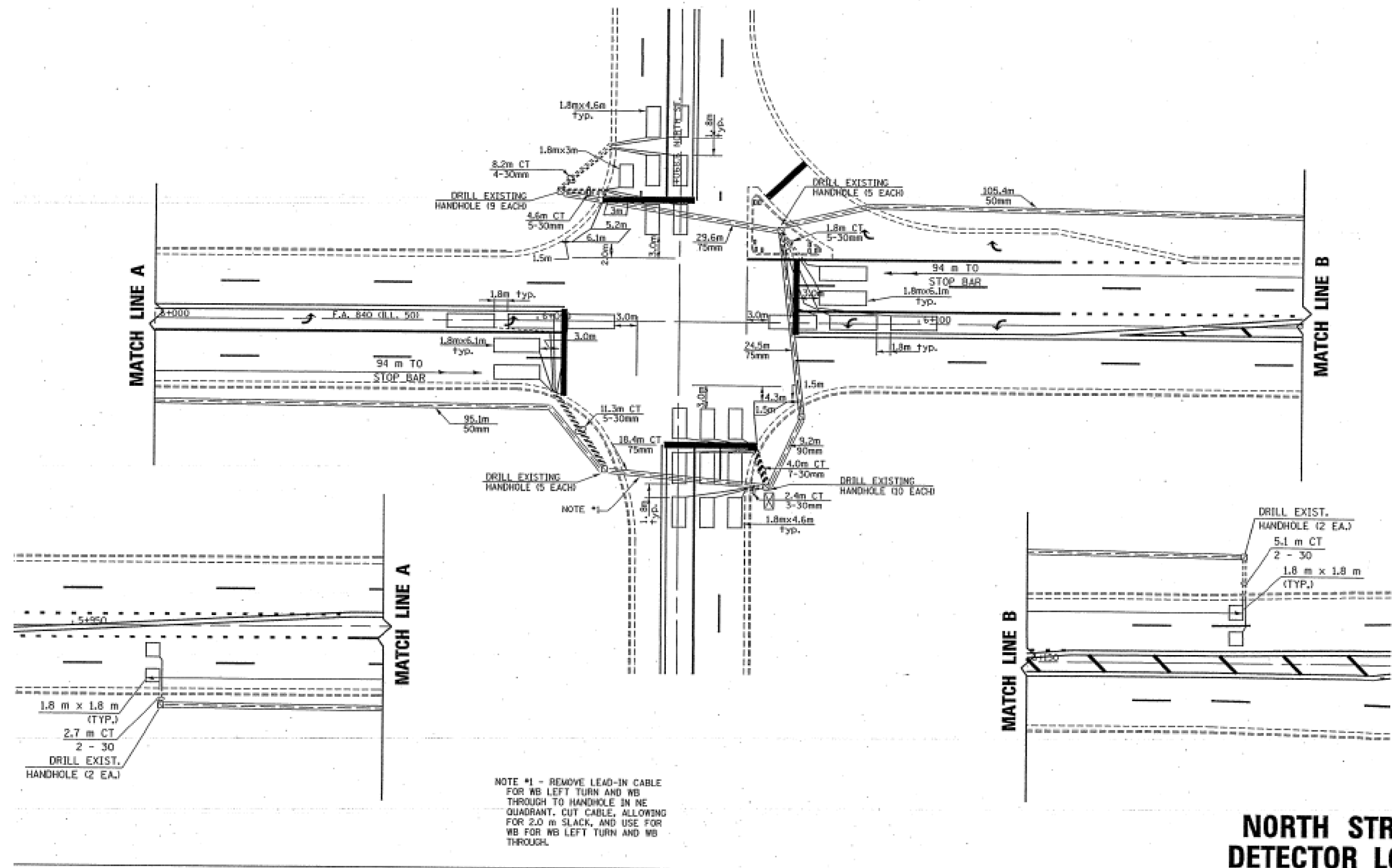

NOTE #1 - REMOVE LEAD-IN CABLE FOR WB LEFT TURN AND WB THROUGH TO HANDHOLE IN NE QUADRANT. CUT CABLE, ALLOWING FOR 2.0 m SLACK, AND USE FOR WB FOR WB LEFT TURN AND WB THROUGH.

## NORTH STREET DETECTOR LOOPS

**FOR INFORMATION ONLY**

THE CONTRACTOR SHALL CONTACT THE IDOT DISTRICT 3 TRAFFIC SECTION AT (815) 434-6131 BEFORE MILLING TO VERIFY DETECTOR LOOP LOCATIONS.

• INTERMITTENT SPRING ROAD REPAIR 2014-6

FILE NAME = c:\p\work\p\idot\carpenterd\0387881\3xxxxx-sht-details.dgn	USER NAME = carpenterd	DESIGNED -	REVISED -	<b>STATE OF ILLINOIS DEPARTMENT OF TRANSPORTATION</b>	<b>DETECTOR LOOP (FOR INFORMATION ONLY) LOCATION 2 - IL 50</b>	F.A.P. RTE.	SECTION	COUNTY	TOTAL SHEETS	SHEET NO.	
\$MODELNAME\$	PLOT DATE = 4/11/2014	DRAWN -	REVISED -			SCALE:	SHEET OF SHEETS	STA. TO STA.	KANKAKEE	24	19
		CHECKED -	REVISED -							CONTRACT NO. 66D91	
		DATE -	REVISED -							ILLINOIS FED. AID PROJECT	

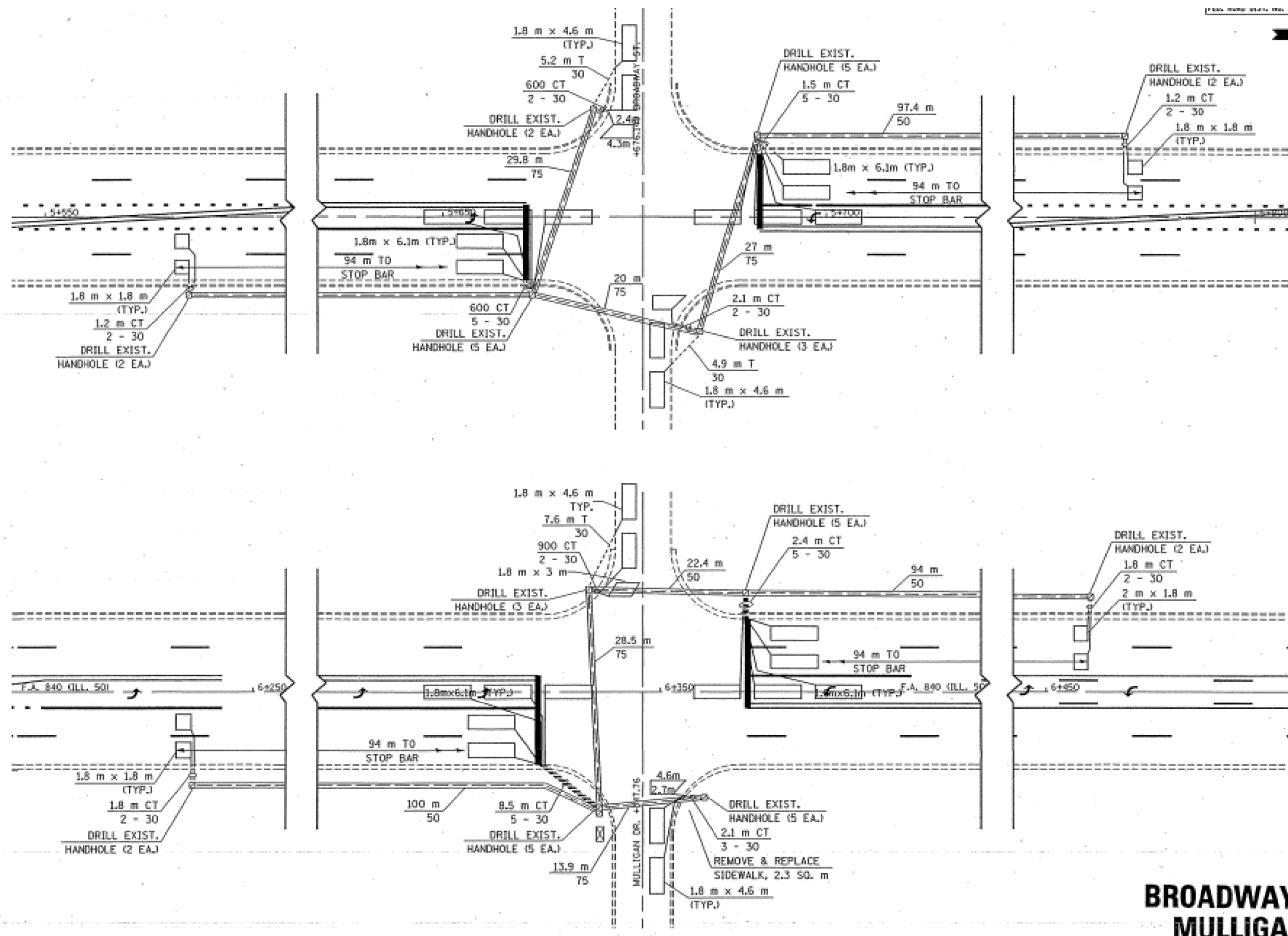

# BROADWAY STREET MULLIGAN DRIVE DETECTOR LOOPS

**FOR INFORMATION ONLY**

THE CONTRACTOR SHALL CONTACT THE IDOT DISTRICT 3 TRAFFIC SECTION AT (815) 434-6131 BEFORE MILLING TO VERIFY DETECTOR LOOP LOCATIONS.

• INTERMITTENT SPRING ROAD REPAIR 2014-6

FILE NAME =	USER NAME = carpenterdj	DESIGNED -	REVISED -
c:\pwork\pwork\carpenterdj\d0387881\3xxxxx-sht-details.dgn		DRAWN -	REVISED -
PLOT SCALE = 100.0000' / 1"		CHECKED -	REVISED -
PLOT DATE = 4/11/2014		DATE -	REVISED -

**STATE OF ILLINOIS  
DEPARTMENT OF TRANSPORTATION**

**DETECTOR LOOP (FOR INFORMATION ONLY)  
LOCATION 2 - IL 50**

SCALE: SHEET OF SHEETS STA. TO STA.

F.A.P. RTE.	SECTION	COUNTY	TOTAL SHEETS	SHEET NO.
VAR	.	KANKAKEE	24	20
CONTRACT NO. 66D91				
ILLINOIS FED. AID PROJECT				

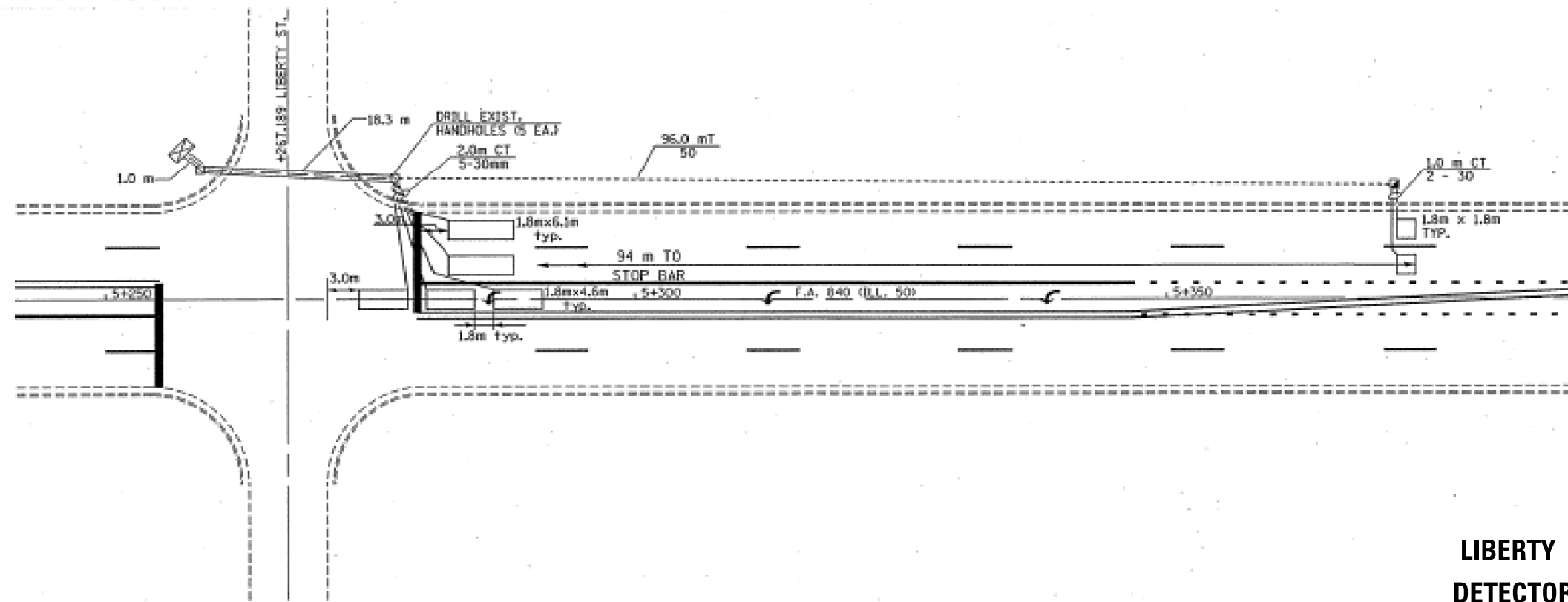

**LIBERTY STREET  
DETECTOR LOOPS**

**FOR INFORMATION ONLY**

THE CONTRACTOR SHALL CONTACT THE IDOT DISTRICT 3 TRAFFIC SECTION AT (815) 434-6131 BEFORE MILLING TO VERIFY DETECTOR LOOP LOCATIONS.

• INTERMITTENT SPRING ROAD REPAIR 2014-6

FILE NAME =	USER NAME = carpenterdj	DESIGNED -	REVISED -
c:\pwork\pwork\carpenterdj\d0387881\03xxxxx-sht-details.dgn		DRAWN -	REVISED -
	PLOT SCALE = 100.0000' / in.	CHECKED -	REVISED -
\$MODELNAME\$	PLOT DATE = 4/11/2014	DATE -	REVISED -

**STATE OF ILLINOIS  
DEPARTMENT OF TRANSPORTATION**

<b>DETECTOR LOOP (FOR INFORMATION ONLY)</b>			
<b>LOCATION 2 - IL 50</b>			
SCALE:	SHEET	OF SHEETS	STA. TO STA.

F.A.P. RTE.	SECTION	COUNTY	TOTAL SHEETS	SHEET NO.
VAR	•	KANKAKEE	24	21
CONTRACT NO. 66D91				
ILLINOIS FED. AID PROJECT				

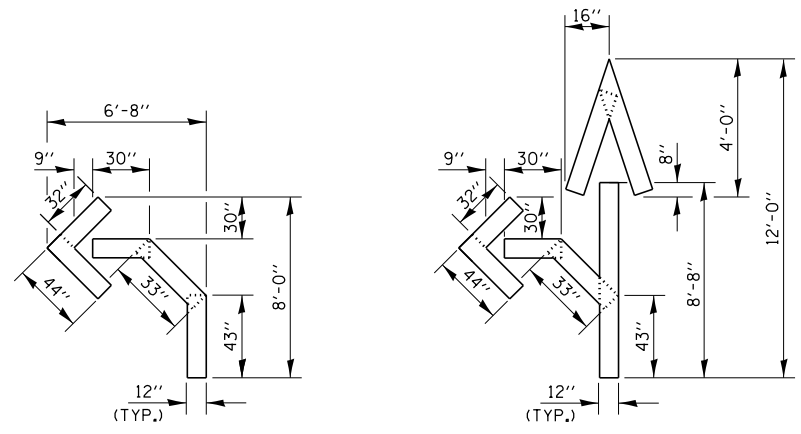

QUANTITY  
12" LINE = 16 LIN. FT.  
OR 4" LINE = 48 LIN. FT.

QUANTITY  
12" LINE = 29 LIN. FT.  
OR 4" LINE = 87 LIN. FT.

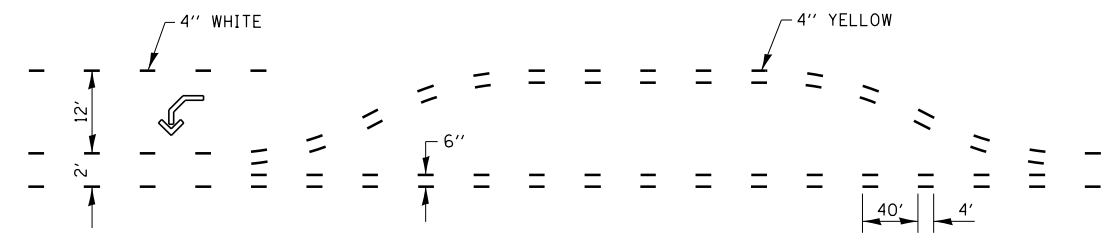

**SHORT-TERM PAVEMENT MARKING  
FOR MEDIANS AND ARROWS**

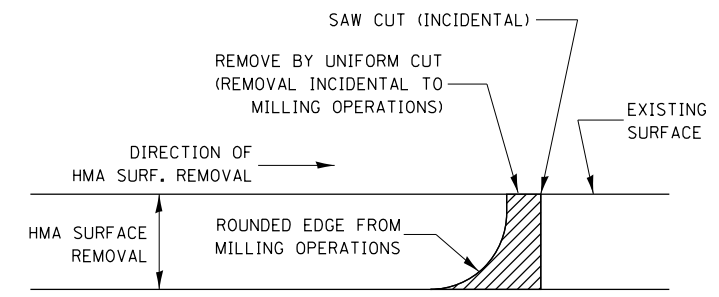

NOTE:  
WHEN MILLING OPERATIONS PRODUCE A ROUNDED EDGE,  
THEN A SAW CUT SHALL BE USED TO MANUFACTURE  
A PERPENDICULAR EDGE AS SHOWN IN THE DETAIL.  
THE ENGINEER SHALL BE THE SOLE JUDGE  
CONCERNING THE USE OF THIS DETAIL

**HMA DETAIL AT BUTT JOINTS**

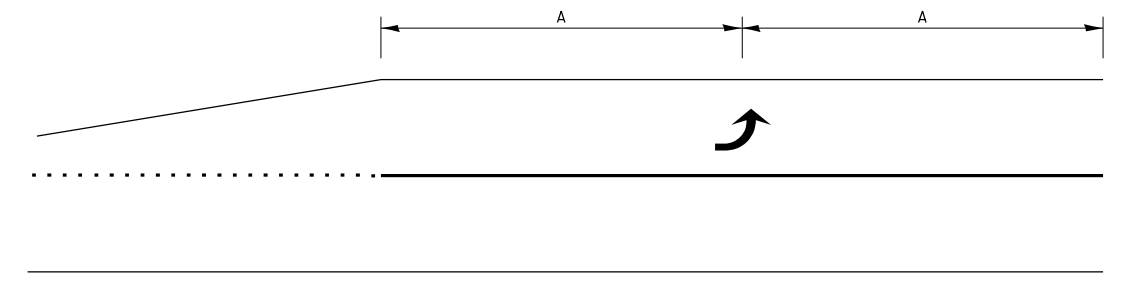

**99' AND UNDER**

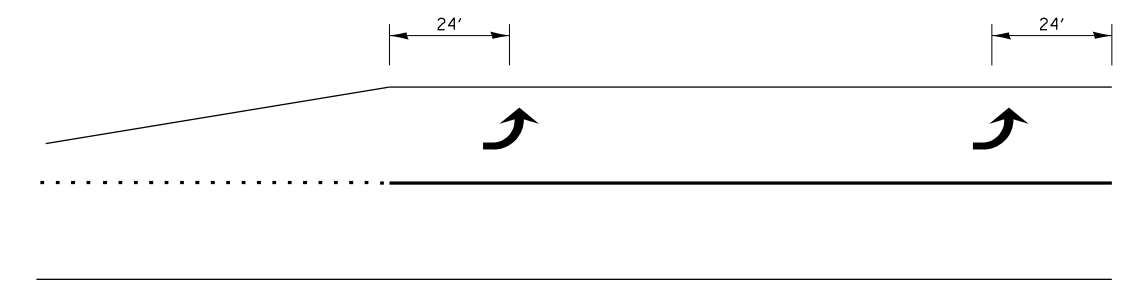

**100' TO 149'**

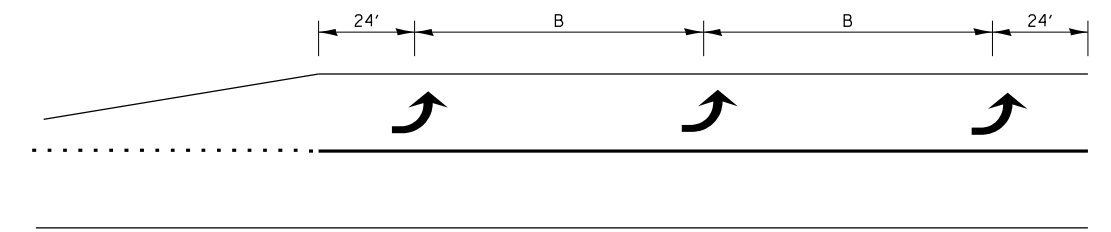

**150' AND LONGER**

**TYPICAL PLACEMENT OF ARROWS  
IN TURN LANES**

FILE NAME =	USER NAME = carpenterdj	DESIGNED -	REVISED -
ei:\pw\work\p\midot\carpenterdj\d0387881\03xxxx-sht-details.dgn		DRAWN -	REVISED -
	PLOT SCALE = 100.0000' / 1in.	CHECKED -	REVISED -
	PLOT DATE = 4/11/2014	DATE -	REVISED -

STATE OF ILLINOIS  
DEPARTMENT OF TRANSPORTATION

DETAILS			
SCALE:	SHEET NO.	OF SHEETS	STA. TO STA.

F.A.P. RTE.	SECTION	COUNTY	TOTAL SHEETS	SHEET NO.
VAR	.	KANKAKEE	24	22
CONTRACT NO. 66D91				
ILLINOIS FED. AID PROJECT				

• INTERMITTENT SPRING ROAD REPAIR 2014-6

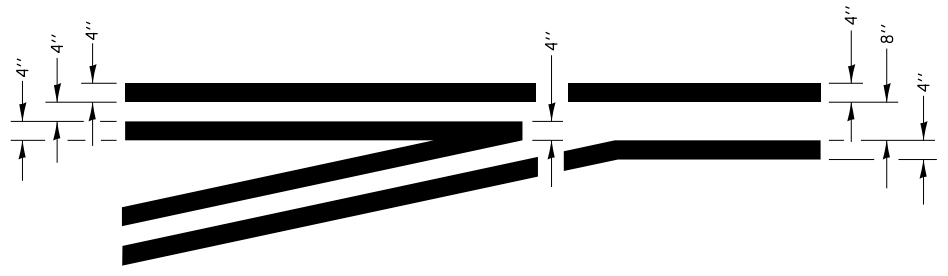
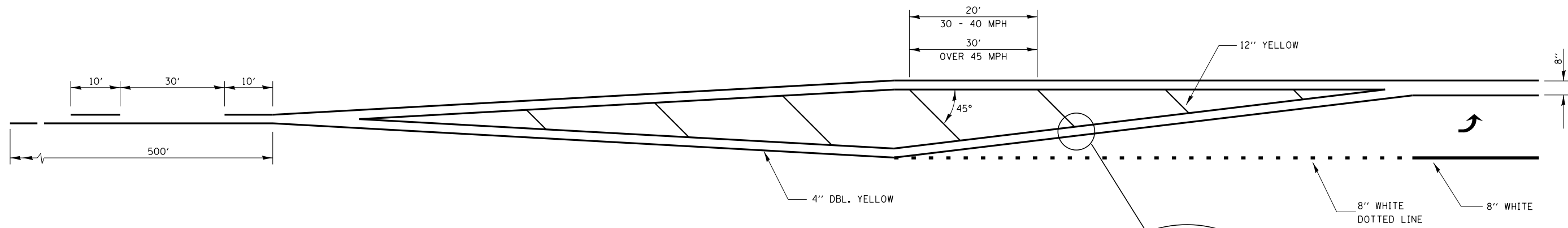

**TYPICAL APPLICATION  
LEFT TURN LANES**

**ADVANCE AND INTERSECTION LANE  
DIVIDER LINES**

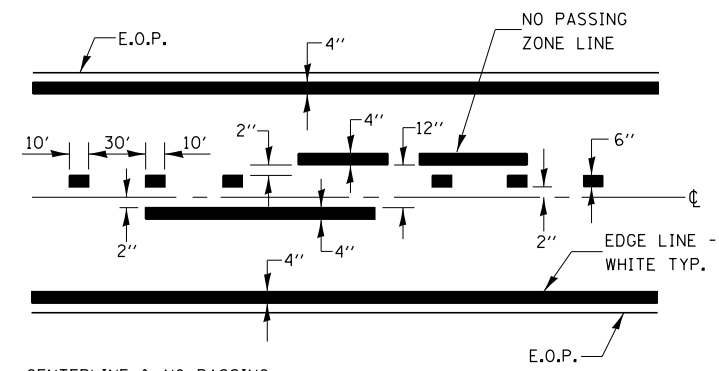
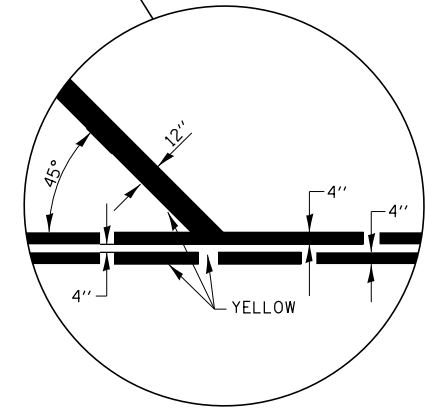

**PAVEMENT MARKING**

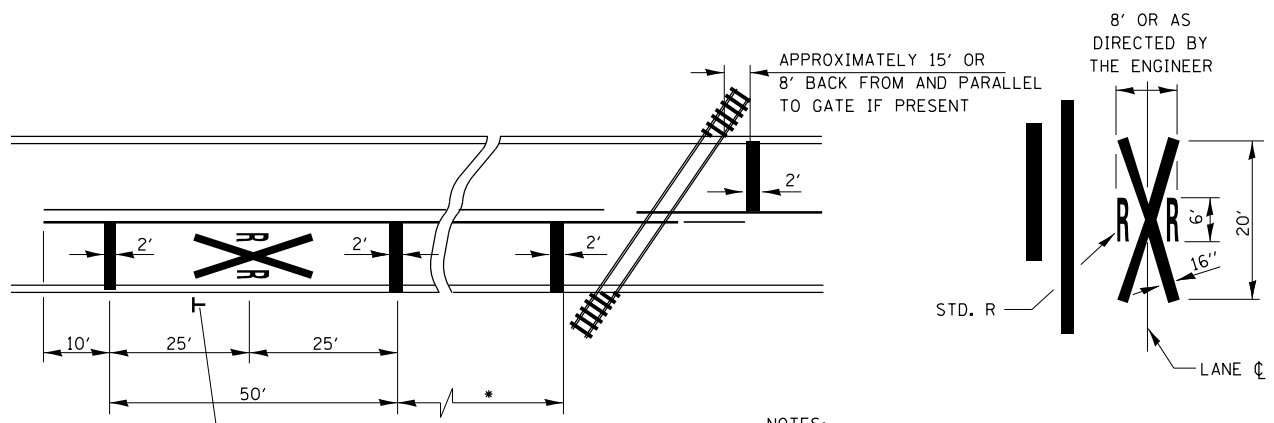

**PAVEMENT MARKINGS AT  
RAILROAD-HIGHWAY GRADE CROSSING**

• MINIMUM DISTANCE  
400' FOR 55 MPH  
250' FOR 45 MPH  
100' FOR 35 MPH OR LESS

NOTES:  
THE TRANSVERSE SPREAD OF THE "X"  
MAY VARY ACCORDING TO LANE WIDTH.  
  
ON MULTI-LANE ROADS, THE STOP LINES  
SHALL EXTEND ACROSS ALL APPROACH  
LANES AND SEPARATE RXR SYMBOLS SHALL  
BE PLACED ADJACENT TO EACH OTHER  
IN EACH LANE.  
  
WHEN THE PAVEMENT MARKING SYMBOL  
IS USED, A PORTION OF THE SYMBOL  
SHOULD BE LOCATED DIRECTLY ADJACENT  
TO THE ADVANCE WARNING SIGN (W10-1).

FILE NAME =	USER NAME = carpenterdj	DESIGNED -	REVISED -
ei:\pw\work\p\idot\carpenterdj\d0387881\03xxxx-sht-details.dgn		DRAWN -	REVISED -
	PLOT SCALE = 100.0000' / in.	CHECKED -	REVISED -
	PLOT DATE = 4/11/2014	DATE -	REVISED -

**STATE OF ILLINOIS  
DEPARTMENT OF TRANSPORTATION**

<b>DETAILS</b>			
SCALE:	SHEET	OF SHEETS	STA. TO STA.

F.A.P. RTE.	SECTION	COUNTY	TOTAL SHEETS	SHEET NO.
VAR	•	KANKAKEE	24	23
CONTRACT NO. 66D91				
ILLINOIS FED. AID PROJECT				

• INTERMITTENT SPRING ROAD REPAIR 2014-6

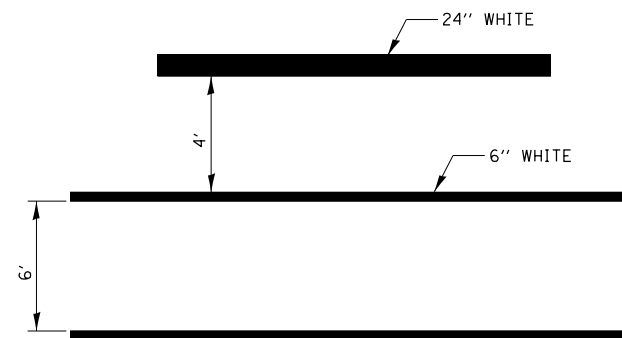

**TYPICAL SPACING DETAIL FOR  
CROSSWALKS AND STOP BARS**

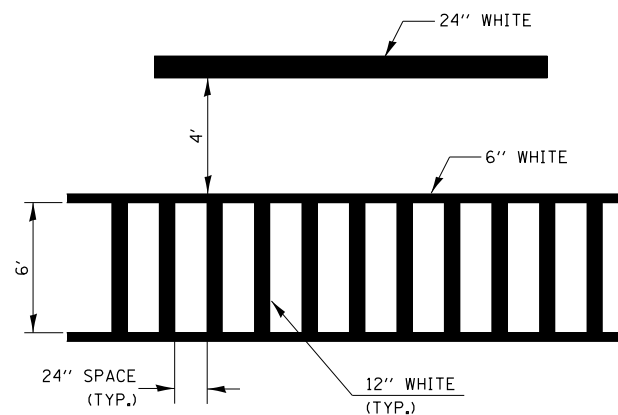

**TYPICAL SPACING DETAIL FOR  
CROSSWALKS AND STOP BARS**

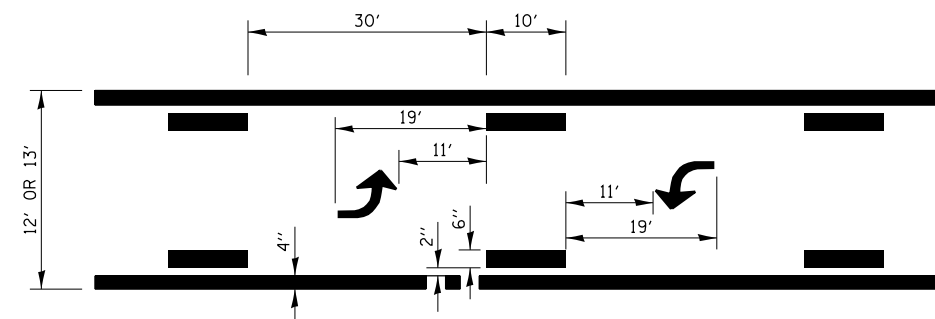

**TYPICAL APPLICATION  
BI-DIRECTIONAL TURN LANE**

FILE NAME =	USER NAME = carpenterdj	DESIGNED -	REVISED -
c:\pw\work\p\idot\carpenterdj\d0387881\03xxxxx-sht-details.dgn		DRAWN -	REVISED -
	PLOT SCALE = 100.0000' / in.	CHECKED -	REVISED -
	PLOT DATE = 4/11/2014	DATE -	REVISED -

**STATE OF ILLINOIS  
DEPARTMENT OF TRANSPORTATION**

**DETAILS**

SCALE: SHEET OF SHEETS STA. TO STA.

• INTERMITTENT SPRING ROAD REPAIR 2014-6

F.A.P. RTE.	SECTION	COUNTY	TOTAL SHEETS	SHEET NO.
VAR	•	KANKAKEE	24	24
			CONTRACT NO. 66D91	
ILLINOIS FED. AID PROJECT				