

FOR INDEX OF SHEETS, SEE SHEET NO. 2

STATE OF ILLINOIS  
DEPARTMENT OF TRANSPORTATION  
DIVISION OF HIGHWAYS

**PROPOSED  
HIGHWAY PLANS**

F.A.P. ROUTE 669 (ILL.116)  
SECTION 171-1; 161-3; 15-1  
SPRING ROAD REPAIR  
PEORIA COUNTY  
C-94-081-14

F.A.P. RTE.	SECTION	COUNTY	TOTAL SHEETS	SHEET NO.
669	171-1; 161-3; 15-1	PEORIA	10	1
		ILLINOIS	CONTRACT NO. 68B83	

JOB NO. D-94-025-14

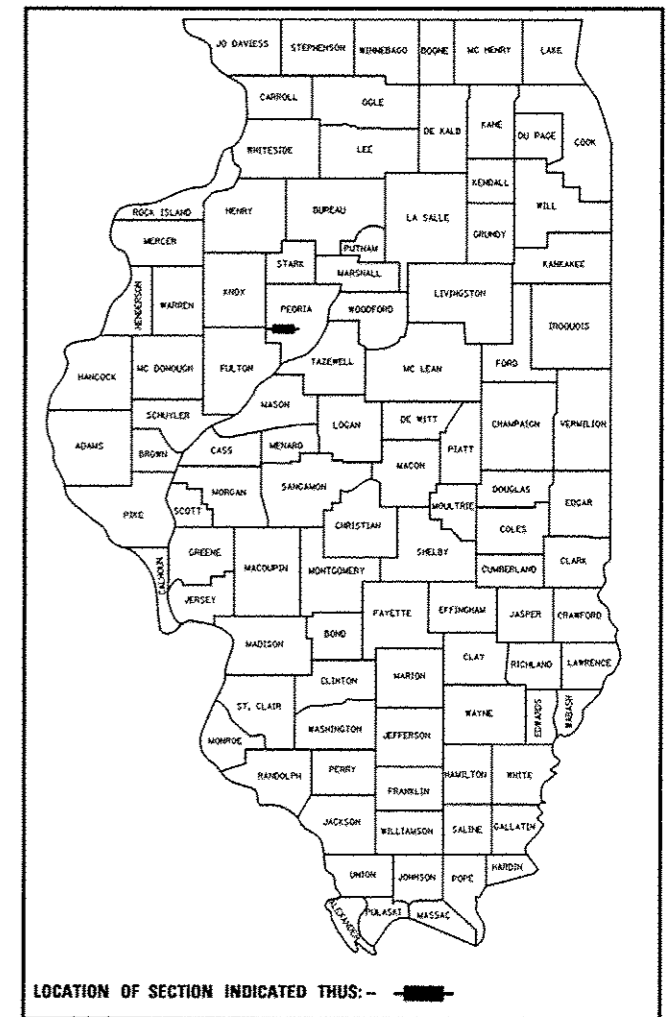

**STATION EQUATIONS**

- P.I. STA. 794+00.00 BK. =
- P.O.T. STA. 794+16.00 AH.
- P.O.T. STA. 874+54.39 BK. =
- P.O.T. STA. 874+56.13 AH.
- P.I. STA. 943+00.00 BK. =
- P.O.T. STA. 942+95.50 AH.
- P.T. STA. 988+27.55 BK. =
- P.O.T. STA. 988+43.06 AH.
- P.T. STA. 996+60.86 BK. =
- P.O.T. STA. 996+42.16 AH.
- P.I. STA. 1043+00.00 BK. =
- P.O.T. STA. 1043+09.03 AH.
- P.O.T. STA. 1079+00.00 BK. =
- P.O.T. STA. 1078+92.19 AH.
- P.O.T. STA. 1131+74.91 BK. =
- P.O.T. STA. 1131+75.91 AH.
- P.T. STA. 1183+15.36 BK. =
- P.O.T. STA. 1183+21.02 AH.

STATION EQUATION  
P.O.T. STA. 1201+06.51 BK =  
P.O.T. STA. 24+26.49 AH  
(STATIONING DECREASES GOING WEST  
AND STATIONING DECREASES GOING EAST)

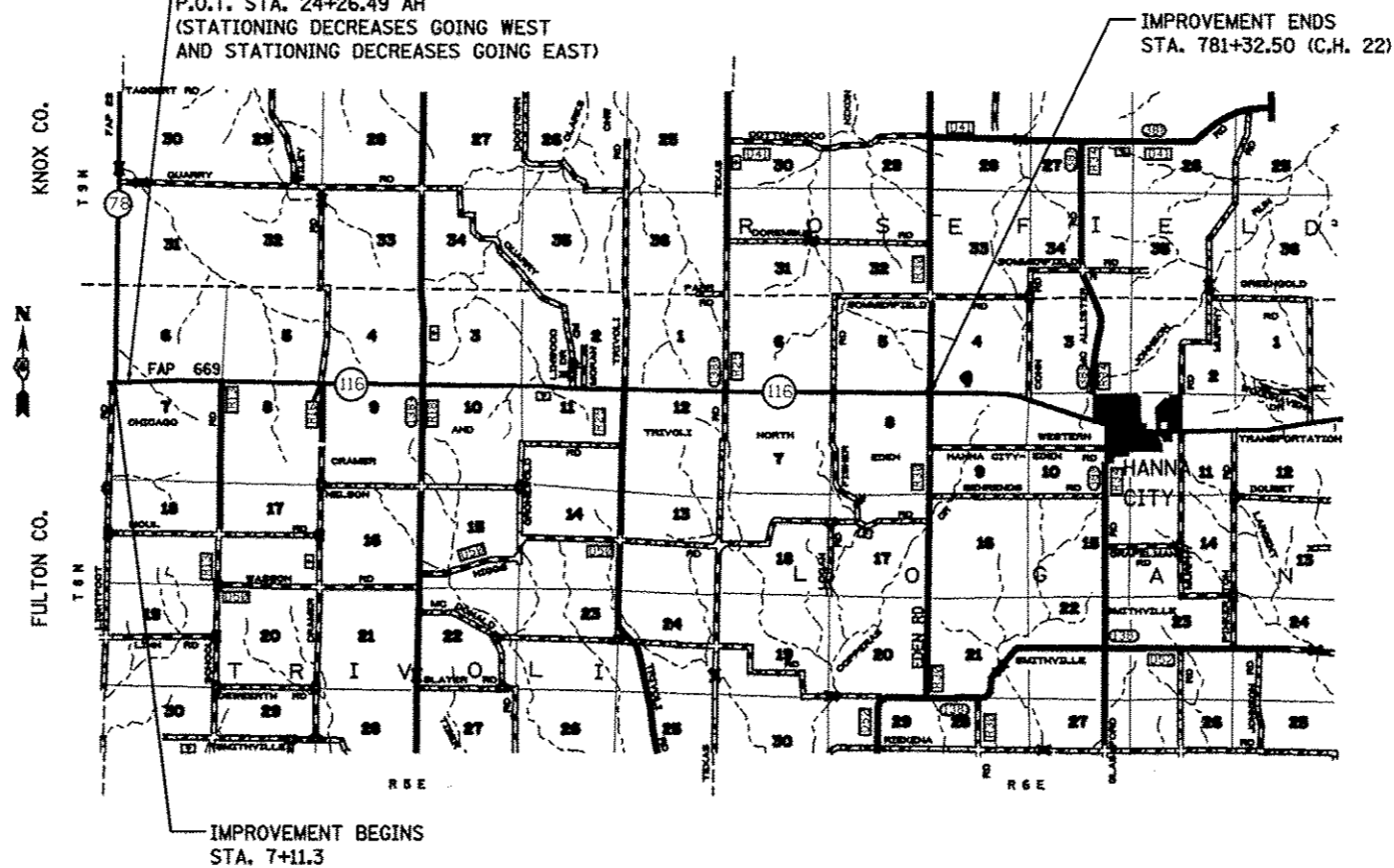

J.U.L.I.E.  
JOINT UTILITY LOCATION INFORMATION FOR EXCAVATION  
1-800-892-0123  
OR 811

PROJECT ENGINEER RICH DOTSON (309-671-3455)  
PROJECT MANAGER KEVIN HORST (309-671-3472)  
  
CONTRACT NO. 68B83

GROSS LENGTH = 43671.27 FT. = 8.271 MILES  
NET LENGTH = 43671.27 FT. = 8.271 MILES

DESCRIPTION OF WORK:  
THIS PROJECT CONSISTS OF PARTIAL DEPTH PATCHING.

STATE OF ILLINOIS  
DEPARTMENT OF TRANSPORTATION  
DIVISION OF HIGHWAYS  
SUBMITTED 0409 2014  
*John D. Beranzelli*  
DEPUTY DIRECTOR OF HIGHWAYS, REGION ENGINEER  
May 9 2014  
*John D. Beranzelli* PE/br  
ENGINEER OF DESIGN AND ENVIRONMENT  
May 9 2014  
*Chris Osborn* PE/br  
DIRECTOR OF HIGHWAYS, CHIEF ENGINEER

**PRINTED BY THE AUTHORITY  
OF THE STATE OF ILLINOIS**